

# WALKER SERVICE DIVISION

*Same as Def 134*

## JACK PARTS MANUAL

MODEL J-132

Series AA & B

MODEL J-134

Series AA

J-132 TWO TON CAPACITY  
J-134 FOUR TON CAPACITY

SEE PARTS SHEET FILE FOR:

J-132 SERIES D

J-134 SERIES C

**RETAIN**

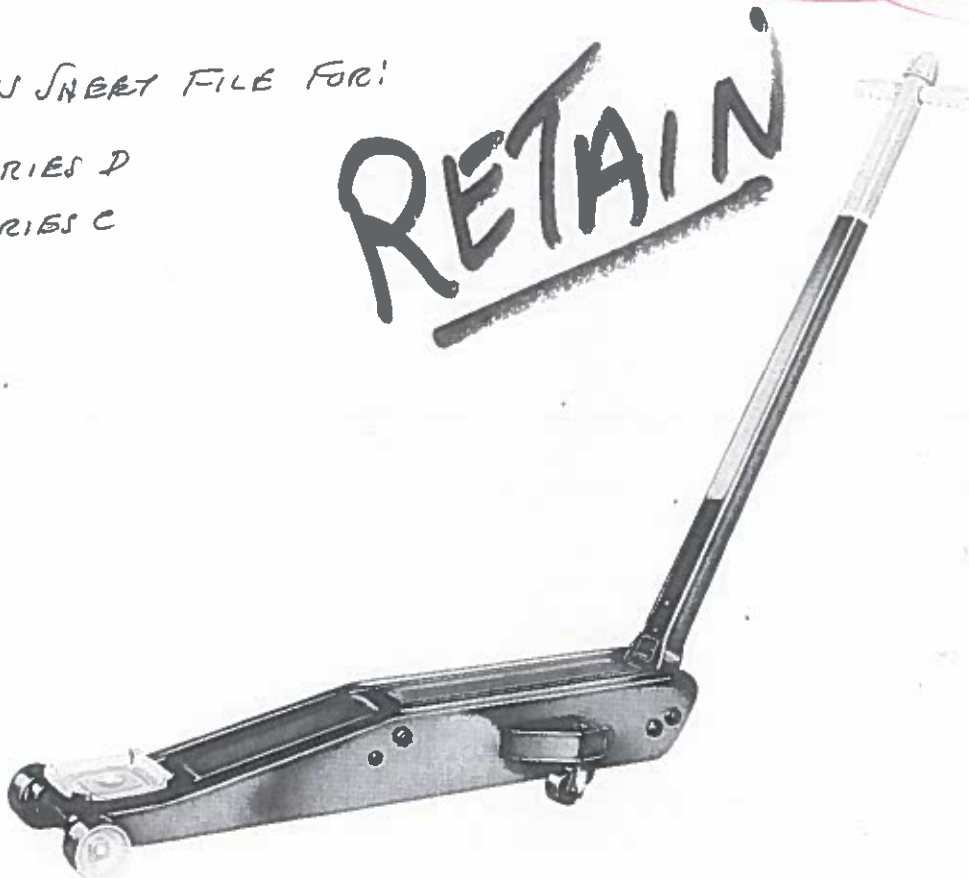

### WALKER SERVICE

We have Factory-owned BRANCHES AND AUTHORIZED SERVICE DEPOTS located in the principal cities of the United States and Canada. They are operated by FACTORY TRAINED STAFFS and carry a comprehensive stock of REPAIR PARTS. Before returning Jacks for service, please contact the Factory or your Walker DISTRIBUTOR for location of Branch or Service Depot nearest you. Walker Branches will be listed under Walker Marketing Corporation, and your orders should be directed accordingly.

**NOTE: WALKER WHOLESALE DISTRIBUTORS & DEALERS** – When ordering repair parts from Factory or Factory Branches – address orders to WALKER MARKETING CORPORATION.

**WALKER MANUFACTURING COMPANY** GENERAL OFFICE: RACINE, WISCONSIN  
FACTORY SERVICE BRANCHES: – ATLANTA, GEORGIA – CLEVELAND, OHIO – KANSAS CITY, MISSOURI – PHILADELPHIA, PENNA. WALKER BRANCHES ARE LISTED – WALKER MARKETING CORP. – ADDRESS ACCORDINGLY.

Q-134-AA

W.C. & J. J. ...

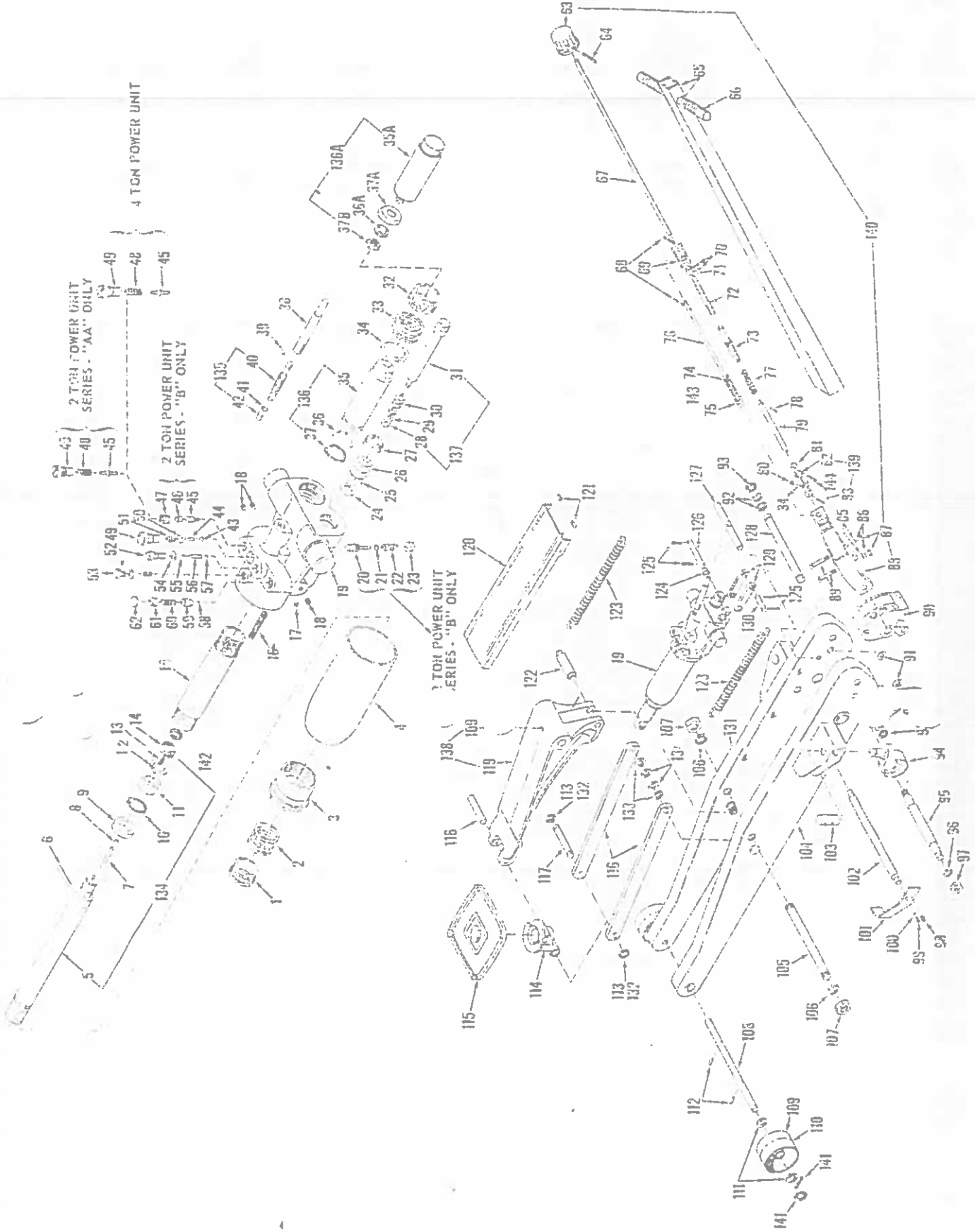

PART NUMBER, NOT BY CODE NUMBER  
PAGE FOR COMPLETE NUMERICAL LISTING

MODEL J-132 Series AA & B  
 MODEL J-134 Series AA

Code No.	Part Number		Part Number		Description
	Model J-132	Used on Series	Model J-134	Used on Series	
1	222062	AA-B	222066	AA	Ram Gland Nut
2	See Note 1 222 063	AA-B	See Note 1 222 064	AA	Packing Ring - Ram
3	222061	AA-B	222067	AA	Tank Nut
4	221749	AA-B	221765	AA	Oil Tank
5	223283	B	223165	Late AA	Ram
5	See Note 2	AA	See Note 2	Early AA	Ram
6	G-17691	AA-B	G-17851	AA	Cross Pin
7	221751	AA-B	221767	AA	Up - Stop Pin
8	See Note 1 203 199	AA-B	See Note 1 203 199	AA	Valve
9	221752	AA-B	221768	AA	Heel Plate - Ram
10	See Note 1 221 703	AA-B	See Note 1 221 709	AA	Ram Cup
11	221754	AA-B	221754	AA	Ram Cup Retainer
12	221847	AA-B	221847	AA	Retainer Ring
13	G-18491	AA-B	G-18491	AA	Spring
14	223166	B	223166	Late AA	Screen
14	221755	AA	221755	Early AA	Screen
15	221750	AA-B	221766	AA	Cylinder
16	G-16701	AA-B	G-16701	AA	Screen
17	201808	AA-B	201808	AA	Rivet
18	210311 (3)	AA-B	210311 (3)	AA	Pipe Plug
19	222955	B	221777	AA	Base
19	See Note 3	AA			Base
20	222992	B			Poppet
21	See Note 1 214 035	B			"O" Ring
22	222991	B			Spring
23	222993	B			Adjustment Plug
24	204402	AA-B	204301	AA	Washer
25	See Note 1 222 200	AA-B	See Note 1 213 152	AA	Packing Ring
26	222209	AA-B	G-16571	AA	Gland Nut
27	212170	AA-B	212170	AA	Hex Nut
28	204325	AA-B	218544	AA	Washer
29	See Note 1 226 397	AA-B	See Note 1 218 542	AA	Rubber Washer
30	See Note 1 201 226	AA-B	See Note 1 201 227	AA	"V" Packing
31	222208	AA-B	221744	AA	Pressure Pump
32	G-16581	AA-B	G-17081	AA	Gland Nut
33	See Note 1 213 170	AA-B	See Note 1 213 171	AA	Packing Ring
34	204359	AA-B	204372	AA	Washer
35	221756	B	221770	Late AA	Speed Pump
35A	210232	AA	210224	Early AA	Speed Pump
36	221757	B	221771	Late AA	Washer
36A	204272	AA	204286	Early AA	Washer
37	See Note 1 221 758	B	See Note 1 221 772	Late AA	Quad Ring
37A	See Note 1 218 723	AA	See Note 1 200 524	Early AA	Cup Leather 213 660 For J134
37B	203344	AA	203287	Early AA	Hex Nut
38	G-17151	AA-B	G-17151	AA	Slotted Tube
39	220769	AA-B	220769	AA	Release Pin
40	212875	AA-B	212875	AA	Release Stem
41	See Note 1 214 105	AA-B	See Note 1 214 105	AA	"O" Ring
42	212227	AA-B	212227	AA	Release Valve
43	See Note 1 203 200	AA-B	See Note 1 203 200	AA	Valve
44	221740	AA-B	221740	AA	Plug
45	222957	B			Piston
45	221739	AA	221739	AA	Piston
46	See Note 1 222 495	B			Cup Packing
47	222994	B			Plug
48	221738	AA	G-20481	AA	Spring
49	222257	AA-B	222257 (2)	AA	Plug
50	See Note 1 203 207	AA-B	See Note 1 203 205	AA	Valve
51	222201	AA-B	222201	AA	Spring
52	G-17021	AA-B	G-17021	AA	Plug
53	212968	AA-B	212968	AA	Filler Plug Assembly
54	See Note 1 204 242	AA-B	See Note 1 204 242	AA	Copper Gasket
55	See Note 1 203 201	AA-B	See Note 1 203 201	AA	Valve
56	221742	AA-B	221742	AA	Plug
57	See Note 1 203 198	AA-B	See Note 1 203 198	AA	Valve
58	See Note 1 203 197	AA-B	See Note 1 203 197	AA	Valve
59	WH-2151	AA-B	WH-2151	AA	Adapter
60	WH-1841	AA-B	WH-1841	AA	Spring
61	WH-231	AA-B	WH-231	AA	Adj. Nut
62	201733	AA-B	201733	AA	Exp. Plug
63	221937	AA-B	221937	AA	Release Knob
64	221938	AA-B	221938	AA	Roll Pin
65	221781	AA-B	221781	AA	Handle & Cross Bar Assembly
66	221809 (2)	AA-B	221809 (2)	AA	Handle Grip
67	221759	AA-B	221759	AA	Turning Rod
68	204461 (2)	AA-B	204461 (2)	AA	Cotter Pin
69	901246	AA-B	901246	AA	Felt Pad Assembly

No. in parenthesis is amount required.

Note 1 - Repair Kit Item, Order Repair Kit No. URK-107 for J-132 and URK-108 for J-134.

Note 2 - Replace with current ram Assy.

Note 3 - Substitute with current base plus Code Nos. 45, 46, 47, 20, 21, 22 & 23. These parts required to make base completely interchangeable. Customer's should contact nearest Service Depot or Factory Branch for data on exchange program for complete hydraulic power unit.

MODEL J-132 Series AA & B

MODEL J-134 Series AA

Code No.	Part Number		Part Number		Description
	Model J-132	Used on Series	Model J-134	Used on Series	
70	202285 (2)	AA-B	202285 (2)	AA	Rivet
71	G-20851	AA-B	G-20851	AA	Connector Rod
72	G-16861	AA-B	G-16861	AA	Hex Rod
73	901283	AA-B	901283	AA	Hex Tube Assembly
74	901259	AA-B	901259	AA	Plunger Rod & Head Assembly
75	G-12331	AA-B	G-12331	AA	Plunger Head
76	G-21051	AA-B	G-21051	AA	Plunger Rod
77	G-20901	AA-B	G-20901	AA	Retriever Spring
78	200613	AA-B	200613	AA	Pin
79	G-21031	AA-B	G-21031	AA	Extension Rod
80	203332	AA-B	203332	AA	Hex Nut
81	901172	AA-B	901172	AA	Universal Assembly
82	G-16501 (2)	AA-B	G-16501 (2)	AA	Solid End Universal
83	G-21191	AA-B	G-21191	AA	Bolt
84	201784	AA-B	201784	AA	Lockwasher
85	204270 (2)	AA-B	204270 (2)	AA	Washer
86	209964 (2)	AA-B	209964 (2)	AA	Lockwasher
87	203344 (2)	AA-B	203344 (2)	AA	Hex Nut
88	G-2613	AA-B	G-2613	AA	Handle Socket
89	200472 (2)	AA-B	200472 (2)	AA	Bolt
90	214700	AA-B	214700	AA	Handle Segment Assembly
91	221828 (2)	AA-B	221828 (2)	AA	Washer
92	204343 (4)	AA-B	204343 (2)	AA	Washer Handle Ful. Pin
93	221798 (2)	AA-B	221798 (2)	AA	Ret. Ring - Handle Ful. Pin
94	221699 (2)	AA-B	221875 (2)	AA	Caster
95	221796	AA-B	221796	AA	Handle Bumper Pin
96	201110 (2)	AA-B	201110 (2)	AA	Lockwasher
97	203299 (2)	AA-B	203299 (2)	AA	Hex Nut
98	221871 (2)	AA-B	221871 (2)	AA	Set Screw
99	201395 (2)	AA-B	201395 (2)	AA	Cover Screw
100	201785 (2)	AA-B	201785 (2)	AA	Lockwasher
101	221868 (2)	AA-B	221868 (2)	AA	Spacer
102	221870	AA-B	221869	AA	Compression Bar
103	221865 (2)	AA-B	221865 (2)	AA	Sleeve
104	221804	AA-B	221832	AA	L. H. Side Plate
105	221790	AA-B	221822	AA	Fulcrum Pin
106	201478 (2)	AA-B	201479 (2)	AA	Washer
107	203311 (2)	AA-B	203313 (2)	AA	Hex Nut
108	221787	AA-B	221819	AA	Front Axle
109	G-16711	AA-B	G-16711 (3)	AA	Grease Fitting
110	221715 (2)	AA-B	221818 (2)	AA	Front Wheel
111	204324 (4)	AA-B	221778 (4)	AA	Washer
112	219509 (2)	AA-B	219509 (2)	AA	Roll Pin
113			221817 (2)	AA	Tru Ark Ring
114	221793	AA-B	G-7632	AA	Cap Housing
115	221788	AA-B	221788	AA	Lifting Cap
116	221792 (2)	AA-B	221823 (2)	AA	Parallel Link
117	221794	AA-B	221825	AA	Pin
118	G-16751	AA-B	G-16751	AA	Pin
119	221791	AA-B	221824	AA	Bell Crank
120	221802	AA-B	221830	AA	Unit Cover
121	221786 (2)	AA-B	221786 (2)	AA	Screw
122	221801	AA-B	221829	AA	Ram Pin
123	221800 (2)	AA-B	221800 (2)	AA	Pull Back Spring
124	221743	AA-B	210225	AA	Spacer
125	204444 (4)	AA-B	204444 (4)	AA	Cotter Pin
126	216646	AA-B	216646	AA	Pump Pin
127	221799	AA-B	221799	AA	Universal Support Brgs.
128	221795	AA-B	221795	AA	Handle Fulcrum Pin
129	G-17041 (2)	AA-B	G-17041 (2)	AA	Pump Links
130	216645	AA-B	216645	AA	Pump Pin
131	221803	AA-B	221831	AA	R. H. Side Plate
132	213925 (4)	AA-B	221798 (2)	AA	Ret. Ring Parallel Link
133	204303 (2)	AA-B	204303 (2)	AA	Parallel Link Washer
134	222092	AA-B	222100	AA	Ram Assembly
135	222095	AA-B	222095	AA	Release Stem Assembly
136	222090	B	222098	Late AA	Speed Pump Assembly
136A	210248	AA	210275	Early AA	Speed Pump Assembly
137	222214	AA-B	222087	AA	Pressure Pump Assembly
138	222091	AA-B	222099	AA	Bell Crank Assembly
139	213704	AA-B	213704	AA	Universal Assembly
140	222094	AA-B	222094	AA	Handle Assembly
141	204463 (2)	B	204465 (2)	Late AA	Cotter Pin
141	214557 (2)	AA	221820 (2)	Early AA	Ret. Ring Front Axle
142	210411	AA-B	210411	AA	Washer
143	WH-201	AA-B	WH-201	AA	Spring
144	211341	AA-B	211341	AA	Rivet

No. in parenthesis is amount required.

ORDER BY PART NUMBER, NOT BY CODE NUMBER  
SEE BACK PAGE FOR COMPLETE NUMERICAL LISTING

December 1965

CONFIDENTIAL - For Service Depot Use

MODELS J-132 & J-134 *AA*

Repair Kit Items Deleted From Parts Manual (1964)

<u>Code No.</u>	<i>SERIES AA, B, D</i>	<i>SERIES AA, C</i>	<u>Description</u>
	<u>J-132 Part No.</u>	<u>J-134 Part No.</u>	
2 (2)	<del>222063</del> -226001	<del>222068</del> -226002	Ram Packing
8	203199	203199	Valve
10	<del>221753</del> 228256	<del>221769</del> 228257	Ram Cup, <i>yellow</i>
21	214555	-	"O" Ring
25 (2)	222210	213152	Packing Ring
29	WH 9611 (226397)	218542	Rubber Washer
30 (3)	201826	201827	"V" Packing
33 (2)	213165	213171	Packing Ring
36	221757 (6248-19)	221771	BACK-UP TRIMS (WASHER)
37	221758 Q-19	221772	Quad Ring
37A	218123 (FOR SPEED PUMP)	200501	Cup Leather
41	214555	214555	"O" Ring
43	203200	203200	Valve
46	222995	-	Cup Packing
50	203207	203205	Valve
54	204842	204842	Copper Gasket
55	203201	203201	Valve
57	203198	203198	Valve
58	203197	203197	Valve

Service Division

Walker Manufacturing Company