

**WALKER**

**SERVICE  
DIVISION**

**Jack Parts Sheet**

**MODEL 93662  
SERIES "A", "B" & "C"**

*Retain for file.*

**10 TON CAPACITY**

AIR-HYDRAULIC SERVICE JACK

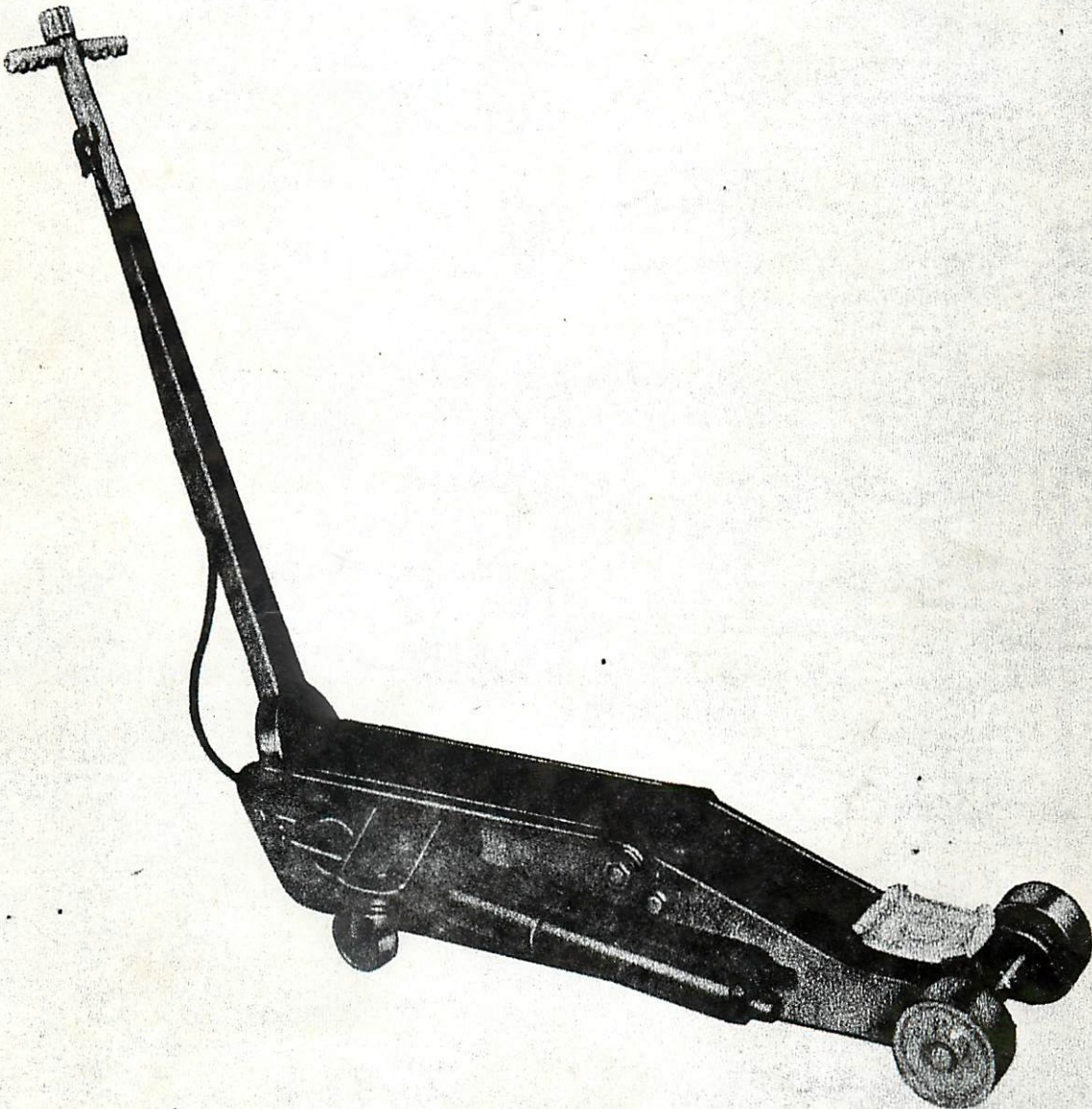

**SERVICE**

We have Factory-owned BRANCHES AND AUTHORIZED SERVICE DEPOTS located in the principal cities of the United States and Canada. They are operated by FACTORY TRAINED STAFFS and carry a comprehensive stock of REPAIR PARTS. Please contact the Factory or your Walker DISTRIBUTOR for location of Branch or Service Depot nearest you.

**Walker Manufacturing** GENERAL OFFICE: Racine, Wisconsin — MANUFACTURING PLANT AND SERVICE DEPARTMENT: Jonesboro, Arkansas — FACTORY SERVICE BRANCHES: Atlanta, Georgia — Cleveland, Ohio — Kansas City (Riverside), Missouri — Philadelphia, Pennsylvania — Sacramento, California.

**MODEL 93662  
SERIES "A", "B" & "C"**

NOTE: TIGHTEN TO  
450-550 FT. LBS.

NOTE: TIGHTEN TO  
125-175 FT. LBS.

EARLY SERIES  
HANDLE PIN

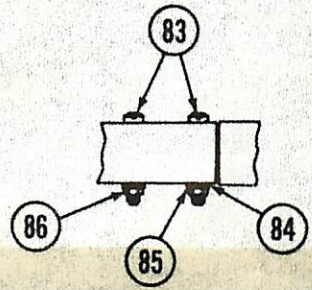
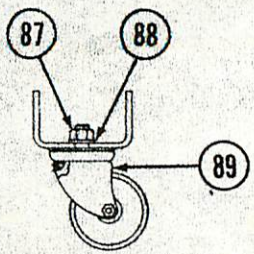
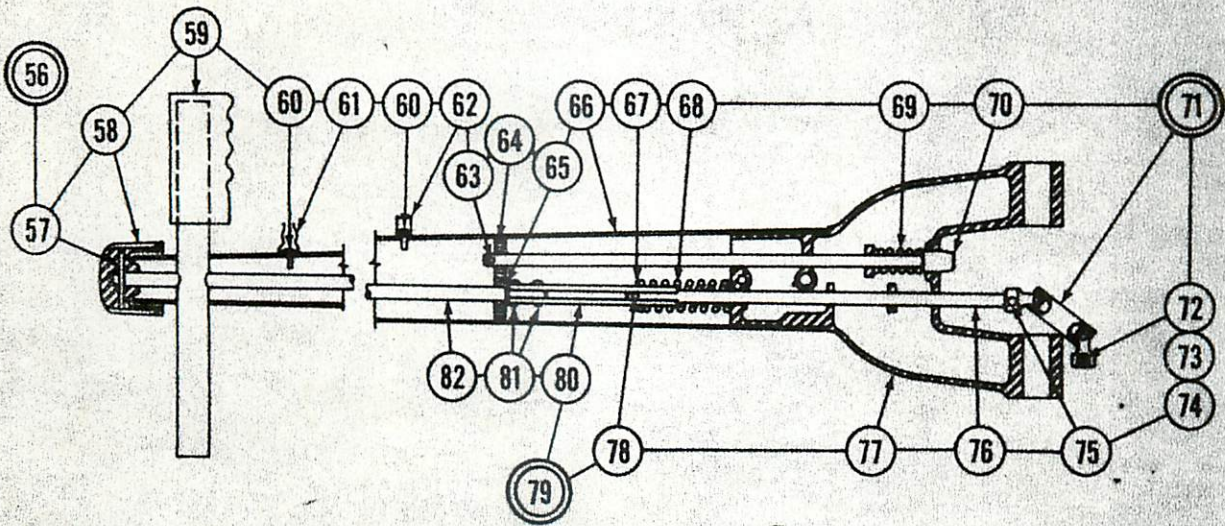
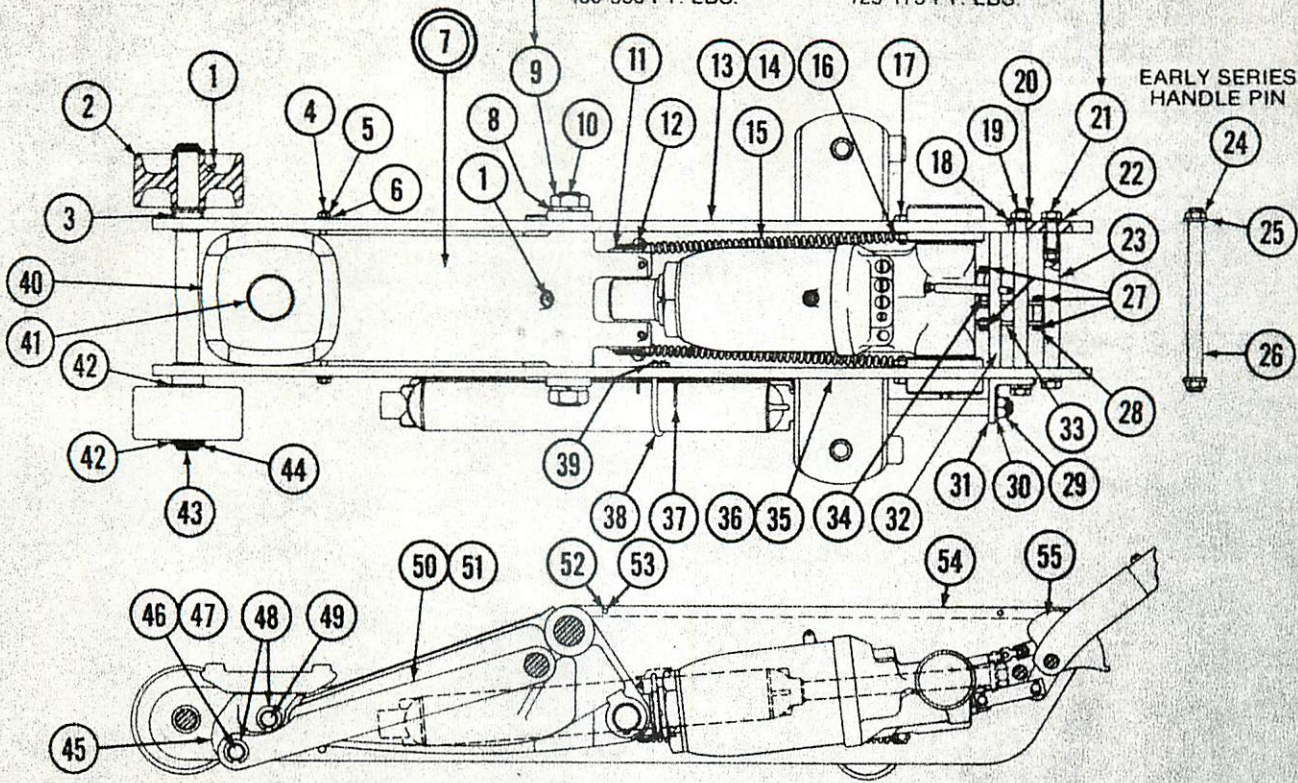

**TRI-CITY HYDRAULIC JACK SERVICE**  
 4628 N. Florida Avenue  
 Tampa, Florida 33603-3700  
 (813) 236-8551

**ORDER BY PART NUMBER, NOT BY CODE NUMBER**

**MODEL 93662**  
**SERIES "A", "B" & "C"**

| Code No. | Part No. | Description            | Series   | No. Req'd | Code No. | Part No. | Description                   | Series   | No. Req'd |
|----------|----------|------------------------|----------|-----------|----------|----------|-------------------------------|----------|-----------|
| 1        | 226318   | Grease Fittings        | A, B & C | 5         | 46       | 229936   | Pin                           | A        | 1         |
| 2        | 231963   | Wheel                  | A, B & C | 2         | 47       | 231431   | Pin                           | B & C    | 1         |
| 3        | 217653   | Roll Pin               | A, B & C | 2         | 48       | 229947   | Retaining Ring                | A, B & C | 4         |
| 4        | 229938   | Pin                    | A, B & C | 1         | 49       | 229946   | Pin                           | A, B & C | 1         |
| 5        | 207169   | Nut                    | A, B & C | 2         | 50       | 229941   | Parallel Link                 | A        | 2         |
| 6        | 201789   | Lock Washer            | A, B & C | 2         | 51       | 231430   | Parallel Link                 | B & C    | 2         |
| 7        | 231474   | Lifting Arm Ass'y      | A, B & C | 1         | 52       | 201785   | Lockwasher                    | A, B & C | 4         |
| 8        | 201481   | Lock Washer            | A, B & C | 2         | 53       | 211567   | Screw                         | A, B & C | 4         |
| 9        | 203323   | Nut                    | A, B & C | 2         | 54       | 229954   | Unit Cover                    | A, B & C | 1         |
| 10       | 226271   | Fulcrum Pin            | A, B & C | 1         | 55       | 214700   | Handle Segment & Bushing      | A, B & C | 1         |
| 11       | 229910   | Retaining Ring         | A, B & C | 2         | 56       | 231990   | Handle Ass'y -- Complete      | A, B & C | 1         |
| 12       | 229933   | Pull Back Plate        | A, B & C | 2         | 57       | 221938   | Roll Pin                      | A, B & C | 1         |
| 13       | 230012   | R.H. Side Plate Ass'y  | A        | 1         | 58       | 221937   | Release Knob                  | A, B & C | 1         |
| 14       | 231424   | R.H. Side Plate Ass'y  | B & C    | 1         | 59       | 221809   | Handle Grip                   | A, B & C | 2         |
| 15       | 229932   | Pull Back Spring       | A, B & C | 2         | 60       | 224081   | Screw                         | A, B & C | 2         |
| 16       | 203272   | Nut                    | A, B & C | 2         | 61       | 223172   | Hose Clip                     | A, B & C | 1         |
| 17       | 212689   | Bolt                   | A, B & C | 2         | 62       | 223179   | Hose Clamp                    | A, B & C | 2         |
| 18       | 201110   | Lockwasher             | A, B & C | 2         | 63       | 204461   | Cotter Pin                    | A, B & C | 1         |
| 19       | 230006   | Bumper Pin             | A, B & C | 1         | 64       | 227397   | Link                          | A, B & C | 1         |
| 20       | 203299   | Nut                    | A, B & C | 2         | 65       | 204277   | Washer                        | A, B & C | 1         |
| 21       | 231420   | Bolt                   | B & C    | 2         | 66       | 230220   | Handle & Cross Bar Ass'y      | A, B & C | 1         |
| 22       | 201110   | Lockwasher             | B & C    | 2         | 67       | 204303   | Washer                        | A, B & C | 1         |
| 23       | 231419   | Handle Fulcrum Pin     | B & C    | 1         | 68       | 228875   | Spring                        | A, B & C | 1         |
| 24       | 219451   | Nut                    | A        | 2         | 69       | 226372   | Spring                        | A, B & C | 1         |
| 25       | 201477   | Lockwasher             | A        | 2         | 70       | 229952   | Plunger Rod & Head Ass'y      | A, B & C | 1         |
| 26       | 229940   | Handle Fulcrum Pin     | A        | 1         | 71       | 213704   | Universal Ass'y <i>228354</i> | A, B & C | 1         |
| 27       | 204444   | Cotter Pin             | A, B & C | 4         | 72       | 201784   | Lockwasher                    | A, B & C | 1         |
| 28       | 216645   | Pin                    | A, B & C | 1         | 73       | 203332   | Nut                           | A, B & C | 1         |
| 29       | 203301   | Nut                    | A, B & C | 1         | 74       | 226366   | Bolt                          | A, B & C | 1         |
| 30       | 227713   | Lockwasher             | A, B & C | 1         | 75       | 211341   | Rivet                         | A, B & C | 1         |
| 31       | 230008   | Bracket                | A, B & C | 1         | 76       | 229951   | Rod                           | A, B & C | 1         |
| 32       | 229929   | Universal Support Brg. | A, B & C | 1         | 77       | 229949   | Handle Socket                 | A, B & C | 1         |
| 33       | 226325   | Link                   | A, B & C | 2         | 78       | 218988   | Roll Pin                      | A, B & C | 1         |
| 34       | 210225   | Pump Link Spacer       | A, B & C | 1         | 79       | 227436   | Turning Rod Ass'y             | A, B & C | 1         |
| 35       | 230013   | L.H. Side Plate Ass'y  | A        | 1         | 80       | 227398   | Slide Rods                    | A, B & C | 2         |
| 36       | 231425   | L.H. Side Plate Ass'y  | B & C    | 1         | 81       | 202294   | Rivets                        | A, B & C | 2         |
| 37       | 225906   | Bracket                | A, B & C | 1         | 82       | 227400   | Rod                           | A, B & C | 1         |
| 38       | 230007   | Hanger                 | A, B & C | 1         | 83       | 200472   | Bolt                          | A, B & C | 2         |
| 39       | 226019   | Lock Nut               | A, B & C | 2         | 84       | 204270   | Washer                        | A, B & C | 2         |
| 40       | 232619   | Lifting Cap            | A, B & C | 1         | 85       | 209964   | Lockwasher                    | A, B & C | 2         |
| 41       | 232620   | Swivel Pin             | A, B & C | 1         | 86       | 203344   | Nut                           | A, B & C | 2         |
| 42       | 229912   | Washer                 | A, B & C | 4         | 87       | 203297   | Nut                           | A, B & C | 2         |
| 43       | 229939   | Axle                   | A, B & C | 1         | 88       | 201115   | Lockwasher                    | A, B & C | 2         |
| 44       | 229911   | Retaining Ring         | A, B & C | 2         | 89       | 230010   | Caster                        | A, B & C | 2         |
| 45       | 229927   | Cap Housing            | A, B & C | 1         |          |          |                               |          |           |



**TRI-CITY HYDRAULIC JACK SERVICE**

4628 N. Florida Avenue  
Tampa, Florida 33603-3700  
(813) 236-8551

**ORDER BY PART NUMBER, NOT CODE NUMBER**  
**SEE BACK PAGE FOR COMPLETE NUMERICAL LISTING**

## SERVICE ADJUSTMENT PROCEDURE - 229999 AIR HYDRAULIC PUMP

- I. If Air-Hydraulic Jack will not lift but **sounds** normal:
  - A. It is probably air bound. To correct, tip jack on its left side (as viewed from handle end) and cycle the air pump slowly.
  - B. The Hydramatic valve might be stuck open. To check, open release, pull bellcrank up to full height by hand, close the release valve while at full height and let go of the bellcrank. If it returns to low position, the trouble is in the hydraulic unit. If it holds position, lower the jack and try to make a lift with the air pump. If successful, the trouble was in the Hydramatic and raising the bellcrank by hand corrected it.
- II. If Air-Hydraulic Jack will not lift and does **not** sound normal, look for the following:
  - A. If the air pump is cycling unusually fast:
    1. The jack may be air bound.
    2. The suction ball in the hydraulic unit may not be seating.
  - B. If the air pump is not cycling at all, but air can be heard rushing out the exhaust port, the air pump should be removed and checked for the following:
    1. Rubber bumper on cushion spring may have been dislodged from the spring.
    2. The valve plunger assembly 223187 may be stuck open.
    3. The two weep holes in the pump retainer plug 223183 may be plugged with dirt.
    4. The return spring 223173 may be broken.
  - C. If the air pump is not cycling at all and no air is coming out of the exhaust, check for the following:
    1. The pump rod 231619 may be frozen in its packing gland.
    2. The Valve Plunger Assembly 223187 is not opening. Look for a bent Trip Washer or a bent or rusted Valve Plunger which has seized in the piston.
- III. If the jack will raise a load but much more slowly than normal, the trouble is almost certainly related to the air pump. Look for the following:
  - A. If the pump cycles very slowly:
    1. There may be a restriction in the air line between the air valve and the air pump.
    2. One of the weep holes in the 223183 Pump Retainer Plug may be plugged.
  - B. If the pump cycles very rapidly:
    1. The 225384 Trip Spring may be deformed or broken.