

# Hydraulic Floor Service Jack

Model: 401

Owner's Manual and  
Spare Parts List

2 ton  
Capacity



# VIKING

## Important

Please read these instructions carefully before using your jack.

Proper use and care of the jack will help to assure you of continuous, safe, trouble free performance.

## QUALITY GUARANTEE LIMITED WARRANTY.



INTERMARKET INC WARRANTS, to the final purchaser, jacks and related service equipment distributed by it to be free from defects in material and workmanship for a period of 90 days from date of sale.

If a jack or related equipment is determined to be defective during the warranty period, it will be repaired or replaced without charge provided that the equipment is shipped, transportation charges prepaid, with proof of date of purchase, to INTERMARKET INC. or to a designated field service depot.

This warranty does not apply to parts damaged from accident, overload, or abuse, nor does it apply to any product which has been altered or used with special attachments other than recommended by the distributor or their equivalent.

THERE ARE NO OTHER WARRANTIES OF ANY SORT; EXPRESS OR IMPLIED, AND SELLER SPECIFICALLY DISCLAIMS ANY WARRANTY OF MERCHANTABILITY OR OF FITNESS FOR ANY PARTICULAR PURPOSE. THE SELLER'S SOLE OBLIGATION, WHICH SHALL REPRESENT THE BUYER'S SOLE AND EXCLUSIVE REMEDY, SHALL BE TO REPAIR OR AT THE SELLER'S OPTION TO REPLACE ANY PRODUCT OR PART DETERMINED TO BE DEFECTIVE AS AFORESAID. IN NO EVENT SHALL THE SELLER BE LIABLE FOR ANY SPECIAL, DIRECT, INDIRECT, INCIDENTAL, CONSEQUENTIAL OR OTHER DAMAGES OF A SIMILAR NATURE, INCLUDING, WITHOUT LIMITATION, LOSS OF PROFITS OR OF PRODUCTION TIME, OR LOSS OR EXPENSES OF ANY NATURE, INCURRED BY THE BUYER OR ANY THIRD PARTY.



Catalog Nr. 054209

26 CORPORATE CIRCLE, P.O. BOX 519  
GUILDERLAND, NEW YORK, 12084, USA

# Owner's Manual and Spare Parts List

Issued: September, 1987



**TRI-CITY HYDRAULIC JACK SERVICE**

4628 N. Florida Avenue  
Tampa, Florida 33603-3700  
(813) 236-8551

REF.	PART NAME	QTY	PART NR.
01	O'Ring	01	862214
02	Head Nut	01	981022
03	O'Ring	01	862038
04	Lift Piston	01	690021
04C	Lift Piston Compl (4and5)	01	691021
05	Cup	01	832326
06	Cylinder	01	916022
07	Oil Reservoir	01	969022
08	Rubber Plug	01	893101
09	O'Ring	01	862040
10	O'Ring	01	862131
11	Washer	01	905019
12	Oil Filter	01	828010
13	Overload Valve	01	699018
14	Ball	03	824030
15	Pump Housing	01	907021
16	Packing	01	883205
17	Release Screw	01	688018
18	Track Ring	10	804012
19	Axle	01	927091
20	Pump Piston	01	689017
20C	Pump Piston, Compl (20thru23)	01	689019
21	Dust Seal	01	835010
22	O'Ring	01	862115
23	Cup	01	832313
24	Pump Cylinder	01	915011
25	O'Ring	01	862120
26	Washer	01	905011
27	Oil Filter	01	828011
28	Track Ring	01	804005
29	Pump Beam	01	929024
30	Spring	01	856133
31	Pin	01	960052
32	Axle	01	927086
33	Spring (Pair)	01	686800
34	Axle	01	927088
35	Frame	01	684026
36	Axle	02	927137
37	Track Ring	02	804122
38	Bolt	02	866103
39	Washer	02	806020
40	Caster	02	693018
41	Track Ring	02	804015
42	Washer	02	905018
43	Wheel	02	973012
44	Axle	01	927089
45	Link	02	983029
46	Carrier	01	694022
47	Saddle	01	670020
48	Axle	01	927087
49	Lift Arm	01	675022
49C	Lift Arm Compl.	01	676022
50	Tension Pin	01	871019
51	Spring	01	856677
52	Cover	01	921025
53	Nut	01	873200
54	Bolt	01	866227
55	Handle, Compl. (53thru55)	01	678022
	Repair Kit (1,3,5,8,9,10,16, 21,22,23,25)		683020
	Hydraulic Unit.(1thru17, 20thru 27)		696021
	Hydraulic Unit. Compl. (1thru 34)		697024

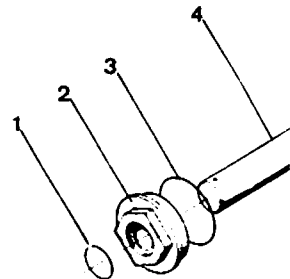
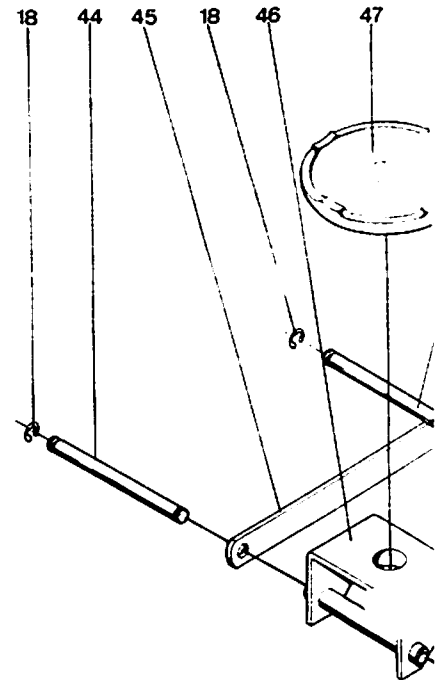



## TRI-CITY HYDRAULIC JACK SERVICE

4628 N. Florida Avenue  
Tampa, Florida 33603-3700  
(813) 236-8551



# VIKING

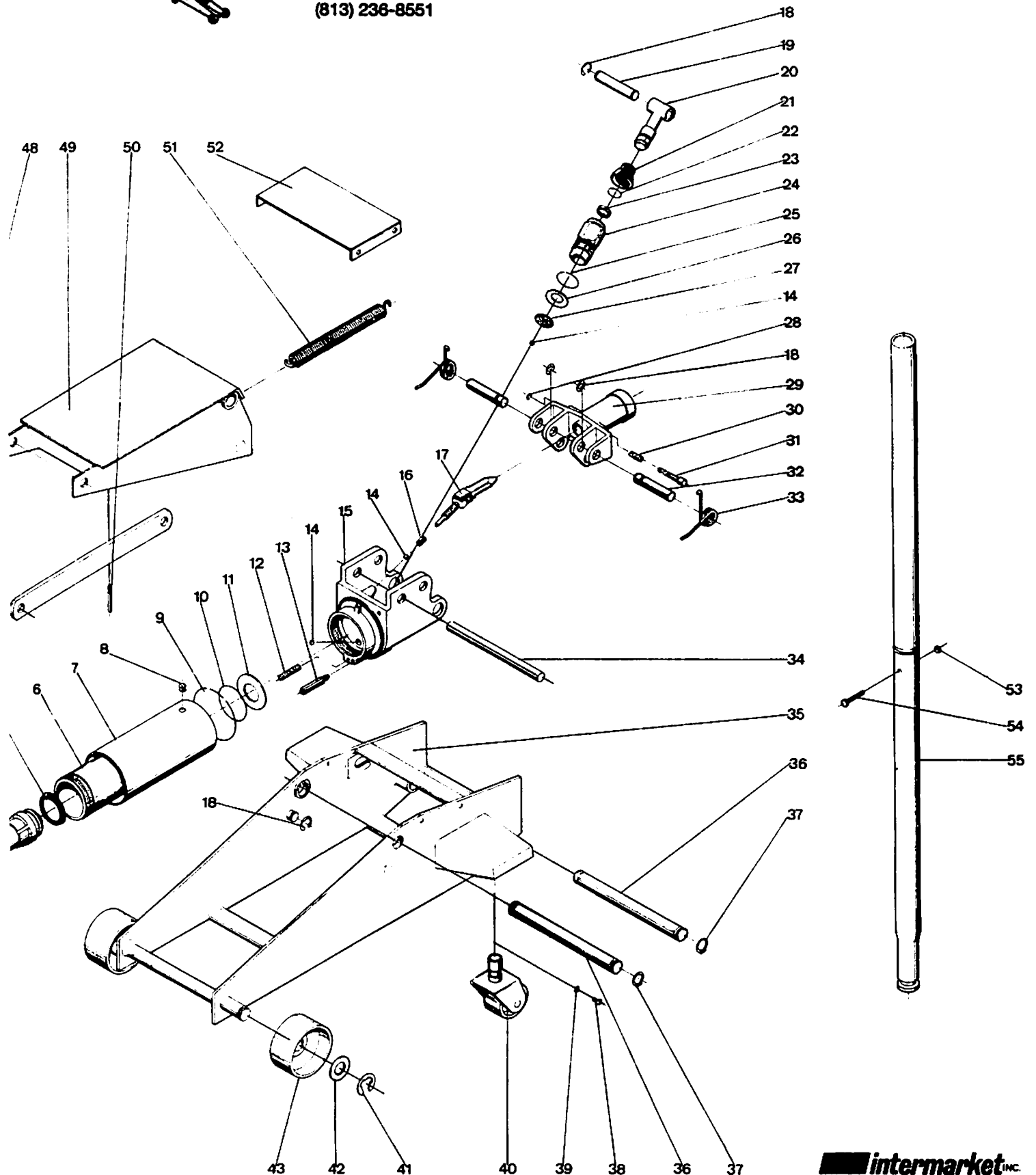

**intermarket** inc.

26 Corporate Circle, P.O. Box 519  
Guilderland, New York, 12084, USA

# Hydraulic Floor Service Jack

## Owner's Manual and Spare Parts List



26 Corporate Circle, P.O. Box 519  
Guilderland, New York, 12084, USA

### Handle Assembly Instructions

1. Remove bolt (ref. 54) and insert top section into bottom section
2. Align bolt holes and insert bolt through handle, install nut (ref. 61) and tighten.
3. Holding quick release handle pin (ref. 31) pulled insert handle into pump beam.  
Be sure release valve shaft is properly aligned with square hole in bottom of handle.
4. Handle must rotate freely for proper release valve operation.
5. Pull pin (ref. 31) to remove handle.

### Safety Rules

1. Use jack on solid flat surface only. Jack wheels must be permitted to roll during operation.
2. Set parking brake and block wheels of vehicle before raising.
3. Use factory recommended vehicle lifting points only.
4. Center lifting point on jack saddle to prevent slipping.
5. Do not drive off raised jack, damage to both vehicle and jack could occur.
6. JACKS ARE DESIGNED STRICTLY FOR LIFTING. WHEN WORKING  
UNDER A RAISED VEHICLE ALWAYS USE GARAGE STANDS TO SUPPORT VEHICLE.

### Operating Instructions

#### To Raise

1. Position jack correctly under vehicle to be raised.
2. Close release valve by turning handle clockwise (right) until snug.  
DO NOT OVERTIGHTEN.
3. Pump handle until saddle reaches jacking point.
4. Check to be sure jacking point is centered on saddle between slip lugs.
5. Pump handle until desired height is reached.

#### To Lower

1. Slowly turn handle counter-clockwise (left) to open release valve.
2. Lowering speed is controlled by the amount the release valve is opened.

### Maintenance

1. Store jack in fully lowered position in a dry, clean location.
2. Lubricate frequently all axles, external screws and bearing surfaces.
3. Inspect lift and pump piston frequently for rust or corrosion. Clean as needed and wipe with oily cloth.

### Service

1. Poor lifting performance may be caused by air in the hydraulic system from shipment and handling. To correct this situation all air must be purged using the following procedure:  
open release valve fully by turning handle (or release control knob) counter-clockwise (left).  
Using full stroke pump handle several times to remove all air.