

Hydraulic Floor Service Jack

Owner's Manual and
Spare Parts List

Model 400

2¼ TON
Capacity



VIKING

Important

Please read these instructions carefully before using your jack.

Proper use and care of the jack will help to assure you of continuous, safe, trouble free performance

QUALITY GUARANTEE

LIMITED WARRANTY



INTERMARKET INC WARRANTS, to the final purchaser, jacks and related service equipment distributed by it to be free from defects in material and workmanship for a period of 90 days from date of sale.

If a jack or related equipment is determined to be defective during the warranty period, it will be repaired or replaced without charge provided that the equipment is shipped, transportation charges prepaid, with proof of date of purchase, to INTERMARKET INC. or to a designated field service depot.

This warranty does not apply to parts damaged from accident, overload, or abuse, nor does it apply to any product which has been altered or used with especial attachments other than recommended by the distributor or their equivalent.

THERE ARE NO OTHER WARRANTIES OF ANY SORT; EXPRESS OR IMPLIED, AND SELLER ESPECIFICALLY DISCLAIMS ANY WARRANTY OF MERCHANTABILITY OR OF FITNESS FOR ANY PARTICULAR PURPOSE. THE SELLER'S SOLE OBLIGATION, WHICH SHALL REPRESENT THE BUYER'S SOLE AND EXCLUSIVE REMEDY, SHALL BE TO REPAIR OR AT THE SELLER'S OPTION TO REPLACE ANY PRODUCT OR PART DETERMINED TO BE DEFECTIVE AS AFORESAID. IN NO EVENT SHALL THE SELLER BE LIABLE FOR ANY SPECIAL, DIRECT, INDIRECT, INCIDENTAL, CONSEQUENTIAL OR OTHER DAMAGES OF A SIMILAR NATURE, INCLUDING, WITHOUT LIMITATION, LOSS OF PROFITS OR OF PRODUCTION TIME, OR LOSS OR EXPENSES OF ANY NATURE, INCURRED BY THE BUYER OR ANY THIRD PARTY.



Owner's Manual and Spare Parts List

MOD. 400 2 1/4

Issued: April, 1st 87



TRI-CITY HYDRAULIC JACK SERVICE

4628 N. Florida Avenue
Tampa, Florida 33603-3700
(813) 236-8551

REF NR.	PART NAME \	PART NR.	
		QTY	MOD. 400
01	O Ring	01	862218
02	Head Nut	01	981010
03	O Ring	01	862040
04	Lift Piston	01	690019
04C	Lift Piston, Compl (04 and 05)	01	691019
05	Cup	01	832430
06	Cylinder Tube	01	916011
07	Tank Tube	01	969011
08	Plug, Rubber	01	893101
09	O Ring	01	862043
10	O Ring	01	862137
11	Washer	01	905010
12	Oil Filter	01	828010
13	Overload Valve	01	699018
14	Ball	03	824030
15	Pump Housing	01	907010
16	Packing	01	883205
17	Release Valve Shaft	01	688018
18	Track Ring	06	804012
19	Axle	01	927091
20	Pump Piston	01	689017
20C	Pump Piston, Compl (20 Thru 23)	01	689019
21	Dust Seal	01	835010
22	O Ring	01	862115
23	Cup	01	832313
24	Pump Cylinder	01	915011
25	O Ring	01	862120
26	Washer	01	905011
27	Oil Filter	01	828011
28	Bolt	02	866207
29	Washer	02	806030
30	Pump Beam	01	929021
31	Axle	02	927092
32	Spring (Pair)	01	686800
33	Axle	01	927095
34	Axle	02	927070
35	Washer	04	806050
36	Nut	04	873400
37	Axle	01	927150
38	Track Ring	02	804125
39	Bolt	02	866103
40	Washer	02	806020
41	Nut	02	873700
42	Washer	02	806110
43	Caster	02	693018
44	Axle	01	927151
45	Nut	02	873601
46	Washer	02	806090
47	Spacer	02	910151
48	Wheel	02	973010
49	Axle	01	927130
50	Frame (Pair)	01	684024
51	Track Ring	06	804012
52	Axle	01	927094
53	Saddle Carrier	01	694018
54	Saddle	01	670018
55	Axle	01	927093
56	Link	02	983030
57	Lift Arm	01	675023
57C	Lift Arm, Compl (51, 52, 53, 55, 56, 57)	01	676023
58	Tension Pin	01	871024
59	Spring	02	856677
60	Cover	01	921022
61	Nut	01	873200
62	Bolt	01	866227
63	Handle, Compl	01	678022
	Repair Kit (1, 3, 5, 8, 9, 10, 16, 21, 22, 23, 25)		683012
	Hydraulic Unit (1 Thru 17, 20 Thru 27)		696019
	Hydraulic Unit, Compl (1 Thru 33)		697020

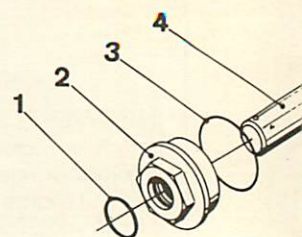
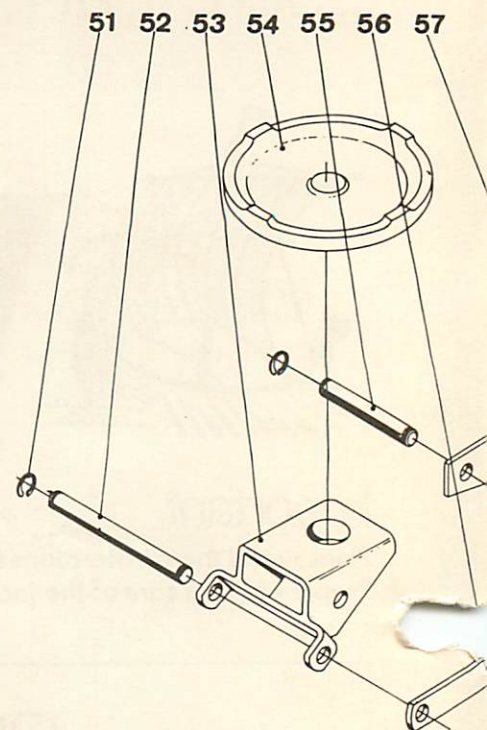



TRI-CITY HYDRAULIC JACK SERVICE
4628 N. Florida Avenue
Tampa, Florida 33603-3700
(813) 236-8551



2 1/4 TON VIKING MOD. 400

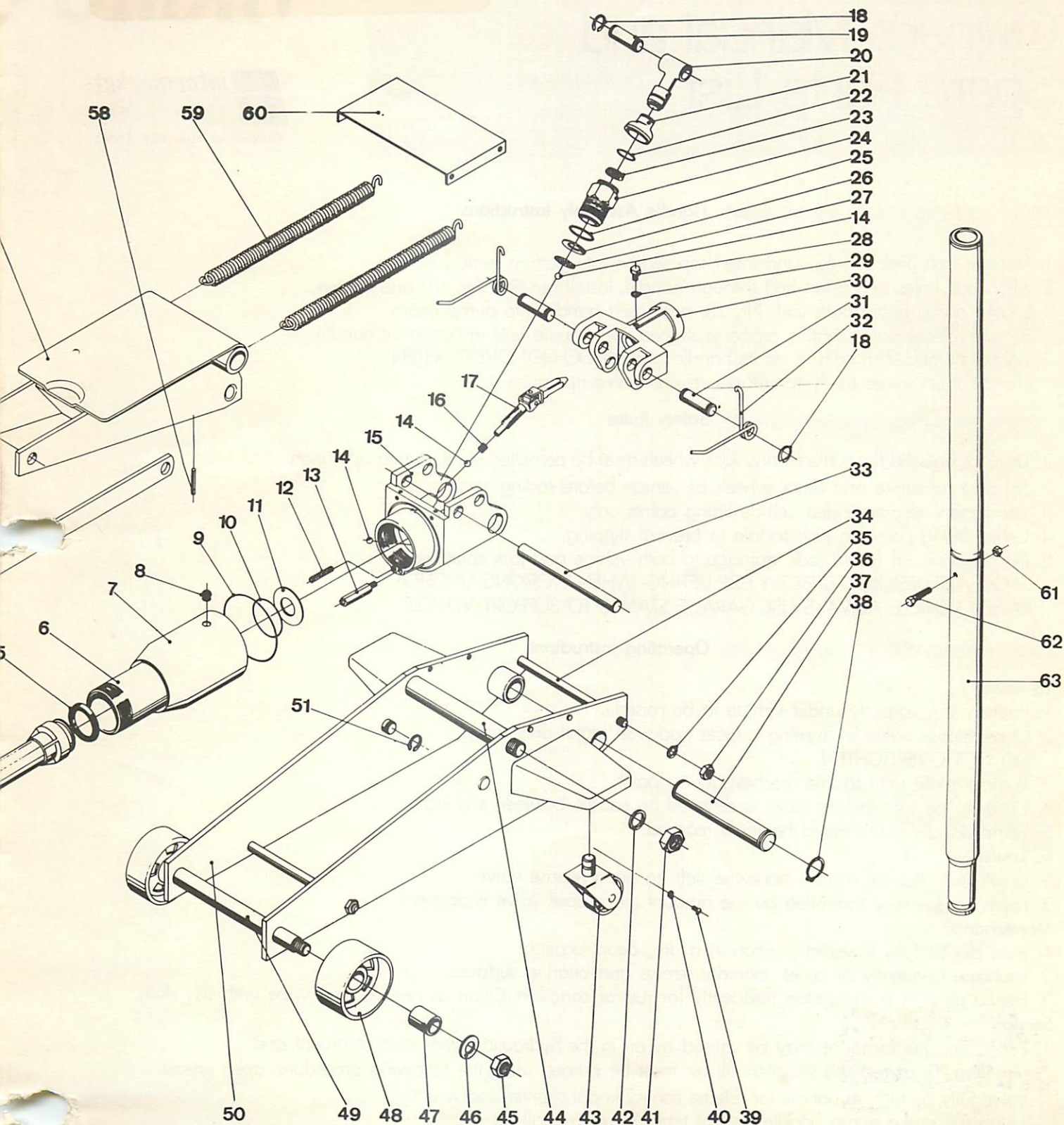

Hydraulic Floor Service Jack

Owner's Manual and Spare Parts List



Guilford, New York, 12084

Handle Assembly Instructions

1. Remove bolt (Ref. Nr. 62) and insert top section into bottom section.
2. Align bolt holes and insert bolt through handle, install nut (Ref. Nr. 61) and tighten.
3. Loosen pump beam bolts (Ref. Nr. 28) and insert handle into pump beam.
Be sure release valve shaft is properly aligned with square hole in bottom of handle.
4. Tighten pump beam bolts to secure handle in place. DO NOT OVERTIGHTEN.
Handle must rotate freely for proper release valve operation.

Safety Rules

1. Use jack on solid flat surface only. Jack wheels must be permitted to roll during operation.
2. Set parking brake and block wheels of vehicle before raising.
3. Use factory recommended vehicle lifting points only.
4. Center lifting point on jack saddle to prevent slipping.
5. Do not drive off raised jack, damage to both vehicle and jack could occur.
6. JACKS ARE DESIGNED STRICTLY FOR LIFTING. WHEN WORKING UNDER A RAISED VEHICLE ALWAYS USE GARAGE STANDS TO SUPPORT VEHICLE.

Operating Instructions

To Raise

1. Position jack correctly under vehicle to be raised.
2. Close release valve by turning handle clockwise (right) until snug.
DO NOT OVERTIGHTEN.
3. Pump handle until saddle reaches jacking point.
4. Check to be sure jacking point is centered on saddle between slip lugs.
5. Pump handle until desired height is reached.

To Lower

1. Slowly turn handle counter-clockwise (left) to open release valve.
2. Lowering speed is controlled by the amount the release valve is opened.

Maintenance

1. Store jack in fully lowered position in a dry, clean location.
2. Lubricate frequently all axles, external screws and bearing surfaces.
3. Inspect lift and pump piston frequently for rust or corrosion. Clean as needed and wipe with oily cloth.

Service

1. Poor lifting performance may be caused by air in the hydraulic system from shipment and handling. To correct this situation all air must be purged using the following procedure: open release valve fully by turning handle (or release control knob) counter-clockwise (left).
Using full stroke pump handle several times to remove all air.