

VIKING No. 303 HC

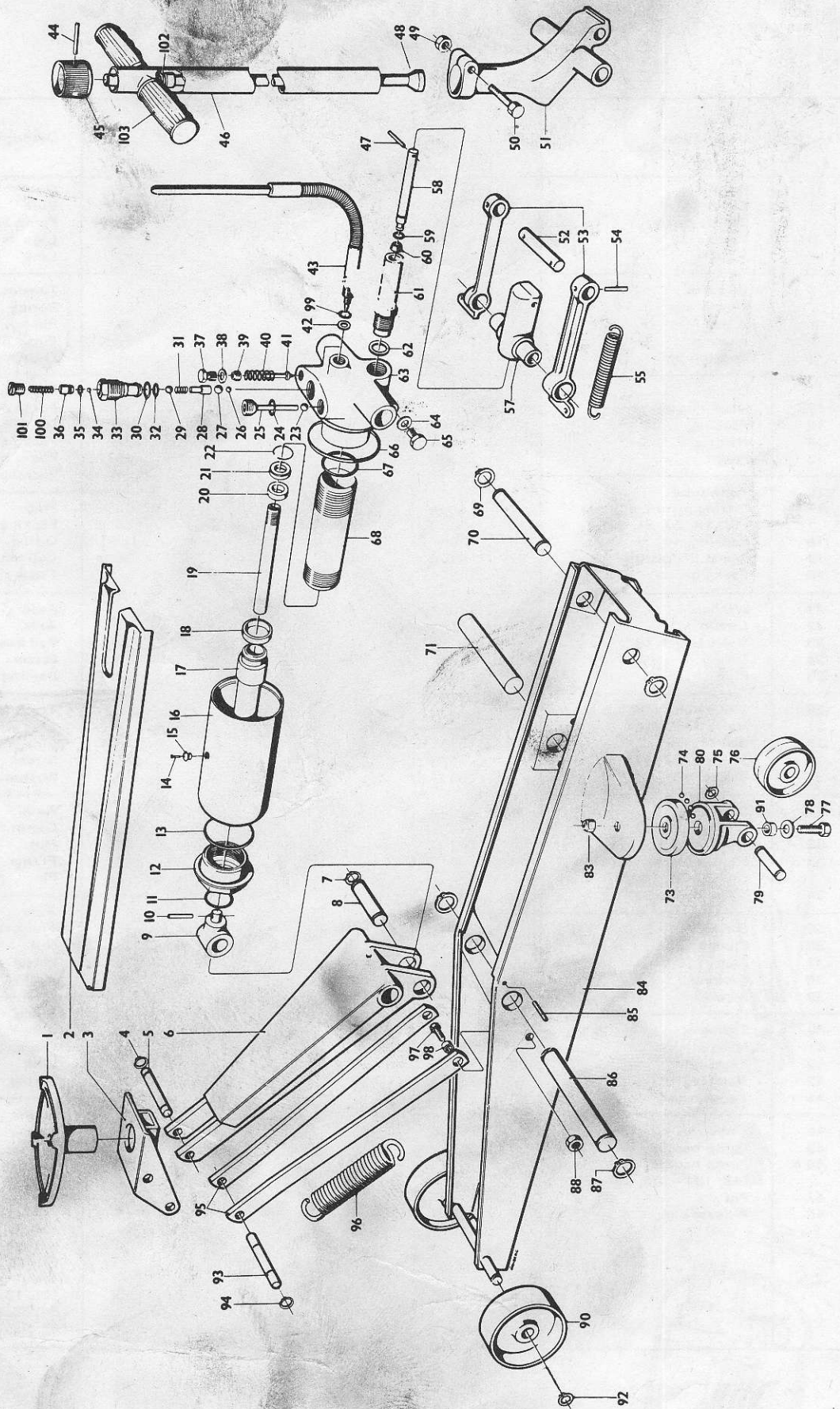

SPARE PARTS LIST

VIKING No. 303 HC

Capacity 3 tons

Ref. No.	Description	Qty.	Part. No.	Ref. No.	Description	Qty.	Part. No.
1	Saddle	1	13606	49	Nut	1	14931
2	Cover	1	13435	50	Bolt	1	16117
3	Saddle carrier	1	13266	51	Pump arm	1	13297
4	Track ring	2	13900	52	Link axle	1	13223
5	Axle	1	16433	53	Link	2	13193
6	Lift arm	1	13265	54	Tension pin	2	10159
7	Track ring	2	13902	55	Spring	2	13250
8	Axle	1	16435	57	Pin housing	1	13446
9	Bearing	1	13416	58 K	Pump piston, compl. (58-60)	1	13963
10	Tension pin	1	10413	59	O-ring	1	13815
11	O-ring	1	14079	60	Packing	1	8288
12	Head nut	1	13940	61 K	Pump cylinder, compl. (47, 58-61)	1	19733
13	Packing	1	9047	62	Packing	1	10406
14	Rivet	1	20266	63	Pump housing	1	14238
15	Plug	1	20253	64	Packing	1	16118
16	Tank tube	1	13540	65	Plug	1	16536
17 K	Lifting piston, compl. (17, 18, 20, 21, 22)	1	13584	66	Packing	1	4069
18	Packing	1	13615	67	O-ring	1	5046
19	Speed lift piston	1	14806	68	Cylinder tube	1	14076
20	Packing	1	14804	69	Track ring	2	13900
21	Washer	1	14803	70	Axle	1	13516
22	Circlip	1	14805	71	Axle	1	13514
23	Valve ball 7/16"	1	10412	72	Ball bearing cup	2	13427
24	O-ring	1	12717	73	Screw	4	13218
25	Plug	1	14088	74	Bearing ball 1/4"	33	6824
26	Valve ball 5/16"	1	3740	75	Track ring	2	13904
27	Valve ball 7/16"	1	10412	76	Link wheel	2	8968
28	Ball bracket	1	16446	76 K	Link wheel, compl. (74-83)	2	13320
29	Valve ball 7/32"	1	5494	77	Screw	2	13422
30	O-ring	1	16584	78	Washer	2	13835
31	Spring	1	23035	79	Axle	2	16428
32	O-ring	1	12717	80	Castor fork	2	20352
33	Housing	1	20109	83	Nut	2	22554
33 K	High speed valve, compl. (30, 32-36, 100, 101)	1	20112	84	Frame	1	13398
34	Valve ball 5/32"	1	16060	85	Pin	2	13561
35	O-ring	1	20111	86	Axle	1	13514
36	Plunge	1	20110	87	Track ring	2	13902
37	Plug	1	16536	88	Nut	2	22555
38	Packing	1	16118	90	Wheel	2	16786
39	Screw	1	8350	91	Washer	2	13062
40	Spring	1	8429	92	Track ring	2	13901
41	Needle	1	8351	93	Axle	1	16434
42	Packing	1	11286	94	Track ring	2	13900
43	Release shaft	1	14044	95	Link	2	13280
44	Tension pin	1	13561	96	Spring	1	13612
45	Knob	1	20209	97	Screw	2	13547
46	Pump handle	1	20222	98	Spacer	2	13281
46 K	Pump handle, compl. (48, 101-103, 44-46)	1	20224	99	O-ring	1	7594
47	Pin	1	11117	100	Spring	1	19096
48	Release bar	1	20217	101	Plug	1	15799
				102	Washer	1	20076
				103	Handle	2	15058
					Hydraulic unit, compl. (11-43, 47, 58-68, 99, 100)	1	13583
					Repair kit (11, 13, 14, 18, 20, 24, 30, 34, 38, 59, 60, 62, 64, 66, 67, 99)	1	17468

1.000 77-06 TunaTrack 11280



VIKING

See other side for model breakdown illustration

IMPORTANT
ORDER BY PART NUMBER AND NAME

Intermarket Inc. P. O. Box 5282, Albany, New York 12205