



OWNER'S MANUAL

Item# T830027H

3 TON

SUPER DUTY HYBRID-LIFT GARAGE JACK

3 TON S.U.V.

2 TON LOW PROFILE



⚠ WARNING!

Questions, problems, missing parts? Before returning to your retailer, contact our customer service department at www.torin-usa.com/support.

Read carefully and understand all ASSEMBLY AND OPERATION INSTRUCTIONS before operating. Failure to follow the safety rules and other basic safety precautions may result in serious personal injury.

Version 20200703

TECHNICAL SPECIFICATIONS

Item	Capacity	Lifting Range Min. (inch)	Lifting Range Max. (inch)	Lifting Range Min. (mm)	Lifting Range Max. (mm)
T830027H	2 TON	3-7/8	30-1/8	98	765
	3 TON	9-3/4	30-5/16	248	770

SAFETY INSTRUCTIONS

Read Operating Instructions

Study, understand and follow all instructions in this manual before operating the jack. Failure to heed these warnings may result in loss of load, damage to the jack and/or jack failure resulting in personal injury or property damage.

Position the Jack

Position the jack to only lift on the areas of the vehicle specified by the vehicle manufacturer.

Use Support Stands

After lifting the vehicle always support the load with appropriately rated vehicle supports stands before working on the vehicle.

Do Not Overload Jack

Do not overload this jack beyond its rated capacity. Overloading this jack beyond its rated capacity can cause damage to or failure of the jack.

Use on Hard Level Surface

This jack is designed only for use on hard level surfaces capable of sustaining the load. Use on other than hard level surfaces can result in jack instability and possible loss of load.

Center Load on Jack Saddle

Center load on jack saddle before lifting vehicle. Off-center loads and loads lifted when the jack is not level can cause loss of load or damage to the jack.

Keep hands and feet clear of the jack hinge mechanism and ground contact area when lowering the load !

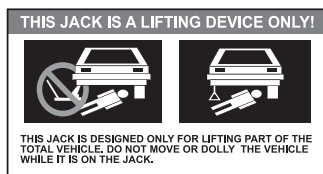

WARRANTY NOTICE

This equipment is covered under a 1-year limited warranty when used as recommended. Only those items listed with a Part # are available for purchase. For assistance with the operation or the availability of replacement parts, contact our Parts and Warranty Department at www.torin-usa.com/support. Please have available a copy of your receipt, the model number of the product, serial number, and specific details regarding your question.

Not all equipment components are available for replacement; illustrations provided are a convenient reference of location and position in the assembly sequence.

The manufacturer reserves the rights to make design changes and or improvements to product lines and manuals without notice.

WARRANTY INFORMATION

We want to know if you have any concerns with our products. If so, please call toll-free for immediate assistance.

For additional web customer support help inquiries visit the Customer Service section at:

<http://www.torin-usa.com>.

⚠ WARNING!

1. STUDY, UNDERSTAND, AND FOLLOW ALL INSTRUCTIONS BEFORE OPERATING THIS DEVICE.
2. DO NOT EXCEED RATED CAPACITY.
3. USE ONLY ON HARD, LEVEL SURFACES, WITH LESS THAN 3 DEGREES OF SLOPE.
4. LIFTING DEVICE ONLY. IMMEDIATELY AFTER LIFTING, SUPPORT THE VEHICLE WITH APPROPRIATE MEANS.
5. DO NOT MOVE OR DOLLY THE VEHICLE WHILE ON THE JACK.
6. LIFT ONLY ON AREAS OF THE VEHICLE AS SPECIFIED BY THE VEHICLE MANUFACTURER.
7. NO ALTERATIONS SHALL BE MADE TO THIS PRODUCT.
8. ONLY ATTACHMENTS AND/OR ADAPTERS SUPPLIED BY THE MANUFACTURER SHALL BE USED.
9. DO NOT GET UNDER OR ALLOW ANYONE UNDER THE VEHICLE UNTIL IT HAS BEEN SUPPORTED BY JACK STANDS.
10. CENTER LOAD ON SADDLE PRIOR TO LIFTING.
11. USE WHEEL CHOCKS OR OTHER BLOCKING DEVICE ON OPPOSING WHEELS BEFORE USING JACK.
12. NEVER USE ON A LAWN MOWER OR LAWN TRACTOR.
13. DO NOT USE THIS JACK FOR ANY USE OTHER THAN THE MANUFACTURER SPECIFIED USAGE.
14. DO NOT ROCK THE VEHICLE WHILE WORKING ON OR AROUND EQUIPMENT.
15. THE FOLLOWING ARE NOT RECOMMENDED FOR SUPPORTING ON THIS EQUIPMENT: FOUNDATIONS, HOMES, MOBILE HOMES, TRAILERS, RV'S, CAMPERS, NOR FIFTH WHEELS, ETC....
16. FAILURE TO HEED THESE MARKINGS MAY RESULT IN PERSONAL INJURY AND/OR PROPERTY DAMAGE.

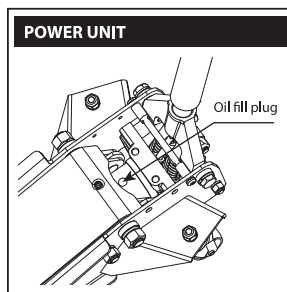
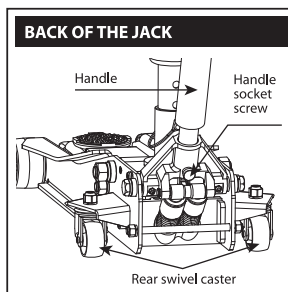
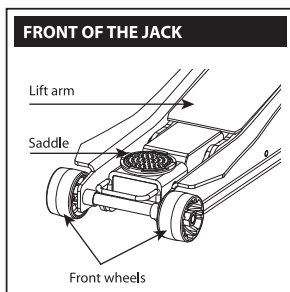

ASSEMBLY

1. Line up the square hole located at the bottom of the handle over the square bolt inside the Handle Socket.
2. Secure the handle in place by tightening the screw in the Handle Socket.

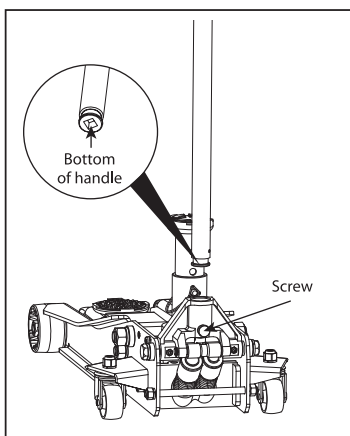

FEATURES & OPERATION

To use the jack in a locked position:

1. Raise the jack one full pump.
2. Remove the lock pin from its storage area.
3. Manually raise the lifting arm to a 90 degree position.
4. Insert the lock pin into the upper slot.
5. Exchangable saddles.
6. Adjustable height of the saddle.

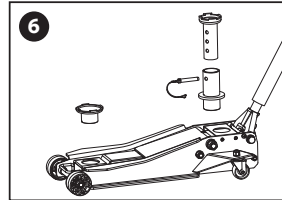
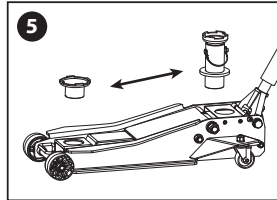
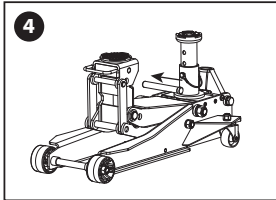
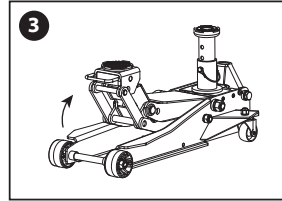
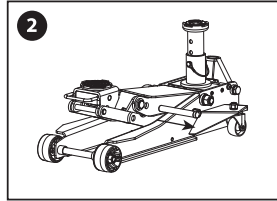
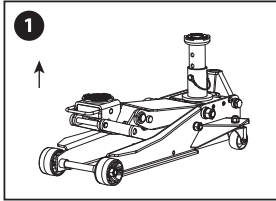

Operation

Raising the Jack

- Close the release valve by turning the handle clockwise as far as it will go.
- Block the vehicle's wheels for lifting stability.
- Refer to the vehicle manufacturer owner's manual to locate approved lifting points on the vehicle. Position the jack so that the saddle is centered and will contact the load lifting point firmly.
- Step on foot pedal to raise saddle until it makes contact with the vehicle. Check to see that the saddle is centered and will contact the load lifting point firmly. Foot pedal it's not apt to lift the load but only to quick lift the saddle.
- Continue to pump the jack with handle to lift the vehicle to the desired height. After lifting, support the load with appropriately rated vehicle support stands before working on the vehicle.

Lowering the Jack

- Carefully open the release valve by slowly turning the handle counterclockwise.

How it Works

With Release Valve Closed

- An upward stroke of the jack handle draws oil from the reservoir tank into the plunger cavity. Hydraulic pressure holds the valve closed, which keeps the oil in the plunger cavity.
- A downward stroke of the jack handle releases oil into the cylinder, which forces the ram out. This raises the saddle.
- When the ram reaches maximum extension, oil is bypassed back into the reservoir to prevent an over extended ram stroke and possible damage to the jack.
- Opening the release valve allows oil to flow back into the reservoir. This releases hydraulic pressure on the ram, which results in lowering the saddle.

MAINTENANCE

To Add Oil:

- Position the jack on level ground and lower the saddle. Remove the oil plug.
- Fill the oil case until oil level is just beneath the lower rim of oil fill hole. Replace oil plug.
- Perform the Air Purge Procedure described below.

To Replace Oil:

- Fully open release valve by turning handle counterclockwise as far as it will go.
- Turn the jack over so that old oil will drain from the oil fill hole.
- Refill through oil fill hole. Keep dirt and other material clear when pouring. Fill to just beneath lower rim of hole.
- Replace oil plug.
- Perform Air Purge Procedure described below.

Lubrication

- Add lubricating oil (WD-40) to all moving parts when needed.
- For light duty use lubricate every six months.
- For heavy and constant use lubrication recommended every month.

Rust Prevention:

- Check ram and pump plunger on the Power Unit Assembly every two months (or sooner, based on usage) for any signs of rust or corrosion. Lift the jack as high as it goes and look under and behind the lifting arm. If signs of rust are visible clean as needed and wipe down with an oily cloth or WD-40.
- When storing the jack, always have the saddle and pump plunger in the down position.

ALWAYS USE A GOOD GRADE HYDRAULIC JACK OIL. DO NOT USE HYDRAULIC BRAKE FLUID, ALCOHOL, GLYCERINE, DETERGENT, MOTOR OIL OR DIRTY OIL. USE OF AN UN-RECOMMENDED FLUID CAN CAUSE DAMAGE TO YOUR JACK.

Air Purge Procedure

During shipment or after oil refill, air may get into the hydraulic system causing poor lifting performance. Then system air purge is required as follows:

1. Turn the release valve fully counterclockwise to fully open the release valve.
2. Pump handle rapidly several times.
3. Turn the release valve clockwise to close the release valve.
4. Pump handle until the lift arm reaches maximum height and continue to pump several times to remove trapped air in the ram.
5. Turn the release valve fully counterclockwise to lower lift arm to lowest position. Use force on saddle if necessary.
6. Turn the release valve clockwise to closed position and check for proper pump action. It may be necessary to perform the above steps more than once to assure air is evacuated totally.

TROUBLESHOOTING				
Jack will not lift load	Jack will not hold load	Jack will not lower	Poor jack lifting	Causes and solutions
X				Release valve is not completely closed. Turn clockwise.
X			X	Air is in hydraulics. Purge air from system.
X	X		X	Low oil Level. Add oil as required.
		X		Oil reservoir is overfilled ; Drain excessive oil. Lubricate moving parts.
X	X		X	Power unit malfunctioning. Replace the power unit.

PARTS LIST

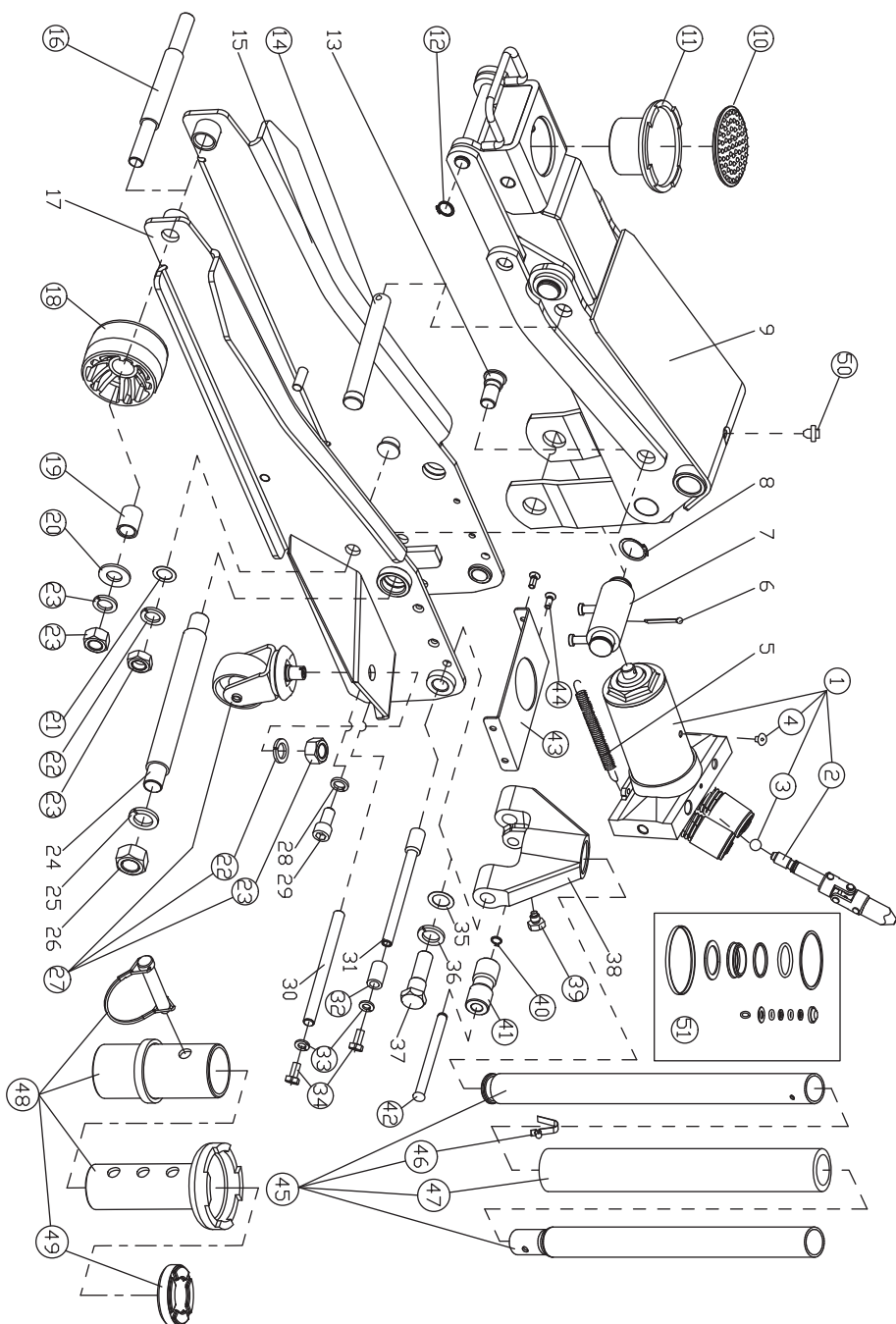

REF.	PART	DESORPTION	QTY
1	TZ830027H-1	Power unit assembly	1
2	T830023.4.1(asm)	Universal Joint Assembly	1
3	GB/T 308-6	Steel ball bearing Ø6mm	1
4	TF1201C-29	Oil plug	1
5		Return spring	2
6		Cotter pin Ø4x45mm	1
7		Coupling connector	1
8		C-clip Ø25mm	2
9		Lifting arm assembly	1
10	T815016CL-1	Saddle pad	1
11	TZ830027H.2	Saddle	1
12	GB/T 894.1-16	C-clip Ø16mm	2
13		Connecting rod pintle	2
14	T830027.1.3	Fixed pin	1
15		Right frame assembly	1
16	TZ830027H-1	Shaft for front wheel	1
17		Left frame assembly	1
18	TZ830027H-2	Front wheel	2
19	TZ830027H-3	Sleeve for front wheel	2
20	GB/T 97.1-16	Washer M16	2
21	QLZ3-7	Washer M16	2
22	GB/T 859-16	Spring washer M16	6
23	GB/T 6170-M16	Nut M16	6
24		Supporting Shaft	1
25		Spring washer M20	2
26		Nut M20	2
27	T83508.6(ASM)	Rear caster assembly	2
28		Spring washer M12	2
29		Socket head cap screw M12X25mm	2
30		BACK shaft	1
31		Position shaft	1
32	T84004-7	Rubber sleeve	2
33	GB/T 859-8	Spring washer M8	4
34	GB/T 5783-M8X16	Pan head combination drive machine screw M8x16mm	4
35		Washer M18	2
36		Spring washer M18	2
37		Shoulder bolt M18x54mm	2
38		Handle Socket	1
39	QLZ2C-1a	Handle socket screw M10x19mm	1
40	GB/T 894.1-12	C-clip Ø12mm	1
41	T825011CL.2-3	Contact roller	1
42	T825011CL.2-2	Pin for contact roller	1
43	TZ830027H-4	Cover plate	1
44	GB/T 70.3-M6x16	Plug for cover plate	4
45	T830008.6	Handle assembly	1
46	T83508.5-4	Handle lock pin	1
47	T83508-9	Flexible protective pipe	1
48	TZ830027H.3	Height saddle assembly	1
49	TZ830027H.3-1	Saddle pad	1
50	GB/T 1152	Oil cup	1
51	T830023.MF	Seal kit	1



Torin Inc.
4355 E. Brickell Street Ontario, CA USA
www.torin-usa.com
Made in China

