

# HYDRAULIC TRANSMISSION JACK

1/4 TON CAPACITY

J-47

Models 91-714  
93714, YA714

6-5-87

Series "D"

**TRI-CITY HYDRAULIC JACK SERVICE**  
4628 N. Florida Avenue  
Tampa, Florida 33603-3700  
(813) 236-8551



| MODEL  | LABEL KIT NO. | REPAIR KIT NO. |
|--------|---------------|----------------|
| 91-714 | 240123        | 91-393         |
| 93714  | 240124        | 240520         |
| YA714  | 240125        | 240520         |

## SPECIFICATIONS

| Low Pickup Height | High Lifting Point | Lifting Head Size (Max.) | Chassis Length | Chassis Width |
|-------------------|--------------------|--------------------------|----------------|---------------|
| 39"               | 78"                | 15-1/2" Sq.              | 38"            | 38"           |

| Caster Wheel Diameter | Forward Tilt | Rearward Tilt | Sideways Tilt |
|-----------------------|--------------|---------------|---------------|
| 4"                    | 80°          | 18°           | 10° R & L     |

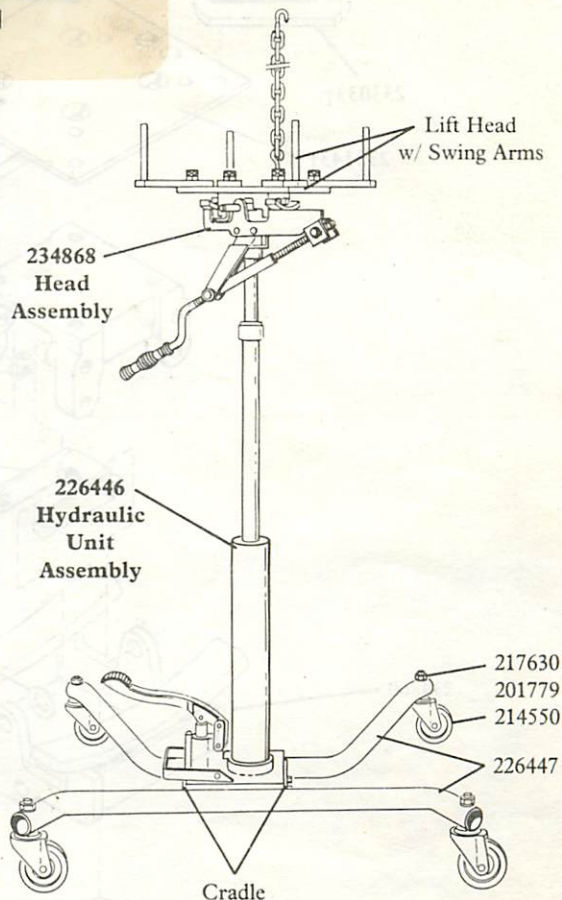

## ASSEMBLY INSTRUCTIONS

- 1) Assemble casters to leg assembly using nuts and lockwashers provided. Leg assembly is upright when cradle in center of leg assembly is lower than ends of legs.
- 2) Assemble hydraulic unit to cradle at center of leg assembly with four cap screws and lockwashers from base of hydraulic unit.  
NOTE: The hydraulic unit must be centrally located between the wheels. If it is off center, lift unit from cradle and rotate it 1/2 turn then return unit to cradle.
- 3) Remove envelope wired to head assembly then place head assembly on top of ram. Insert groove pin from envelope in hole from which wire was removed. Drive pin in until it is flush with surface.
- 4) Place lift head with swing arms on top of head assembly and fasten securely with four flat head screws.
- 5) **Loosen the uppermost screw on the side of the hydraulic unit. (This is an air vent for the oil reservoir and must be loose or jack will not function properly.)**  
NOTE: Filler screw is directly below the air vent. Oil level should be maintained to the edge of this hole when rams are in the down position.

## TO PREPARE JACK FOR USE

This unit may occasionally become air bound due to being tipped over during shipping. Trapped air should be purged from both the pump and the ram to insure proper operation.

- 1) To purge air from pump, remove pipe plug from top of the pump piston (directly below foot pedal). Add clean hydraulic jack oil through pipe plug hole until it overflows, then replace pipe plug. Pump is now free of air.
- 2) Pump foot pedal until rams are fully extended. In this position if pedal feels solid the jack is ready for use. If pedal is "spongy", leave the rams fully extended and loosen (do not remove) pipe plug in collar at top of lower ram. When oil starts leaking past the plug, tighten it and check pedal for solid feel as before.
- 3) Step on the release lever to lower ram.

**LINCOLN**

A DIVISION OF  
McNEIL CORPORATION

One Lincoln Way  
St. Louis, MO 63120-1578  
(314) 679-4200

SECTION - **W3**  
PAGE - **2F**

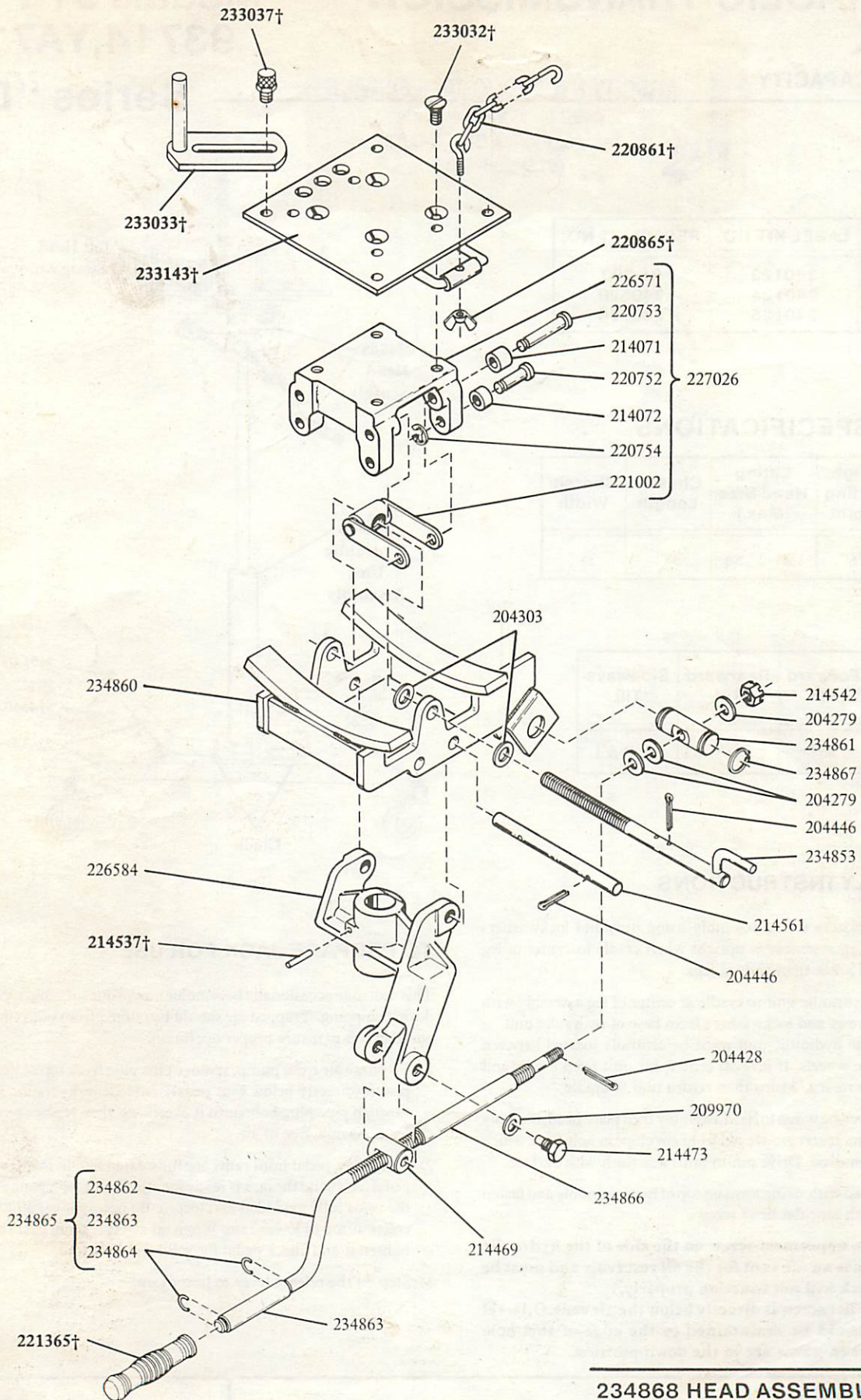

**234868 HEAD ASSEMBLY**

†Not included in 234868 Head Assembly.



# TRI-CITY HYDRAULIC JACK SERVICE

4628 N. Florida Avenue  
Tampa, Florida 33603-3700  
(813) 236-8551

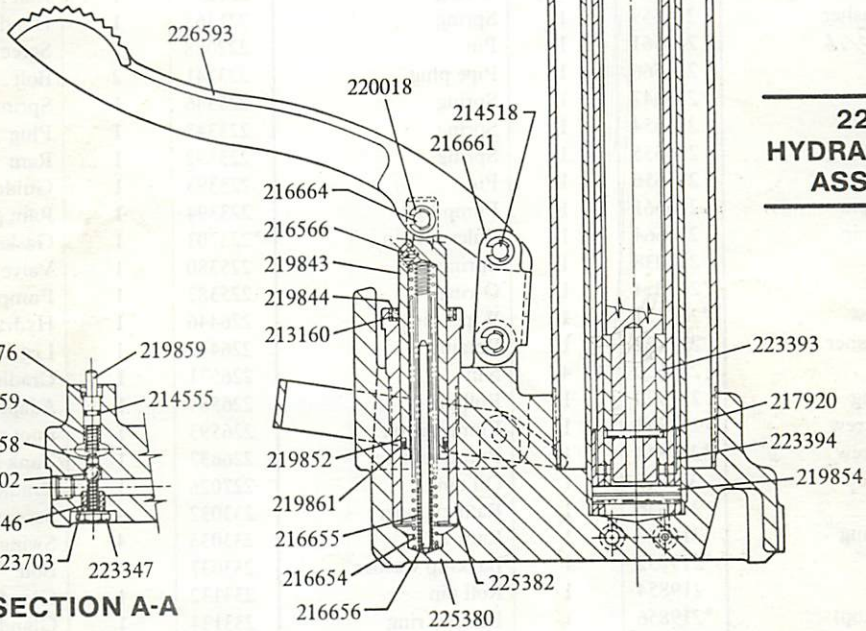
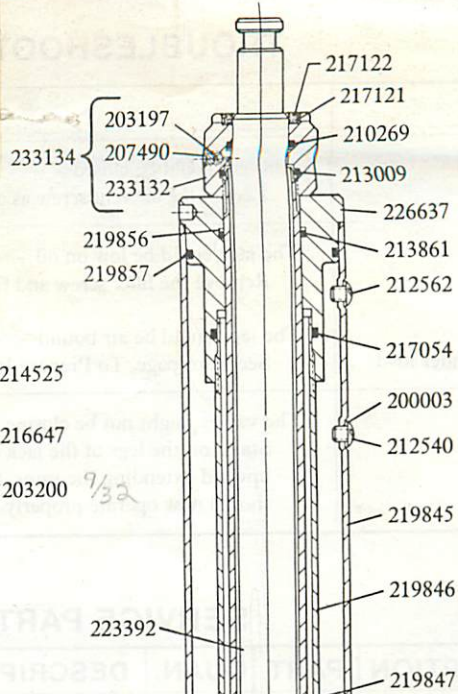
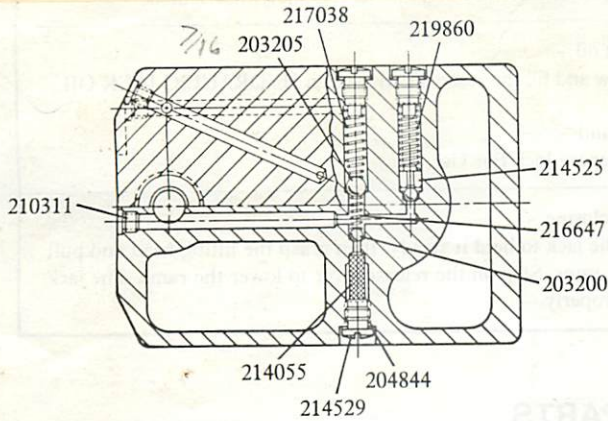

## 226446 HYDRAULIC UNIT ASSEMBLY

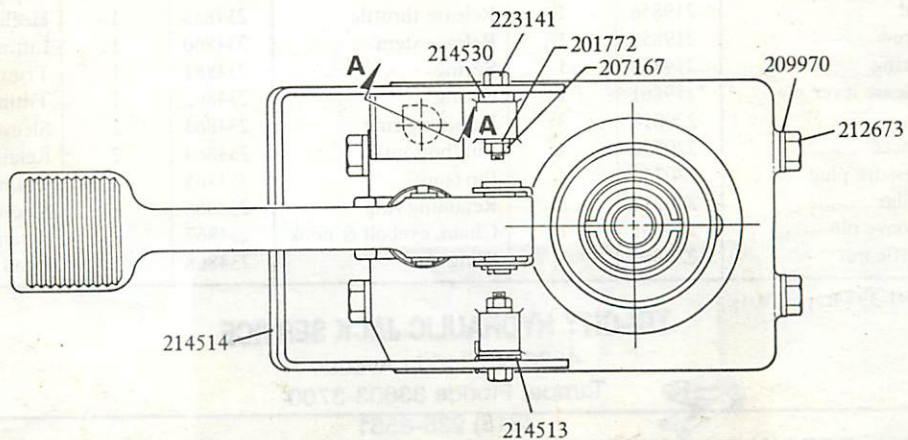
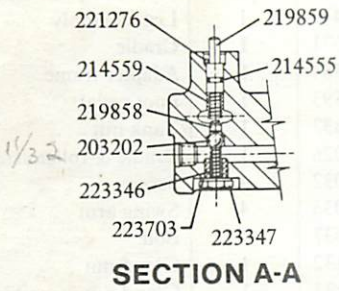

## TROUBLESHOOTING

| PROBLEM   | SOLUTION   |
|---|--|
| 1) Will not lift full height.   | Air vent could be closed -<br>Loosen the air vent screw as described in Item 5 of Assembly Instructions.   |
| 1) Will not lift load.<br>2) Will not lift full height.<br>3) Pump feels "spongy" under load. | The jack could be low on oil -<br>Remove the filler screw and fill the reservoir with clean HYDRAULIC JACK OIL.<br><br>The jack could be air bound -<br>See front page, To Prepare Jack For Use.   |
| 1) Will not lift load.<br>2) Will not hold load.  | The valves might not be closing -<br>Stand on the legs of the jack to hold it steady, then grasp the lifting head and pull upward extending the rams. Step on the release lever to lower the rams. The jack should now operate properly. |

## SERVICE PARTS

| PART    | QUAN. | DESCRIPTION      | PART    | QUAN. | DESCRIPTION           | PART    | QUAN. | DESCRIPTION               |
|---------|-------|------------------|---------|-------|-----------------------|---------|-------|---------------------------|
| *200003 | 2     | Gasket           | 214550  | 4     | Caster                | 221002  | 1     | Heeling screw nut & links |
| 201772  | 2     | Lockwasher       | *214555 | 1     | O-ring                | 221276  | 1     | Roll pin                  |
| 201779  | 4     | Lockwasher       | 214559  | 1     | Spring                | 221365  | 1     | Hand grip                 |
| 203197  | 1     | Ball <i>3/16</i> | 214561  | 1     | Pin                   | 222088  | 1     | Screen                    |
| *203200 | 2     | Ball             | 216566  | 1     | Pipe plug             | 223141  | 2     | Bolt                      |
| *203202 | 1     | Ball             | 216647  | 1     | Spring                | 223346  | 1     | Spring                    |
| *203205 | 1     | Ball             | 216654  | 1     | Spring                | 223347  | 1     | Plug                      |
| 204279  | 3     | Washer           | 216655  | 1     | Spring                | 223392  | 1     | Ram                       |
| 204303  | 2     | Washer           | 216656  | 1     | Pin                   | 223393  | 1     | Guide                     |
| 204428  | 1     | Cotter pin       | 216661  | 1     | Pump link             | 223394  | 1     | Ram guide                 |
| 204446  | 4     | Cotter pin       | 216664  | 1     | Fulcrum pin           | *223703 | 1     | Gasket                    |
| *204844 | 3     | Gasket           | 217038  | 1     | Spring                | 225380  | 1     | Valve base                |
| 207167  | 2     | Nut              | *217054 | 1     | O-ring                | 225382  | 1     | Pump cylinder             |
| 207490  | 1     | Set screw        | *217121 | 1     | Wiper ring            | 226446  | 1     | Hydraulic unit assembly   |
| 209970  | 6     | Lockwasher       | 217122  | 1     | Retainer              | 226447  | 1     | Leg assembly              |
| *210269 | 1     | O-ring           | 217630  | 4     | Nut                   | 226571  | 1     | Cradle                    |
| 210311  | 3     | Pipe plug        | 217920  | 1     | Roll pin              | 226584  | 1     | Adapter frame             |
| 212540  | 1     | Filler screw     | 219843  | 1     | Pump piston           | 226593  | 1     | Foot pedal                |
| 212562  | 1     | Vent screw       | *219844 | 1     | Pump retainer         | 226637  | 1     | Tank nut                  |
| 212673  | 4     | Cap screw        | 219845  | 1     | Oil tank              | 227026  | 1     | Cradle & roller assembly  |
| *213009 | 1     | O-ring           | 219846  | 1     | Ram cylinder          | 233032  | 4     | Screw                     |
| *213160 | 1     | Wiper ring       | 219847  | 1     | Ram                   | 233033  | 4     | Swing arm                 |
| *213861 | 1     | O-ring           | *219852 | 1     | Back-up washer        | 233037  | 4     | Bolt                      |
| 214055  | 1     | Screen           | 219854  | 1     | Roll pin              | 233132  | 1     | Gland nut                 |
| 214071  | 4     | Roller (top)     | *219856 | 1     | Leather ring          | 233134  | 1     | Gland nut assembly        |
| 214072  | 4     | Roller (bottom)  | *219857 | 1     | O-ring                | 233143  | 1     | Top plate                 |
| 214469  | 1     | Nut              | 219858  | 1     | Release throttle      | 234853  | 1     | Heeling screw             |
| 214473  | 2     | Screw            | 219859  | 1     | Release stem          | 234860  | 1     | Lifting frame             |
| 214513  | 1     | Spring           | 219860  | 1     | Spring                | 234861  | 1     | Trunnion                  |
| 214514  | 1     | Release lever    | *219861 | 1     | O-ring                | 234862  | 1     | Tilting screw             |
| 214518  | 2     | Pin              | 220018  | 3     | Retaining ring        | 234863  | 1     | Sleeve                    |
| 214525  | 1     | Spacer           | 220752  | 4     | Pin (bottom)          | 234864  | 2     | Retaining ring            |
| 214529  | 3     | Pressure plug    | 220753  | 4     | Pin (top)             | 234865  | 1     | Tilting screw assembly    |
| 214530  | 2     | Collar           | 220754  | 8     | Retaining ring        | 234866  | 1     | Sleeve                    |
| 214537  | 1     | Groove pin       | 220861  | 1     | Chain, eyebolt & hook | 234867  | 2     | Retaining ring            |
| 214542  | 1     | Castle nut       | 220865  | 1     | Wing nut              | 234868  | 1     | Head assembly             |

\*Included in 240520 and 91-393 Repair Kits.

### TRI-CITY HYDRAULIC JACK SERVICE

4628 N. Florida Avenue

Tampa, Florida 33603-3700

(813) 236-8551

RETAIN THIS INFORMATION FOR FUTURE REFERENCE

When ordering replacement parts, list: Part Number, Description, Model Number, and Series Letter.

LINCOLN ST. LOUIS provides a Distributor Network that stocks equipment and replacement parts.

A list of Authorized Service Departments will be furnished upon request.