



**TEMPLETON, KENLY & CO.**

2525 Gardner Road • Broadview, Illinois 60153 • 312-865-1500

# 100 TON CENTER HOLE CYLINDER

REPAIR PARTS SHEET

**RC1103C**  
**RC1106C**

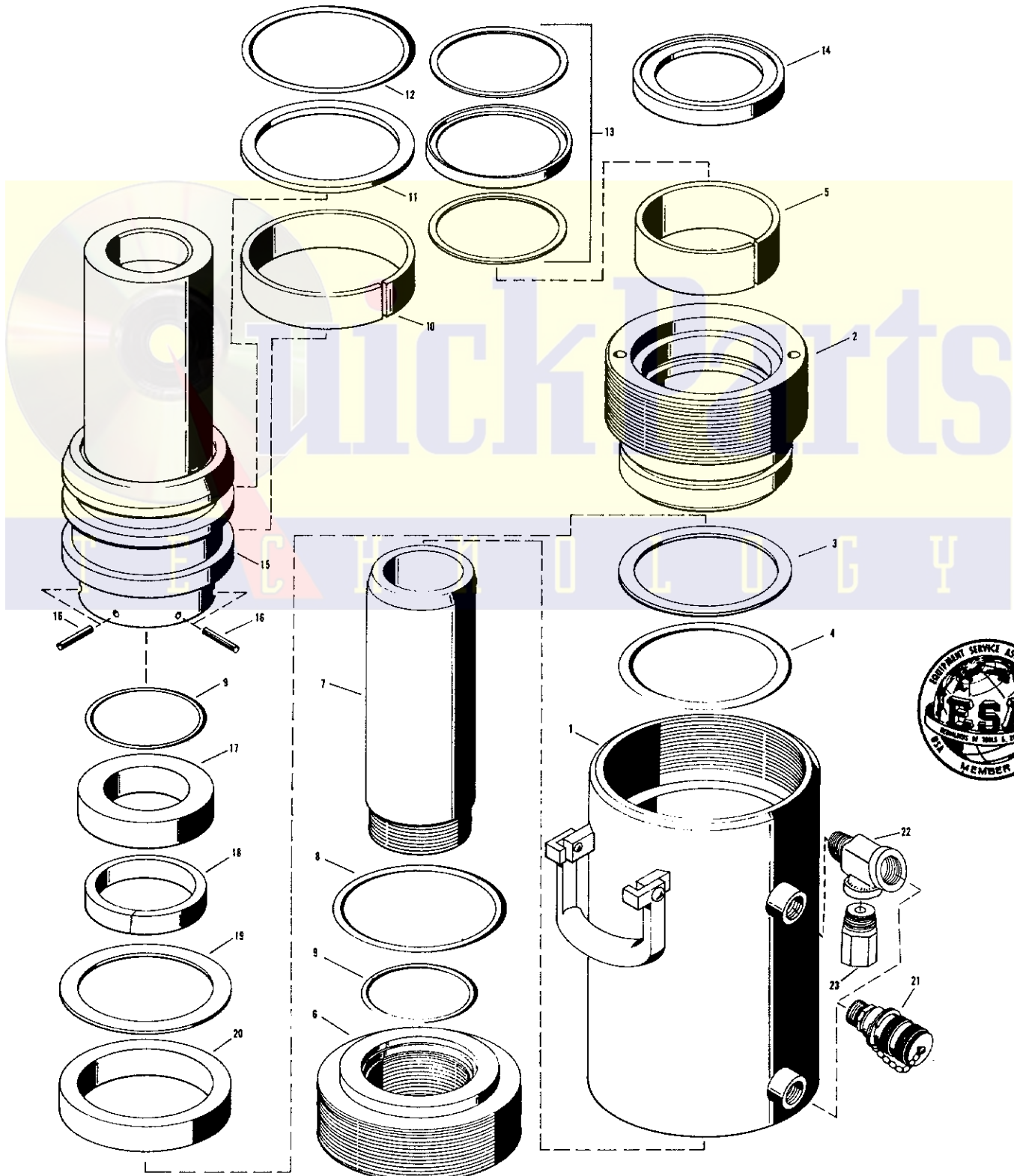

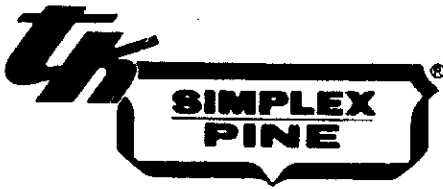

**WARRANTY**

Templeton, Kenly & Co. warrants to the purchaser of its products that if the product or any part thereof in the judgment of Templeton, Kenly & Co. is proven to be defective in material or workmanship within one year from the date of original purchase (two years on Heavy Duty Hydraulics and five years on Super Jacks), such defects will be repaired or replaced (at the company's option) free of charge for parts and labor.

This warranty does not apply to any product which has been damaged by accident or which has been misused, abused, altered, or repaired by anyone other than recognized Templeton, Kenly authorized Service Centers.

This warranty is in lieu of all other warranties expressed or implied, and no other person is authorized to assume for Templeton, Kenly & Co. any other liability in connection with the sale of this product.

**TEMPLETON, KENLY & CO.**

2525 Gardner Road • Broadview, Illinois 60153

**PARTS LIST**

ITEM NO.	DESCRIPTION	QTY.	CONTROL NUMBER	
			RC1103C (13241)	RC1106C (13245)
1	Housing Complete	1	97348	97356
2	Housing Insert	1	97343	97343
3	Back-Up Washer	1	+	+
4	"O"-Ring	1	+	+
5	Rod Wear Ring	1	+	+
6	Base	1	91964	91964
7	Center Sleeve	1	97347	97355
8	"O"-Ring	1	+	+
9	"O"-Ring	2	+	+
10	Piston Wear Ring	1	+	+
11	Back-Up Washer	1	+	+
12	"O"-Ring	1	+	+
13	GT-Ring	1	+	+
14	Oil Seal	1	+	+
15	Ram Plunger Ass'y	1	97349	97357
16	Pin	6	+	+
17	Small "U" Leather	1	+	+
18	Small Filler	1	+	+
19	Seal Saver Washer	1	+	+
20	Large "U" Leather Ass'y.	1	+	+
21	Ram Half Coupling	2	18211	18211
22	Street Tee	1	84047	84047
23	Relief Valve	1	84027	84027
	Packing Kit		99938	99938
	Repair Kit		99939	99939

- \* Items Included In Packing Kit
- + Items Included In Repair Kit

**ENGINEERING DATA**

RC1103C ..... Capacity 100 Tons at 9450 PSI on 21.20 Sq. In.  
Ram Area. Stroke 3".

RC1106C ..... Capacity 100 Tons at 9450 PSI on 21.20 Sq. In.  
Ram Area. Stroke 6".