



# TEMPLETON, KENLY & COMPANY

GARDNER ROAD and 16th STREET  
PHONE 312 - 865-1500

BROADVIEW, ILLINOIS 60153  
TWX 910 - 226-1955

## Simplex Center Hole Hydraulic Pullers

1003A  
1003B  
1003C

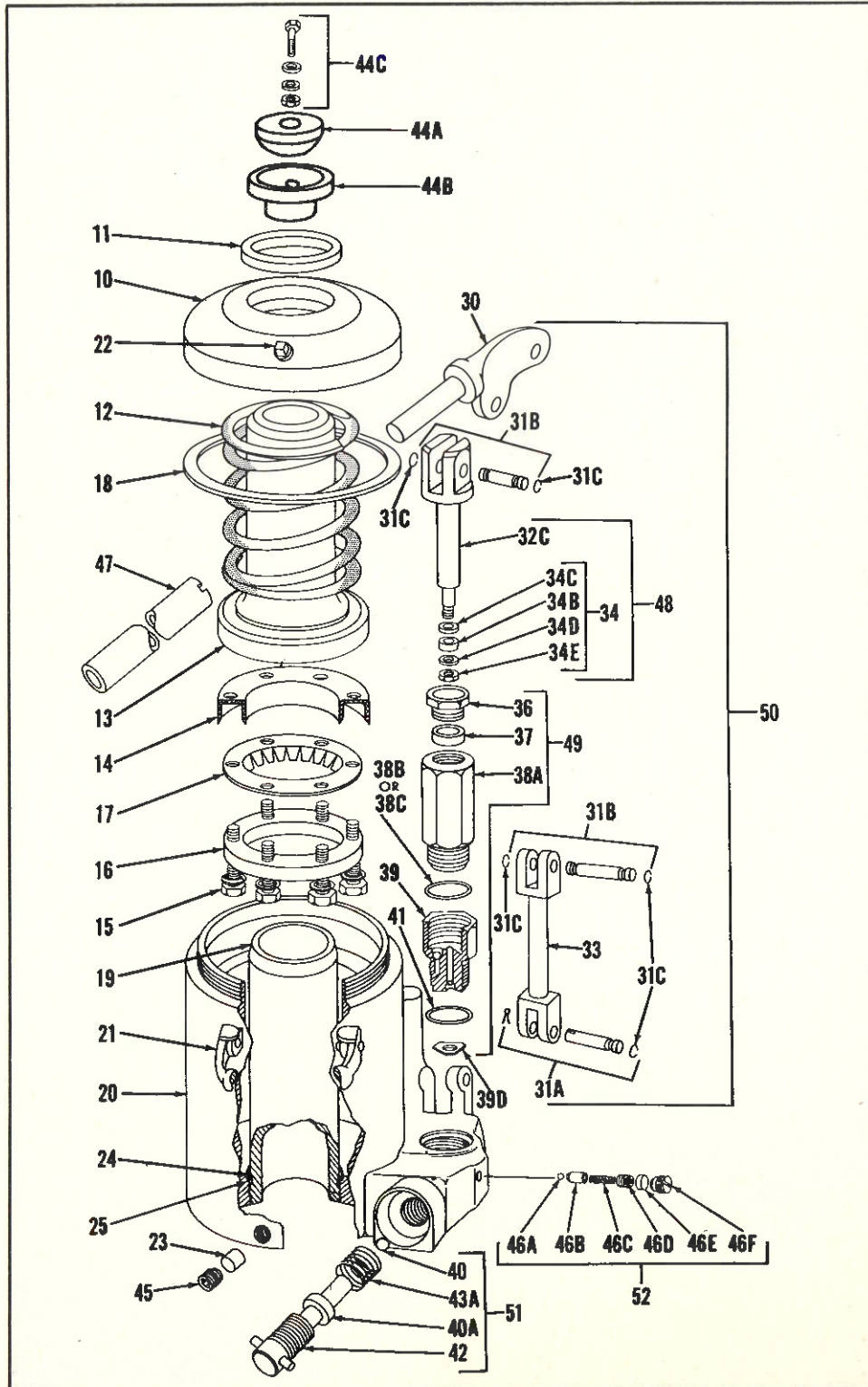

*Retain*



## Simplex Center Hole Hydraulic Pullers

Item No.	Jack No. 1003A	Jack No. 1003B	Jack No. 1003C	Name of Part
	Part No.	Part No.	Part No.	
10	1003A-10	1003A-10	1003C-10	Cap
11	1003A-11	1003A-11	1003A-11	Wiper Ring
12	803A-12	803A-12	803A-12	Retracting Spring
13	1003A-13	1003A-13	1003A-13	Ram Plunger
14	1003A-14	1003A-14	1003A-14	"U" Leather
15	-----	-----	-----	Filler Ring Screws 3/8-16x1-1/4 Hex. Hd. Screw Including Lock Washer (3/8 Medium Thickness Washer). . . .6-Req.
16	1003A-16	1003A-16	1003A-16	Filler Ring
17	1003A-17	1003A-17	1003A-17	Sealing Spring
18	803A-18	803A-18	803A-18	Housing Gasket
19	-----	1003B-19	1003B-19	Center Sleeve
20	1003C-20	1003C-20	1003C-20	Housing (Incl. Handles)
21	803A-21	803A-21	803A-21	Carrying Handle. . . .2-Req.
22	FP4	FP4	FP4	Breather Plug
23	303A-23	303A-23	303A-23	Pipe Plug Seal. . . .2-Req.
24	-----	J606B-9	J606B-9	Base "O" Ring
25	-----	1003B-8	1003B-8	Back-Up Washer
30	303A-30	303A-30	303A-30	Pump Lever
31A	303A-31A	303A-31A	303A-31A	Pump Housing Pin (Including Cotter & Clip)
31B	303A-31B	303A-31B	303A-31B	Pump Link Pin (Including Clips). . . .2-Req.
31C	85A-100G	85A-100G	85A-100G	Pump Pin Clip. . . .5-Req.
32C	303A-32C	303A-32C	303A-32C	1/2" Pump Piston
33	303A-33	303A-33	303A-33	Pump Link
34	RP5-4	RP5-4	RP5-4	Pump Piston Packing Complete (Incl. Items No. 34B, 34C, 34D, & 34E)
34B	RP5-13D	RP5-13D	RP5-13D	1/2" Pump Cup
34C	RP5-13E	RP5-13E	RP5-13E	1/2" Pump Washer Leather
34D	-----	-----	-----	Pump Cup Washer (No. 10 Small Brass Washer)
34E	-----	-----	-----	Pump Cup Nut (No. 10-32 Self Locking Nut)
36	303A-36	303A-36	303A-36	Pump Gland
37	303A-37	303A-37	303A-37	Pump Packing
38A	303A-38A	303A-38A	303A-38A	Pump Barrel (1/2")
38B	J330-38B	J330-38B	-----	Pump Barrel Seal
38C	-----	J330-38C	J330-38C	Pump Barrel "O" Ring (Used On New Models)
39	303A-39	J330-39	J330-39	Pump Valve Block - Complete
39D	303A-39D	303A-39D	303A-39D	Pump Block Gasket
40	3HJ-23B	3HJ-23B	3HJ-23B	Release Ball
40A	303A-40A	303A-40A	303A-40A	Release Valve Packing
41	-----	J330-41	J330-41	Pump Block "O" Ring
42	303A-42	303A-42	303A-42	Release Screw
43A	303A-43A	303A-43A	303A-43A	Release Ball Spring
44A	1003C-44A	1003C-44A	1003C-44A	Swivel Cap
44B	1003C-44B	1003C-44B	1003C-44B	Swivel Cap Saddle
44C	-----	-----	-----	Swivel Cap Screw 3/8 x 1-3/4 Hex. Hd. Cap Screw (Incl. Parts 3/8 Flex Lock Nut & 3/8 Plain Washer (2-Req.))
45	-----	-----	-----	Pipe Plug (1/4" Socket Hd.)
46A	-----	-----	803C-7D	Safety Valve Ball (1/8")
46B	-----	-----	RP3-7	Safety Valve Spring Plunger
46C	-----	-----	RP3-7A	Safety Valve Spring
46D	-----	-----	RP3-7B	Safety Valve Adjusting Screw
46E	-----	-----	3HJ-24	Valve Seal
46F	-----	-----	3HJ-21	Valve Screw
47	303A-47	303A-47	303A-47	Handle Lever
48	303A-48	303A-48	303A-48	1/2" Piston Assembly (Incl. Items No. 32C, 34B, 34C, 34D, & 34E)
49	303A-49	J330-49	J330-49	1/2" Pump Barrel Assembly (Incl. Items No. 36, 37, 38A, 38B, 38C, 39, 39D, & 41) On 1003A Less Items No. 38C & 41.
50	303A-50	J330-50	J330-50	1/2" Pump Assembly Complete (Incl. Items No. 30, 31A, 31B(2), 32C, 33, 34B, 34C, 34D, 34E, 36, 37, 38A, 38B, 38C, 39, 39D, & 41) On 1003A Less Items No. 38C & 41.
51	303A-51	303A-51	303A-51	Release Valve Assembly Complete (Incl. Items No. 40, 40A, 42, & 43A)
52	-----	-----	803C-52	Safety-Overload By-Pass Valve Assembly (Incl. Items No. 46A, 46B, 46C, 46D, 46E, & 46F)
	1003A-200	1003B-200	1003C-200B	Packing Kit (Incl. Items No. 11, 14, 18, 23(2), 24, 25, 34B, 34C, 37, 38B, 38C, 39D, 40A, 41, & 46E) On 1003A Less Items No. 24, 25, 38C, 41, & 46E. On 1003B Less Item No. 46E.
	1003A-300	1003B-300	1003C-300B	Repair Kit (Incl. Items No. 11, 14, 17, 18, 22, 23(2), 24, 25, 31A, 31B(2), 32C, 34B, 34C, 34D, 34E, 36, 37, 38A, 38B, 38C, 39, 39D, 40, 40A, 41, 42, 43A, 46A, 46B, 46C, 46D, 46E, & 46F) On 1003A Less Items No. 24, 25, 38C, 41, 46A, 46B, 46C, 46D, 46E, & 46F. On 1003B Less Items No. 46A, 46B, 46C, 46D, 46E, & 46F.

In ordering, specify the PART NUMBER, NAME OF PART and JACK NUMBER.