

WATCO R-4

**SEARS**

**OWNERS  
MANUAL**

**MODEL NO.  
328.12061**

**CAUTION:**  
Read Rules for  
Safe Operation  
and Instructions  
Carefully

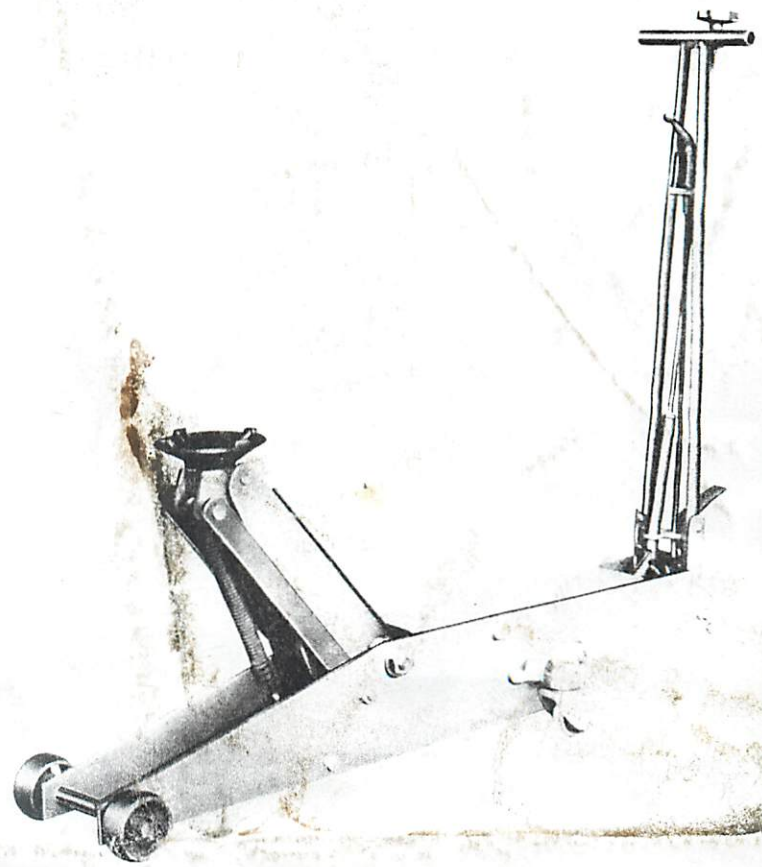

# 4 TON CAPACITY FLOOR SERVICE JACK

Operation  
Repair Parts

Part No.9017

Sears, Roebuck and Co., Chicago, IL. 60684 U.S.A.

## RULES FOR SAFE OPERATION

**IMPORTANT:** Sometimes during shipment and or handling, air gets into the hydraulic system causing poor lifting performance. This is indicated by a spongy feel as you pump the jack under a load. **REMOVE ANY AIR FROM THE SYSTEM** by simply opening Release Valve (turn the knob counterclockwise) and operate pump handle rapidly several times.

### Assembling the Jack Handle

1. Unscrew handle set bolt and nuts, and take pedal connecting pin out.
2. Put handle assembly between two jack frames and fix it by handle set bolt and nuts.
3. Put pedal connecting pin back and set pedal spring with pivot step bolt.
4. Set connector A into connector B by bolt.

### Raising the Jack

1. Turn lever up and close release valve (turn knob clockwise).
2. Place the jack underneath of the load pointing the saddle of jack at jacking point.
3. Put the foot pedal down several times so that the saddle to reach to the jacking point, or operate jack handle until the saddle approaches contact with load.
4. Check to see that saddle is correctly positioned.
5. Raise load to desired height by operating jack handle. Transfer to jack stands if load is to be held up for an extended period.

[1] 1 The foot pedal is available for raising jack conveniently by foot until the saddle approaches contact with load. For raising load, operate handle.

2 Air vent plug is sealed by sticker to prevent from oil leakage during transportation. Before operation, take the sticker off.

### Lowering the Jack

Open Release Valve **VERY SLOWLY** (by turning handle counter-clockwise). When Release Valve is opened, saddle can be easily lowered by hand or foot.

### Positioning the Handle

Select one of three holes in the rear end of jack frame. Handle can be set at three different positions by turning lever down.

### Operating Principles

With Release Valve **TIGHTLY CLOSED**:

1. Upward stroke draws oil from Reservoir Tank into Plunger Cavity. Hydraulic pressure keeps Valve closed, keeping oil in cylinder.
2. Downward stroke of Plunger forces oil into Cylinder. Ram is forced out, raising saddle.

When jack is operated under excess of rated capacity, oil is released back into reservoir through safety overload and jack does not lift up.

3. When Ram reaches maximum stroke, oil is by-passed back into Reservoir, thus preventing overextended Ram Stroke.

When Release Valve is opened, oil is allowed to flow back into Reservoir, releasing hydraulic pressure on Ram and permitting saddle to be lowered.

## CAUTION

THIS JACK IS DESIGNED FOR JACKING PURPOSES ONLY. AFTER JACKING, ALWAYS USE SAFETY STANDS TO SUPPORT LOAD BEFORE MAKING REPAIRS. **FOR YOUR SAFETY-DO NOT OVERLOAD THIS JACK BEYOND ITS RATED CAPACITY.**

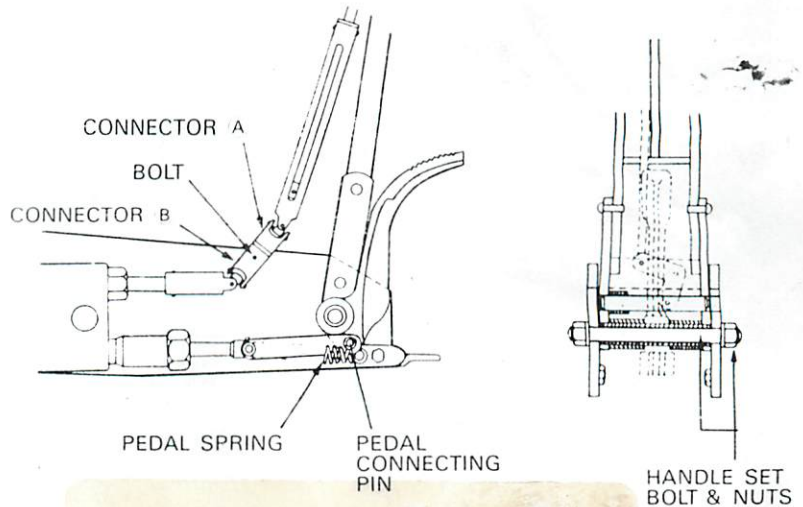

### TRI-CITY HYDRAULIC JACK SERVICE

4628 N. Florida Avenue  
Tampa, Florida 33603-3700  
(813) 236-8551

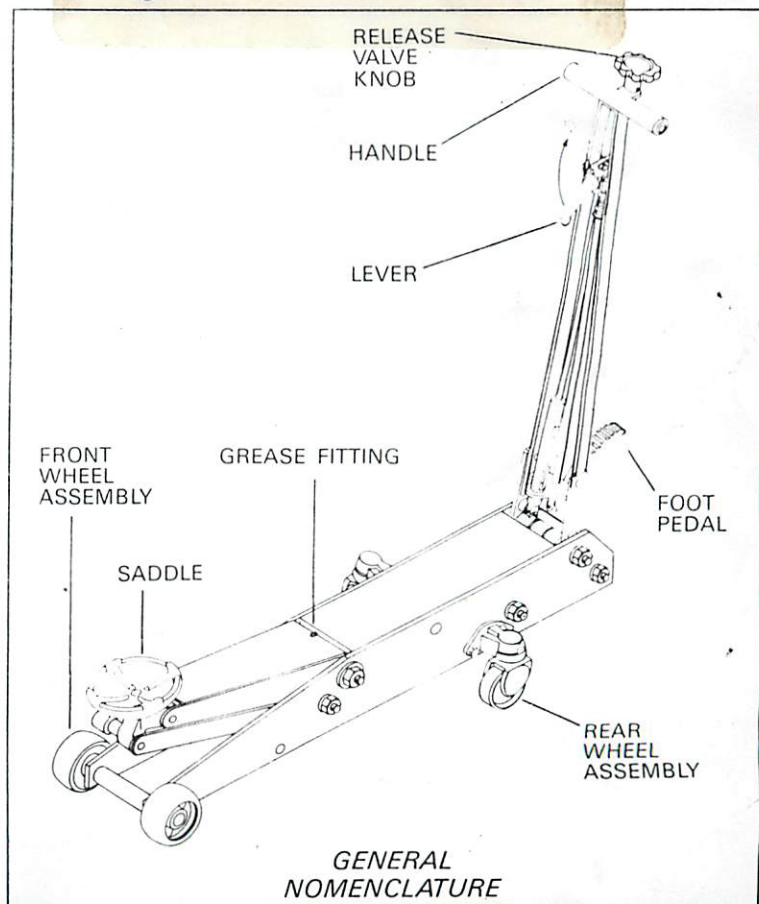

GENERAL  
NOMENCLATURE

Fig. 2



# MAINTENANCE PROCEDURE

## Maintaining Oil Level

**IMPORTANT:** When adding or replacing oil, always use a good grade Hydraulic Jack Oil. **DO NOT** use Brake Fluid, Alcohol, Glycerine, Detergent Motor Oil, or Dirty Oil. Improper fluid can cause serious internal damage to Jack.

**Adding Oil:** With Saddle fully lowered & jack on level ground, remove cover. (See Fig.3) Take air vent plug out and add oil. Oil level should be approx. 1-1/8" below plug hole.

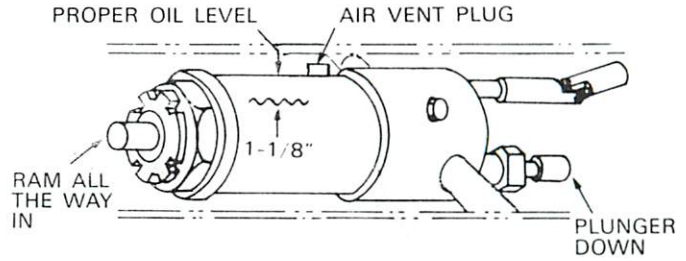

Fig. 3

## Replacing Oil

1. Take release valve fixing bolt out.
2. Take pedal connecting pin out.
3. Take box pin out.
4. Remove power unit from jack frames.
5. Remove air vent plug.
6. Replace Oil.
7. Be very careful not to permit dirt or foreign matter to get into the system.

## Lubrication

Add grease to Upper Arm Grease Fitting every 3 months. (See Fig. 2)

## Preventing Rust

Check ram & plunger every month for any signs of rust or corrosion. Clean as needed and wipe with an oily cloth. Lubricate wheel axles, under part of saddle and all pivot points with oil every month. Add grease to arm pins.

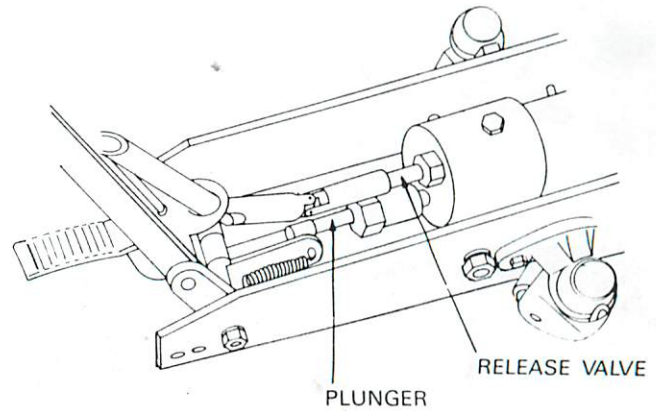

Fig. 4

## TROUBLE SHOOTING (USING JACK WITHIN RATED LOAD CAPACITY)

TROUBLE	POSSIBLE CAUSE	REMEDY
Will not lift load at all	1) No or low Oil in system 2) Power unit not functioning	1) Fill to prescribed level 2) Replace power unit
Will lift load only part way	3) Oil level low	3) Fill to prescribed level
Will lift load, but will not hold	4) Power unit not functioning	4) Replace power unit
Jack will not lower	5) Release Valve stuck – probably dirt or foreign matter	5) Transfer load & clean Release Valve
Poor lifting	6) Dirty Oil 7) Air in Hydraulic System	6) Change Hydraulic Oil 7) Purge Air from system by simply opening Release Valve (turn the knob counterclockwise) and operate pump handle rapidly several times.



**TRI-CITY HYDRAULIC JACK SERVICE**

4628 N. Florida Avenue  
Tampa, Florida 33603-3700  
(813) 236-8551

# REPAIR PARTS

Sears 4 Ton Floor Service Jack  
Model Number 328.12061



## TRI-CITY HYDRAULIC JACK SERVICE

4628 N. Florida Avenue  
Tampa, Florida 33603-3700  
(813) 236-8551

Handle assembly  
(1417)

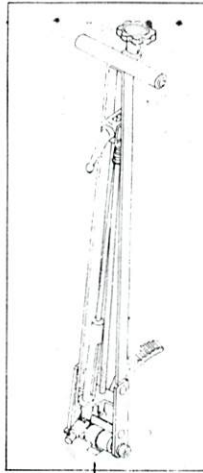

Power unit assembly  
(1517)

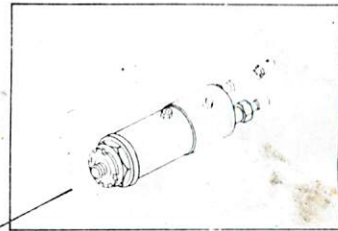

Saddle (2117)

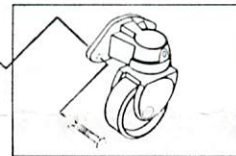
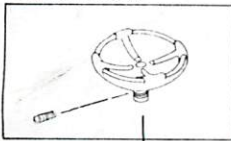

Rear wheel assembly  
(4017)

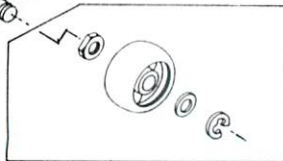

Front wheel assembly  
(1117)

**PARTS ARE AVAILABLE IN ASSEMBLIES ONLY (EXCEPT SADDLE)**

Parts No.	Description	Parts No.	Description
1117	Front wheel assembly	2117	Saddle
1417	Handle assembly	4017	Rear wheel assembly
1517	Power unit assembly	9017	Owners manual

### Model Number 328.12061

The Model Number and Serial Number will be found on the Frame Assembly. Always mention the Model Number and Serial Number when requesting service or repair parts for your Jack.

### How to Order Repair Parts

All assemblies listed herein may be ordered from any SEARS Service Center and Most Sears Stores.

### WHEN ORDERING REPAIR PARTS, ALWAYS GIVE THE FOLLOWING INFORMATION:

- |                 |                          |
|-----------------|--------------------------|
| 1. PART NUMBER  | 3. PART DESCRIPTION      |
| 2. MODEL NUMBER | 4. NAME OF ITEM          |
| 328.12061       | 4 Ton Floor Service Jack |

IF THE PARTS YOU NEED ARE NOT STOCKED LOCAL YOUR ORDER WILL BE ELECTRONICALLY TRANSMIT TO A SEARS REPAIR PARTS DISTRIBUTION CENTER FOR EXPEDITED HANDLING.

**THE CITY HYDRAULIC JACK SERVICE**

4828 N. Florida Avenue  
Tampa, Florida 33603-3760  
(813) 238-8551

**4 TON**

**PARTS LIST**

EXPLODED VIEW OF BODY

EXPLODED VIEW OF HYDRAULIC POWER UNIT

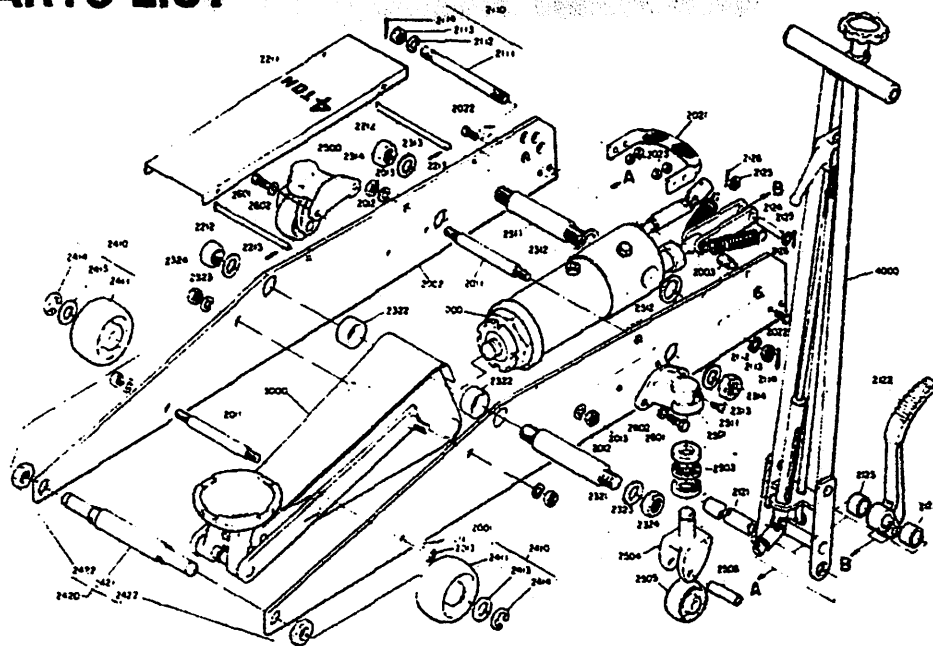
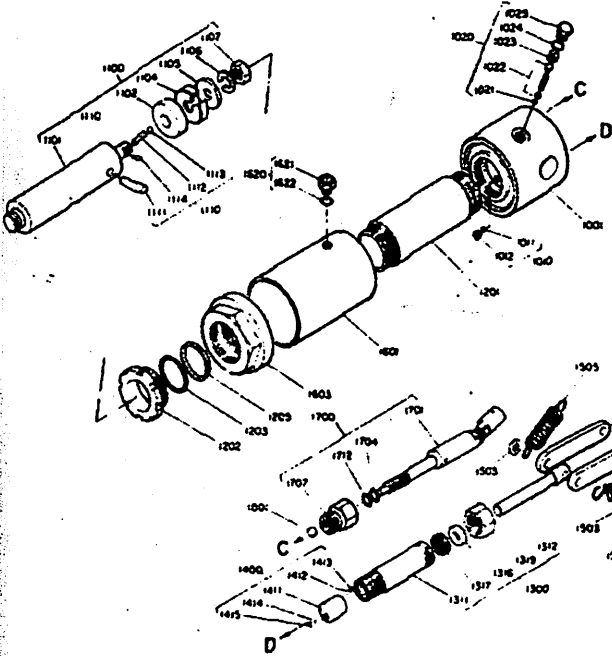

EXPLODED VIEW OF ARM

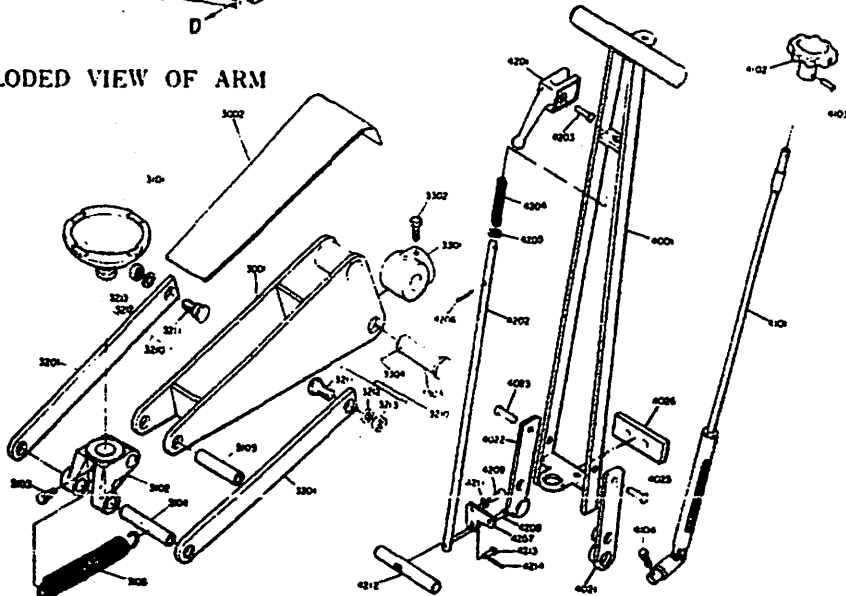

EXPLODED VIEW OF HANDLE

**IMPORTANT**

**USE JACK FOR LIFTING ONLY.  
TO INSURE SAFETY ALWAYS  
SUPPORT VEHICLE WITH STANDS**

**WHEN ORDERING, STATE  
PART NO., DESCRIPTION, AND  
MODEL NO. OF JACK.**

4 TON