

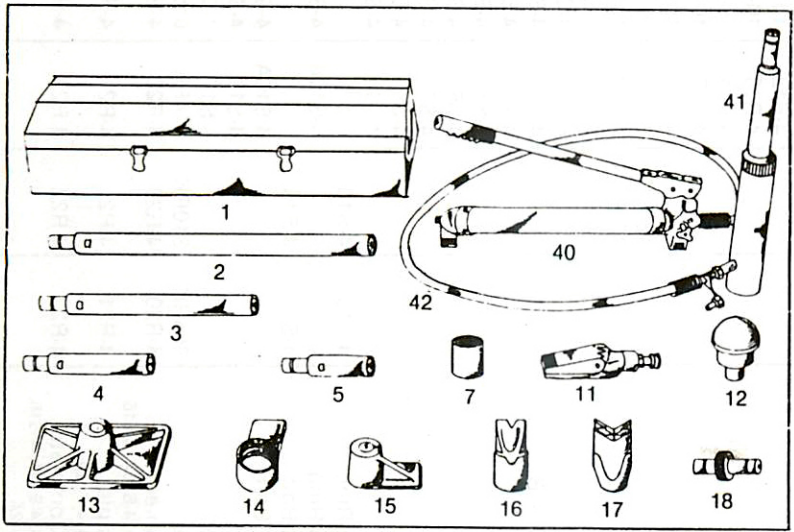

SPARE PARTS LIST

MODELS 804 & 814 (Snap Style) 4 TON CAPACITY
 MODELS 810 & 815 (Snap Style) 10 TON CAPACITY



Hydraulic Spreader Assembly

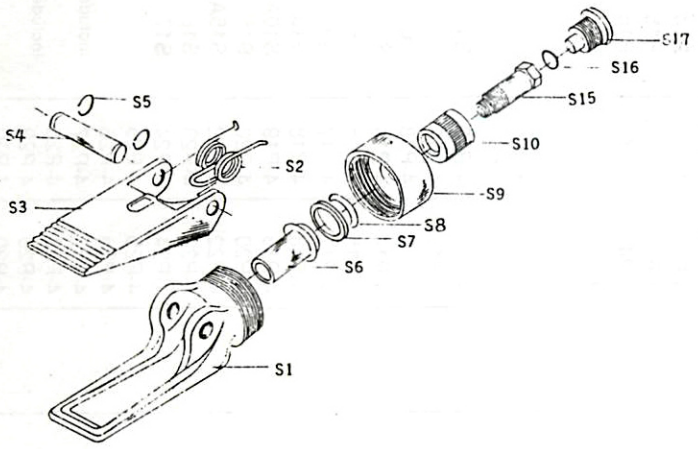

Hydraulic Ram Assembly

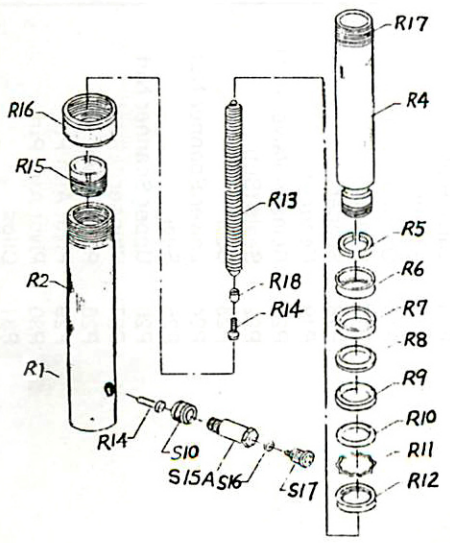

Hydraulic Pump Assembly

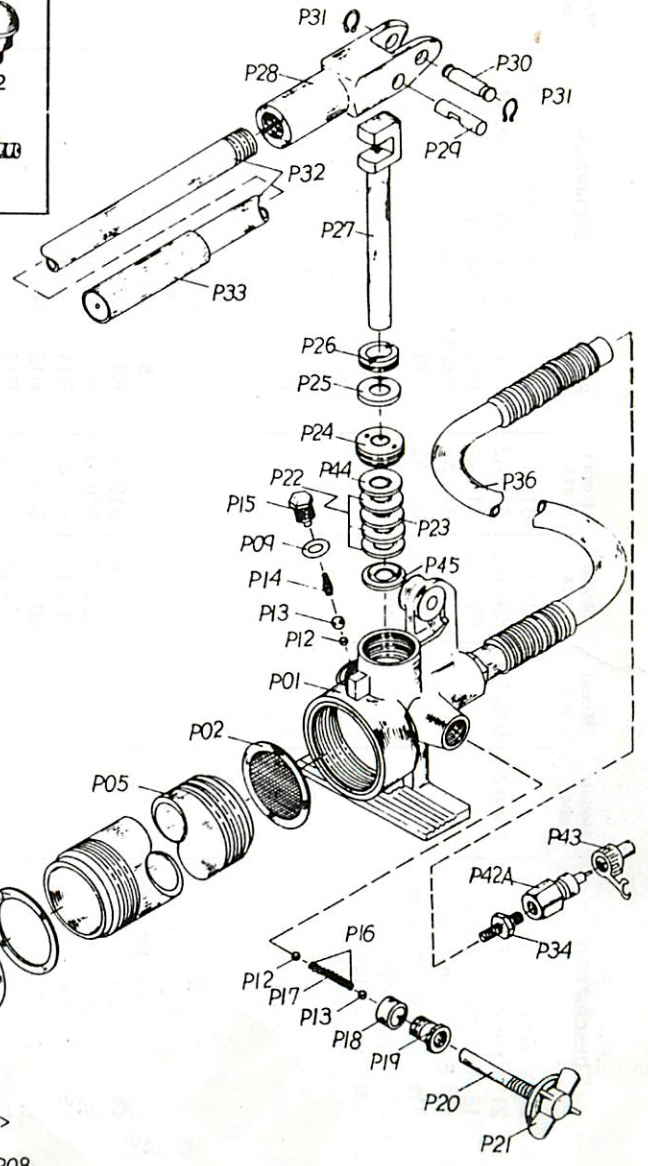

SPARE PARTS LIST

MODELS 804 & 814 (Snap Style) 4 TON CAPACITY
 MODELS 810 & 815 (Snap Style) 10 TON CAPACITY



REF. NO.	DESCRIPTION	Model 804	Model 810	Model 814	Model 815	REF. NO.	DESCRIPTION	Model 804	Model 810	Model 814	Model 815
1	Metal Box	804-A2		804-1	810-1	P32	Pump Handle	4-P42	4-P42	4-P32	10-P32
2	21" Extension Tube		810-A2	804-A2	810-A2	P34	Coupling Connector			4-P34	4-P34
3	18" Extension Tube			804-A3	810-A4	P42	Coupling				4-P42A
4	10" Extension Tube			804-A4	810-A4	P42A*	Coupling				4-P43
5	6 1/2" Extension Tube			804-A5	810-A5	P43	Dust Cap				4-P44
6	3 1/4" Extension Tube			804-A6	810-A6	P44	Back-up Ring				10-P44
7*	Serrated Saddle					P45	Back-up Ring				10-P45
8*	Male Connector	804-A9	810-A9			R1,2	Base & Cylinder	4-R1,2	10-R1,2	4-R1A	10-R1A
9*	Male Adapter	804-A10	810-A10			R1A	Cylinder	4-R4	10-R4		
10*	Female Adapter					R4	Ram				
11	Spreader Ram			804-11	810-11	R4A	Ram			4-R4A	10-R4A
12	Rubber Head		810-12	804-12	810-12	R5	Clips			4-R5	10-R5
13	Flat Base			804-13	810-13	R6	Disc			4-R6	10-R6
14	Spreader Ram Toe			804-14	810-14	R7	Nylon Cap			4-R7	10-R7
15	Spreader Plunger Toe			804-15	810-15	R8	Teflon Cap			4-R8	10-R8
16	Wedge Head			804-16	810-16	R9	Uletan Cap			4-R9	10-R9
17	90° V-Base			804-17	810-17	R10	Spreader			4-R10	10-R10
40	Hydraulic Unit			804-40	810-40	R11	Washer			4-R11	10-R11
41	Hydraulic Ram			804-41	810-41	R12	Nut			4-R12	10-R12
42	Hose			804-42	810-42	R13	Spring			4-R13	10-R13
P1	Pump Housing	4-P1	10-P1	4-P1	10-P1	R14	Screw			4-R14	10-R14
P02	Screen			4-P02	10-P02	R15	Ring			4-R15	10-R15
P4	Seal			4-P4	4-P4	R16	Protector	4-R17	10-R17	4-R18	10-R18
P5	Pump Reservoir			4-P5	10-P5	R17	Saddle				
P6	Reservoir End Cap			4-P6	4-P6	R18	Bushing				
P7	Pump Foot			4-P7	4-P7	S1	Lower Duck Bill				
P8	Nut Housing			4-P8	4-P8	S2	Spring				
P9	O-Ring			4-P9	4-P9	S3	Upper Duck Bill				
P10	Dip Stick			4-P10	4-P10	S4	Pivoting Pin				
P12	Valve Ball			4-P12	4-P12	S5	Clips				
P13	Valve Ball			4-P13	4-P13	S6	Piston				
P14	Spring			4-P14	4-P14	S7	Cup Seal				
P15	Overload Stem			4-P15	4-P15	S8	Washer				
P17	Spring			4-P17	4-P17	S9	End Cap				
P18	Spacer			4-P18	4-P18	S10	Coupling Ring	4-S10	4-S10	4-S10A	4-S10A
P19	Reducer			4-P19	4-P19	S10A	Coupling Ring				
P20	Release Valve Stem			4-P20	4-P20	S15	Coupling Bolt	4-S15	4-S15	4-S15A	4-S15A
P22	Seals (Set)			4-P22	4-P22	S15A	Coupling Bolt				
P23	Seal			4-P23	4-P23	S16	O-Ring				
P24	Lower Spanner Nut			4-P24	4-P24	S17	Dust Cap				
P25	Seal			4-P25	4-P25		Repair Kit				
P26	Upper Spanner Nut			4-P26	4-P26		Ram Coupler	804RK	810RK	814RK	815RK
P27	Plunger			4-P27	4-P27		Hose Coupler	4-R20	4-R20	4-R20	4-R20
P28	Pump Pivot Arm			4-P28	4-P28		includes parts: 4-S10, 4-S15A, 4-S16				
P29	Pivot Arm Pin			4-P29	4-P29		includes parts: 4-P34, 4-P42A				
P30	Pivot Arm Pin			4-P30	4-P30		Coupler Complete	4-R21	4-R21	4-R21	4-R21
P31	Clips			4-P31	4-P31		includes parts: 4-S10, 4-S15A, 4-S16, & 4-P42A	4-R22	4-R22	4-R22	4-R22