

SPX**POWER TEAM®**

SPX Corporation
5885 11th Street
Rockford, IL 61109-3699 USA

Tech. Services: (800) 477-8326
Fax: (800) 765-8326
Order Entry: (800) 541-1418
Fax: (800) 288-7031

Internet Address:
<http://www.powerteam.com>

Form No. 101771

Parts List for:

RD400 Series

MODEL B
DOUBLE-ACTING
HYDRAULIC CYLINDER
Max. Capacity: 400 Tons at 10,185 PSI

**Double-acting
Cylinder
Relief Valve**

See important

! DANGER
statement
on back of
sheet 1 of 1

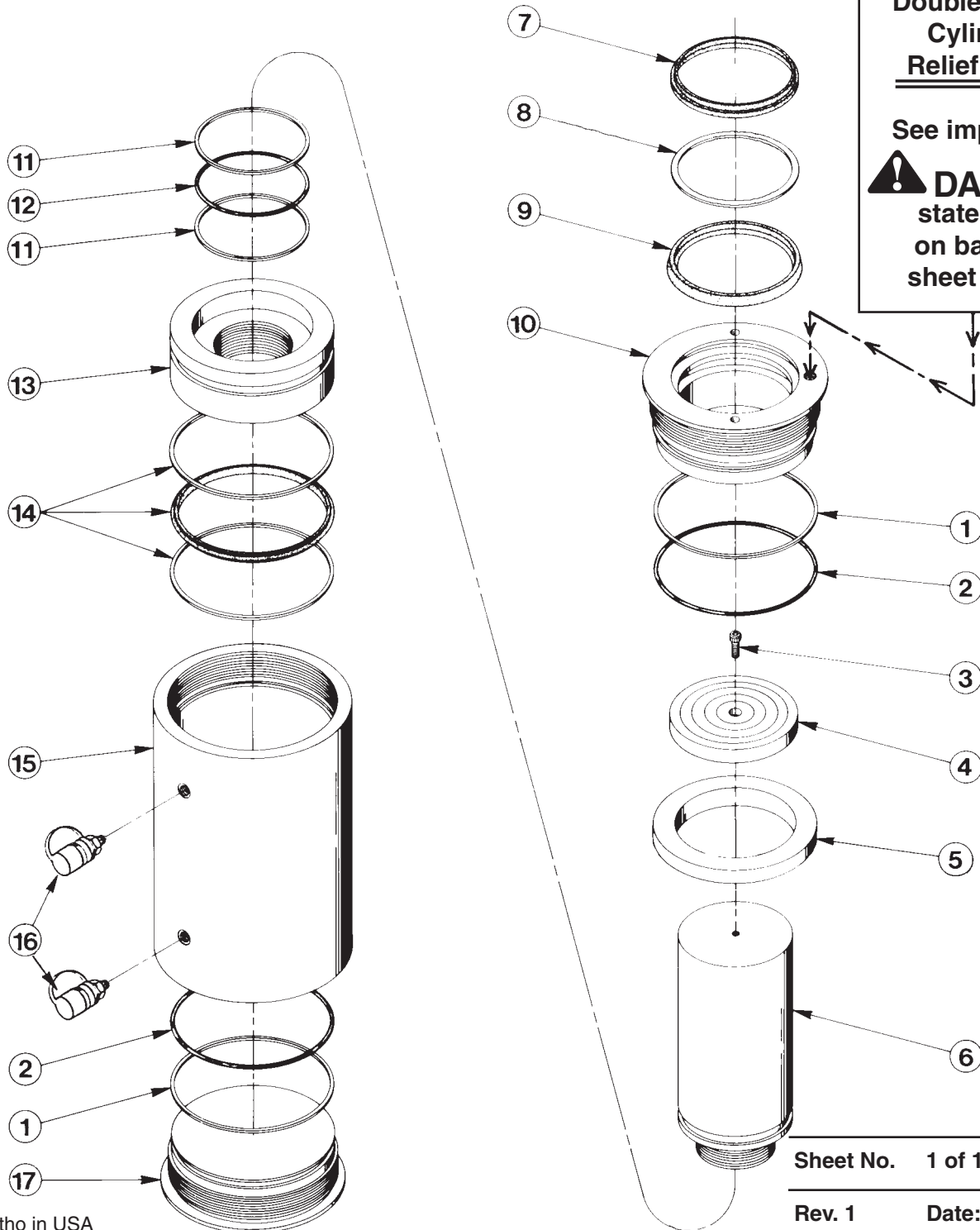

Litho in USA

Sheet No. 1 of 1

Rev. 1

Date: 17 May 1999



DANGER: To help avoid possible serious personal injury or death,

- In the event that the cylinder retract port is ever restricted or plugged, a double-acting cylinder relief valve will help prevent excessive pressure from building in the cylinder. **DO NOT** attempt to adjust or service this relief valve! If oil leakage is detected from this relief valve, discontinue use of the cylinder immediately and contact **Power Team Technical Services**. Only Power Team Authorized Hydraulic Service Centers should service this relief valve.

Item No.	Part No.	No. Req'd	Description
1	*212680	2	Backup Washer (10" x 9-1/2 x .095)
2	*212682	2	O-ring (10" x 9-1/2 x 1/4)
3	252356	1	Cap Screw (3/8-16 UNC x 5-1/2" Lg.)
4	421436	1	Serrated Insert
5	47366	1	Spacer (for RD40066)
†6	58885-" "	1	Piston Rod
7	*212686	1	Rod Wiper
8	*212685	1	Backup Washer (8" x 7-1/4 x 1/8)
9	*212684	1	U-cup
10	61419	1	Piston Retainer (Torque to 1000 ft. lbs.)
11	*212679	2	Backup Washer (7-1/4 x 6-3/4 x .095)
12	*212683	1	O-ring (7-1/4 x 6-3/4 x 1/4)
13	52720	1	Piston Head
14	*212681	1	T-seal and Backup Rings
†15	65425-" "	1	Cylinder Body
16	9796	2	Ram Half Coupler with Dust Cap
17	58886	1	Retainer Nut (Torque to 650 ft. lbs.)

PARTS INCLUDED BUT NOT SHOWN

37782	1	Warning Decal
351390	1	Trade Name Decal
52724	1	Handle Assembly (for RD4006, RD40013 & RD40066)
58264	2	Handle Assembly (for RD40042)

Part numbers marked with an asterisk (*) are contained in Repair Kit No. 300467.

† To order the correct piston rod and cylinder body for your specific model, list the stroke length as a suffix to the item part number.

For example: 58885-6 = 6" stroke
58885-13 = 13" stroke
OR
65425-42 = 42" stroke
65425-66 = 66" stroke

Note: Shaded areas reflect last revision(s) made to this form.

Refer to any operating instructions included with this product for detailed information about operation, testing, disassembly, reassembly, and preventive maintenance.

Items found in this parts list have been carefully tested and selected. **Therefore: Use only genuine replacement parts!**

Additional questions can be directed to our Technical Services Department.