

SPX Corporation
2121 West Bridge Street
Owatonna, MN 55060 USA
Phone: (507) 455-7100
Tech. Services: (800) 477-8326
Fax: (800) 765-8326
Order Entry: (800) 541-1418
Fax: (800) 288-7031

International Sales: (507) 455-7150
Fax: (507) 455-7122
Internet Address:
<http://www.powerteam.com>

Parts List for:

Form No. 100420

9577
V33

3 POSITION, 3-WAY MANUAL – TANDEM CENTER – PUMP MOUNTED VALVE ASSEMBLY

Maximum Capacity: 10,000 PSI

To Parts
List

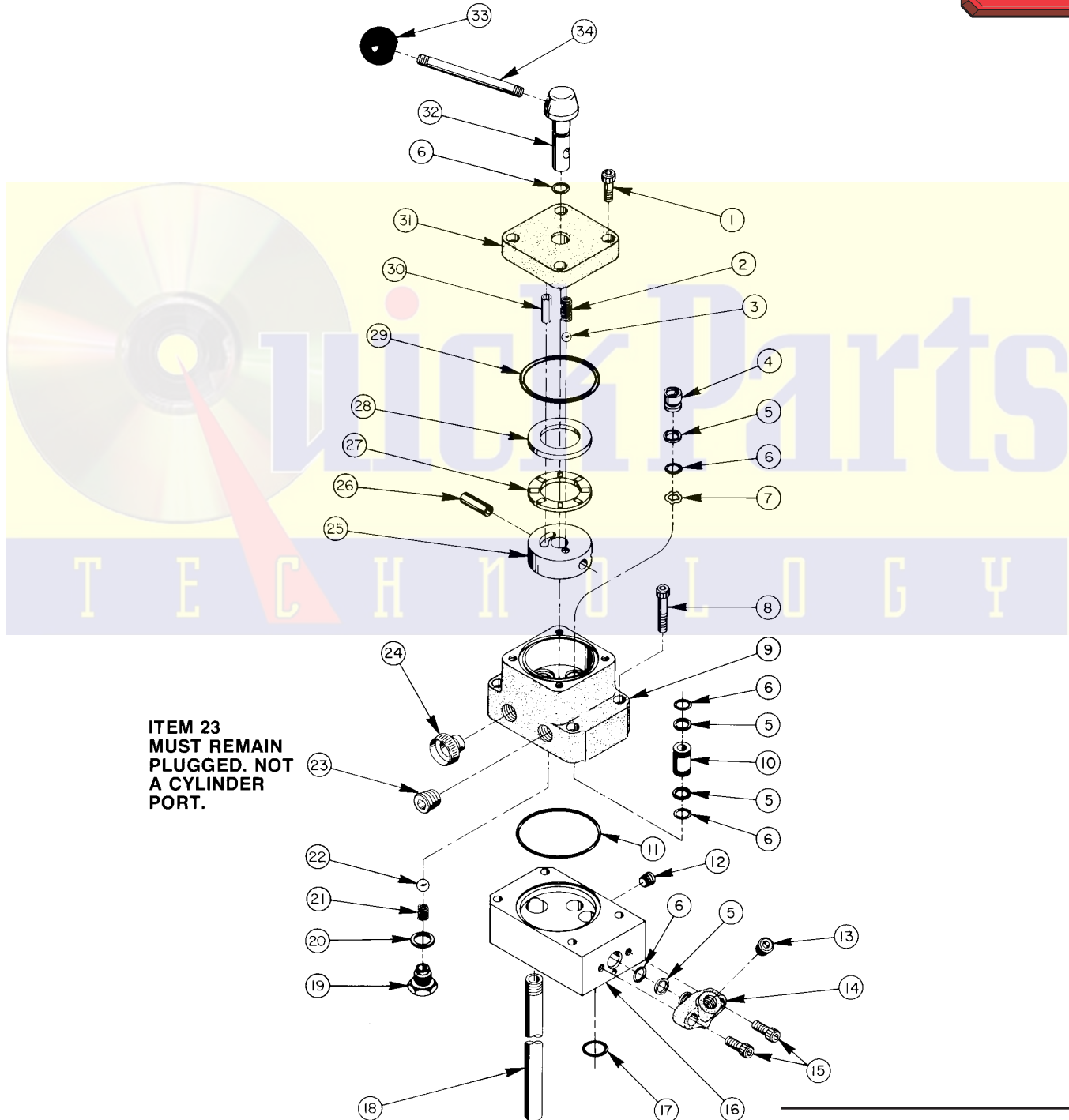

Sheet No. 1 of 1

Rev. Date: 1 Sept. 1982

Parts List, Form No. 100420, Back sheet 1 of 1

Item No.	Part No.	No. Req'd	Description
1	10008	4	Cap Screw (1/4-20 X 3/4 Lg.)
2	16320	1	Compression Spring
3	10375	1	Steel Ball (1/4" Dia.)
4	202480	3	Seal
5	*11863	6	Backup Washer (Teflon)
6	*10268	7	O-ring (3/8 X 1/2 X 1/16)
7	*21975	3	Spring Washer
8	10855	4	Cap Screw (1/4-20 X 2-3/4" Lg.)
9	50957	1	Valve Body
10	202505	1	Bushing
11	*16670	1	O-ring (2-1/2" X 2-3/8" X 1/16)
12	10427	1	Pipe Plug (1/8 NPTF)
13	10479	1	Pipe Plug (1/4 NPTF)
14	20866	1	Gauge Fitting
15	10006	2	Cap screw (1/4-20 X 5/8 Lg.)
16	51045	1	Sub Plate
17	*10302	1	O-ring (3/4 X 5/8 X 1/16)
18	200609	1	Drain Tube
19	29784	1	Valve Screw (Torque to 30/35 ft. lbs.)
20	*14874	1	Copper Washer
21	10444	1	Compression Spring

Item No.	Part No.	No. Req'd	Description
22	10378	1	Steel Ball (3/8 Dia.)
23	10909	1	Pipe Plug (3/8 NPTF)
24	11036	1	Aluminum Plug (3/8 NPTF)
25	36789	1	Rotor
26	10496	1	Roll Pin (5/16 X 1" Lg.)
27	11228	1	Needle Bearing
28	11227-1	1	Bearing Race
29	*11229	1	O-ring (2-3/8" X 2-3/16" X 3/32)
30	11916	1	Roll Pin (1/4 X 7/8 Lg.)
31	36788	1	Valve Body Cap
32	21920	1	Valve Stem
33	10731	1	Knob
34	21639	1	Stud

PARTS INCLUDED BUT NOT SHOWN

202516	1	Porting Decal
202518	1	Trade Name Decal (For V33)
204425	1	Patent Decal
208416	1	Corporate Decal (For 9577)

Part numbers marked with an asterisk (*) are contained in Repair Kit No. 300139.

To
Drawing

SPECIFICATIONS

This is a pump mounted, manually-operated, detent 3-position, 3-way valve for use with power units. It is of a low torque design for use with single-acting or spring return cylinders. A pressure switch and/or gauge may be attached if required.

OPERATION

POSITION "A": Pressure to Port "A"

POSITION "B": Port "A" to tank.

POSITION "C": Neutral. Cylinder port "A" is blocked thereby maintaining pressure. Oil circulates through valve from pump to tank.

NOTE: Pressure holds without loss when shifted from the cylinder port to "hold" position.

Port Sizes: 3/8 NPTF

Maximum Pressure: 10,000 PSI

Maximum

Recommended Flow: 5 GPM

J.I.C. SYMBOL

