

# SM0034 - Speed-Midget 4 Ton Hydraulic Ram

330049 PISTON ASSEMBLY  
INCLUDES:  
330030 & 313573

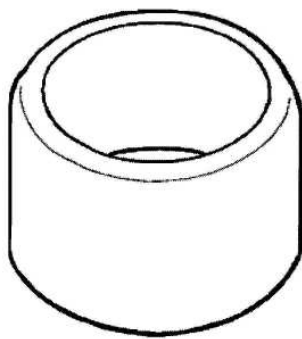

— 212942 PROTECTOR RING

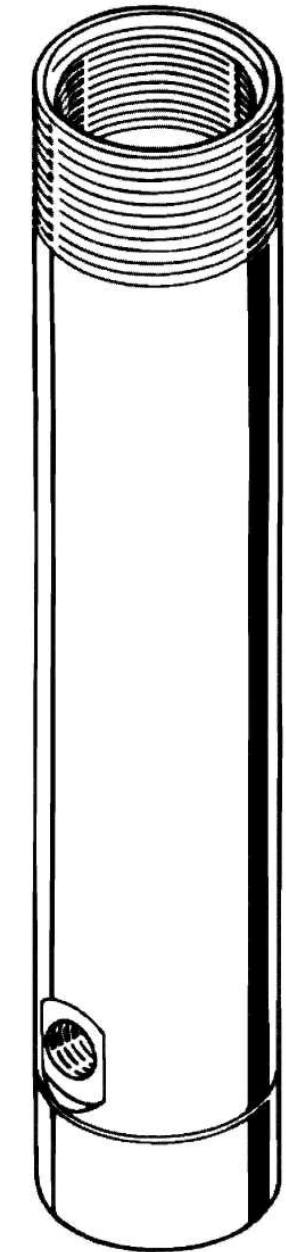

— 330159 CYLINDER

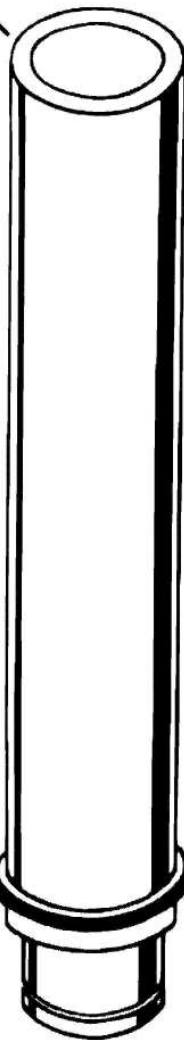

— 330030 PISTON



— 312987 COLLAR, GUIDE

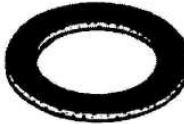

— 212989 WASHER, BACK-UP



— 212984 U-CUP



— 212985 RETAINING RING

330183 WIPER RING —

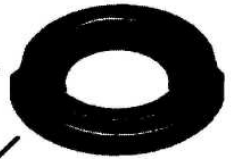

REPLACED ONE PIECE  
ASSEMBLY JUNE 1999

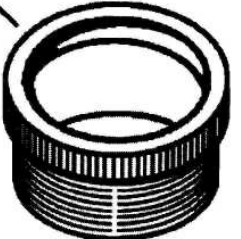

312938 COLLAR  
UPPER GUIDE  
WITH WIPER RING



330228 SWIVEL, SPRING



330156 SCREW  
SPRING RETAINING

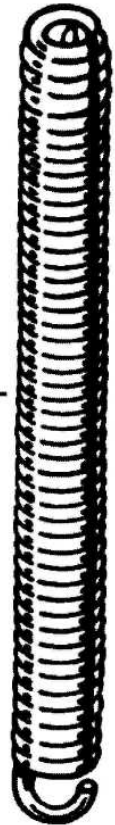

312945 SPRING



— 210271 SCREEN

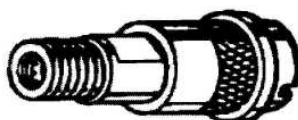

— BU0602 COUPLER



212951 SCREW, SPRING RETAINING

# SM0034 4-TON RAM

## SERVICE INSTRUCTIONS

### DISASSEMBLE:

- 1) Collapse to lowest position and remove ram half coupler (BU0602).
- 2) Remove screen (210271) from hose hole.
- 3) Remove spring screw (212951) from base of hose hole to release spring (312945).
- 4) Remove upper collar bearing (312938).
- 5) Grasp cylinder (330159) with the hose hole up while removing piston (330030). If piston sticks, hold cylinder (lightly) in a smooth vise.
- 6) With retaining ring pliers, remove packing retaining ring (212985).
- 7) In succession, remove "U" cup (212984), back-up washer (212989) and ram guide collar (312987).

### REASSEMBLE:

- 1) Check cylinder (330159) and guide collar (312987) for scoring and fit. Check all metal parts for wear, burrs or damage.
- 2) Thoroughly clean all metal parts.
- 3) Assemble guide collar (312987) to piston (330030). *Make sure recess in guide collar is toward (313573) retaining ring on piston.*
- 4) Place back-up washer (212989) against guide collar on piston.
- 5) Place "U" cup (212984) with flat side against back-up washer on piston.
- 6) With retaining ring pliers place retaining ring (212985) in groove on end of piston.
- 7) Coat outer race of guide collar, back-up washer and "U" cup with medium consistency, high temperature, bearing grease and insert piston assembly into cylinder until it reaches bottom.
- 8) Align loop in spring (312945) with screw hole in hose hole of cylinder.
- 9) Replace spring screw (212951) into screw hole in hose hole of cylinder to secure spring. Tighten securely.
- 10) Apply a drop or two of thread adhesive, screw on upper collar bearing (312938) and tighten by hand. *Do not use a permanent thread adhesive.*
- 11) Insert screen (210271) into hose hole.
- 12) Apply thread sealant to ram half coupler (BU0602) and screw into hose hole. *Be careful to avoid mixing sealant with hydraulic fluid by skipping the first three threads of the inserted portion of the coupler.* Tighten securely.
- 13) Attach ram to pump and test for leaks and operation.