

# PARTS LIST



MODEL  
**No. 1780**  
**HIGH LIFT TRANSMISSION JACK**  
CAPACITY  
**2000 Lbs.**

CAT.  
NO. **1780**

SERIAL NO. AFFECTED  
**1001—**

SHEET **1** OF **1**

ISSUE DATE  
**7-22-74**

FORM NUMBER  
**13223**

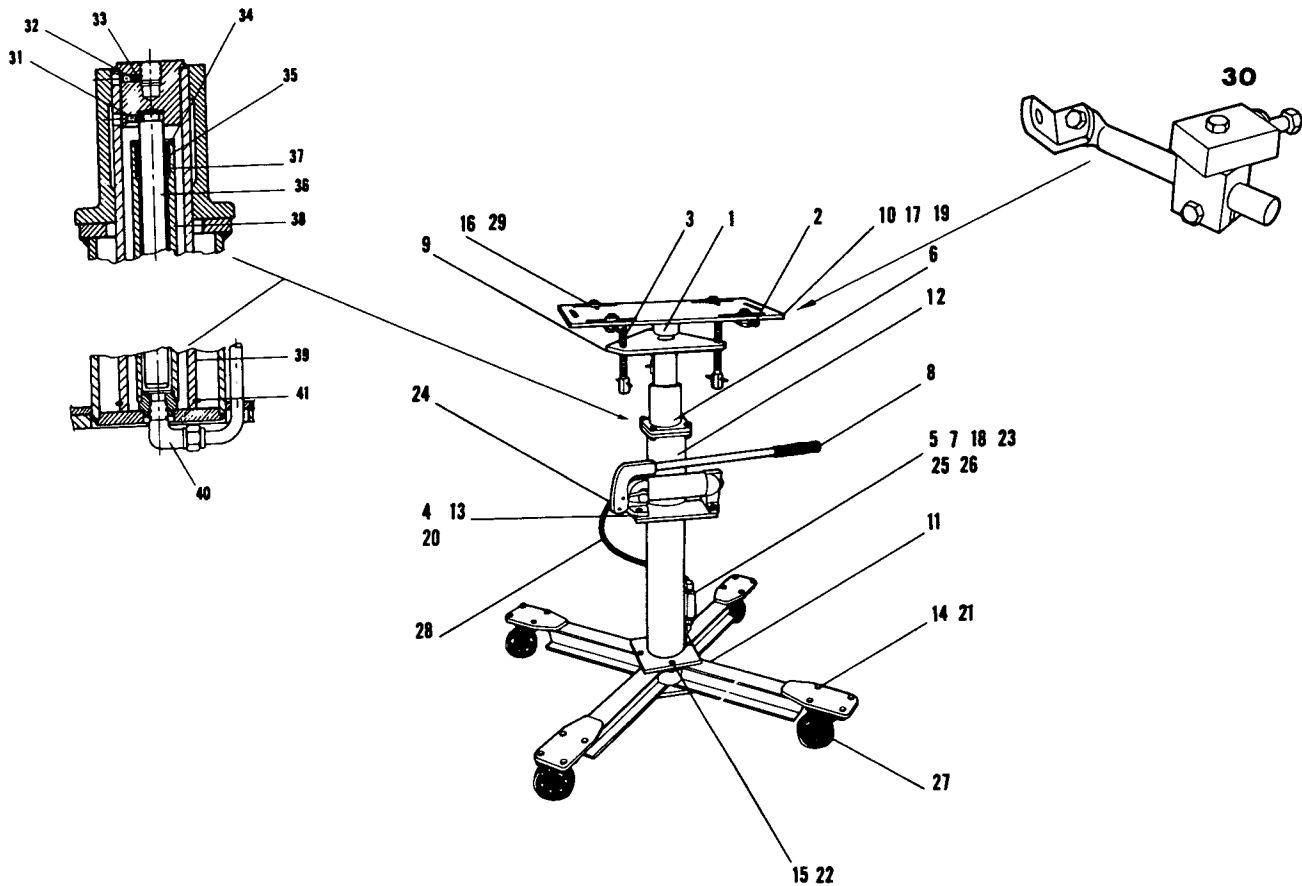

SEE OTHER SIDE

**OWATONNA TOOL COMPANY**  
CABLE ADDRESS: TOOLCO

OWATONNA, MINNESOTA 55060 • U.S.A.  
PHONE: (507) 451-5310

# PARTS LIST

Item No.	Part No.	No. Req'd	Description	Item No.	Part No.	No. Req'd	Description
1	24123	1	Ball Hitch & Pivot Block Assembly	21	10204	20	Hex Nut
2	24134	4	Extension	22	10206	4	Hex Nut
3	24135	3	Screw Assembly	23	10241	2	Lock Washer
4	24147	1	Spacer	24	10469	1	Adaptor Union
5	30850	1	Pressure Compensated Flow Control Valve	25	10474	1	Street Elbow
6	31862-BL21	1	Guide Casting	26	10662	1	Tube Connector
7	31878	1	Pipe	27	10837	4	Caster
8	Y21-1RT	1	Hand Pump	28	Y21-9	1	Hose
9	40580	1	Plate	29	11640	4	Flat Washer
10	50238	1	Top Mounting Plate	30	1718	4	Universal Arm Ass'y
11	50242	1	Base - Ass'y - Weld	31	10137	1	Socket Set Screw
12	50244	1	Cylinder Support Assembly	32	10519	1	Socket Set Screw
13	10035	4	Hex Head Cap Screw	33	21086	1	Brass Plug
14	10052	20	Hex Head Cap Screw	34	12038	1	Retaining Ring
15	10067	4	Hex Head Cap Screw	35	24131	1	Bushing
16	10079	4	Hex Head Cap Screw	36	31866	1	Piston Rod
17	12118	4	Hex Nut	37	12037*	1	Disogrin "U" Cup
18	10168	2	Sc. Sl. Rd. Hd.	38	24128	1	Cylinder Assembly
19	10190	4	Sc. Mach. Sl. Flat Head	39	31864	1	Guide Tube
20	10202	4	Hex Nut	40	10665	1	Elbow 90°
				41	12039	1	Retaining Ring
					31854	2	Chain & Eye Bolt Assembly

\*Part number marked with an asterisk (\*) is contained in Repair Kit #27034.

## GUARANTEE

The Owatonna Tool Company guarantees its equipment products against defects in workmanship and material for 90 days from date of delivery to the user. Only exception is chain which follows the trade custom of its manufacturers and cannot be guaranteed.

When question of warranty arises, the user should send his unit to the nearest OTC authorized service station for inspection, transportation to be prepaid and evidence of delivery date furnished.

If the difficulty comes under the terms of our guarantee, we will repair or replace parts affected and return prepaid. If the difficulty does not come under the terms of our guarantee, you will be so notified along with an estimation of charges for repair and return.

This guarantee is limited to the repair or replacement of any part or parts which are found by us to be defective and does not cover ordinary wear and tear, abuse, misuse, overloading, altered products or use of improper fluid.

**OWATONNA TOOL COMPANY**  
CABLE ADDRESS: TOOLCO

**OWATONNA, MINNESOTA 55060 • U.S.A.**  
PHONE: (507) 451-5310