



A division of SPX Corporation
655 Eisenhower Drive
Owatonna, MN 55060-0995 USA
Phone: (507) 455-7000
Tech. Serv.: (800) 533-6127
Fax: (800) 955-8329
Order Entry: (507) 455-1480
Fax: (800) 283-8665
International Sales: (507) 455-7223
Fax: (507) 455-7746

Form No. 100764

Parts List for:

1585
1586
1587
61933

Power Train Lift

Insert screen here before assembling Quick Connect Fitting. (Screens are contained in Literature Pack.)

For Pump Ass'y,
see sheet 2 of 2.

Detail "A"

Grease
these
areas.

5 (See Detail "A")

6 (See Detail "B")

For Cylinder Ass'y,
see sheet 2 of 2.

(See Detail "C")

Grease
these
areas.

Detail "B"

Detail "C"

Sheet No. 1 of 2

Issue Date: Rev. 10-1-91

Item No.	Part No.	No. Req.	Description
1	13201	2	Cap Screw (3/8-16 x 2-3/4 Lg.)
2	10983	2	Cap Screw (5/8-11 x 5-1/2 Lg.; Grade 8)
3	13324	6	Washer (for 5/8" bolt)
4	215214	2	Tube
5	215215	1	Swivel
6	53345	1	Mast
7	10247	2	Lockwasher (for 3/8" bolt)
8	10204	2	Nut (3/8-16)
9	207514	4	Cap Screw (7/16-14 x 4-1/2 Lg.)
10	10232	4	Washer (for 7/16" bolt)
11	216432	2	Locknut (5/8-11)
12	212434	4	Washer (for 7/8" bolt)
13	216433	2	Locknut (7/8-9)
14	308873	2	Tube
15	11901	2	Retaining Ring (for 5/8" shaft)
16	308877	1	Pivot Pin
17	215222	4	Caster
18	213026	1	Plate
19	15603	4	Flange Nut (7/16-14)
20	10110	4	Acorn Nut (1/2-20)
21	215224	4	Tube Cap
22	53344	1	Base
23	215223	4 ft.	Non-Skid Adhesive Strip (apply 1 ft. strip to each leg)
24	308874	1	Tee
25	216431	2	Cap Screw (7/8-9 x 6-1/2 Lg.; Grade 8)
26	10948	1	Cap Screw (5/16-18 x 1-1/2 Lg.; Torque to 350 - 400 in. lbs.)
27	211060	4	Thread Forming Plastic Screw
28	53346	1	Pump Bracket

PARTS INCLUDED BUT NOT SHOWN

215225	1	Warning Decal
304710	2	Trade Name Decal
216703	1	Made in USA Decal
217825	1	Danger Decal

Refer to any operating instructions included with the product for detailed information about operation, testing, disassembly, reassembly, and preventive maintenance.

Items found in this parts list have been carefully tested and selected by OTC. Therefore: Use only OTC replacement parts!

Additional questions can be directed to the OTC Technical Services Department.

#47704 Tilt Table Assembly
(see Form #102579 for parts breakdown)

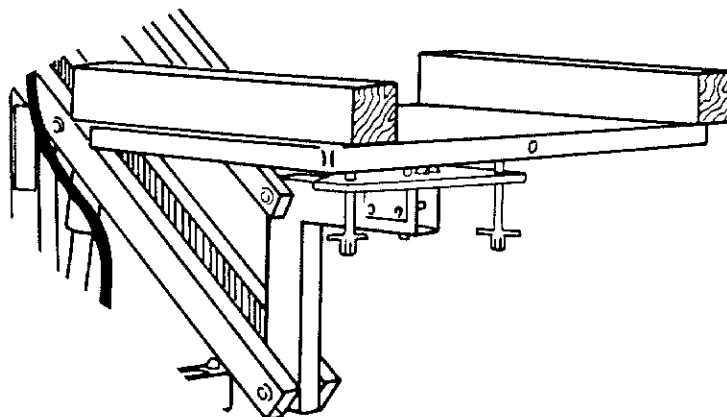

#62339 Fuel Tank Handler
(see Form #102700 for parts breakdown)

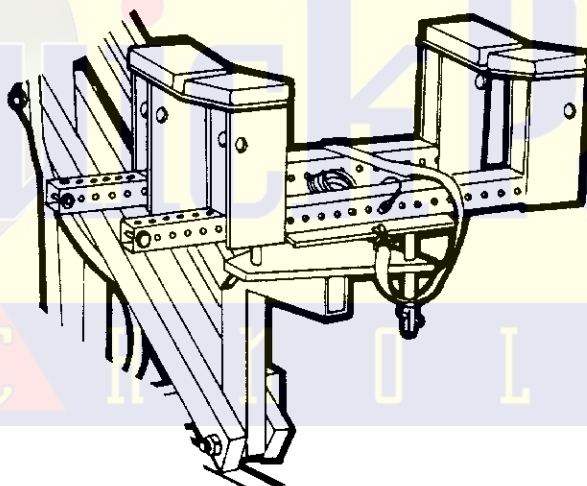

215324 Universal Transmission Adapter Assembly
(see Form #102574 for parts breakdown)

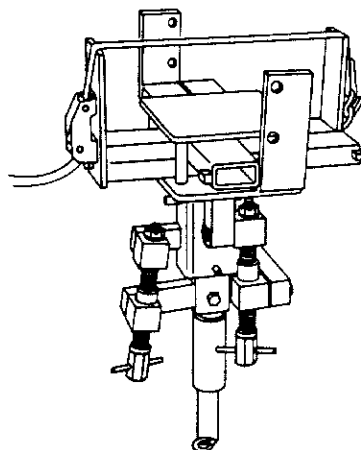

Sheet No. 2 of 2

Issue Date: Rev. 10-1-91

PUMP and RAM ASSEMBLY

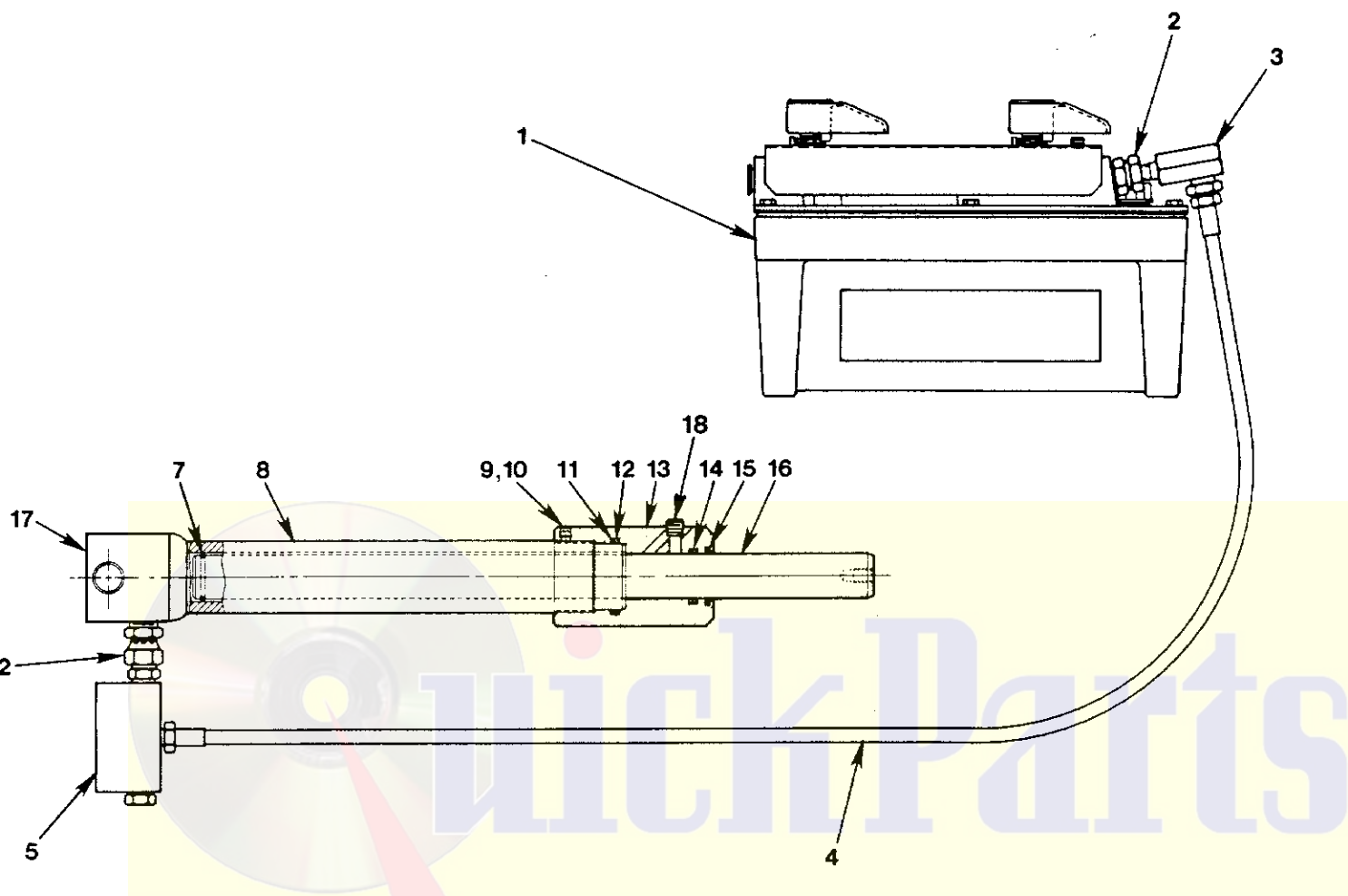

Item No.	Part No.	No. Req'd	Description	Item No.	Part No.	No. Req'd	Description
1	53334	1	Pump (see Form #100718)	11	* 19144	1	Backup Washer (1-3/4 x 1-1/2 x 1/16, -222)
2	10469	2	Straight Fitting	12	* 10282	1	O-ring (1-3/4 x 1-1/2 x 1/8, -222)
3	10470	1	90° Elbow Fitting	13	47527	1	Cylinder Cap
4	39913	1	Hose	14	* 14527	1	"U" Cup
5	28824	1	Flow Control	15	* 15514	1	Rod Wiper
7	16072	1	External Retaining Ring	16	308881	1	Rod
8	308882	1	Cylinder End	17	47526	1	Cylinder Assembly (consists of Items 7 - 16)
9	* 15528	1	Nylon Ball (3/16" Dia.)	18	11084	1	Plug (1/16 NPTF)
10	* 10136	1	Set Screw (1/4-20 x 1/4 Lg.; Torque to 50/70 in. lbs.)				

Part numbers marked with an (*) asterisk are contained in Repair Kit #300496.

- Bleeding the Hydraulic System:** Air can accumulate in the hydraulic system, causing the ram to respond slowly or in an unstable manner. To remove the air:
- 1. Fully retract piston rod (Item #16).
 - 2. Remove bleed plug (Item #18).
 - 3. Run pump to slowly extend piston rod until oil starts to flow out bleed hole.
 - 4. Install bleed plug again.
 - 5. Check oil level in reservoir, and add oil if needed.