



MODEL 71150

## PORTABLE FLOOR SERVICE JACK

### OWNERS MANUAL

PATENT  
PENDING

#### important

Please read these instructions carefully before using your jack. Proper use and care of the jack will help to assure you of continuous, safe, trouble-free performance and will help avoid any warranty problems.

#### specifications

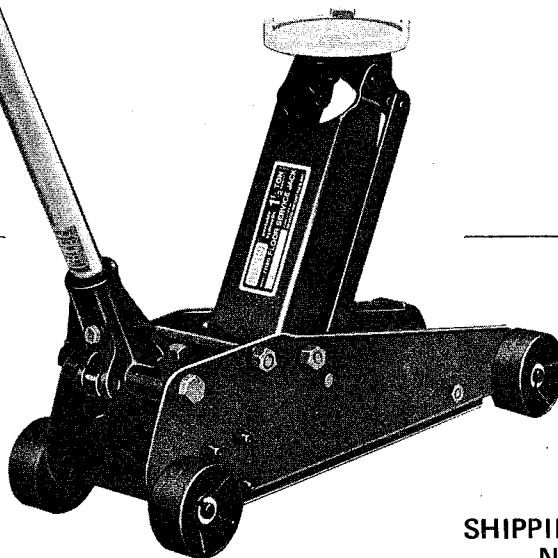

SHIPPING WT: 36 LBS.  
NET WT: 35 LBS.

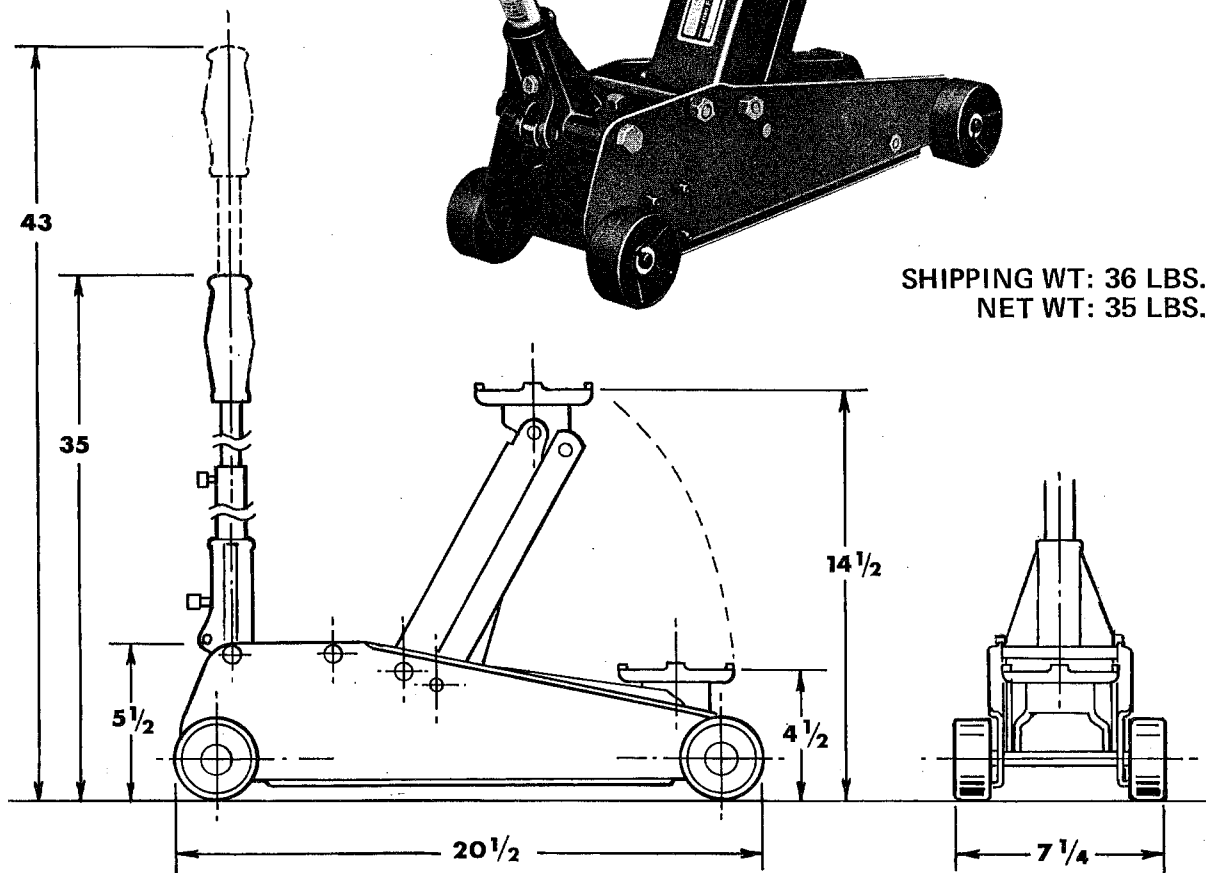

## CAUTION

**THIS JACK IS DESIGNED FOR JACKING PURPOSES ONLY. AFTER JACKING, ALWAYS USE SAFETY STANDS TO SUPPORT LOAD BEFORE MAKING REPAIRS. FOR YOUR SAFETY—DO NOT OVERLOAD THIS JACK BEYOND ITS RATED CAPACITY.**

## operating instructions

### Installing the Handle

Back out lower Hex Head Bolt and insert handle into handle base as shown. Rotate handle slightly to make sure hex opening fully engages Release Valve Key. Handle must be all the way into handle base (up to RED LINE) or Jack will not lower. When Handle is fully engaged with Key, Turn Hex Head Bolt into Handle Base all the way until snug.

**IMPORTANT:** Sometimes during shipment and handling, air gets into the hydraulic system, causing poor lifting performance. Purge any air from the system by fully opening Release Valve (turn handle counter-clockwise all the way); then, while holding the saddle down, operate pump handle rapidly several times.

### Positioning under Load & Raising Jack

1. Close Release Valve **TIGHTLY** by turning handle **CLOCKWISE**.
2. Extend handle length if needed by releasing upper handle Snap Lock and pulling out upper handle until mating hole lines up with Snap Lock button. Release button to lock handle in place.
3. Position jack under load so that saddle will contact load firmly and is centered by slip lugs so it cannot slip.
4. Operate jack handle until saddle approaches contact with load. Once again, check to see that saddle is correctly positioned and load is "LOCKED IN" by Slip Lugs. Raise load to desired height.

### Lowering the Jack

Open Release Valve **VERY SLOWLY** by turning handle **COUNTER-CLOCKWISE**.

## maintenance procedures

**IMPORTANT:** When adding or replacing oil, always use a good grade hydraulic jack oil. Avoid mixing types of oil. **DO NOT** use Brake Fluid, Alcohol, Glycerine, detergent motor oil or dirty oil. Improper fluid can cause serious internal damage to jack. When adding oil, be **VERY CAREFUL** not to permit dirt or any foreign matter to get into the system.

Check Ram and Plunger every 3 months for any signs of rust or corrosion. Clean as needed and wipe with an oily cloth. When not using the jack, always leave the Saddle all the way down. Add grease to Lift Arm Fitting at least twice yearly, depending upon usage.

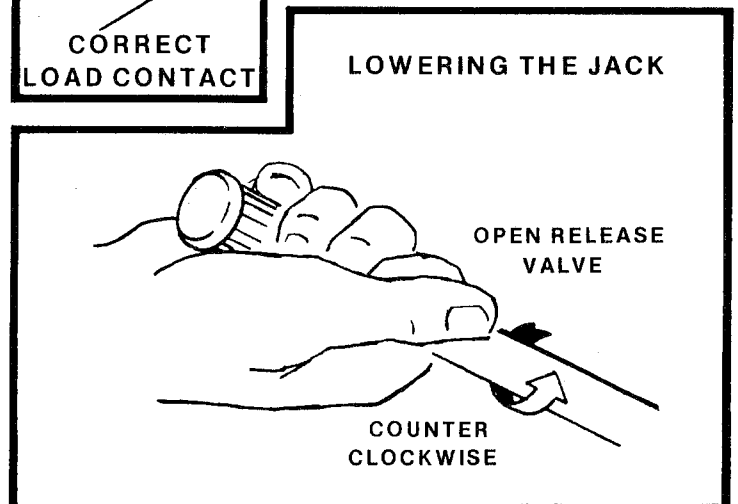
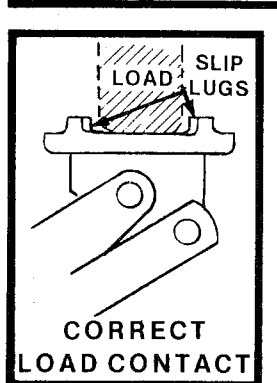
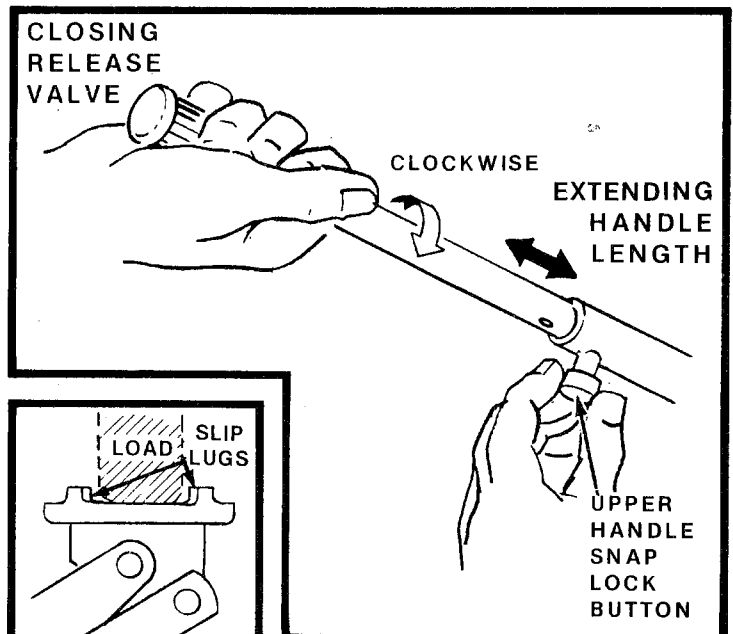
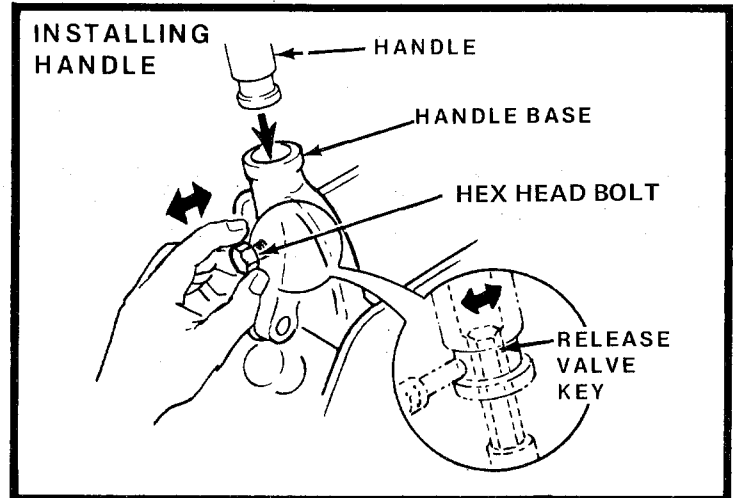

# repair parts

MODEL 71150

## FLOOR SERVICE JACK

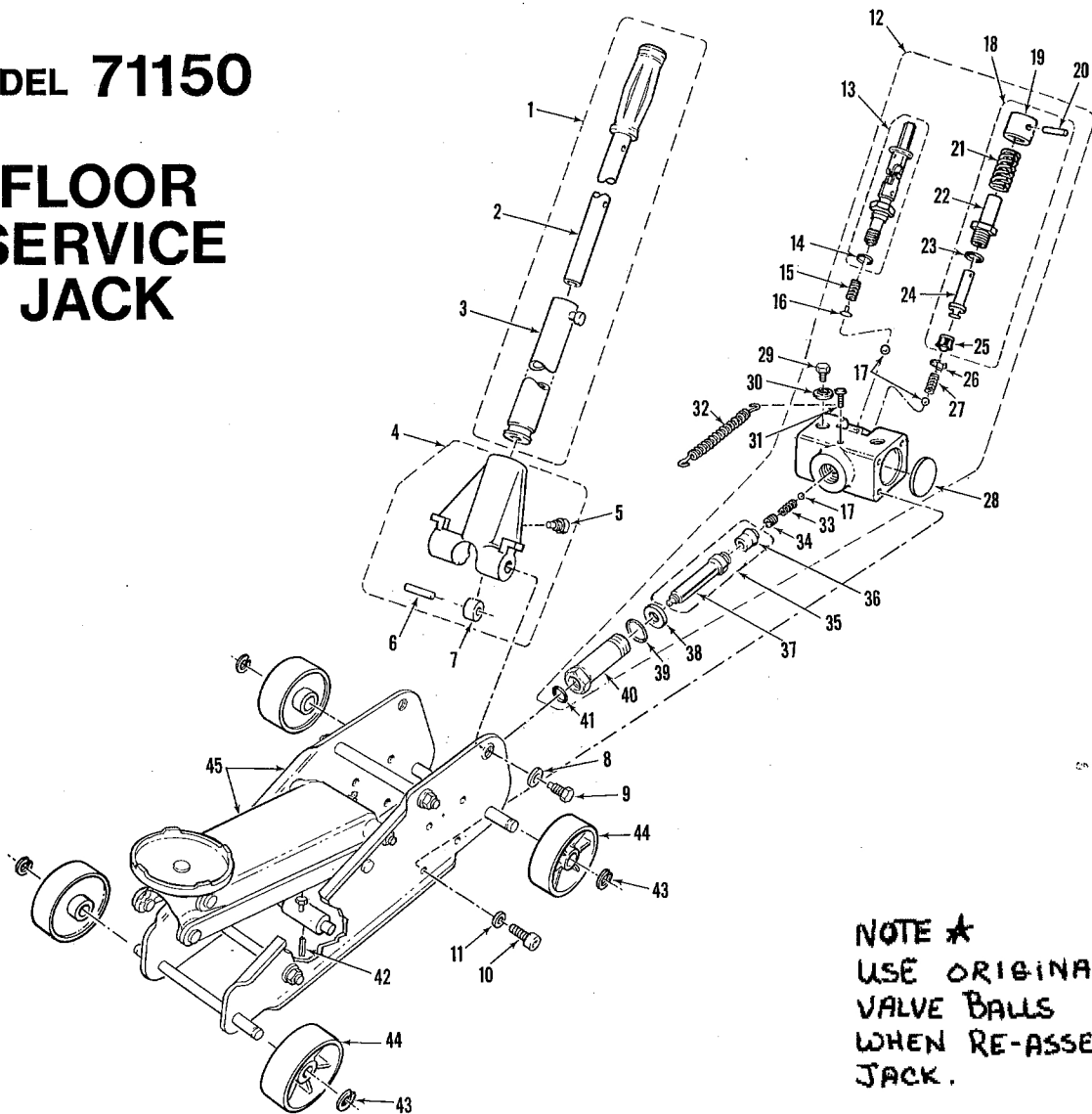

**NOTE \***  
USE ORIGINAL  
VALVE BALLS  
WHEN RE-ASSEMBLING  
JACK.

INDEX NO.	PART NO.	DESCRIPTION	INDEX NO.	PART NO.	DESCRIPTION	INDEX NO.	PART NO.	DESCRIPTION
1	213040	Handle Assy — complete <i>includes:</i>	15	4004	Spring-overload	34	3005	Screw
2	212005	Upper Handle Assy	16	213016	End Cap	35	213045	Ram Assy <i>includes:</i>
3	212010	Lower Handle Assy	17	9001	Check Ball 7/32"	36	8019	Cup-packing
4	213050	Handle Base Assy <i>includes:</i>	18	213020	Pump Assy <i>includes:</i>	37	213026	Ram
5	3047	Bolt — Hex Hd 1/4-20	19	213023	Cap	38	213031	Gasket-Rubber
6	7026	Pin	20	7034	Pin	39	213034	Ring-backup
7	212027	Roller	21	4003	Spring	40	213030	Cylinder
8	2044	Lockwasher	22	213022	Body	41	8017	Split "O" Ring
9	213014	Screw-mtg.	23	8016	"O" Ring	42	7034	Pin
10	3034	Screw — 1/4-20	24	213021	Piston	43	2003	Snapring
11	2004	Lockwasher	25	8020	Cup-packing	44	212207	Wheel
12	213035	Oil Block Assy — complete <i>includes:</i>	26	213033	Retainer	45	213025	Frame & Elevator Arm Assy
13	213015	Release Valve Assy <i>includes:</i>	27	4009	Spring		213500	Repair kit
14	8018	"O" Ring	28	212103	Plug-freeze			
			29	3043	Bolt-Filler Plug			
			30	8011	Stat-o-seal			
			31	3002	Screw			
			32	4006	Spring			
			33	4005	Spring			

**ORDERING PARTS:** all parts orders must contain the following information:

(DO NOT ORDER BY INDEX NO. ONLY  
— such orders will not be processed)

1. PART NUMBER  
2. PART DESCRIPTION

3. QUANTITY DESIRED  
4. MODEL NO. &  
SERIAL NO. (if any)

Parts prices are according to current price lists and subject to change without notice.

## trouble shooting

This Trouble Shooting chart is intended as a guide to help solve only routine problems in hydraulic jack operation. If trouble persists, or problems occur which are not covered here or involve any internal malfunction, take the jack to your nearest authorized NORCO Service Center (refer to the list provided in the owner's envelope or consult your dealer)

PROBLEM	PROBABLE CAUSE	REMEDY
Lift Arm will not rise at all	1. Release Valve not closed.	Check to be sure the lower end of handle is fully engaged with the Release Valve hex key. Rotate handle clockwise until tight to close Release Valve. (See Operating Instructions)
	2. Ram Cylinder Check Ball not seating properly	Take jack to nearest authorized service center.
	3. Overload Check Ball not seating.	
	4. Overload Setting improper	
Lift Arm will go up only part way	1. Improper oil level — too low or too high.	Remove filler plugs and drain or add oil in both reservoirs. With ram fully retracted & plunger down and jack on level ground, proper level should read 1-1/4" on a dipstick. (See Maintenance Procedures)
	2. Air in hydraulic system	Open Release Valve. Push down on saddle & operate pump at same time. Pump about 10 times. Close Release Valve tightly.
	3. Overload Setting improper 4. Pump Intake Check Ball not seating	Take jack to nearest authorized service center
Lift Arm goes up, but will not stay up (even without load)	1. Ram Cylinder Check Ball not seating 2. Seal leakage	Take jack to nearest authorized service center
Will lift load, but will not hold	1. Ram Cylinder Check Ball not seating 2. Seal leakage	Take jack to nearest authorized service center
Jack operates OK with no load, but will not lift load	1. Load exceeds safe rated capacity of jack, Safety Overload is functioning	Determine amount of load, and use another jack with sufficient load capacity
Jack will not lower	1. Handle not fully engaged into Release Valve hex key	Insert handle fully into handle base — up to red line (see Operating Instructions)

Made in U.S.A. by



**INDUSTRIES INC.**

P.O. BOX 2045 • 344 W. 157TH ST.  
GARDENA, CALIF. 90247  
PHONE (213) 321-0970