

⚠ WARNING



- Lock lid and drawers before moving. • Apply brake on locking casters anytime cart is in place. • Do not pull cart. Push from handle on end to move. • Units can tip or fall causing damage or personal injury. • Cart is designed to roll easily on flat surfaces and should not be used on uneven or inclined surfaces.
- Do not open more than one loaded drawer at a time. • Do not stand on or step in drawers. • Keep children away from unit. • Wear gloves when lifting edges. • Before connecting to a power supply, always check to make sure the power supply corresponds to the voltage required on the product. • Fully insert plug to reduce the risk of electric shock. • Always unplug when not in use.
- Disconnect power before installing or servicing. • Do not try to plug in unit or product when hands are wet or damp, or if standing on a wet or damp surface or in water. • Never attempt to pick up unit or plugged in product that should fall in standing water. • This unit is not waterproof and is intended for general use indoors. • Do not use in potentially dangerous locations, such as flammable or explosive atmospheres. • Keep cord away from heat, oil, sharp edges or moving parts. • Failure to heed these warnings may result in personal injury and/or property damage.



WARNING: This product can expose you to chemicals including nickel which is known to the State of California to cause cancer and birth defects or other reproductive harm. For more information go to www.P65Warnings.ca.gov.

⚠ WARNING

SERVICE CART WEIGHT CAPACITY

Maximum Total Net Load	500 LBS
Top Lid of Cart	150 LBS
Bottom Shelf	150 LBS
3" Drawer(s) each	30 LBS each
4" Drawer	70 LBS each
5" Drawer	70 LBS each

PLEASE NOTE: Loading cart beyond rated capacity may cause structural damage to the cart as well as personal and/or property damage. Please educate your customers to the dangers of overloading. Do not attempt to push cart with items on the top lid.

ASSEMBLY INSTRUCTIONS

FIG. 1

Installing 4 pc. caster (#18/#23) onto the bottom tray (#17) with #19/#20/#21.

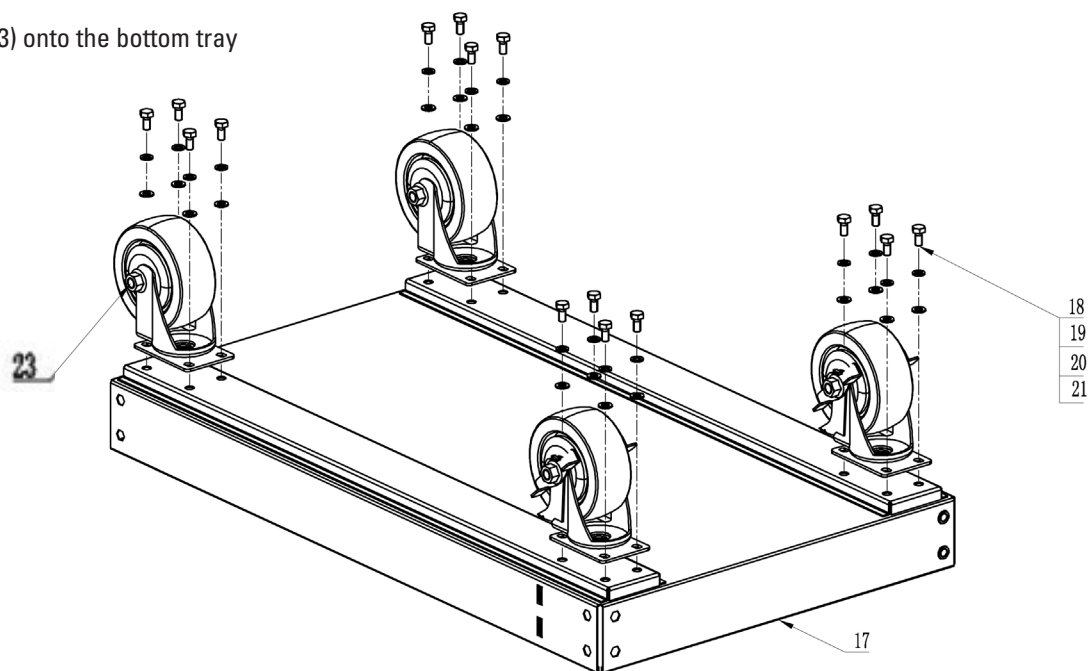

ASSEMBLY INSTRUCTIONS

FIG. 2

Install leg/bumper(#10,#11) onto the cart body (#8) and fasten with 12 bolts (#30).

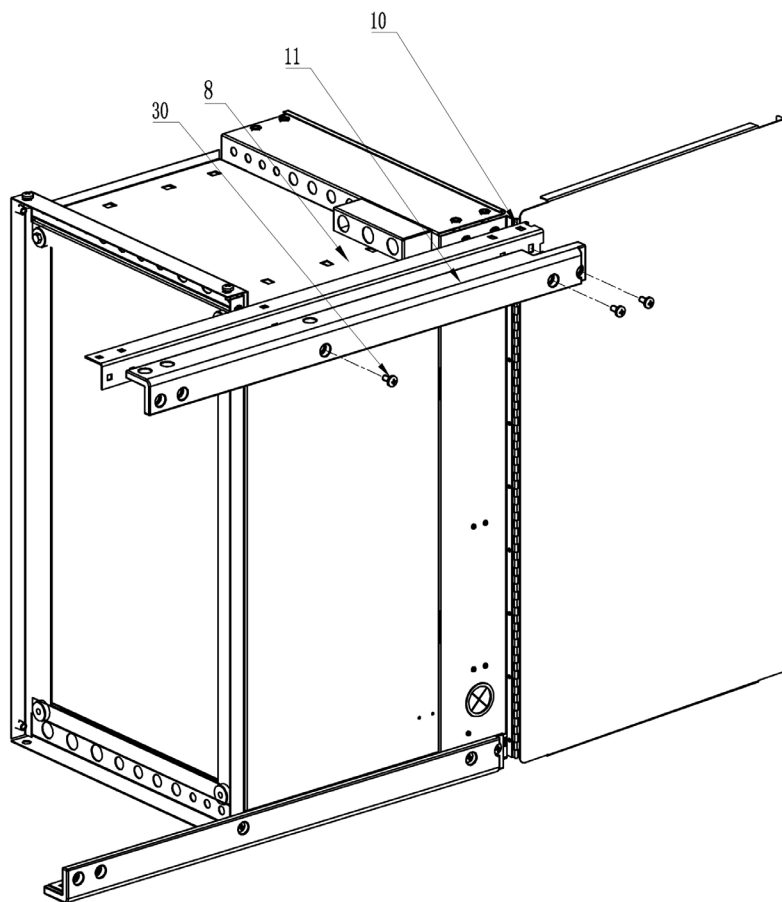
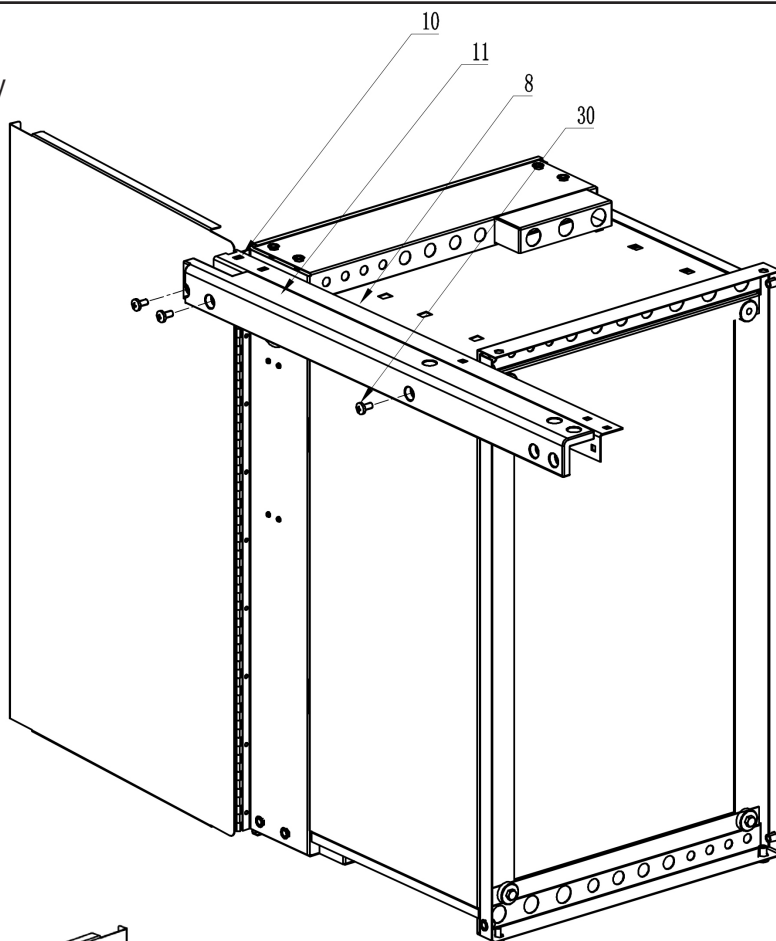
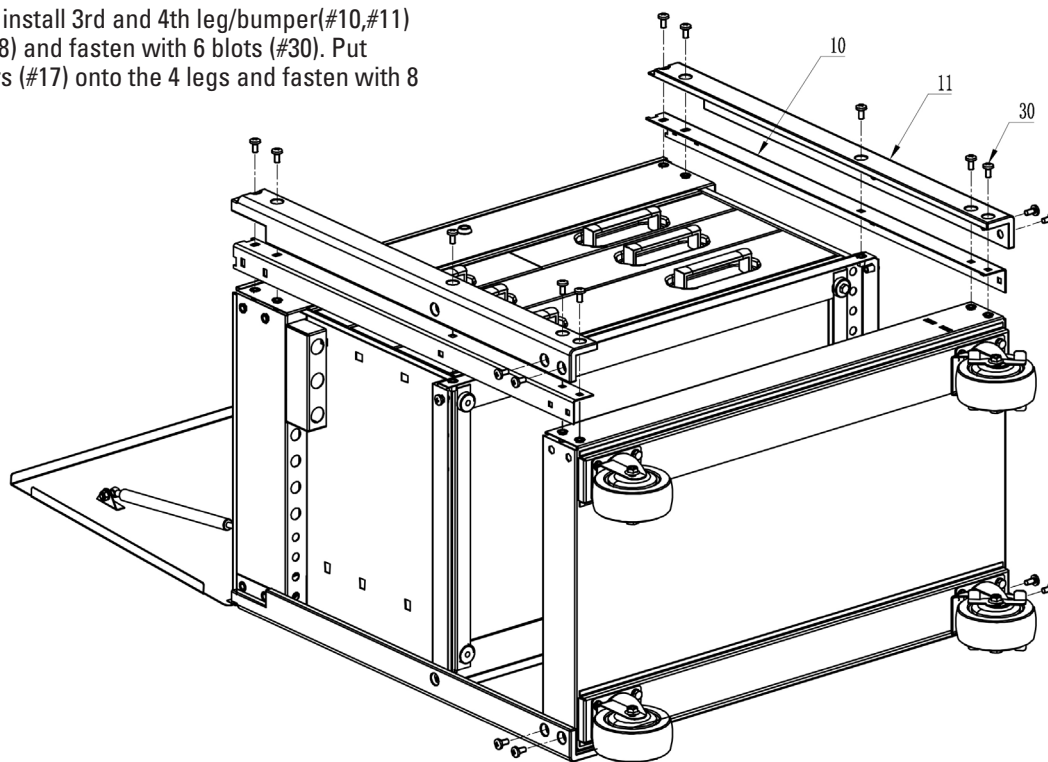

FIG. 3

Turn cart body 180° to install second leg/bumper (#10,#11) onto the cart body (#8) and fasten with 12 bolts (#30).

ASSEMBLY INSTRUCTIONS
FIG. 4

Turn cart body 90° to install 3rd and 4th leg/bumper(#10,#11) onto the cart body (#8) and fasten with 6 bolts (#30). Put bottom tray w/casters (#17) onto the 4 legs and fasten with 8 bolts (#30)

FIG. 5

Turn cart body 90° and fasten remaining 4 bolts (#30).

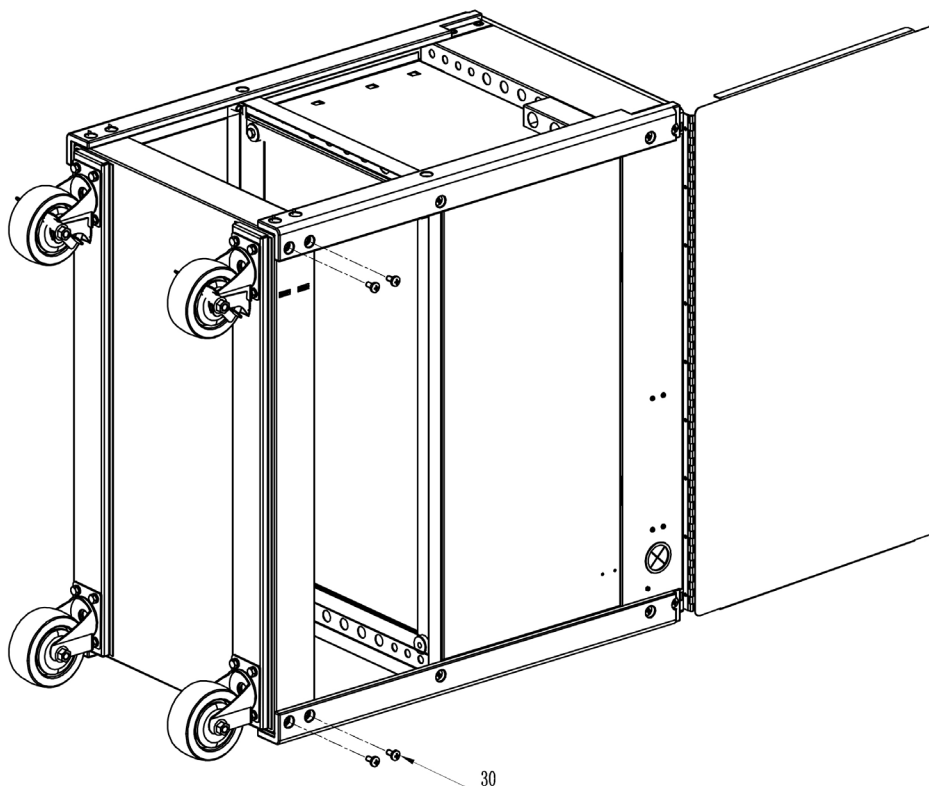

ASSEMBLY INSTRUCTIONS

FIG. 6

Mount the push handle (#7) to the same side of the cart as the locking casters, using the four bolts (#6) provided.

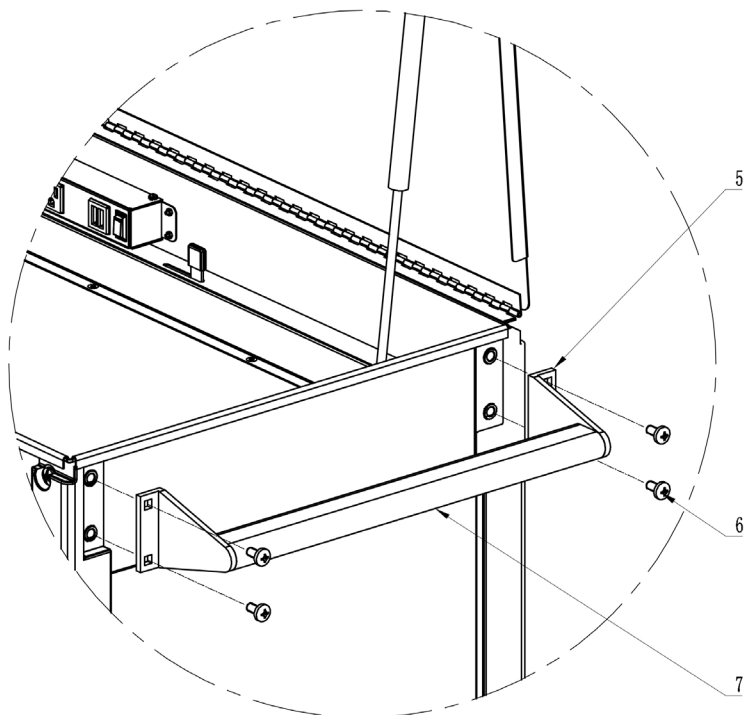
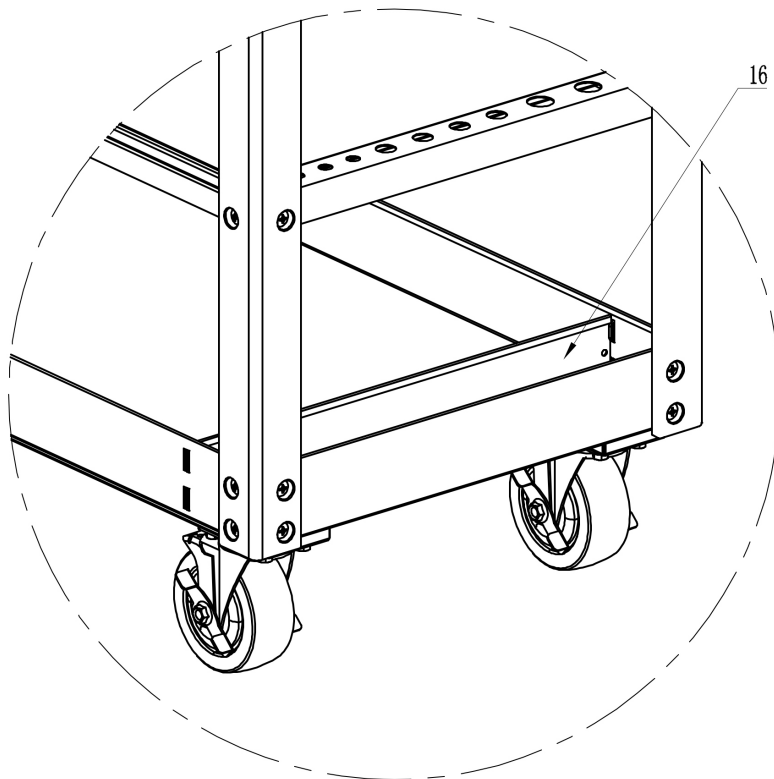
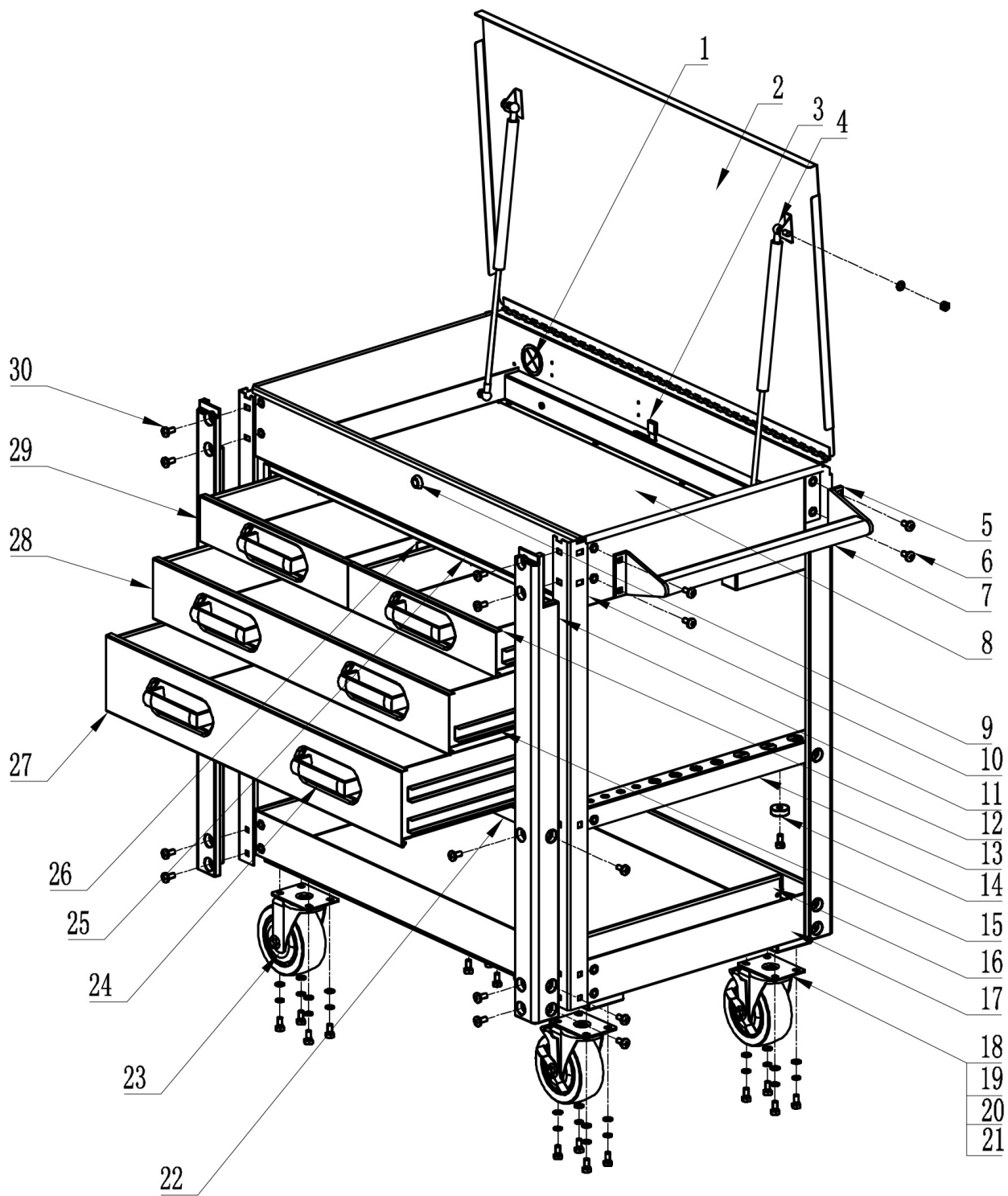

FIG. 7

Install Spray Can Divider (#16) onto the bottom tray



PARTS DRAWING



TROUBLESHOOTING

Problem: Drawers appear not to fit, do not slide in accurately and bump the cart sides.

Solution: The roller bearing slides must be fully engaged into the mounting slots on all drawers. They potentially could fall out of position in shipment or during assembly. Remove the drawer that is out of position. The drawer is removed by the two clips on the roller bearing slides. Simply push the roller bearing slide back down into position. Insert the drawer back onto the roller bearing slides.

PARTS LIST AND PARTS DRAWING

Item No.	Part No.	No. Req'd	Description
1	RS4RCP	1	Cord Rubber Protector
2	MSC4LIDREDRAT	1	Lid - Stealth Black Red Rat Fink 2019
3	RSLMQPMSBN	1	Locking Mechanism (Excludes Lock) - Stealth Black
4	RSGP	2	Gas Piston
5	RS4QPHBC	2	Handle Brackets/ Pair with Hardware - Chrome
6	RS4QPHBKC	8	M8x19 Bolts w/ Plum Bolts - Chrome
7	RSMSC4HDL	1	Push Handle
8		1	Cart Body - Stealth Black
9	RSLKB	1	Lock with keys
10	RSMSC4PLGSB	4	Leg/Each - Stealth Black
11	RSMSC4BP	1	Safety bumper (4pc)
12	MSC4PLD3RR	1	3" Right Drawer - Red
13	RSMSC4PSPHSB	1	Screwdriver/Prybar Holder - Stealth Black
14	RS4QPRC	4	Rubber Cushion
15	RSRBS	4	Roller Bearing Slides
16	RSMSC4SCDSB	1	Spray Can Divider - Stealth Black
17	MSC4QPBTBSB	1	Bottom Tray - Stealth Black
18	RSSWLCS	2	5" Swivel Locking Caster / each
19	*	16	Washer
20	*	16	Spring Washer
21	*	16	M8 x 16 Bolt Kits
22	RSMSC4QPRPSB	2	Reinforced Piece / each - Stealth Black
23	RSSWCS	2	5" Swivel Caster Non-Locking / each
24	MSC4HC	1	6 Pc. Chrome Handles
25	RSMSC4JSB	2	"J" Channel - Stealth Black
26	RSMSC4CCPSB	1	Center Clip-on pcs/pair - Stealth Black
27	MSC4PLD5R	1	5" Drawer - Red
28	MSC4PLD4R	1	4" Drawer - Red
29	MSC4PLD3RL	1	3" Left Drawer - Red
30	RS4QPLHK	32	Leg Hardware Kit (M8 x 17)
	* RS4QPCHK		Caster Hardware Kit (incl 19,20 & 21)

Also available:

RSRBSDET8PK	Ball Bearing Slide Detents (Package of 8).
RSMSC46LK	6 Piece Liner Kit
MSC4FC	Set of 2 Fixed 5" x 2" Casters (Optional - Not Included)
RSMSC4SBP	Stealth Black Touch-Up Paint