

! WARNING

SERVICE CART WEIGHT CAPACITY

| | |
|-------------------------------------|--------------|
| Total Net Load | 500 LBS |
| Top and Bottom Shelf | 150 LBS each |
| Small Top Drawers | 30 LBS each |
| Center and Bottom Drawers | 70 LBS each |

It is the responsibility of the owner to make sure all personnel read this manual prior to using the device. It is also the responsibility of the device owner to keep this manual intact and in a convenient location for all to see and read. If the manual or product labels are lost or not legible, contact Matco Tools for replacements. If the operator is not fluent in English, the product and safety instructions shall be read and discussed with the operator in the operator's native language by the purchaser/owner or his designee, making sure that the operator comprehends its contents. PLEASE NOTE: Loading cart beyond rated capacity may cause structural damage to the cart as well as personal and /or property damage. Please educate your customers to the dangers of overloading.



- Read and follow all instructions in User's Manual

- Do not load carts beyond rated capacity.

- Lock lid and drawers before moving.



- Apply brake on locking casters anytime cart is in place.

- Do not pull cart. Push from handle on end to move.



- Units can tip or fall causing damage or personal injury.



- Do not open more than one loaded drawer at a time.

- Do not stand on or step in drawers.



- Keep children away from unit.



- Wear gloves when lifting edges.



- Cart is designed to roll easily on flat surfaces and should not be used on uneven or inclined surfaces.

- This product may contain one or more chemicals known to the State of California to cause cancer and birth defects or other reproductive harm.
Wash hands thoroughly after handling.

- Failure to heed these warnings may result in personal injury and/or property damage.

ASSEMBLY INSTRUCTIONS

Due to the weight of this cart we recommend that **TWO PEOPLE** work together on the assembly. This cart weighs approximately 170 lbs; please use caution during assembly.

Step 1: Locate the key tied to the bottom tray. Using the key, open the lid and remove the caster box from the bottom drawer. Once removed, make sure all drawers are completely closed and the inside lever is in the locked position. Close the top lid and lock.

Step 2: Lay out a work surface using the protective foam provided. Once this surface is secure, gently turn the cart onto its lid (logo will be facing the foam).

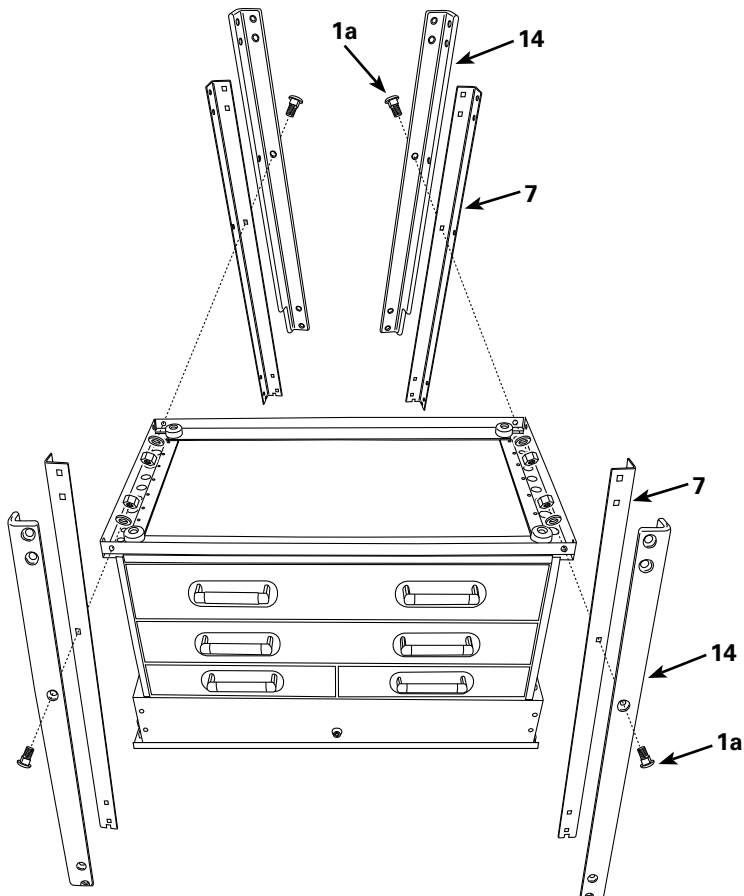

Step 3: (Before assembling the legs, remove the cable tie holding the bumper in place.) Insert the front leg (Part #7), labeled FL or FR into top lip of the cart. Then place the Front bumper (Part # 14 with Matco Logo) over the leg aligning the center bolt holes. With holes aligned, insert stove bolt (Part #1a) and finger tighten with nyloc nut and washer.

Step 4: Install back leg (Part #7) labeled BL or BR and bumper (Part #14 without logo) following the same procedure as above. Note: Make sure the back leg is inside the hinge rivet. Otherwise the holes will not line up during assembly!!!

Step 5: Repeat steps 3 & 4 to mount the legs on the opposite side.

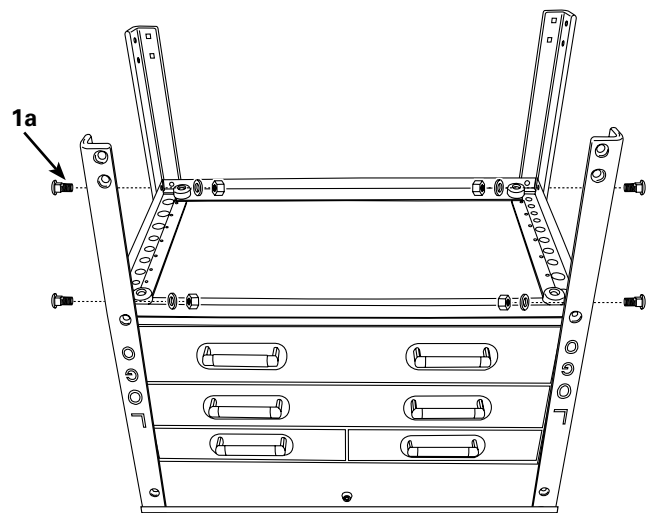

Step 6: Completely tighten the 8 bolts just inserted.

ASSEMBLY INSTRUCTIONS

Step 7: Insert bottom shelf (Part # 23) between the four legs, flat side facing up towards the ceiling. Insert sixteen stove bolts (Part #1a) and completely tighten.

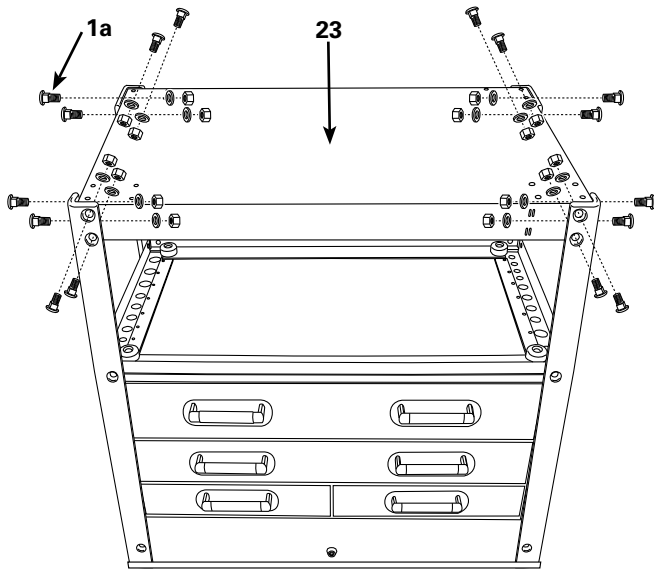

Step 8: Mounting casters: Put the four casters in place. The two locking casters (Part #12) should be on one side of the cart, and the two non locking casters (Part #10) should be on the other (**Left or right side, NOT front or back**). Using the 16 bolts (Part #9), washers and fasteners (located in separate caster bag), completely tighten the casters to the bottom tray using a 13mm socket and 14mm combination wrench for the bolt head. (Note: Bolt head and one washer should be on the inside of the bottom shelf, nyloc nut and one washer will be on the caster side.)

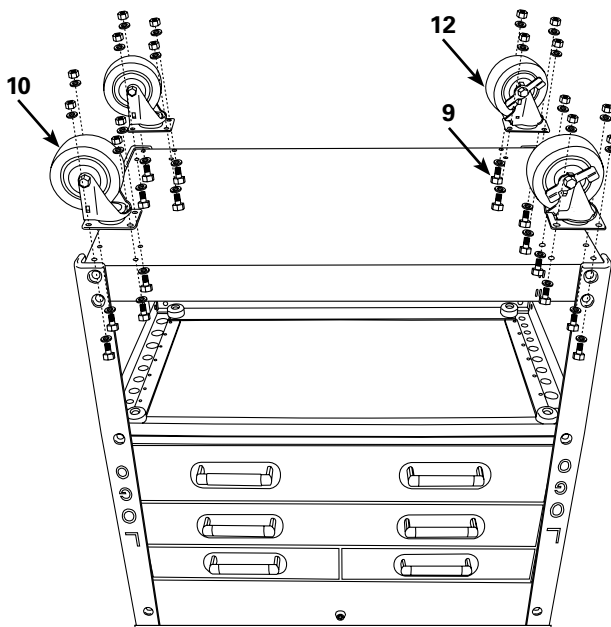

Step 9: Carefully turn cart onto its casters.

Step 10: Open top lid using the key provided.

TOOLS NEEDED FOR ASSEMBLY:

- 2 - 14mm Combination Wrenches
- 13mm Socket or Universal Socket
- 4" Extension
- 1/4" Ratchet
- #2 Phillips Screwdriver

Step 11: Mount push handle/bracket assembly (Parts #5 & 6) to the same side of the cart as the locking casters, using the four stove bolts (Part #1b) provided. Finger tighten at this time.

Step 12: Insert the 4 Stove bolts (Part #4) provided to the opposite side of the cart. Note: This stove bolt is shorter due to not having to pass through a handle or bumper.

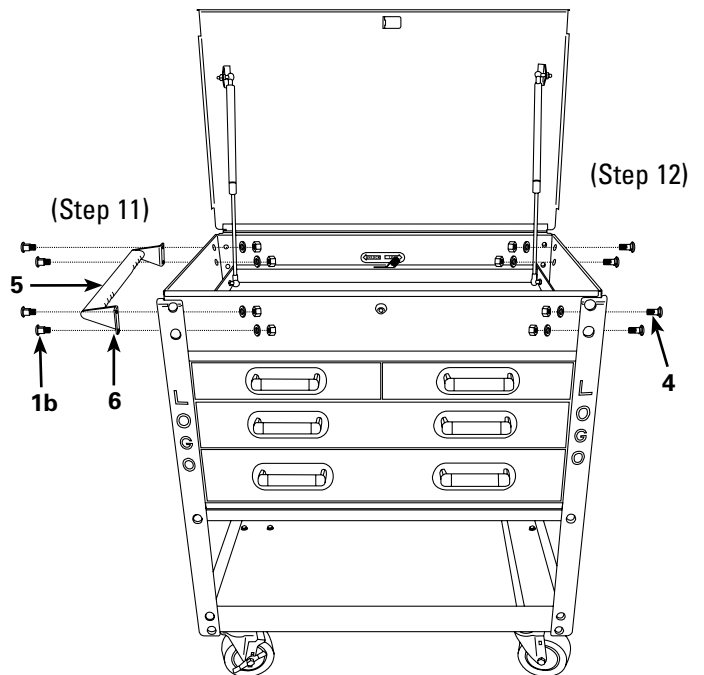

Step 13: Insert the remaining 8 stove bolts (Part #1a).

ASSEMBLY INSTRUCTIONS

Step 14: Using 13mm socket, completely tighten all fasteners!!

Step 15: Insert spray can divider (Part #19) into provided cut away on the bottom shelf (Part #23). (Optional)

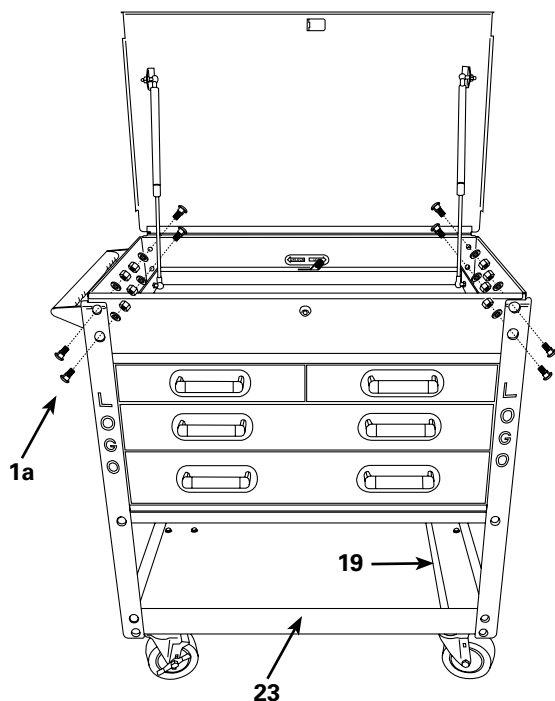

HARDWARE SPECIFICATIONS

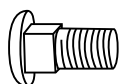

1a x 32 pcs.



2 x 72 pcs.

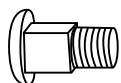

1b x 4 pcs.



3 x 56 pcs.

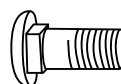

4 x 4 pcs.

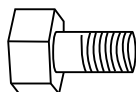

9 x 16 pcs.

TROUBLESHOOTING

Troubleshooting points during MSC4RFA17 Series Assembly:

Problem: Drawers appear not to fit, do not slide in accurately and bump the cart sides.

Solution: The roller bearing slides must be fully engaged into the mounting slots on all drawers. They could potentially fall out of position while turning the cart on its lid or back onto its caster.

Check the side of the cart to determine which slide is out of position.

Remove the drawer that is out of position. The drawer is removed by the two clips on the actual roller bearing slide.

Simply push the roller bearing slide back down into position.

Insert the drawer back onto the roller bearing slides.

Problem: Back Lock/Unlock Switch does not engage the drawer.

Solution: The inside Lock/Unlock slide could potentially fall out of its groove while turning the cart on its lid or back onto its casters.

Unscrew the four screws that are holding the Lock/Unlock slide in place.

Once the screws are removed, simply place the latch back onto the slide and tighten the four screws back down.

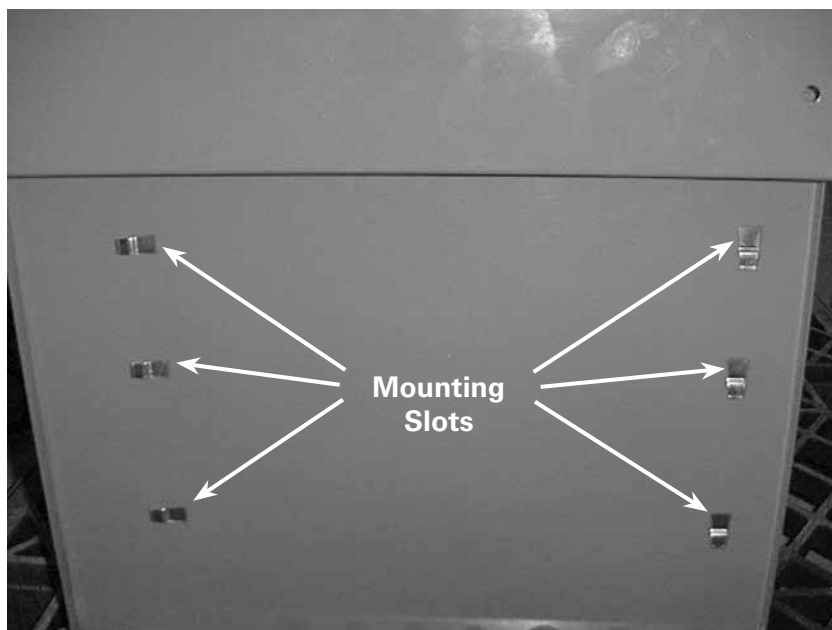

PART DRAWINGS

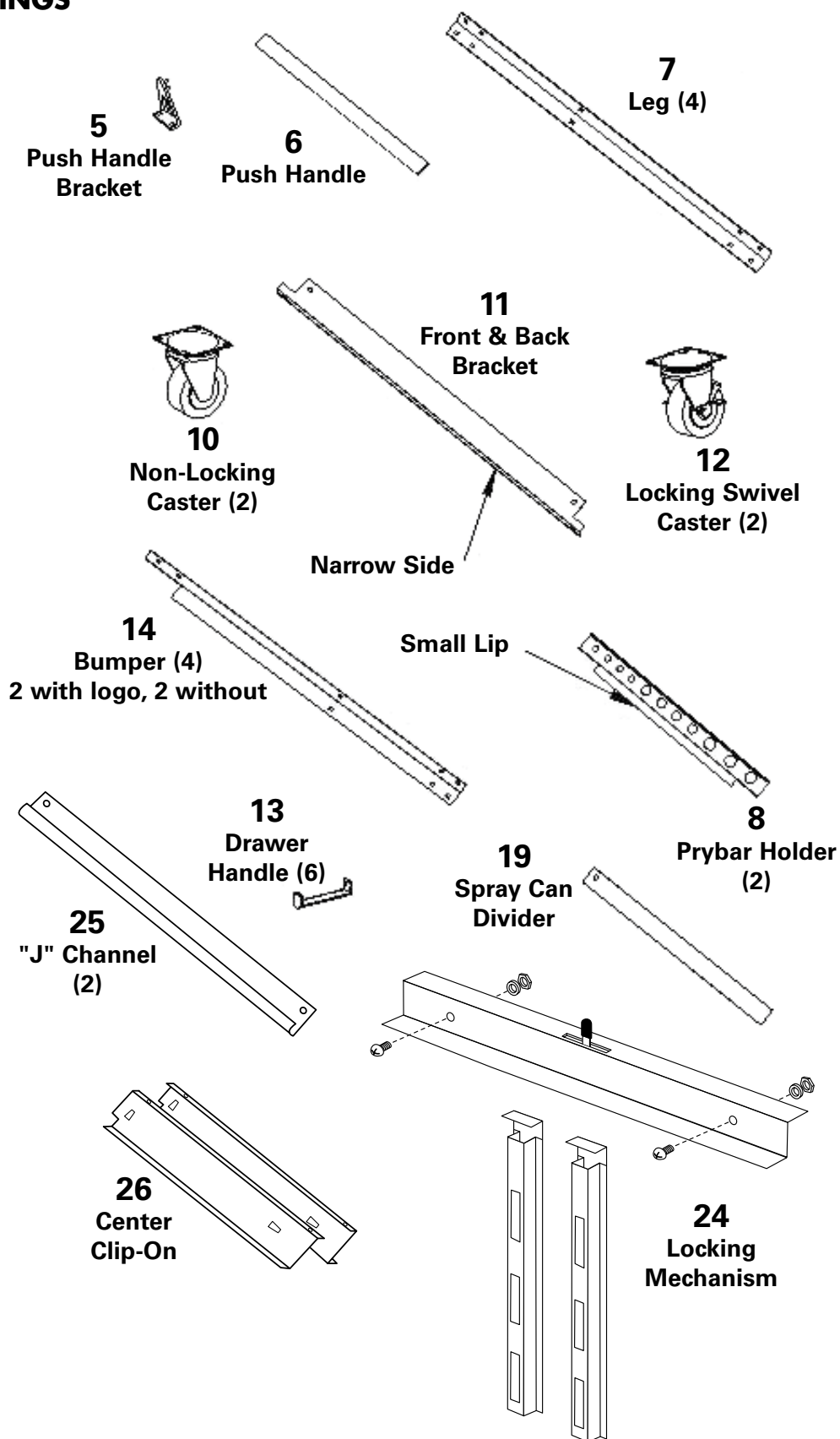

PART DRAWINGS

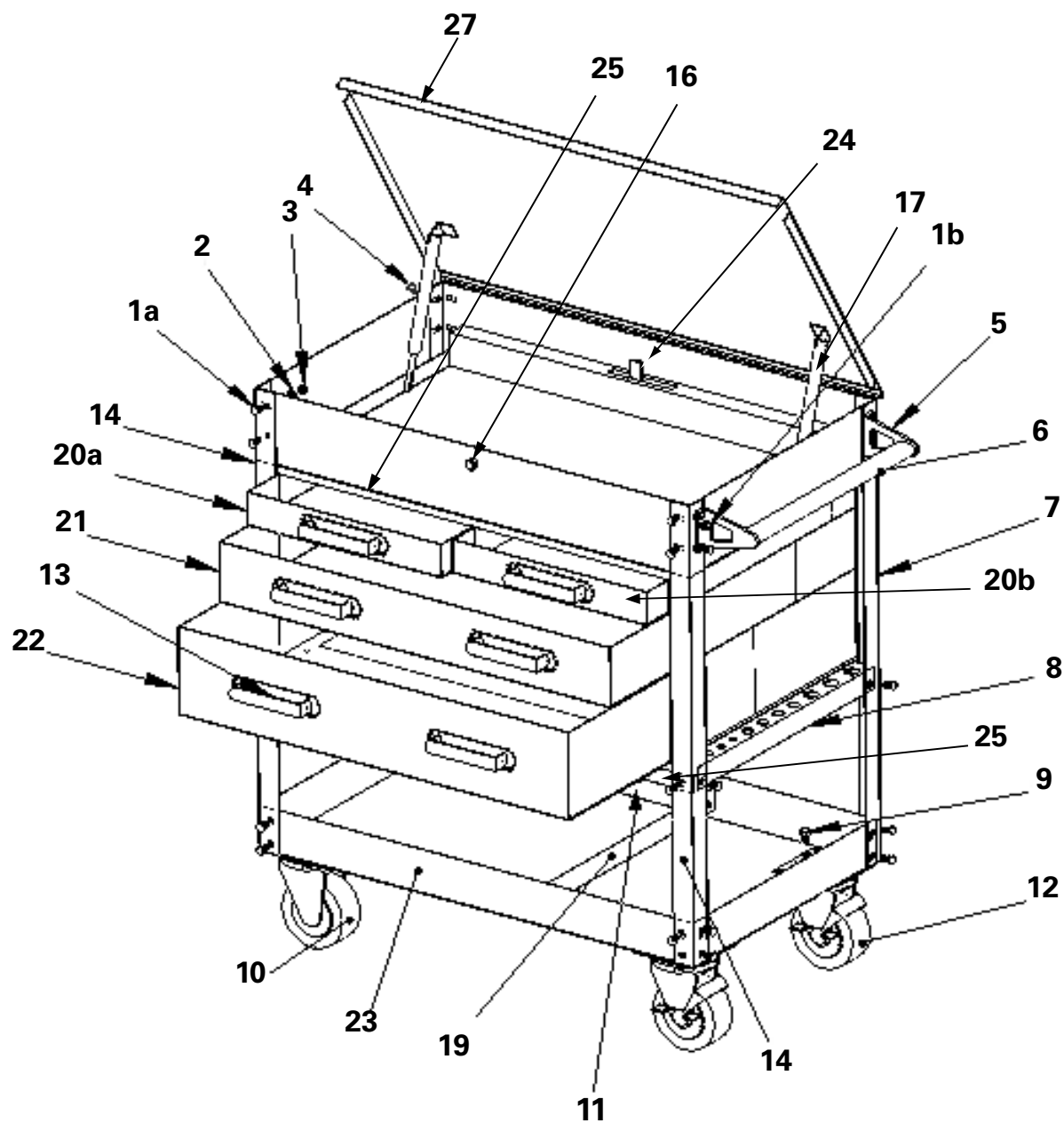

| Item No. | Part No. | No. Req'd | Description |
|----------|-----------------------------|-----------|---|
| 1a | * | 32 | M8x22 Bolt |
| 1b | * | 4 | M8x28 Bolt |
| 2 | * | 72 | M8 Washer |
| 3 | * | 56 | M8 Locking Nut |
| 4 | * | 4 | M8x22 Bolt |
| 5 | RSMSC4HB | 1 | Handle Brackets/Pair with Hardware |
| 6 | RSMSC4HDL | 1 | Handle |
| 7 | RSMSC4LGSB (stealth black) | 4 | Leg/each |
| 8 | RSMSC4SRPSB (stealth black) | 2 | Screwdriver/Prybar Holder/each |
| 9 | * | 16 | M8x16 Bolt (for casters) |
| 10 | RSSWCS | 2 | 5" Swivel Caster /each |
| 11 | RSMSC4RPBK (black) | 2 | Reinforced Piece /each |
| 12 | RSSWLCS | 2 | 5" Swivel Caster with lock /each |
| 13 | MSC4HC | 1 | 6 Pc. set Chrome Handles |
| | MSC4HBK | | 6 Pc. set Black Handles (Optional) |
| | MSC4HBL | | 6 Pc. set Blue Handles (Optional) |
| | MSC4HR | | 6 Pc. set Red Handles (Optional) |
| 14 | RSMSC4BP | 1 | Set of 4 Bumpers |
| 15 | * | 12 | Screw for Drawer Handles |
| 16 | RSLKB | 1 | Lock with Keys |
| 17 | RSGPBK | 2 | Gas Piston /each black |
| 18 | RSRBS | 4 | Roller Bearing Slides /pair (not shown) |
| 19 | RSMSC4SCDSB (stealth black) | 1 | Spray Can Divider |
| 20a | MSC4LD3RFL (green) | 1 | 3" Left Drawer |
| 20b | MSC4LD3RFR (green) | 1 | 3" Right Drawer |
| 21 | MSC4LD4RF (green) | 1 | 4" Drawer |
| 22 | MSC4LD5RF (green) | 1 | 5" Drawer |
| 23 | MSC4SSB (stealth black) | 1 | Bottom Shelf with Reinforcing Brackets |
| 24 | RSLMMBKNSB (stealth black) | 1 | Locking Mechanism (Excludes Lock) |
| 25 | RSMSC4JSB (stealth black) | 2 | "J" Channel |
| 26 | RSMSC4CCPSB (stealth black) | 1 | Center Clip-On Pcs/Pair (Fit between 3" drawers)(not shown) |
| 27 | MSC4LIDRF9 (green) | 1 | Lid |

* Available in: RSMSC4BK Bolt Kit.

Also available: RSRBSDET8PK Ball Bearing Slide Detents (Package of 8).

RSMSC46LK 6 Piece Liner Kit

MSC4FC Set of 2 Fixed 5" x 2" Casters (Optional - Not Included)

RSBKP Black Touch-Up Paint