

⚠ WARNING



- Lock lid and drawers before moving.
- Apply brake on locking casters anytime cart is in place.
- Do not pull cart. Push from handle on end to move.
- Units can tip or fall causing damage or personal injury.
- Cart is designed to roll easily on flat surfaces and should not be used on uneven or inclined surfaces.
- Do not open more than one loaded drawer at a time.
- Do not stand on or step in drawers.
- Keep children away from unit.
- Wear gloves when lifting edges.
- Before connecting to a power supply, always check to make sure the power supply corresponds to the voltage required on the product.
- Fully insert plug to reduce the risk of electric shock.
- Always unplug when not in use.
- Disconnect power before installing or servicing.
- Do not try to plug in unit or product when hands are wet or damp, or if standing on a wet or damp surface or in water.
- Never attempt to pick up unit or plugged in product that should fall in standing water.
- This unit is not waterproof and is intended for general use indoors.
- Do not use in potentially dangerous locations, such as flammable or explosive atmospheres.
- Keep cord away from heat, oil, sharp edges or moving parts.
- Failure to heed these warnings may result in personal injury and/or property damage.



WARNING: This product can expose you to chemicals including nickel which is known to the State of California to cause cancer and birth defects or other reproductive harm. For more information go to www.P65Warnings.ca.gov.

⚠ WARNING

SERVICE CART WEIGHT CAPACITY

| | |
|------------------------------|-------------|
| Maximum Total Net Load | 500 LBS |
| Top Lid of Cart | 150 LBS |
| Bottom Shelf | 150 LBS |
| 3" Drawer(s) each | 30 LBS each |
| 4" Drawer | 70 LBS each |
| 5" Drawer | 70 LBS each |

PLEASE NOTE: Loading cart beyond rated capacity may cause structural damage to the cart as well as personal and/or property damage. Please educate your customers to the dangers of overloading. Do not attempt to push cart with items on the top lid.

ASSEMBLY INSTRUCTIONS

FIG. 1

Installing 4 pc. caster (#18/#23) onto the bottom tray (#17) with #19/#20/#21.

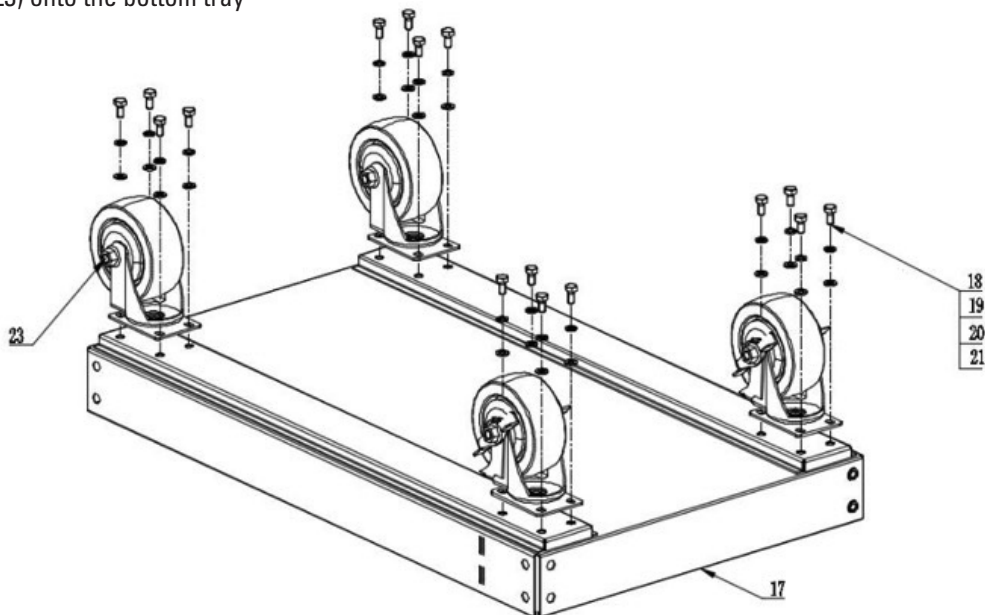

ASSEMBLY INSTRUCTIONS

FIG. 2

Install leg/bumper(#10,#11) onto the cart body (#8) and fasten with 6 bolts (#30).

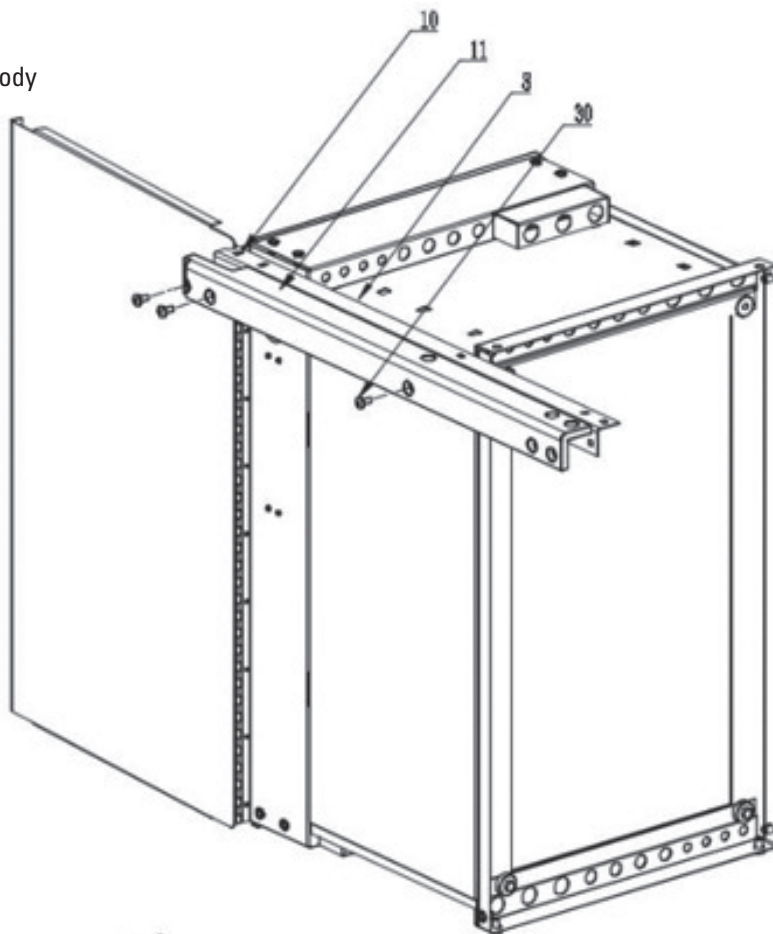
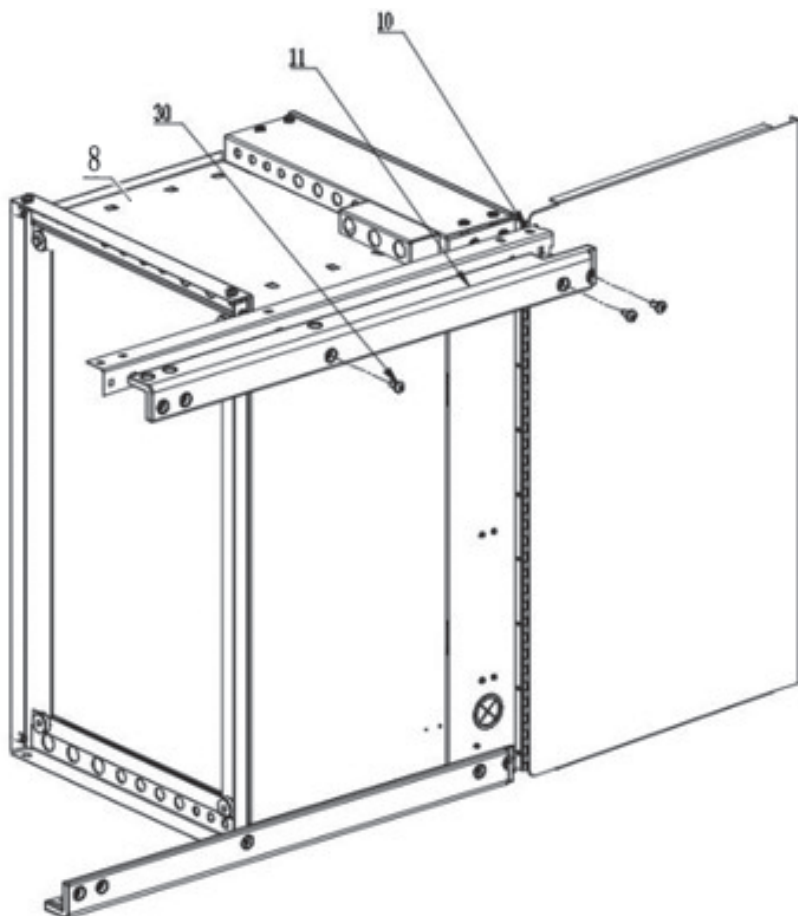

FIG. 3

Turn cart body 180° to install second leg/bumper (#10,#11) onto the cart body (#8) and fasten with 6 bolts (#30).



ASSEMBLY INSTRUCTIONS
FIG. 4

Turn cart body 90° to install 3rd and 4th leg/bumper(#10,#11) onto the cart body (#8) and fasten with 6 bolts (#30). Put bottom tray w/casters (#17) onto the 4 legs and fasten with 8 bolts (#30)

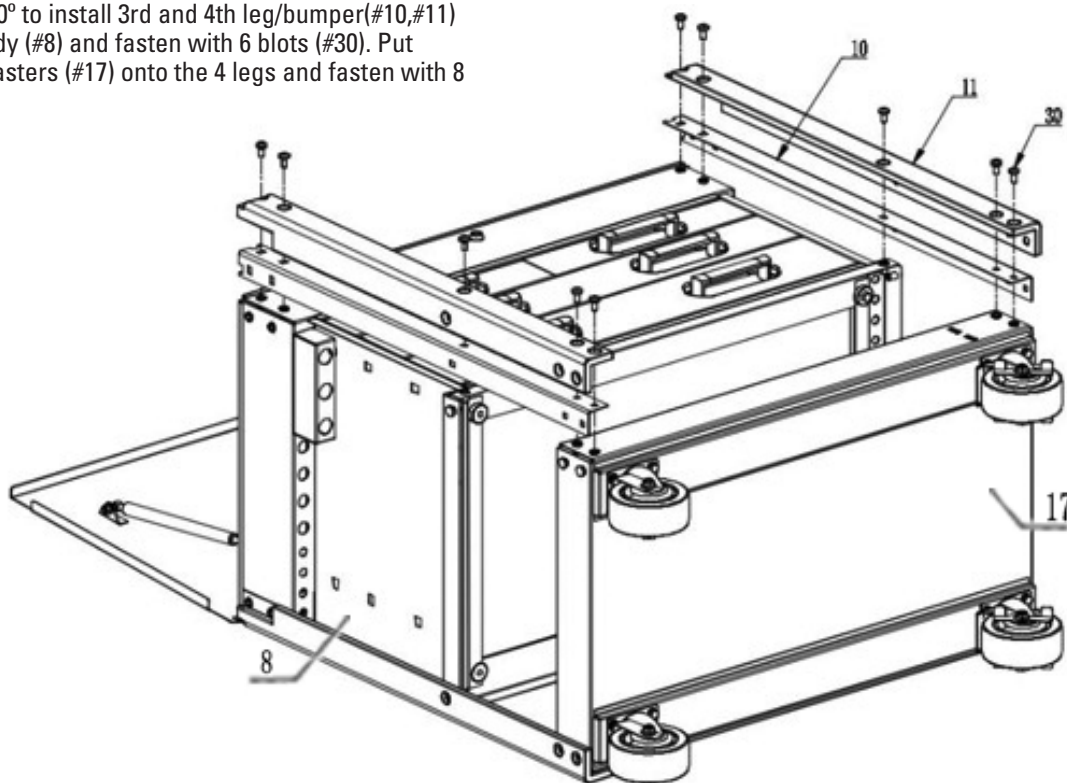
FIG. 5

Turn cart body 90° and fasten remaining 8 bolts (#30).

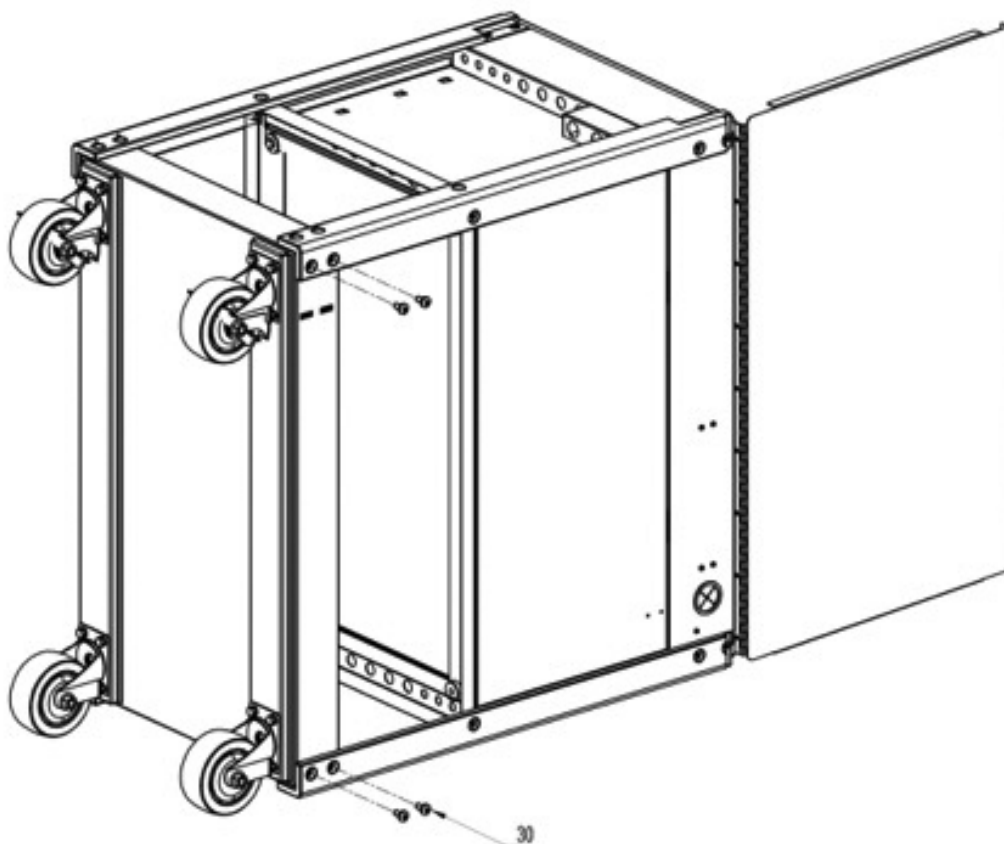

ASSEMBLY INSTRUCTIONS

FIG. 6

Mount the push handle (#7) to the same side of the cart as the locking casters, using the four bolts (#6) provided.

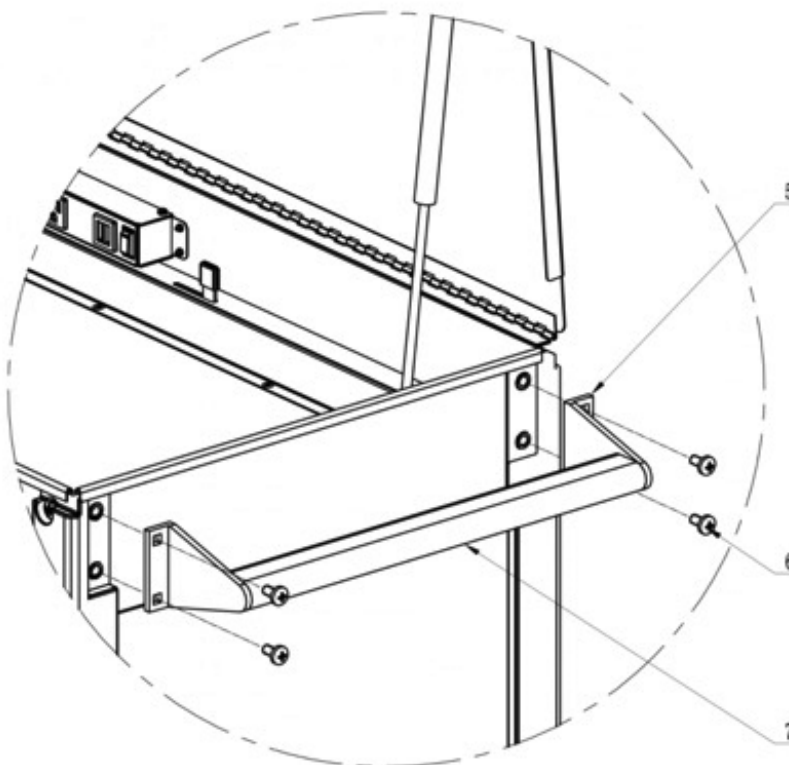
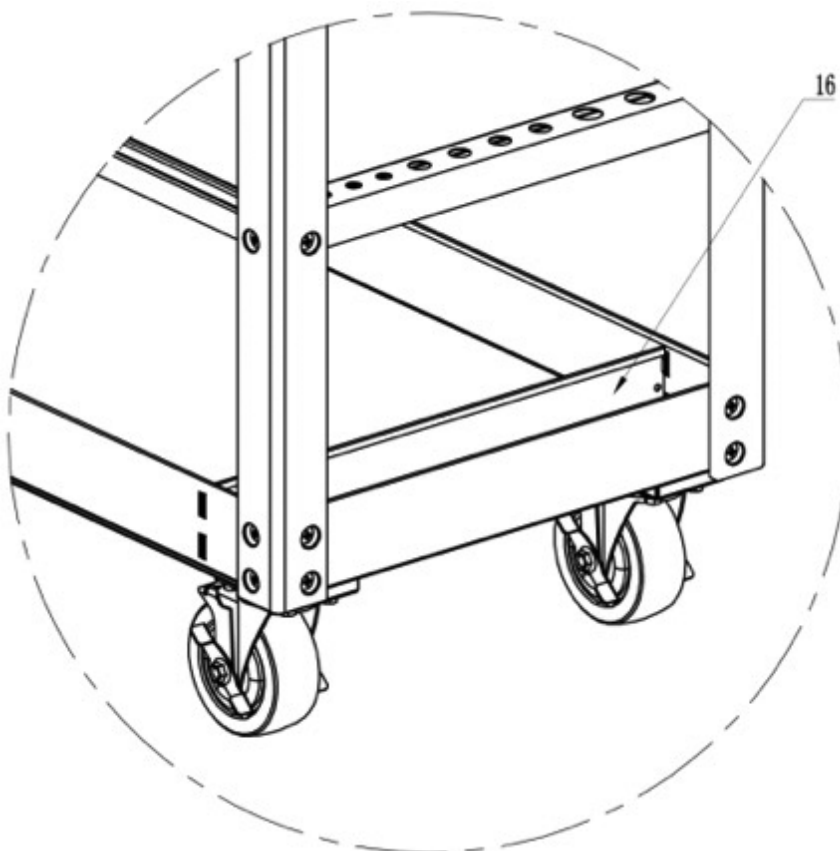
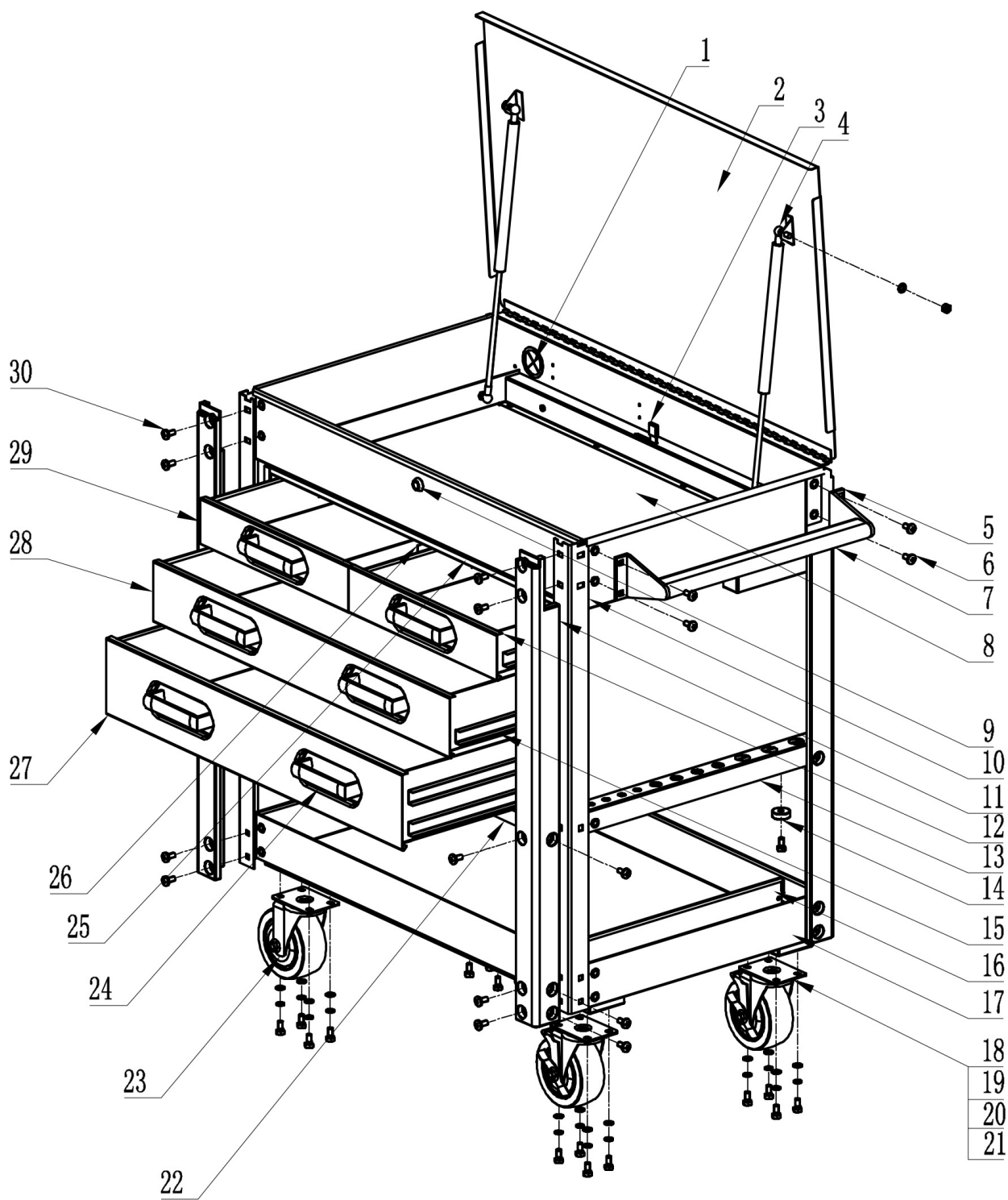

FIG. 7

Install Spray Can Divider (#16) onto the bottom tray



PARTS DRAWING



TROUBLESHOOTING

Problem: Drawers appear not to fit, do not slide in accurately and bump the cart sides.

Solution: The roller bearing slides must be fully engaged into the mounting slots on all drawers. They potentially could fall out of position in shipment or during assembly. Remove the drawer that is out of position. The drawer is removed by the two clips on the roller bearing slides. Simply push the roller bearing slide back down into position. Insert the drawer back onto the roller bearing slides.

PARTS LIST AND PARTS DRAWING

| Item No. | Part No. | No. Req'd | Description |
|----------|--------------|-----------|--|
| 1 | RS4RCP | 1 | Cord Rubber Protector |
| 2 | MSC4LIDBK9 | 1 | Lid - Black |
| 3 | RSLMQPMBKN | 1 | Locking Mechanism (Excludes Lock) - Black |
| 4 | RSGP | 2 | Gas Piston (each) |
| 5 | RS4QPHBC | 2 | Handle Buckets/ Pair with Hardware - Chrome |
| 6 | RS4QPHBKC | 8 | M8x19 Bolts w/ Plum Bolts - Chrome |
| 7 | RSMSC4HDL | 1 | Push Handle |
| 8 | | 1 | Cart Body |
| 9 | RSLKB | 1 | Lock with keys |
| 10 | RSMSC4PLGBK | 4 | Leg/Each - Black |
| 11 | RSMSC4BP | 1 | Safety bumper (4pc) |
| 12 | MSC4PLD3BLR | 1 | 3" Right Drawer - Blue |
| 13 | RSMSC4QSRPBK | 2 | Screwdriver/Prybar Holder - Black |
| 14 | RS4QPRC | 4 | Rubber Cushion |
| 15 | RSRBS | 4 | Roller Bearing Slides (pair) |
| 16 | RSMSC4SCDBK | 1 | Spray Can Divider - Black |
| 17 | MSC4QPBTK | 1 | Bottom Tray - Black |
| 18 | RSSWLC5 | 2 | 5" Swivel Locking Caster / each |
| 19 | * | 16 | Washer |
| 20 | * | 16 | Spring Washer |
| 21 | * | 16 | M8 x 16 Bolt Kits |
| 22 | RSMSC4QPRPBK | 2 | Reinforced Piece / each - Black |
| 23 | RSSWCS | 2 | 5" Swivel Caster Non-Locking / each |
| 24 | MSC4HC | 1 | 6 Pc. Drawer Handles - Chrome |
| 25 | RSMSC4JBK | 2 | "J" Channel - Black (each) |
| 26 | RSMSC4CCPBK | 1 | Center Clip-on pcs/pair - Black |
| 27 | MSC4PLD5BL | 1 | 5" Drawer - Blue |
| 28 | MSC4PLD4BL | 1 | 4" Drawer - Blue |
| 29 | MSC4PLD3BLL | 1 | 3" Left Drawer - Blue |
| 30 | RS4QPLHK | 1 | 32 Pcs Leg Hardware Kit (M8 x 17) |
| | * RS4QCHK | | 16 Pcs Caster Hardware Kit (incl 19,20 & 21) |

Also available:

| | |
|-------------|--|
| RSRBSDET8PK | Ball Bearing Slide Detents (Package of 8). |
| RSMSC46LK | 6 Piece Liner Kit |
| MSC4FC | Set of 2 Fixed 5" x 2" Casters (Optional - Not Included) |
| RSBKP | Black Touch-Up Paint |
| RSMSC4BLU | Blue Touch-Up Paint |