



OWNERS
MANUAL

MODEL NO.
TJ7752

CAUTION:
Read Rules for
Safe Operation
and All Instruc-
tions Carefully

**SAVE THIS
MANUAL FOR
FUTURE REFERENCE**

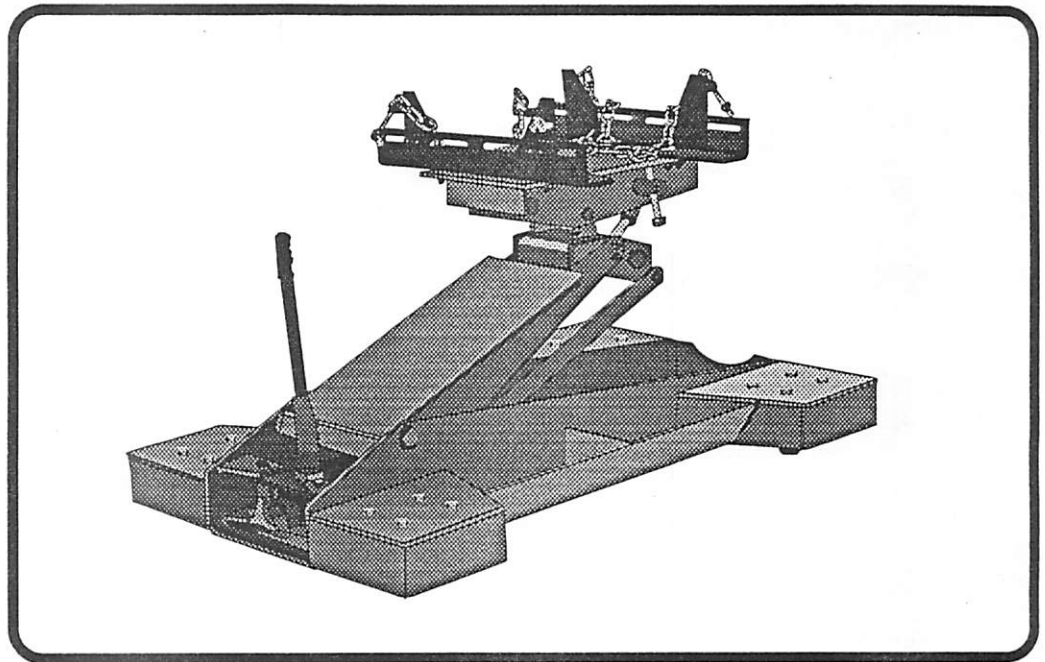

Heavy Duty Transmission Jack 1-1/2 Ton Capacity

OPERATING
and
ASSEMBLY
INSTRUCTIONS
plus
PARTS
BREAKDOWN



⚠ WARNING

THE USE OF THIS JACK IS LIMITED TO THE REMOVAL, INSTALLATION, AND TRANSPORTATION IN THE LOWERED POSITION, OF TRANSMISSIONS AND DIFFERENTIALS. IT MAY BE USED WITH APPROPRIATE ADAPTERS MANUFACTURED SPECIFICALLY FOR THE JACK TO HANDLE OTHER COMPONENTS, SUCH AS REAR AXLE UNITS AND TRANSFER CASES, WITHIN THE WEIGHT LIMITATIONS SPECIFIED. NO ALTERATION TO THE JACK OR ADAPTERS SHALL BE MADE.

BE SURE THE VEHICLE IS APPROPRIATELY SUPPORTED BEFORE STARTING REPAIRS.

DO NOT OVERLOAD. OVERLOADING CAN CAUSE DAMAGE TO OR FAILURE OF THE JACK.

ONLY ATTACHMENTS AND/OR ADAPTERS SUPPLIED BY THE MANUFACTURER SHALL BE USED.

THIS JACK IS DESIGNED FOR USE ONLY ON HARD LEVEL SURFACES CAPABLE OF SUSTAINING THE LOAD. USE ON OTHER THAN HARD LEVEL SURFACES CAN RESULT IN JACK INSTABILITY AND POSSIBLE LOSS OF LOAD.

READ, STUDY AND UNDERSTAND THE OPERATING MANUAL PACKED WITH THIS JACK BEFORE OPERATING.

FAILURE TO HEED THESE WARNINGS MAY RESULT IN LOSS OF LOAD, DAMAGE TO JACK, AND/OR FAILURE RESULTING IN PROPERTY DAMAGE, PERSONAL OR FATAL INJURY.

OPERATING INSTRUCTIONS

ASSEMBLY INSTRUCTIONS:

1. Lay jack on flat, smooth surface. Attach casters (#35) using 4 bolts (#32), 4 washers (#36) and 4 nuts (#37) for each caster.
2. Check for tightness. The rest of the jack is pre-assembled, except for the fingers (#63) and angles (#64).
3. Attach angles to top plate (#64) using 2 washers (#55) and 2 nuts (#56) for reach angle.
4. Attach finger (#63) to angle (#64), using one washer (#66) and 2 wing nuts (#67) for each finger.

INSPECTION:

Visual inspection should be made before each use of the transmission jack, checking for leaking hydraulic fluid and damaged, loose or missing parts. Each jack must be inspected by a manufacturer's repair facility immediately, if accidentally subjected to an abnormal load or shock. Any jack which appears to be damaged in any way, is found to be badly worn, or operates abnormally **MUST BE REMOVED FROM SERVICE** until necessary repairs are made by a manufacturer's authorized repair facility. It is recommended that an annual inspection of the jack be made by a manufacturer's authorized repair facility and that any defective parts, decals or warning labels be replaced with manufacturer's specified parts. A list of authorized repair facilities is available from the manufacturer.

PURGING THE TRANSMISSION JACK:

Air may become trapped in the hydraulic system during transit. To purge air:

1. Open release valve by turning handle counterclockwise.
2. Pump handle rapidly 4 full strokes. This will expel air that may have entered oil passages during transit.
3. Close release valve by rotating handle clockwise and pump handle.
4. If lift arm raises, jack is ready for use. If not, repeat this procedure.

OPERATING INSTRUCTIONS:

1. To lift load, pump lever to raise saddle to desired height to contact transmission.
2. Always position the jack so the weight of the load is equally distributed on the saddle.
3. To tilt lifting head, manipulate the appropriate pair of adjusting screws (there are two pairs) located under the lifting head. When one screw is loosened, the opposite screw should be tightened by the same amount to maintain a solid platform.
4. Position corner support brackets and secure the load with chain.
5. The chain should be pulled over the load securely and engaged into slot on the opposite side of the saddle, then tighten wing nut.
6. To lower the jack, slowly open release valve. Insure that load is lowered slowly.

CAUTION: Keep hands or feet away from the hinge mechanism of the jack.

MAINTENANCE INSTRUCTIONS:

All moving joints require lubrication often. Remove handle and grease the lower end of handle where it rotates in the handle socket. Grease release valve gears. Using a grease gun, grease the lift arm pivot shaft grease fitting until grease appears at the end of the shaft. Oil all lift arm linkages, front wheels and rear casters.

OWNER/USER RESPONSIBILITY:

The owner and/or user must have an understanding of the manufacturer's operating instructions and warnings before using the transmission jack. Personnel involved in the use and operation of equipment shall be careful, competent, trained, and qualified in the safe operation of the equipment and its proper use when servicing motor vehicles and their components. Warning information should be emphasized and understood. If the operator is not fluent in English, the manufacturer's instructions and warnings shall be read to and discussed with the operator in the operator's native language by the purchaser/owner, making sure that the operator comprehends its contents.

Owner and/or user must study and maintain for future reference the manufacturer's instructions and pertinent warning information. Owner and/or user is responsible for keeping all warning labels and instruction manuals legible and intact. Replacement labels and literature are available from the manufacturer.

TJ7752 Exploded View Diagram

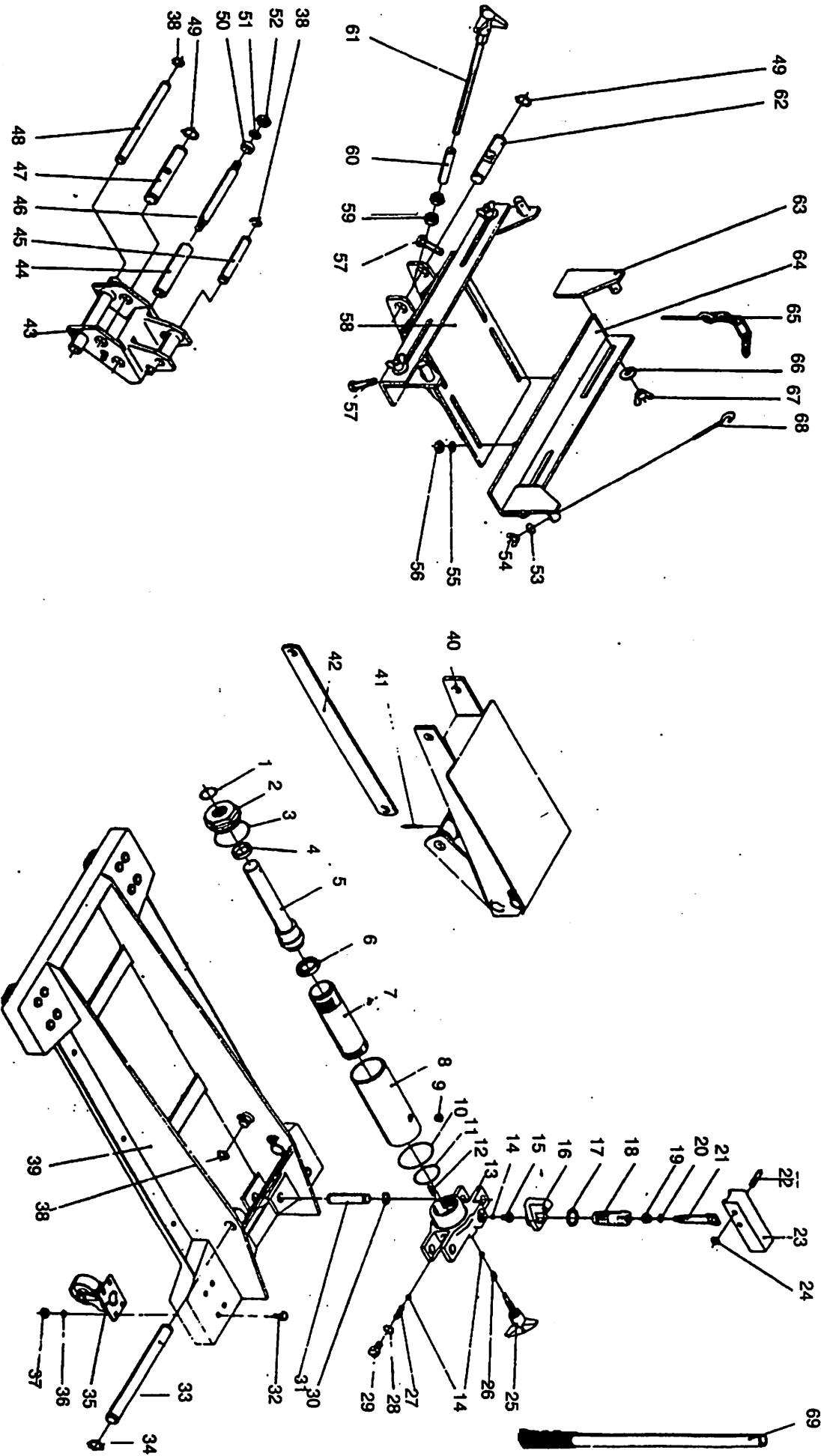

TJ7752 PARTS LIST

| Item # | Part No. | Description | Qty. |
|--------|----------|------------------------------|------|
| 01 | 862218 | O Ring | 1 |
| 02 | 981010 | Head Nut | 1 |
| 03 | 862040 | O Ring | 1 |
| 04 | 910249 | Spacer | 1 |
| 05 | 790020 | Lift Piston | 1 |
| 05C | 791020 | Lift Piston Compl (5 and 6) | 1 |
| 06 | 832430 | Cup | 1 |
| 07 | 916024 | Cylinder | 1 |
| 08 | 969024 | Oil Reservoir | 1 |
| 09 | 893101 | Rubber Plug | 1 |
| 10 | 862043 | O Ring | 1 |
| 11 | 862137 | O Ring | 1 |
| 12 | 828010 | Oil Filter | 1 |
| 13 | 907006 | Pump Housing | 1 |
| 14 | 824030 | Ball | 3 |
| 15 | 991006 | Valve | 1 |
| 16 | 978004 | Link | 1 |
| 17 | 905003 | Washer | 1 |
| 18 | 915004 | Pump Cylinder | 1 |
| 18C | 774005 | Pump Compl. (18, 21C) | 1 |
| 19 | 832307 | Cup | 1 |
| 20 | 862012 | O Ring | 1 |
| 21 | 789005 | Pump Piston | 1 |
| 21C | 789006 | Pump Piston Compl. (19 - 21) | 1 |
| 22 | 927044 | Axle | 2 |
| 23 | 929005 | Pump Beam | 1 |
| 24 | 804006 | Track Ring | 4 |
| 25 | 788005 | Release Screw | 1 |
| 26 | 883205 | Packing | 1 |
| 27 | 856127 | Spring | 1 |
| 28 | 862204 | O Ring | 1 |
| 29 | 866409 | Bolt | 1 |
| 30 | 804119 | Track Ring | 4 |
| 31 | 927115 | Axle | 2 |
| 32 | 866413 | Bolt | 16 |
| 33 | 927191 | Axle | 1 |

| Item # | Part No. | Description | Qty. |
|--------|----------|--|------|
| 34 | 804131 | Track Ring | 2 |
| 35 | 880007 | Caster | 4 |
| 36 | 806050 | Washer | 16 |
| 37 | 873401 | Nut | 16 |
| 38 | 804015 | Track Ring | 6 |
| 39 | 780022 | Frame | 1 |
| 40 | 775020 | Lift Arm | 1 |
| 41 | 871024 | Tension Pin | 1 |
| 42 | 983045 | Link | 2 |
| 43 | 794020 | Carrier | 1 |
| 44 | 910153 | Spacer | 1 |
| 45 | 927116 | Axle | 1 |
| 46 | 927118 | Axle | 1 |
| 47 | 927190 | Axle | 1 |
| 48 | 927117 | Axle | 1 |
| 49 | 804131 | Track Ring | 4 |
| 50 | 905022 | Spacer | 2 |
| 51 | 806091 | Washer | 2 |
| 52 | 873601 | Nut | 2 |
| 53 | 806051 | Washer | 4 |
| 54 | 873402 | Nut | 4 |
| 55 | 806050 | Washer | 8 |
| 56 | 873401 | Nut | 8 |
| 57 | 866655 | Bolt | 2 |
| 58 | 770022 | Adapter | 1 |
| 59 | 873701 | Nut | 2 |
| 60 | 910154 | Spacer | 1 |
| 61 | 788111 | Adjust Screw | 1 |
| 62 | 927189 | Axle | 1 |
| 63 | 782007 | Finger (pair) | 2 |
| 64 | 781120 | Angle | 2 |
| 65 | 781020 | Chain | 2 |
| 66 | 806051 | Washer | 8 |
| 67 | 873401 | Nut | 8 |
| 68 | 956009 | Hook | 2 |
| 69 | 778005 | Handle | 1 |
| | 783011 | Repair Kit (1, 3, 6, 9, 10, 11, 19, 20, 26, 28) | |
| | 797020 | Hydraulic Unit (1 - 29) | |
| | 770023 | Adapter Kit (38, 43 - 68) | |

SPECIFICATIONS

| | | | |
|----------------------------|-----|--------------------------|--------------|
| Low Height | 10" | Saddle Lateral Tilt..... | 12° Each Way |
| Raised Height | 36" | Base Size | 44" x 29" |
| Saddle Forward Tilt | 29° | Shipping Weight | 286 Lbs. |
| Saddle Backward Tilt | 8° | | |

⚠ WARNING

FOR YOUR SAFETY AND TO PREVENT INJURY:

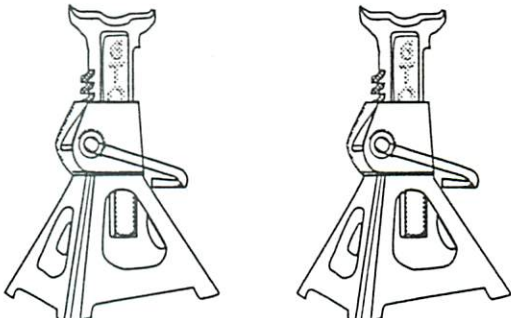

ALWAYS Support Vehicle with Support Stands

POSSIBLE PROBLEMS AND REMEDIES

| Problem | Jack Will Not Lift Load | Jack Lowers Under Load | Jack Will Not Lift Full Rated Capacity | Jack Pump Feels "Spongy" Under Load | Jack Will Not Lift Full Height | |
|---------|-------------------------|------------------------|--|-------------------------------------|--------------------------------|--|
| ✓ | | | ✓ | ✓ | | Jack may be low on oil. Remove filler screw and fill reservoir with clean jack oil. |
| ✓ | | ✓ | ✓ | ✓ | | Jack may be airbound. Bleed the hydraulic system. |
| ✓ | ✓ | ✓ | | | | Valves may not be closing properly. Flush valves by placing one foot on legs and pulling up on saddle. |
| | | | | ✓ | | Rams may be corroded or dirty. Clean, polish, and lubricate. |
| | ✓ | ✓ | | | | Release valve may not be sealing. Release lever should operate freely. |
| | ✓ | | | | | External leakage - take to service center. |