



MB190UC, -BK, -BL, -GR, -NG, -OR, -YE 3 Drawer Deluxe Utility Cart

ASSEMBLY INSTRUCTIONS

Due to the weight of this cart we recommend that **TWO PEOPLE** work together on the assembly. This cart weighs approximately 200lbs, please use caution during assembly.

Step 1: Locate the key tied to the bottom shelf. Using the key, open the sliding top and remove the caster box from the bottom drawer. Once removed make sure all drawers are completely closed and the inside lever is in the locked position. Close the sliding top and lock.

Step 2: Lay out a work surface using the protective foam provided. Once this surface is secure gently turn the cart onto its back. (You may choose to lay it on its top instead)

Step 3: (Before assembling the legs remove the cable tie holding the bumper in place) Insert the front leg (Part #7), labeled FL or FR. Then place the front bumper (Part #13) over the leg aligning the center bolt holes. With holes aligned insert stove bolt (Part #1a) and finger tighten with nyloc nut and washer.

Step 4: Install back leg (Part #7) labeled BL or BR and bumper (Part #13) following the same procedure as above.

Step 5: Repeat steps 3 & 4 to mount the legs on the opposite side.

Step 6: Completely tighten the 8 bolts just inserted.

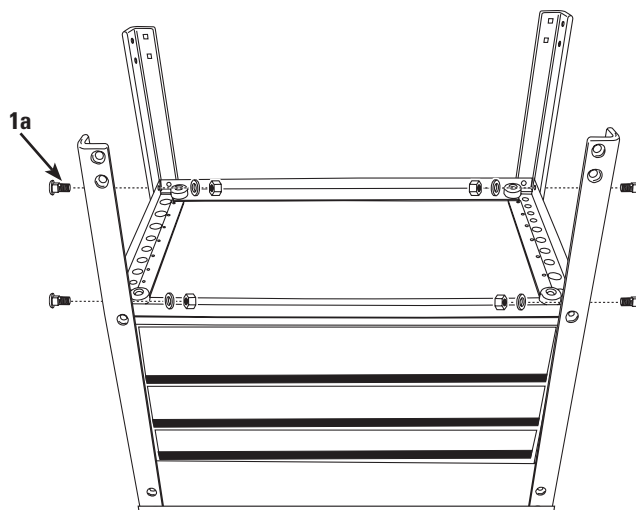

Step 7: Insert bottom shelf (Part #18) between the four legs flat side facing up towards the ceiling. Insert sixteen stove bolts (Part #1a) and completely tighten.

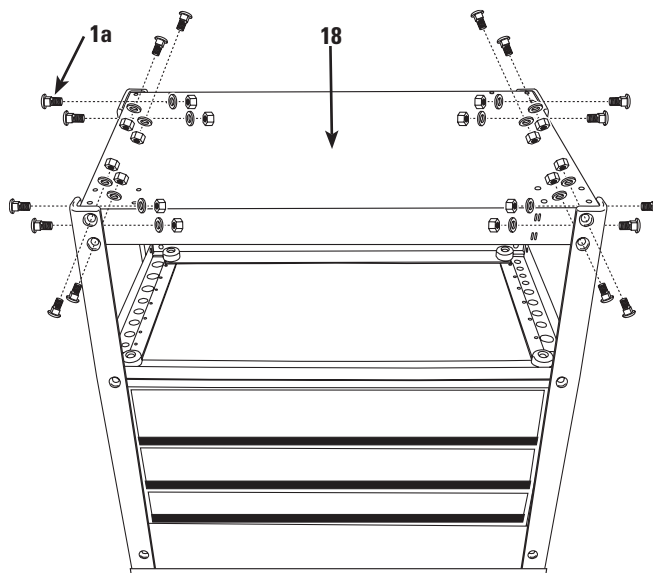
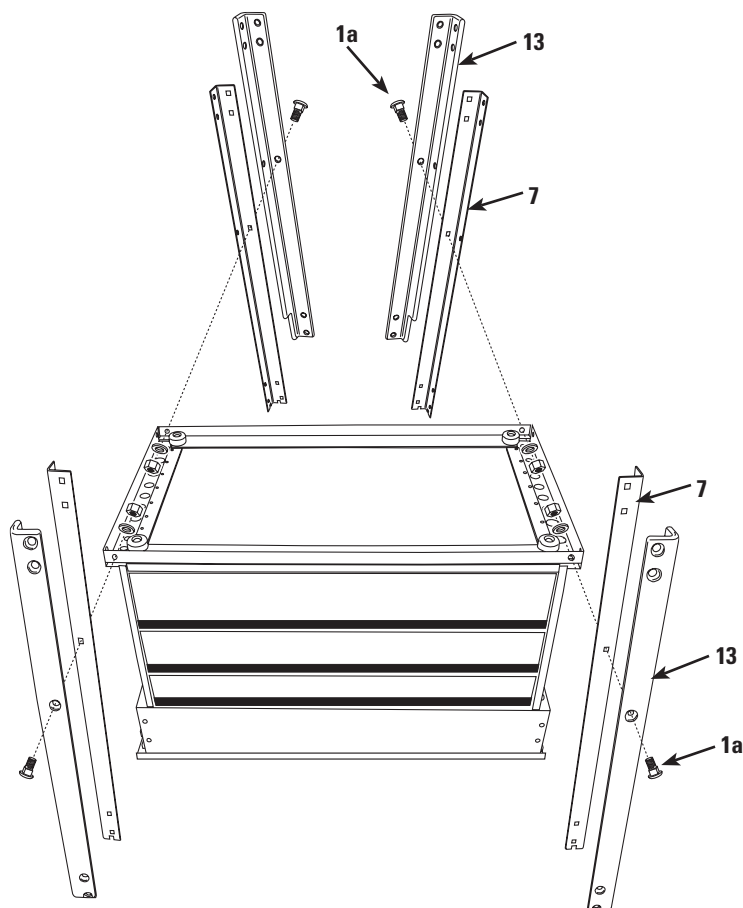



MB190UC, -BK, -BL, -GR, -NG, -OR, -YE 3 Drawer Deluxe Utility Cart

ASSEMBLY INSTRUCTIONS

Step 8: Mounting casters: Put the four casters in place. The two locking casters (Part #10) should be on one side of the cart and the two non locking casters (Part #9) should be on the other (**Left or right side NOT front or back**). Using the 16 bolts (Part #8), washers and fasteners (located in separate Caster bag) completely tighten the casters to the bottom tray using a 13mm socket and 14mm combination wrench for the bolt head. (Note: Bolt head and one washer should be on the inside of the bottom shelf, nyloc nut and one washer will be on the caster side.)

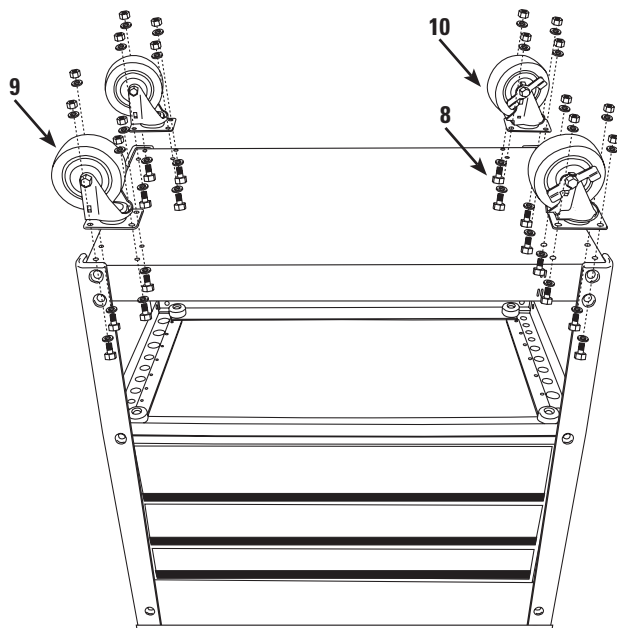

Step 9: Carefully lift cart onto its casters

Step 10: Open sliding top using the key provided

Step 11: Assemble the brackets (Part #5) to the comfort grip push handles (Part #6) then mount push handles and brackets to both sides of the cart using the eight stove bolts (Part #1b) provided. Finger tighten at this time.

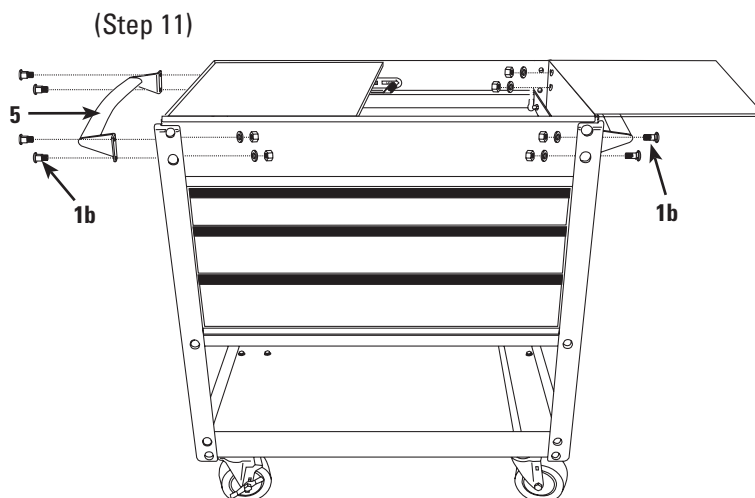

Step 12: Insert the remaining 8 stove bolts (Part #1a).

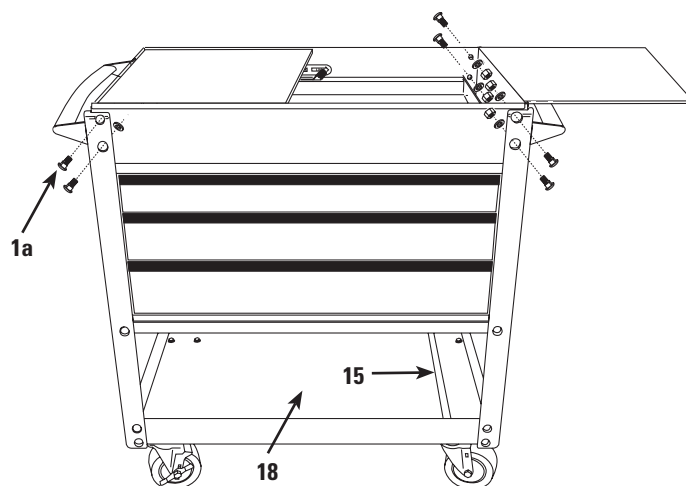

Step 13: Using 13mm socket completely tighten all fasteners!!

Step 14: Insert spray can holder divider (Part #15) into provided channel on the bottom shelf (Part #18).



MB190UC, -BK, -BL, -GR, -NG, -OR, -YE 3 Drawer Deluxe Utility Cart

HARDWARE SPECIFICATIONS

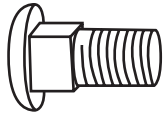

1a x 32 pcs.



2 x 72 pcs.

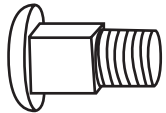

1b x 8 pcs.

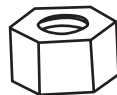

3 x 56 pcs.

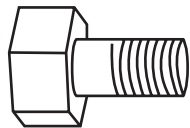

8 x 16 pcs.

TROUBLESHOOTING

Troubleshooting Points during MB190UC Assembly.

Problem: Drawers appear not to fit, don't slide in accurately and bump the cart sides.

Solution: The roller bearing slides must be fully engaged into the mounting slots on all drawers. They potentially could fall out of position while turning the cart on its lid, back, or onto its casters.

Remove the drawer that is out of position. The drawer is removed by the two clips on the roller bearing slides.

Simply push the roller bearing slide back down into position.

Insert the drawer back onto the roller bearing slides

Problem: Back Lock/Unlock Switch does not engage the drawer.

Solution: The inside Lock/Unlock slide potentially could fall out of its groove while turning the cart on its lid, back, or onto its casters.

Unscrew the four screws that are holding the Lock/Unlock slide in place.

Once the screws are removed simply place the latch back onto the slide and tighten the four screws back down.

! WARNING

SERVICE CART WEIGHT CAPACITY

Maximum Total Net Load500 LBS
Top and Bottom Shelf150 LBS each
Drawers.....75 LBS each
Sliding Work Surface (closed).....200 LBS
Sliding Work Surface (fully extended)50 LBS

PLEASE NOTE: Loading cart beyond rated capacity may cause structural damage to the cart as well as personal and /or property damage. Please educate your customers to the dangers of overloading.



MB190UC, -BK, -BL, -GR, -NG, -OR, -YE 3 Drawer Deluxe Utility Cart

PARTS LIST

Item No.	Part No.	No. Req'd	Description
1a	*	32	M8x22 Bolt
1b	*	8	M8x28 Bolt
2	*	72	M8 Washer
3	*	56	M8 Locking Nut
5	RS190UCHB	2	Push Handle Brackets/Pair
6	RS190UCHDL	2	Push Handle
7	RS190UCLG-R	4	Red Leg/each
	RS190UCLG-BK	4	Black Leg/each
	RS190UCLG-BL	4	Blue Leg/each
	RS190UCLG-GR	4	Green Leg/each
	RS190UCLG-NG	4	Neon Green Leg/each
	RS190UCLG-OR	4	Orange Leg/each
	RS190UCLG-Y	4	Yellow Leg/each
8	*	16	M8x19 Bolt (for casters)
9	RSSWCS	2	Swivel Caster /each
10	RSSWLCS	2	Swivel Caster with lock /each
11	RSBKT	2	Bracket for paper storage area
12	RS190UCDHBK		Black Drawer Handle/each
13	RS190UCBP	1	Set of 4 Bumpers
14	RSLK		Lock with Keys
15	RSSCD-R		Red Spray Can Divider
	RSSCD-BK		Black Spray Can Divider
	RSSCD-BL		Blue Spray Can Divider
	RSSCD-GR		Green Spray Can Divider
	RSSCD-NG		Neon Green Spray Can Divider
	RSSCD-OR		Orange Spray Can Divider
	RSSCD-Y		Yellow Spray Can Divider
16	MBD190UC1	2	Red 3" Drawer
	MBD190UC1-BK	2	Black 3" Drawer
	MBD190UC1-BL	2	Blue 3" Drawer
	MBD190UC1-GR	2	Green 3" Drawer
	MBD190UC1-NG	2	Neon Green 3" Drawer
	MBD190UC1-OR	2	Orange 3" Drawer
	MBD190UC1-YE	2	Yellow 3" Drawer
17	MBD190UC2	1	Red 6" Drawer
	MBD190UC2-BK	1	Black 6" Drawer
	MBD190UC2-BL	1	Blue 6" Drawer
	MBD190UC2-GR	1	Green 6" Drawer
	MBD190UC2-NG	1	Neon Green 6" Drawer
	MBD190UC2-OR	1	Orange 6" Drawer
	MBD190UC2-YE	1	Yellow 6" Drawer
18	MBS190UC	1	Red Bottom Shelf
	MBS190UC-BK	1	Black Bottom Shelf
	MBS190UC-BL	1	Blue Bottom Shelf
	MBS190UC-GR	1	Green Bottom Shelf
	MBS190UC-NG	1	Neon Green Bottom Shelf
	MBS190UC-OR	1	Orange Bottom Shelf
	MBS190UC-YE	1	Yellow Bottom Shelf
19	RS190UCPBT	3	Prybar Tube/each

Also available: RS190UC5LK
RSSCPK
RSSCRBS
RSSCRBS-T
RSDETPR

5 Piece Liner kit
Service Cart Polishing Kit
Roller Bearing Slides for Drawers/pair
Roller Bearing Slides for Sliding Top/pair
Detents for Roller Bearing Slides/pair

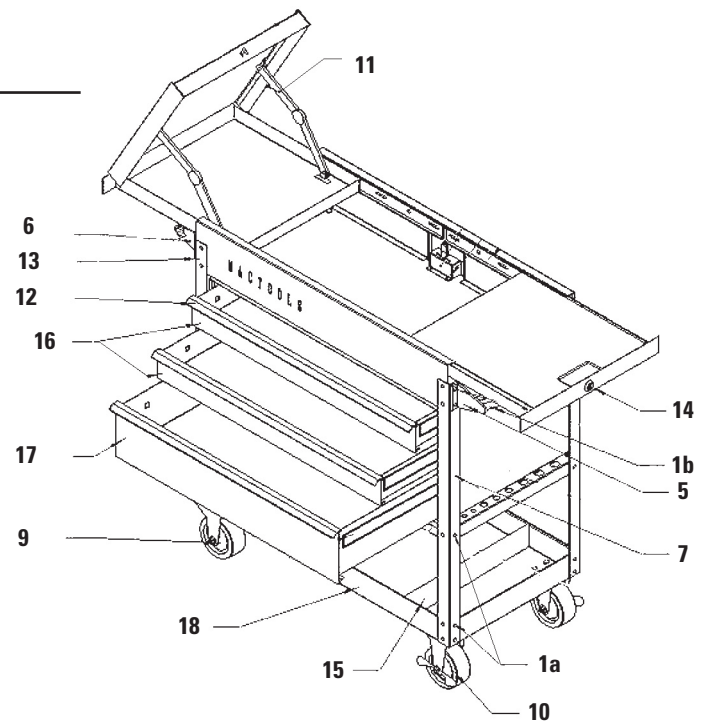

PART DRAWINGS

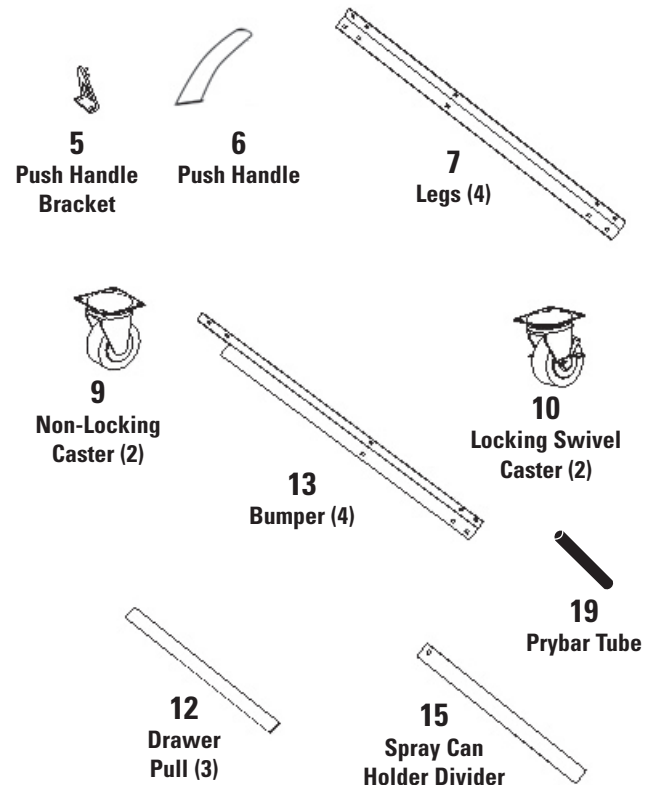

* Available in the following bolt kits:
RS190UCBK1 item# 1a, 2, 3 (32 pieces)
RS190UCBK2 item# 1b, 2, 3 (8 pieces)
RS190UCBK3 item# 2, 3, 8 (16 pieces)

L-Shaped hex key included for adjusting the tension on the RSBKT bracket (item no.11)

TOOLS NEEDED FOR ASSEMBLY:
2 - 14mm Combination Wrenches
13mm Socket or Universal Socket
4" Extension
1/4" Ratchet
#2 Phillips Screwdriver