

HYDRAULIC SERVICE JACK

2 TON CAPACITY

Models 91-652 93652, YA652

Series "E"

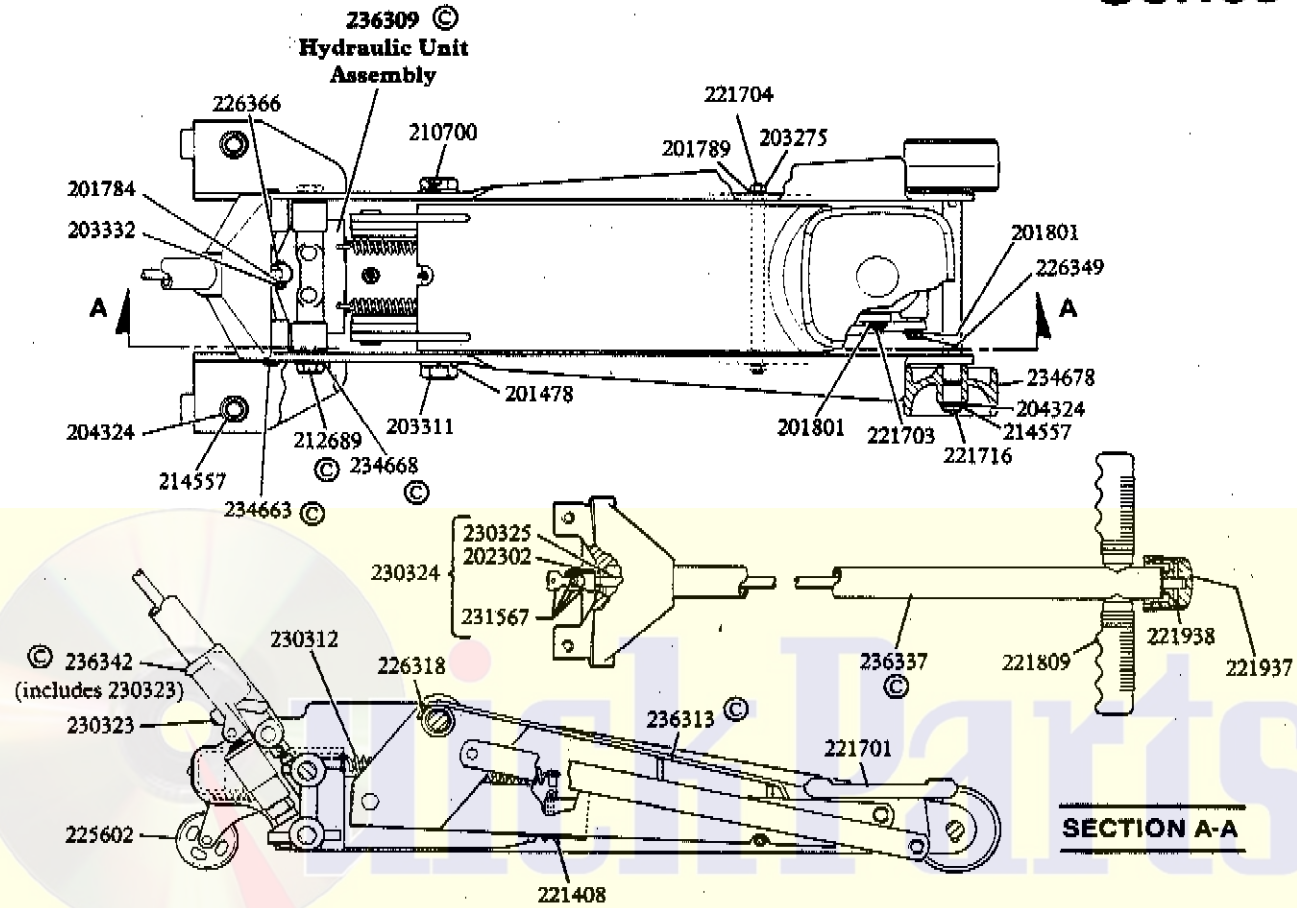

© Indicates Change

MODEL	LABEL KIT NO.	REPAIR KIT NO.
91-652	240169	91-417
93652	240170	240524
YA652	240171	240524

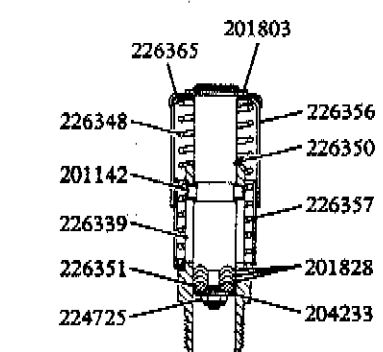

**227045
PUMP & CYLINDER
ASSEMBLY**

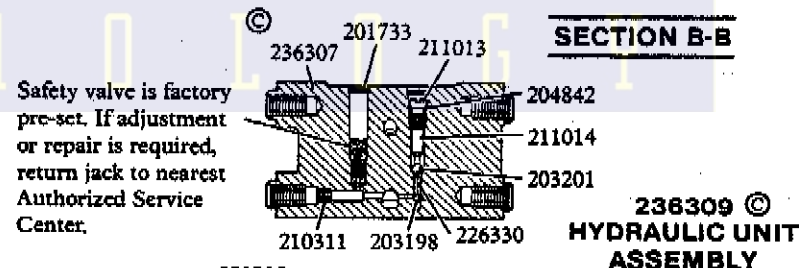

Safety valve is factory pre-set. If adjustment or repair is required, return jack to nearest Authorized Service Center.

SECTION B-B

**236309 ©
HYDRAULIC UNIT
ASSEMBLY**

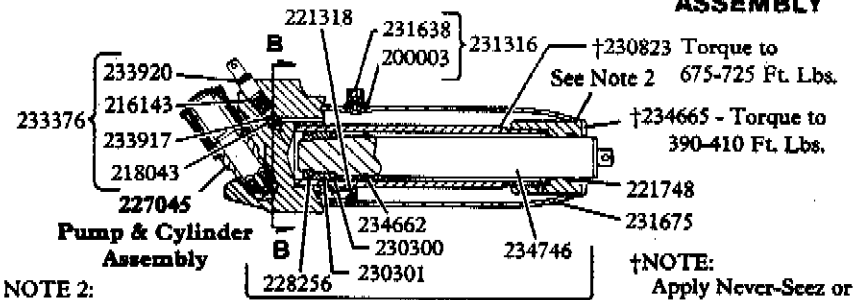

NOTE 2:
Apply Never-Seez or comparable lubricant to end of tank before tightening tank nut.

†230823 Torque to See Note 2 675-725 Ft. Lbs.
†234665 - Torque to 390-410 Ft. Lbs.

†NOTE:
Apply Never-Seez or comparable lubricant to threads before tightening.

LINCOLN
A PENTAIR COMPANY

One Lincoln Way
St. Louis, MO 63120-1578
Customer Service, (314) 679-4300

**SECTION - W1
PAGE - 5E**

L-OCT-86

Copyright 1986
Printed in U.S.A.

FORM 10348E

JUN 19 1986 2:29 PM FROM LINCOLN INDUSTRIAL ST. LOUIS MO. PHONE NO. :

TROUBLESHOOTING

PROBLEM	SOLUTION
1) Oil leaking thru filler plug.	The reservoir could be overfilled - The filler plug is designed with an automatic ventilator valve which allows excessive air or oil to escape from the hydraulic system.
1) Will not lift load. 2) Will not lift full height. 3) Pump feels "spongy" under load.	The jack could be low on oil - Remove the filler plug and fill reservoir with clean Hydraulic Jack Oil. The jack could be air bound - Open the release valve one full turn and pump the handle vigorously. Close the release valve and operate.
1) Release knob difficult to turn. 2) Lifting arm will not retract properly.	The jack might need lubrication - Lubricate pump roller and universal joint with grease or heavy oil. With jack in lowest position, grease the fulcrum pin of the lifting arm through the fitting provided. Raise the jack to its highest position and grease the fulcrum pin again. Lubricate (with a heavy oil) the moving joints accessible with jack in this position.
1) Handle raises under load. 2) Handle lowers under load. 3) Will not lift load. 4) Will not hold load.	The valves might not be closing - Lower the lifting arm and close the release valve. Place one foot on a front wheel and raise the lifting arm to its full height by hand. Open the release valve to lower the lifting arm. The jack should now operate properly.

If the above procedures do not correct the problem, contact your nearest Authorized Warranty and Service Center. When submitting any jack or equipment to be repaired, be sure to state the nature of the problem and indicate whether an estimate of the repair cost is needed.

IMPORTANT: As with any hydraulic unit, this unit may occasionally become "air bound" due to being tipped over during shipment. To purge the air from the oil lines, open the release and pump rapidly a few strokes. Close release and pump to full height, then open the release to allow the ram to descend rapidly. If the pump still seems "spongy", repeat the procedure.

Low Pickup Height	High Lifting Point	Power Raise	Cap Size (Sq.)	Handle Length	Chassis Length	Chassis Height (Max.)	Front Wheel (Dia.)	Caster Wheel (Dia.)
4"	24-1/2"	20-1/2"	6-1/8"	49"	32-3/4"	7-1/4"	3-3/4"	2-1/2"

SERVICE PARTS

PART	QUAN.	DESCRIPTION	PART	QUAN.	DESCRIPTION	PART	QUAN.	DESCRIPTION
200003	1	Gasket	221318	1	Screen	*230301	1	Heel plate
201142	1	Cross pin	221408	1	Cotter pin	230312	2	Spring
201478	2	Lockwasher	221701	1	Cap housing	230323	1	Set screw
201733	2	Expansion plug	221703	1	Pin	230324	1	Rod & universal ass'y.
201784	1	Lockwasher	221704	1	Spacer pin	230325	1	Turning knob rod
201789	2	Lockwasher	221716	1	Axle	230823	1	Ram cylinder
201801	4	Retaining ring	*221748	1	Quad ring	231316	1	Plug & gasket ass'y.
201803	1	Retaining ring	221809	2	Handle grip	231567	1	Universal assembly
*201828	3	V-packing	221937	1	Release knob	231638	1	Filler plug & vent ass'y.
202302	1	Rivet	221938	1	Roll pin	231675	1	Oil tank
*203198	1	Ball	224725	2	Nut	233376	1	Release stem ass'y.
*203201	1	Ball	225602	2	Caster	*233917	1	Plastic spring
203275	2	Nut	226318	1	Grease fitting	233920	1	Release stem
203311	2	Nut	226330	1	Spacer	234662	1	Up-stop ring
203332	1	Nut	226339	1	Pump cylinder	234663	2	Pin
204233	1	Washer	226348	1	Spring	234665	1	Tank nut
204324	4	Washer	226349	1	Pin	234668	4	Washer
*204842	1	Gasket	226350	1	Pump piston	234678	2	Front wheel
210311	1	Pipe plug	*226351	1	Adapter	234745	1	Ram assembly
210700	1	Fulcrum pin	226356	1	Pump sleeve (top)	234746	1	Ram
211013	1	Pressure plug	226357	1	Pump sleeve (bottom)	236307	1	Unit block
211014	1	Spacer	226365	1	Pump sleeve cover	236309	1	Hydraulic unit ass'y
212689	4	Bolt	226366	1	Bolt	236313	1	Bell crank ass'y
214557	4	Retaining ring	227045	1	Pump assembly	236337	1	Handle
*216143	1	O-ring	*228256	1	U-cup packing	236342	1	Handle socket ass'y
218043	1	Release valve	230300	1	Washer			

*Included in 91-417 & 240524 Repair Kits.