

SPREADER

1 TON CAPACITY

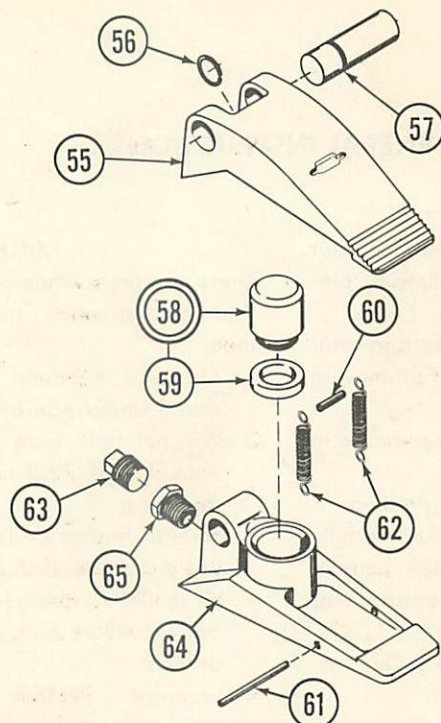

Code No.	Part No.	Description	No. Req'd.	Code No.	Part No.	Description	No. Req'd.
55	230786	Spreader - Upper Half	1	61	221938	Rollpin - Return Spring	1
56	230792	Retaining Ring	1	62	230791	Return Spring	2
57	230790	Fulcrum Pin	1	63	230674	Pipe Plug	1
58	230782	Ram Assembly	1	64	230788	Spreader - Lower Half	1
59	230785	"U"-Cup	1	65	230973	Reducer	1
60	219960	Rollpin - Return Spring	1				

NUMERICAL LISTING OF PARTS

Part No.	Code No.	Part No.	Code No.	Part No.	Code No.	Part No.	Code No.
93138	45, 53	220018	3	230661	5	230717	42
200003	32	221938	61	230662	20	230718	38
201733	26	222201	18	230663	19	230719	44
203196	30	226179	11	230664	2	230720	37A
203197	15	226180	6	230665	1	230763	46, 54
203201	17	226373	27	230674	63	230782	58
204281	10	226375	28	230695	47	230785	59
209910	7	226376	29	230699	50	230786	55
212540	31	230650	21	230700	41, 51	230788	64
213149	9	230651	23	230702	48	230790	57
214154	13	230652	24	230703	52	230791	62
214161	12	230653	22	230711	36	230792	56
216258	8	230654	14	230712	35	230973	65
217909	16	230656	4	230713	40	231808	39
218776	25	230658	34	230715	37	231809	49
219960	60	230660	33	230716	43		

ORDER BY PART NUMBER, NOT BY CODE NUMBER