

**PARTS BREAKDOWN**  
**JSJ-2 1/4 HYDRAULIC GARAGE SERVICE JACK**

JSJ-2 1/4S  
 12/86

**FILE**

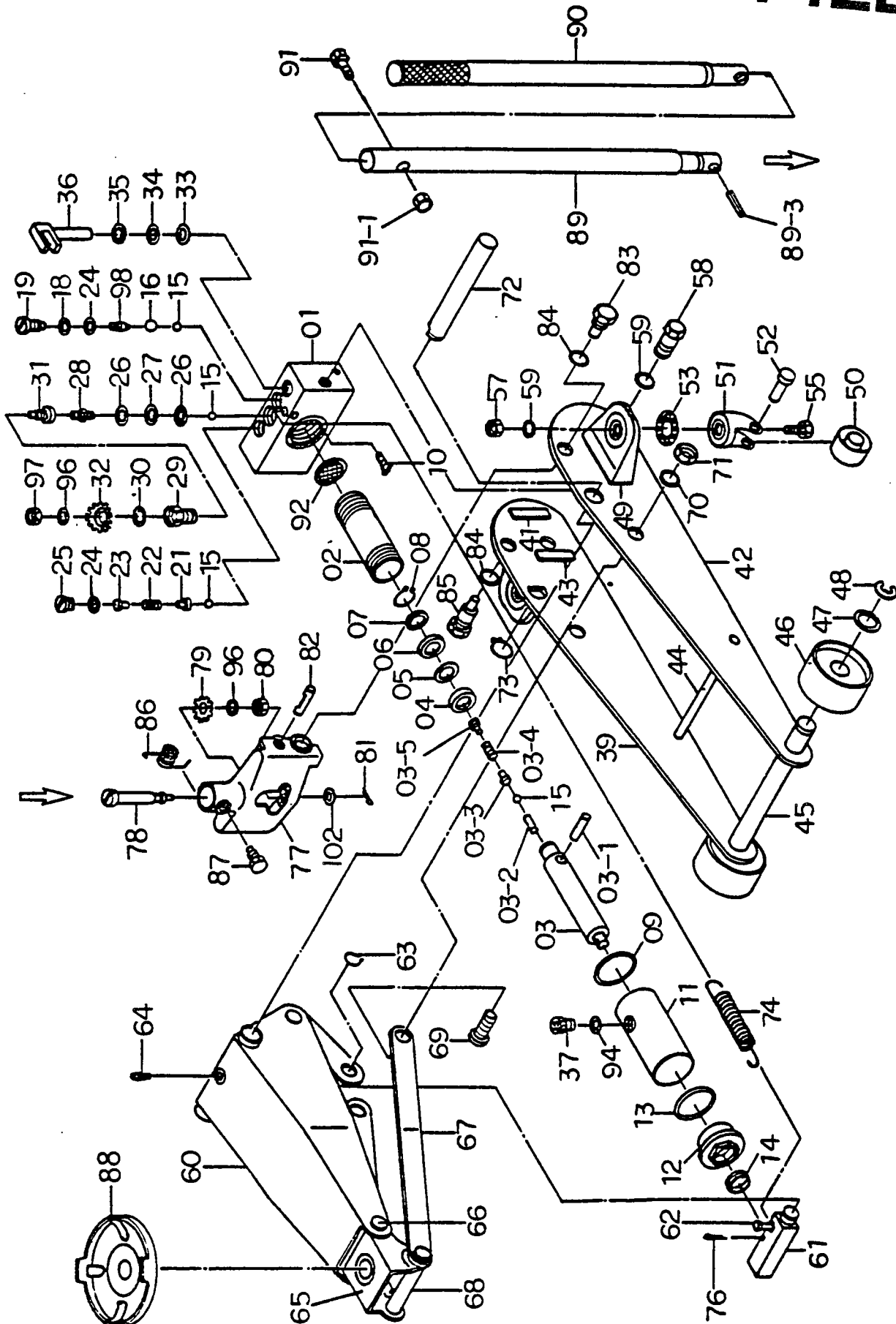

# TROUBLESHOOTING

JSJ-2 1/4 S

TROUBLE	POSSIBLE CAUSE	REMEDY
Jack does not lift.	1. Release oil valve. 2. Oil exhausted. 3. Defective suction and/or exhaust valve. 4. Defective packing.	1. Tighten release valve. 2. Fill tank with oil 3. Check for dust or foreign matter, and clean. 4. Replace packing.
Lifts only half way.	Insufficient oil.	Check oil supply and fill.
Lifts, but then lowers out of control.  Erratic lift.	1. Defective suction 2. Defective piston packing.  Defective plunger packing and/or incorrect valve.	1. Clean valves and adjust valve contact. 2. Replace the piston packing.  Clean valves and/or packing. Replace oil.

FILE

## PARTS LIST JSJ-2 1/4 HYDRAULIC GARAGE SERVICE JACK

ITEM NO	DESCRIPTION	QTY	ITEM NO	DESCRIPTION	QTY
01	BASE	1	49	REAR CASTER BRACKET	2
02	CYLINDER	1	50	REAR CASTER	2
03	RAM	1	51	FORK, SWIVEL, REAR CASTER	2
03-1	PIN	1	52	SHAFT, REAR CASTER	2
03-2	STEM	1	53	BALL BEARING	2
03-3	PLUNGER SPRING	1	55	BOLT	2
03-4	SPRING	1	57	NUT	2
03-5	SCREW	1	58	BOLT	2
04	RETAINER, RAM	1	59	SPRING WASHER	4
05	BACK-UP RING	1	60	LIFTING ARM ASSY	1
06	CUP SEAL	1	61	CONNECTING ROD	1
07	CUP WASHER	1	62	PIN	1
08	SNAP-RING "C."	1	63	SNAP-RING "C."	2
09	PACKING	1	64	GREASE FITTING	1
10	FILTER	1	65	SADDLE BASE	1
11	RESERVOIR	1	66	PIN, LIFTING ARM	1
12	TOP NUT	1	67	SIDE LINK	2
13	"O"-RING	1	68	PIN, SIDE LINK	1
14	SEAL, TOP NUT.	1	69	SCREW, SIDE LINK	2
15	STEEL BALL 1/4"	4	70	SPRING WASHER	2
16	STEEL BALL 3/8"	1	71	NUT	2
18	WASHER	1	72	SPINDLE, LIFTING ARM	1
19	BOLT, CHECK VALVE	1	73	SNAP-RING "C."	1
21	SPRING PLUNGER	1	74	SPRING	1
22	SPRING	1	76	SPLIT PIN	1
23	SCREW, SPRING	1	77	HANDLE FORK	1
24	SEAL	2	78	CONNECTING ROD, RELEASE VALVE	1
25	BOLT, SAFETY VALVE	1	79	GEAR, CONNECTING ROD, RELEASE VALVE	1
26	WASHER	2	80	NUT	1
27	COLLAR	1	81	SPLIT PIN	1
28	RELEASE VALVE	1	82	PIN	1
29	NUT, RELEASE VALVE	1	83	SHAFT, HANDLE	1
30	"O"-RING	1	84	SPRING WASHER	2
31	CONNECTING ROD, RELEASE VALVE	1	85	SHAFT, HANDLE	1
32	GEAR, RELEASE VALVE	1	86	TORSION SPRING	1
33	"O"-RING	1	87	SET SCREW, HANDLE	1
34	BACK-UP RING	1	88	SADDLE KIT	1
35	SEAL, DUST	1	89	HAND LEVER "A."	1
36	PUMP PISTON	1	89-3	PIN	1
37	FILLER PLUG	1	90	HAND LEVER "B."	1
39	FRAME, R.H.	1	91	BOLT	1
41	FIXED SHEET	2	91-1	NUT	1
42	FRAME, L.H.	1	92	SCREEN, CYLINDER	1
43	FIXED SHEET	1	94	"O"-RING, FILLER PLUG	1
44	LIFTING ARM STOP ROD	1	96	SPRING WASHER	2
45	FRONT SPINDLE	1	97	NUT	1
46	FRONT WHEEL	2	98	SPRING	1
47	WASHER	2	102	WASHER	1
48	SNAP-RING "E."	2			