

# **OPERATOR'S MANUAL**

## **HP-35 Hydraulic Press**

**JET Equipment & Tools**



1901 JEFFERSON AVENUE / TACOMA WASHINGTON 98402 / (206) 572-5000

# 35 Ton Capacity Hydraulic Press Assembly

## Assembly Procedure

1. Fix Leg(1-2) and Cross member(1-10) to the lower part of Main column (1-1) with Bolt, Nut and Spring washer.

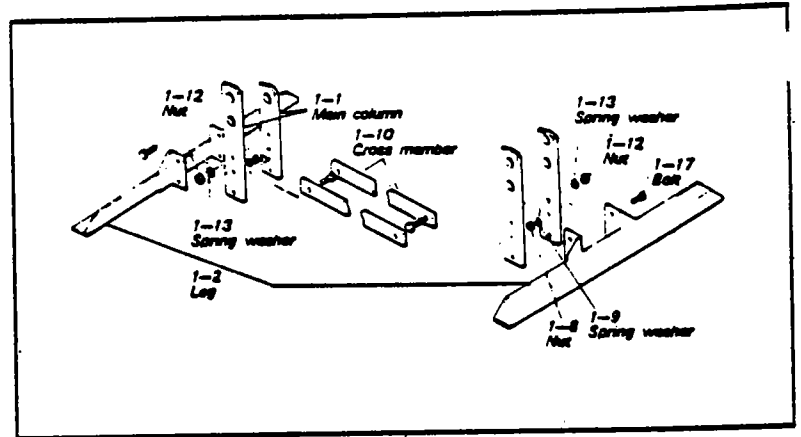

2. Pass four Work frame bolts (1-22) through Work frame(1-15) and fasten them with Nut and Spring washer. Never forget to fit the upper Work frame bolt (1-22) with Guide roller (9-14).

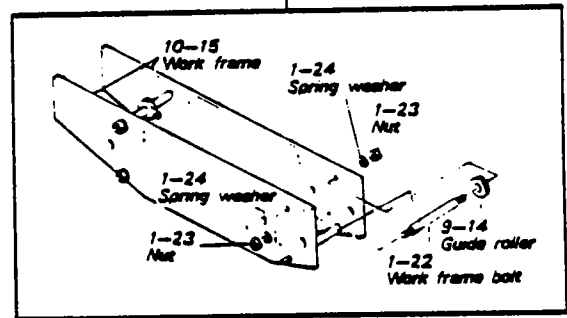

3. Fix Work frame(1-15) to Main column (1-1) and pass Stopper(1-26) through any holes of Main column(1-1) at your discretion.

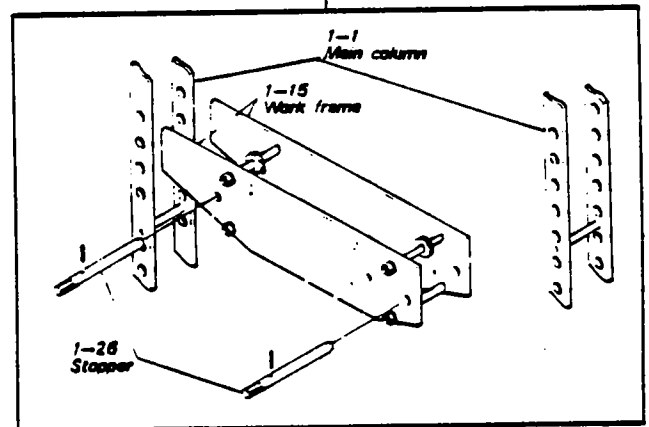

4. Fix Upper plate(1-14) to the upper part of Main column(1-1) with Bolt, Nut and Spring washer.

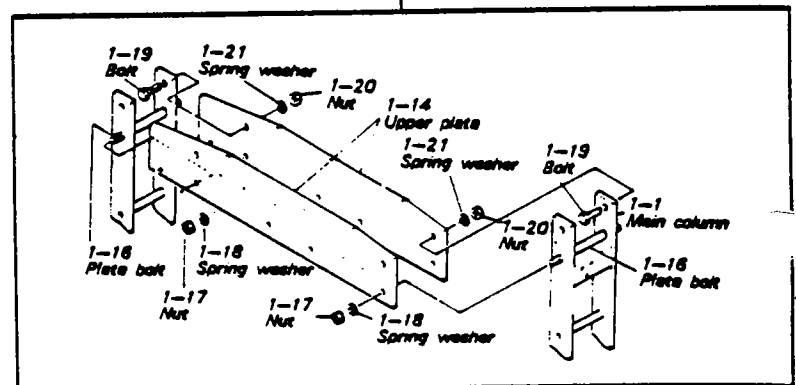

# 35 Ton Capacity Hydraulic Press Assembly

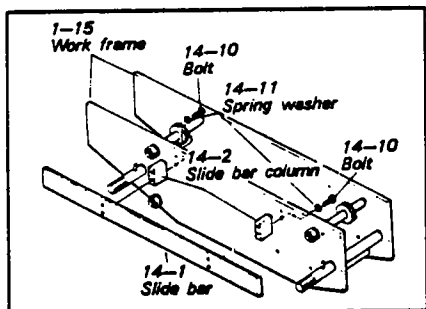

5. Fix Slide bar(14-1) to the front side of Work frame(1-15) with Bolt and Spring washer, interposing Slide bar column (14-2).

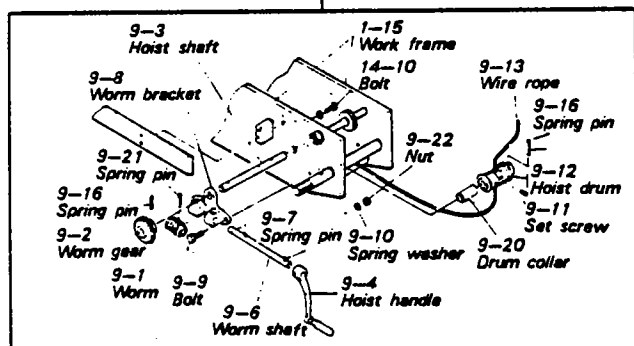

6. Fix Worm bracket(9-8) to the front side of Work frame(1-15) with Bolt, Nut and Spring washer.

\* Place Hoist drum(9-12) and Drum collar (9-20) between Work frames(1-15), insert Hoist shaft(9-3), drive Spring pin (9-16) centering the hole of Hoist drum(9-12) and at last fasten with Set screw (9-11).

\* Fix Worm gear(9-2) to an end of Hoist (9-3), driving Spring pin(9-16).

\* Fit Worm(9-1) and Worm gear(9-2) together to insert Worm shaft(9-6) and drive Spring pin(9-21).

7. Pass an end of Wire rope(9-13) round Bolt(1-19) and fasten it tightly with Wire clip(9-16).

Lead the other end of Wire rope(9-13) outside Guide roller(9-14) on Work frame bolt(1-22) and then through the center of Hoist drum (9-12).

Lead the other end of Wire rope(9-13) outside another Guide roller (9-14) on the opposite Work frame bolt(1-22) and then round the upper Bolt(1-16) of Main column(1-1) finally to fasten tightly with Wire clip(9-15).

8. Fix Hoist handle (9-4) to Worm shaft (9-6) and turn it in a clockwise direction to wind Wire rope(9-13) round Hoist drum (9-12).

Continue to wind, and Wire rope (9-13) will become tight and then will lift up Work frame (1-15). gradually.

Turn Hoist handle (9-4), and Stopper (1-26) will become loose. At this time, extract the two Stoppers (1-26), and you can bring Work frame (1-15) up and down freely.

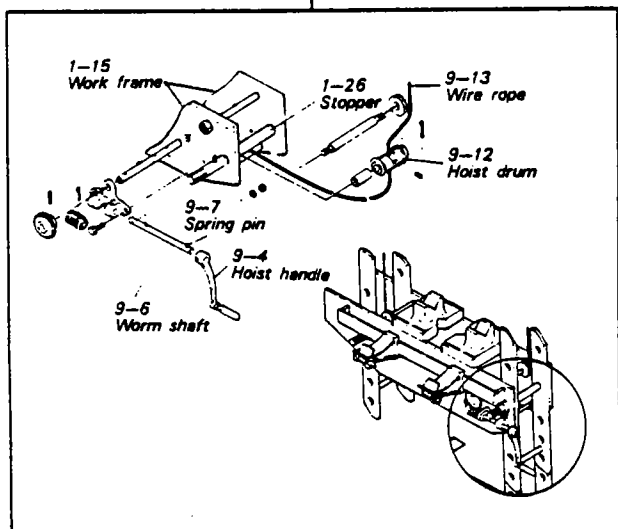

# 35 Ton Capacity Hydraulic Press Assembly

9. Place Cylinder Assembly between Upper plates (1-14) from below and fix Cylinder saddle (2-2) to Upper plate (1-14) with Bolt and Spring washer.

10. Fix Oil Box Assembly to Oil box bracket (5-6) with Bolt and Spring washer.

\* Fix High pressure pipe (2-13) with Cap nut (2-11) to Union (2-10) for one end to Nipple (5-2) for the other.

\* Insert an end of Suction pipe (4-10) into Oil suction Bolt (4-3) fastened to Oil tank (4-1) and attach Hose band (2-16). Insert the other end into the rear Fitting (4-9) provided on Oil box (5-1) and attach Hose band (2-16).

\* Insert an end of Drain pipe (5-11) into Coupling (4-9) fixed on the lower side of Oil tank (4-1) and attach Hose band (2-16). Insert the other end into the front Fitting (4-9) provided on Oil box (5-1) and attach Hose band (2-16).

\* Insert an end of By-pass pipe (2-15) into Nipple (2-14) fixed to Gland (2-5) and attach Hose band (2-16).

Insert the other end into Coupling (4-9) fixed on the lateral side of Oil tank (4-1) and attach Hose band (2-16).

\* Connect an end of Pressure gauge pipe (8-3) with Shock absorber (A) fixed to Pressure gauge (8-4) and the other end with Nipple (10-1) fixed on the rear side of Oil box (5-1).

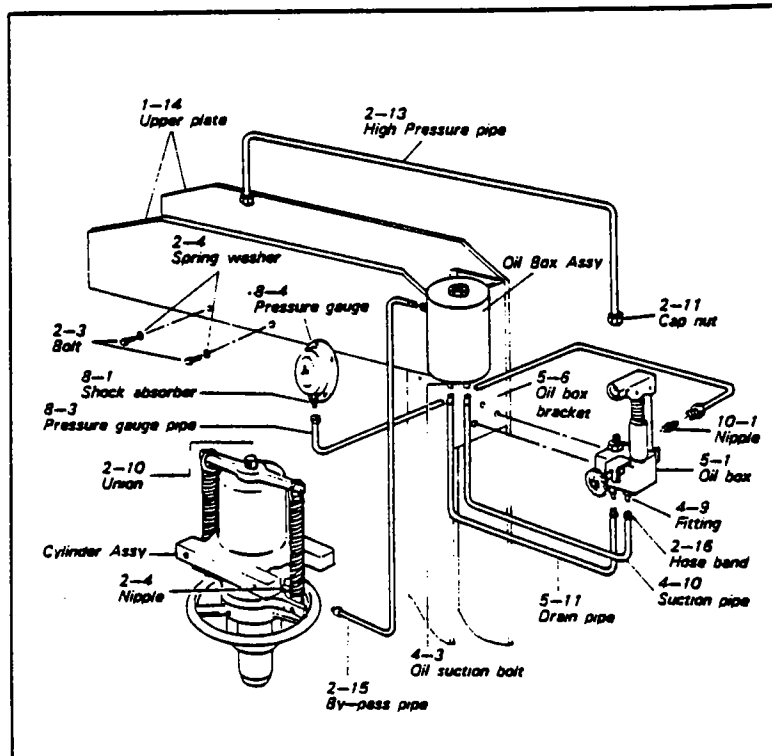

# 35 Ton Capacity Hydraulic Press Assembly

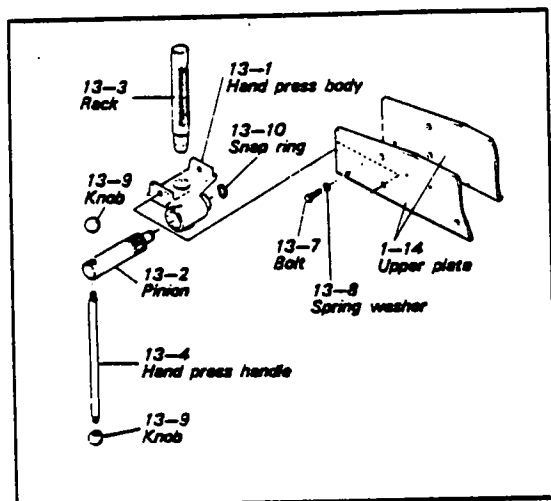

11. Fix Hand press body (13-1) onto the left side of Upper plate (1-14) and fasten with Bolt and Spring washer.

\* Pass Rack (13-3) through Hand press body (13-1) and then pass Pinion (13-2) through the same so that the gear tooth of Rack (13-3) and that of Pinion (13-2) can fit together. Attach Snap ring (13-10) to Pinion (13-2).

\* Pass Hand press handle (13-4) through Pinion (13-2) and screw Knob (13-9) to the both ends of Hand press handle (13-4).

\* Confirm that Rack (13-3) goes up when Hand press handle (13-4) is turned in a counter-clockwise direction, while it goes down when the latter is turned in a clockwise direction.

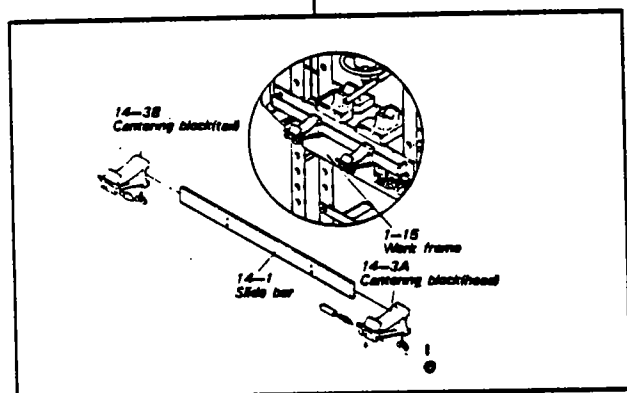

12. Fit Slide bar (14-1) attached to Work frame (1-15) with Centering block (tail) (14-3B) from the left and Centering block (head) (14-3A) from the right.

## CAUTION

When Work frame (1-15) is at a standstill or loaded, never forget to set two Stoppers (1-26) in the hole of Main column (1-1) to assure the stationary position, and loosen Wire rope (9-15).

HP-35

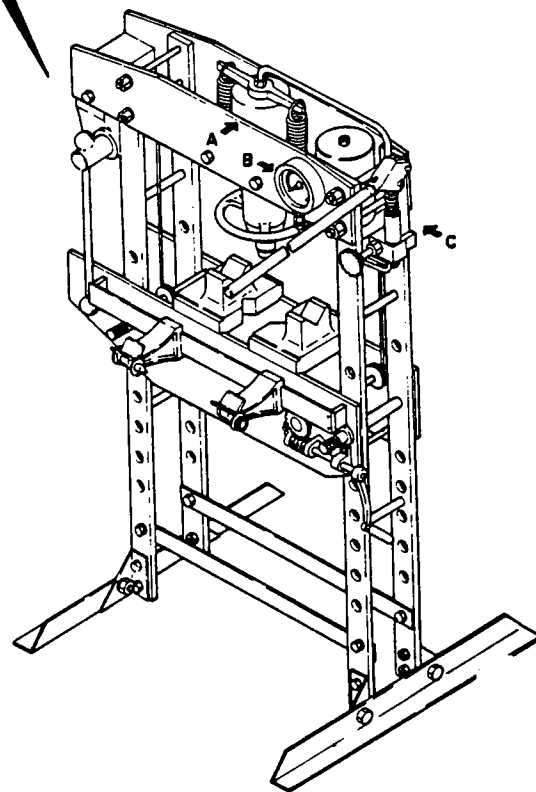
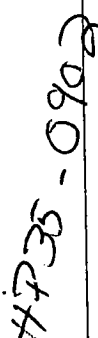

## HP-35 Hydraulic Press

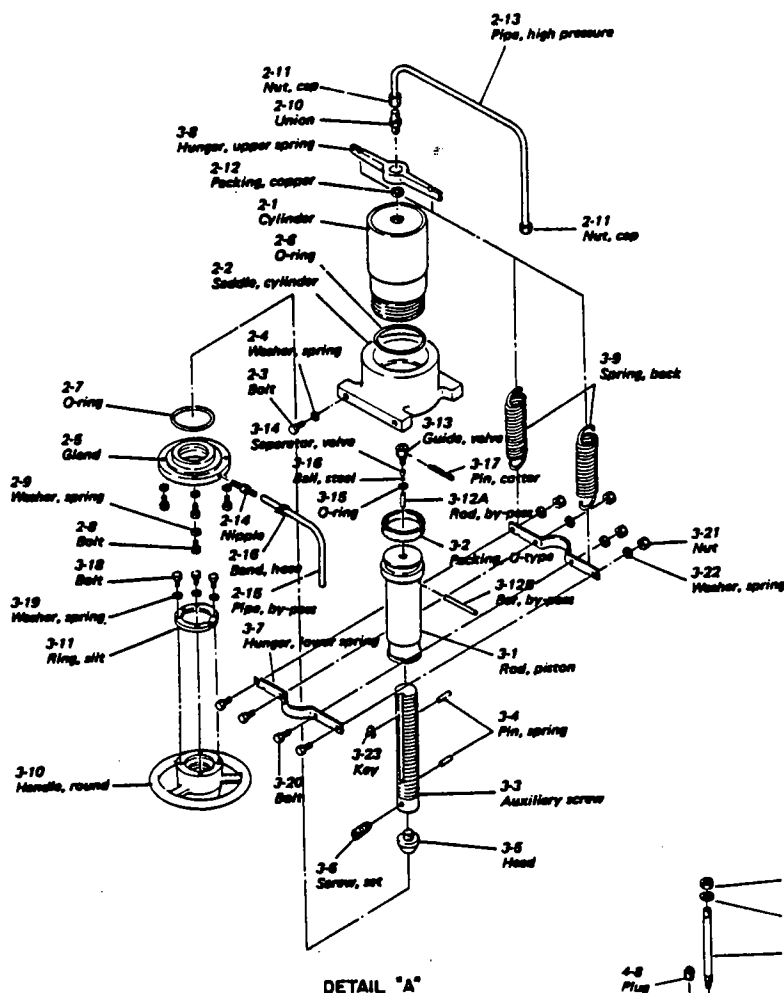

**DETAIL "A"**

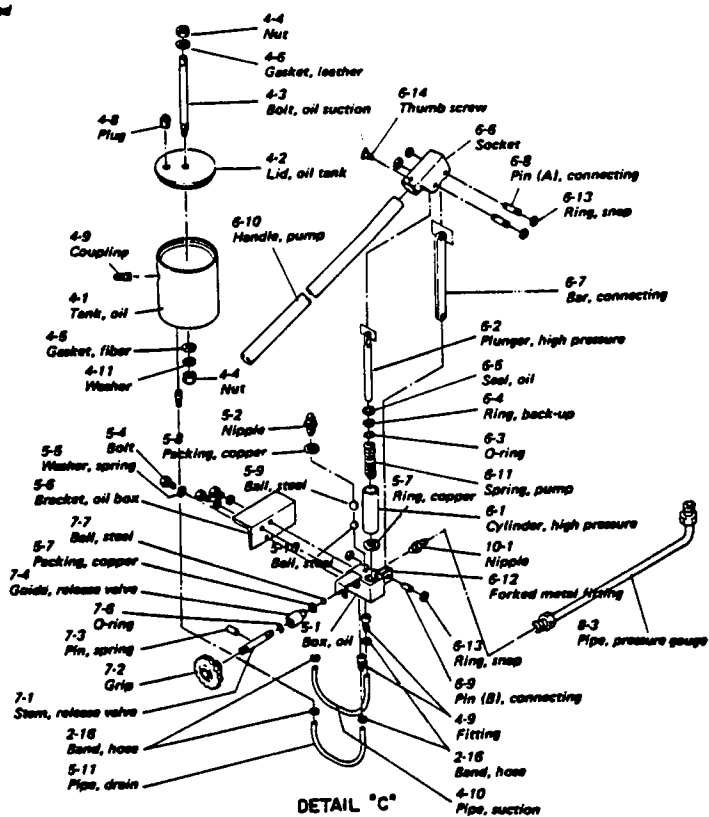

**DETAIL "C"**

# Hydraulic Press

HP-35

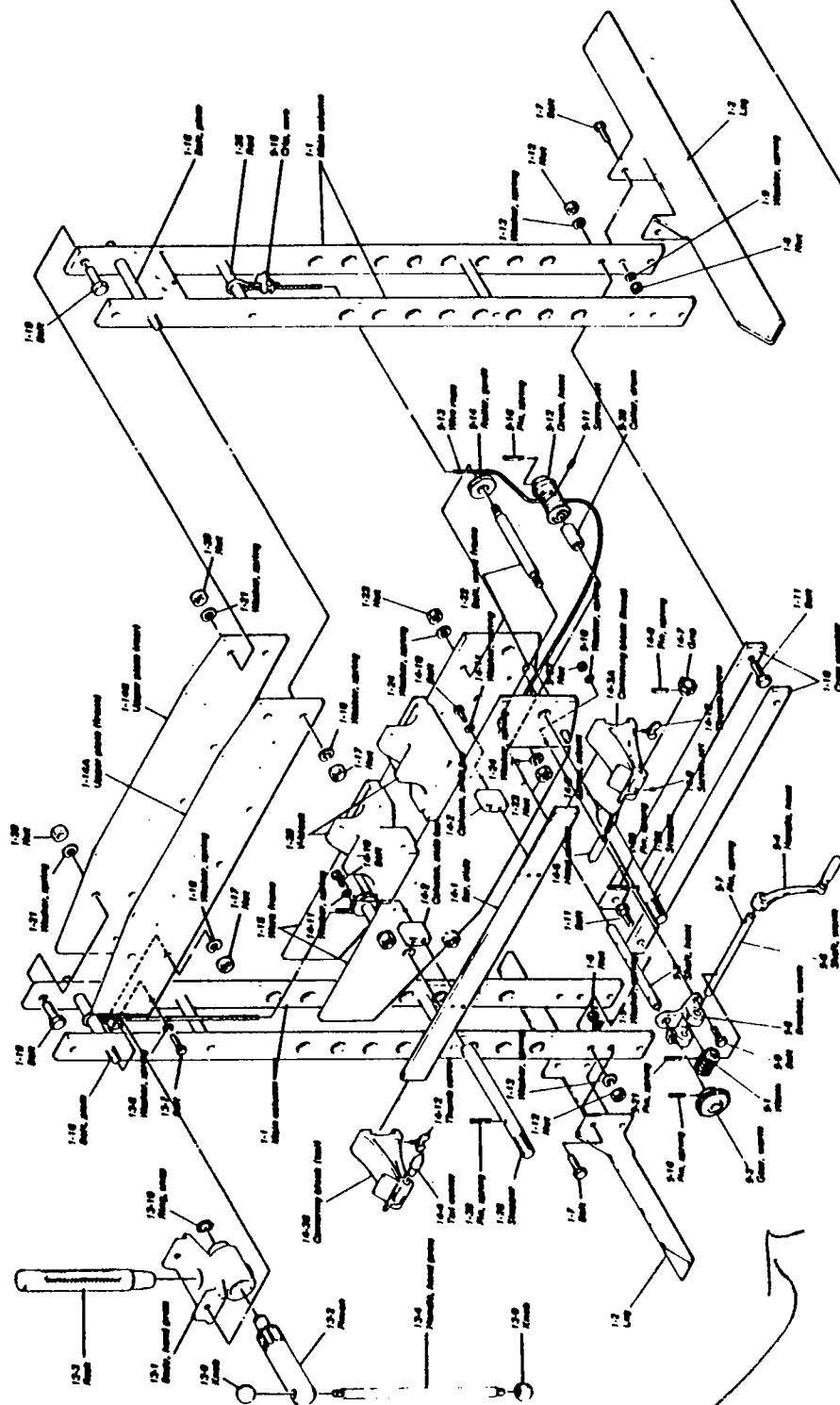

HP-35-0902

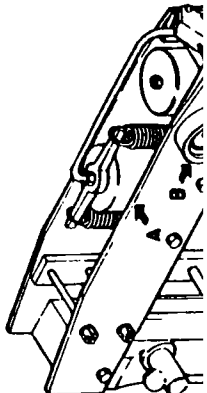



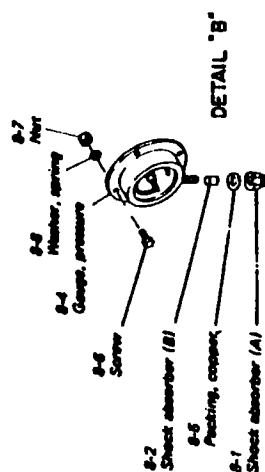
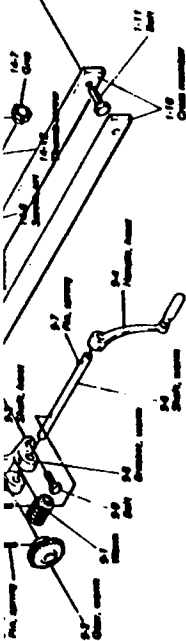

**DETAIL 'B'**

7

SETH

# HP-35 Hydraulic Press

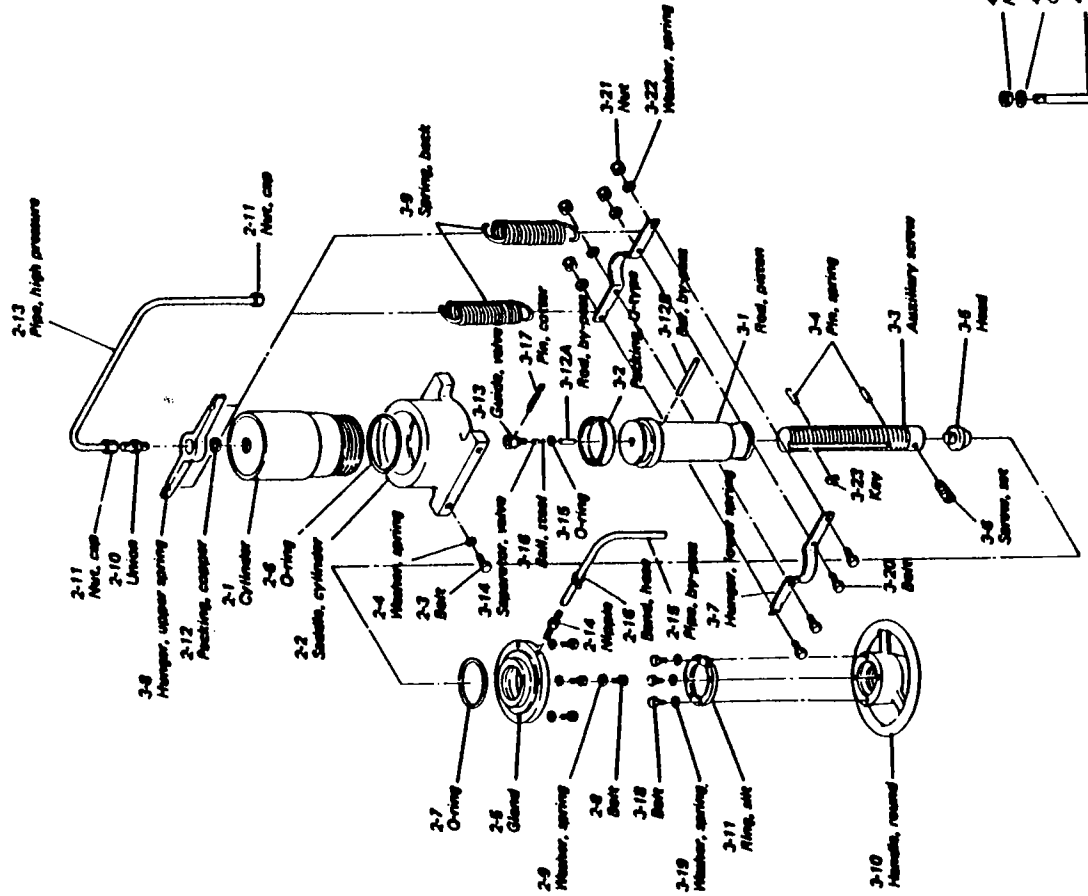

DETAIL "A"

