

INSTRUCTION MANUAL REPAIR PARTS LIST

WARRANTY

OPERATION

MAINTENANCE

TROUBLESHOOTING

PARTS SHEET

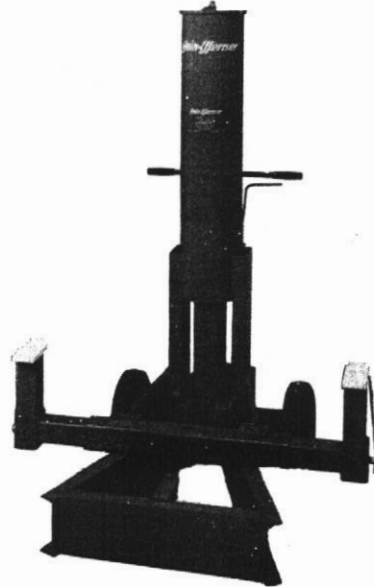

Warranty to Commercial Customers

Hein-Werner warrants its products to be free from defects in materials and workmanship for a period of 90 days from the date of original sale to user. Any product proved to Hein-Werner's satisfaction to be defective during that 90-day period will be repaired or replaced, at Hein-Werner's option, if returned to the nearest official service station, transportation charges prepaid. A full and complete explanation of the complaint, and proof of purchase date, must accompany the product. Hein-Werner's sole obligation and buyer's exclusive remedy under this warranty is limited to such repair or replacement.

HEIN-WERNER SHALL NOT BE LIABLE FOR ANY CONSEQUENTIAL, INCIDENTAL OR SPECIAL DAMAGES INCLUDING BUT NOT LIMITED TO LOSS OR DAMAGE RESULTING FROM USE OR LOSS OF USE OF HEIN-WERNER PRODUCTS WHATSOEVER, WHETHER BASED ON BREACH OF CONTRACT, BREACH OF WARRANTY, NEGLIGENCE OR OTHER TORT, OR ANY STRICT LIABILITY THEORY.

This warranty does not apply to products subjected to accident, damage by circumstances beyond Hein-Werner's control, improper operation, maintenance or storage, or to other than normal application, use or service.

THIS WARRANTY IS IN LIEU OF ALL OTHER WARRANTIES, EXPRESS OR IMPLIED, INCLUDING, BUT NOT LIMITED TO, THE IMPLIED WARRANTIES OF MERCHANTABILITY AND FITNESS FOR A PARTICULAR PURPOSE.

HEIN-WERNER CORPORATION
1005 PERKINS AVENUE
WAUKESHA, WISCONSIN 53186



CAUTION



1. **THIS IS A LIFTING DEVICE ONLY. THE LOAD MUST BE SUPPORTED IMMEDIATELY BY OTHER APPROPRIATE MEANS.**
2. **DO NOT OVERLOAD. OVERLOADING CAN CAUSE DAMAGE TO OR FAILURE OF THE JACK.**
3. **THIS JACK IS DESIGNED FOR USE ONLY ON HARD LEVEL SURFACES CAPABLE OF SUSTAINING THE LOAD. USE ON OTHER THAN HARD LEVEL SURFACES CAN RESULT IN JACK INSTABILITY AND POSSIBLE LOSS OF LOAD.**
4. **FAILURE TO HEED THESE CAUTIONS MAY RESULT IN LOSS OF LOAD. DAMAGE TO JACK AND/OR FAILURE IN PERSONAL INJURY OR PROPERTY DAMAGE.**

OWNER'S RESPONSIBILITY

Operation

The owner must provide that all users understand the manufacturer's operating instructions before operating the jack. He must emphasize all cautionary information.

Maintenance

The owner must verify that the jack is maintained according to the manufacturer's instructions.

Inspection

1. The owner must inspect, or appoint a knowledgeable person to inspect the jack at regular intervals.
2. Frequency of Inspection - each jack must be inspected immediately if subjected to an abnormal load or shock. Regular inspections should be made weekly for daily use and monthly for intermittent use or according to manufacturer's recommendation.
3. Damaged jacks - any jack which appears to be damaged in any way, is deemed, badly worn, or operates abnormally **MUST BE REMOVED FROM SERVICE** until necessary repairs are made.
4. Users should be aware that repair of this equipment may require specialized knowledge and facilities. It is recommended that a periodic inspection of the jack be made by an authorized repair facility. A list of authorized repair facilities is available from the manufacturer.

FEATURES

1. This Lift is equipped with two positive mechanical locking features. The Jack and load will be held in any raised position even if the air line is cut due to the air retained in the cylinder. The mechanical lock automatically engages while Jack is being lowered. This Lock must be manually released before a Jack can be lowered.
2. It is also equipped with a hydraulic "check" in case the load on the lift is removed suddenly.

OPERATING INSTRUCTIONS

Positioning

1. Dolly Jack to center of vehicle under bumper. Slide adjustable lifting pads an equal distance each side of center so that the pads will contact the vehicle at the frame or the bumper brackets.
2. When lifting front end, check to see that gearshift is in neutral position and hand brake released so that vehicle may roll freely towards the Jack as the vehicle is lifted. This puts the minimum amount of strain on bumper brackets and Jack.
3. When lifting rear end, check front wheels of vehicle to see that they point straight ahead. **FRONT WHEELS MUST BE ABLE TO ROLL TOWARD JACK.**

Lifting

1. Open air valve slowly to allow pads to make contact with vehicle. Lift will drift up slightly when valve is released.
2. Open valve and raise to desired height. The mechanical lock will engage automatically at intervals while Jack is being raised.

Lowering

In order to release Jack and remove weight from mechanical lock, apply small amount of air pressure. Lift mechanical locking handle and release lock. Release air by operating valve and hold mechanical lock in off position. Speed of descent is governed by air valve and it is extremely easy to provide smooth operation.



CAUTION



**USE JACK FOR LIFTING ONLY.
ALWAYS SUPPORT VEHICLE WITH
VEHICLE SUPPORT STANDS.**

ORDER PARTS FROM THE NEAREST HEIN-WERNER OFFICIAL SERVICE STATION
- ALWAYS STATE BOTH MODEL AND SERIAL NUMBER.

Save these instructions for future reference.

REPAIR PARTS LIST

Order parts from the nearest Hein-Werner Official Service Station.
Always state both model and serial number.

MODEL AL-50

Part Code 64637
5 Ton Capacity

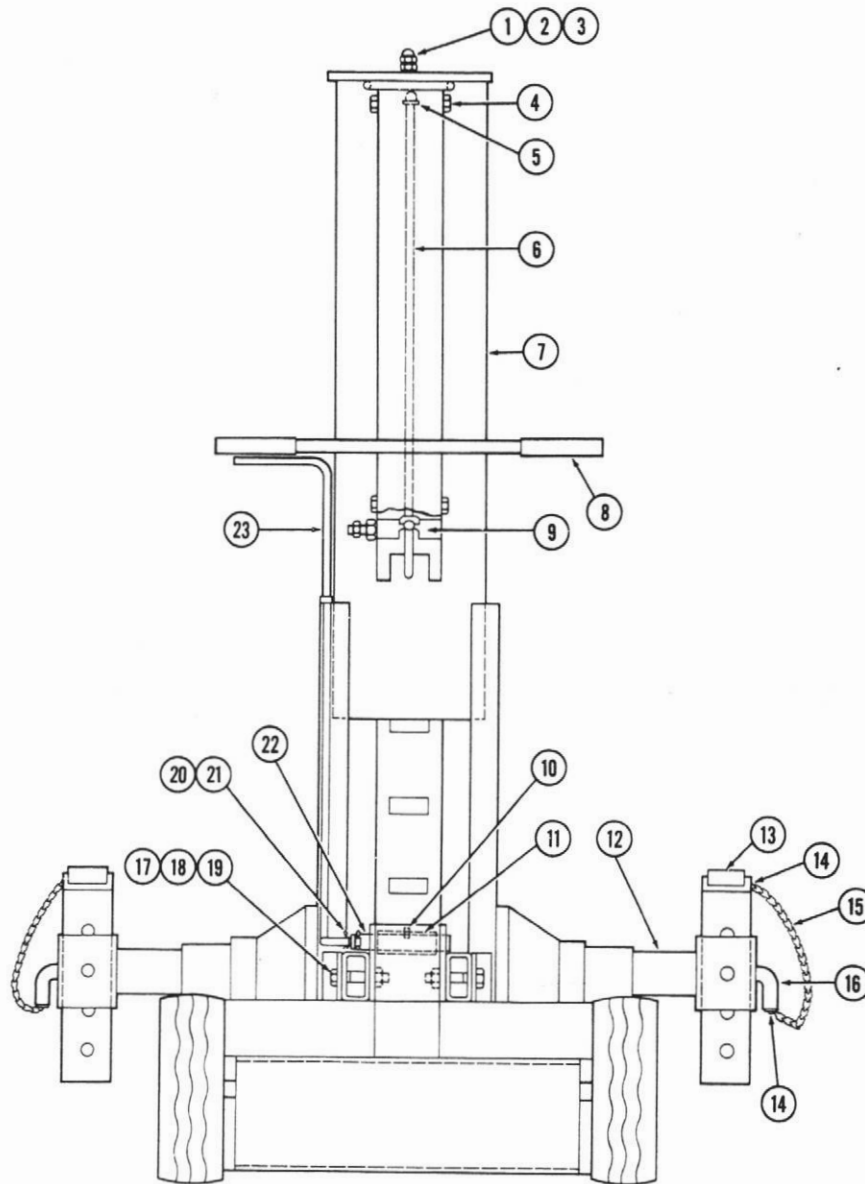

ITEM NO.	PART NO.	DESCRIPTION	QTY.	ITEM NO.	PART NO.	DESCRIPTION	QTY.
1	64736	5/8-11 Acorn Nut	1	13	64782	Pad Assembly	2
2	16260	O-Ring	2	14	64739	Drive Screw	4
3	64735	5/8-11 Hex Nut	1	15	64740	Chain	2
4	64798	3/8-16 X 1/2 Capscrew	4	16	64738	Pin	2
5	64766	90° Elbow	1	17	64793	3/4-10 X 3 1/2 Hex Hd. Bolt	4
6	64708	Air Pipe	1	18	02490	Lockwasher	4
7	64784	Tank Assembly	1	19	64792	3/4-10 Hex Nut	4
8	63732	Handle Grip	2	20	64569	Cotter Pin	2
9	64711	Air Valve	1	21	64789	Washer	2
10	26032	Roll Pin	1	22	64815	Lock Shaft Assembly	1
11	64813	Roller	1	23	64737	Lock Handle	1
12	64783	Slide Arm Assembly	2				

REPAIR PARTS LIST

Order parts from the nearest Hein-Werner Official Service Station.

Always state both model and serial number.

ITEM NO.	PART NO.	DESCRIPTION	QTY.	ITEM NO.	PART NO.	DESCRIPTION	QTY.
24	64803	Lock Nut	1	46	25320	½" Lockwasher	3
25	64802	Lockwasher	1	47	25336	½"-13 Hex Nut	3
26	64799	Flatwasher	1	48	64790	½"-20 X 3/4" Screw	4
27	64734	Piston Cup	1	49	64727	Slide Plate	2
28	64776	Piston	1	50	26720	Jam Nut	2
29	64733	Piston Bearing	1	51	64768	Rod	1
30	64688	Hydraulic Check Assembly	1	52	64771	U-Cup	2
31	64777	Cover	1	53	64772	O-Ring	2
32	64722	Slide Assembly	1	54	16260	O-Ring	1
33	64710	Wheel	2	55	64801	O-Ring	1
34	64773	Washer	5	56	64716	Cylinder Assembly	1
35	64774	Klip Ring	5	57	02675	½" Ball	1
36	64796	1"-8 X 5½" Bolt	1	58	64769	Piston	1
37	64797	Lockwasher	1	59	64554	Elbow	2
38	64795	1"-8 Jam Nut	1	60	64767	Tube	1
39	64690	Roller Assembly	1	61	64763	Reservoir Assembly	1
40	64705	Roller Tube	1	62	64760	Center Plug	1
41	64775	Bearing	2	63	64762	Spring Pin	2
42	64689	Caster Assembly	1	64	64761	End Nut	1
43	64707	Spring	1	65	64759	Tube	1
44	64785	Frame Assembly	1	66	64759	45° Elbow	1
45	64788	½"-13 X 4½" Bolt	3	67	64765	Plug	1

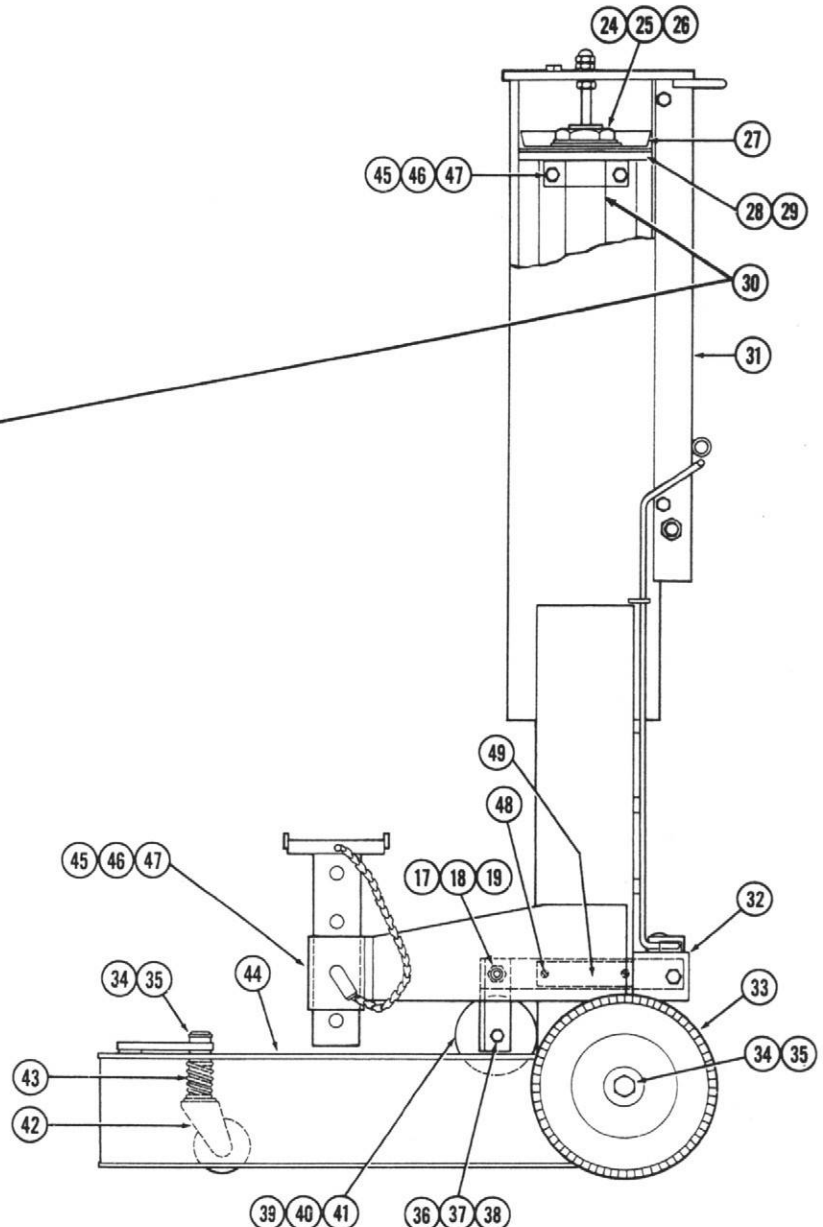
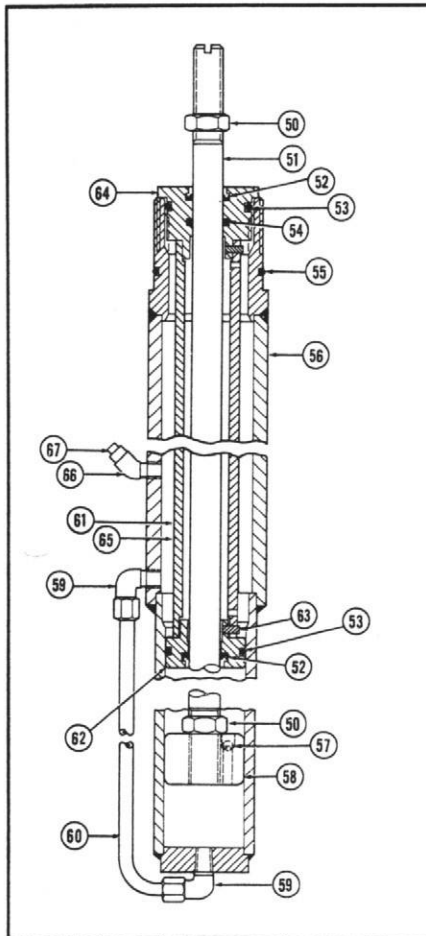

Hein-Werner

CORPORATION

WAUKESHA, WISCONSIN — AJAX, ONTARIO

Form 10-029

PRINTED IN U.S.A.

MAINTENANCE INSTRUCTION

LUBRICATION

Do Not Put Oil Inside Of Cylinder

All mechanical parts should be oiled periodically every 60 days.

NOTE: Both front and rear rollers are equipped with precision roller bearings prepacked with grease. However, after prolonged use or under adverse conditions it is advisable to remove rollers, clean thoroughly and repack with a good grade of heavy duty grease.

Under normal operation, cylinder and piston will need little or no maintenance. If required contact your local Authorized Service Center.

Test Hydraulic Check (At least once each month.)

1. Lower lift all the way down.
2. Stand Clear.
3. With no load - Apply full air.
4. Lift should rise smoothly.
5. Check is low on oil if it rises suddenly a short distance - then continues at a smooth slow rise.
6. To fill, apply air and raise tank to full height. Remove plug through hole near top of vertical post. Fill with clean Hein-Werner hydraulic jack oil.

RECHECK

DO NOT USE HYDRAULIC BRAKE FLUID.

Jack Will Not Lift Load	Jack Will Not Lower	TROUBLESHOOTING CHECKLIST
X		Air pressure might be too low. Check pressure at compressor, and also make sure that air hose is not plugged.
	X	The mechanical lock might be engaged. Admit air until the jack raises slightly, then disengage the bar.

IF THE ABOVE PROCEDURES DO NOT CORRECT THE PROBLEM, CONTACT YOUR NEAREST SERVICE DEPOT. WHEN SUBMITTING ANY JACK OR EQUIPMENT TO REPAIRED, BE SURE TO STATE THE NATURE OF THE PROBLEM AND INDICATE WHETHER AN ESTIMATE OF THE REPAIR COST IS NEEDED.

PRESSURE/LOAD CHART

Air Pressure PSI	Load (Lbs.)	Air Pressure PSI	Load (Lbs.)
185	10,000	145	7,840
175	9,460	135	7,295
165	8,920	125	6,755
155	8,380	115	6,215

SPECIFICATIONS

Capacity (Lbs.)	Low Pickup Height	High Lifting Point	Power Raise	Saddle Spread	Clearance (Air Tank to Front of Saddle)	Min. psi for Rated Load	Shipping Weight (Lbs.)
10,000	13"	58"	45"	34½ to 48¼	13-3/8"	185	558