

BULLETIN

IM-985

REV. NO. 1

OCTOBER, 1986

GREENLEE®

7804

HYDRAULIC PUNCH DRIVER

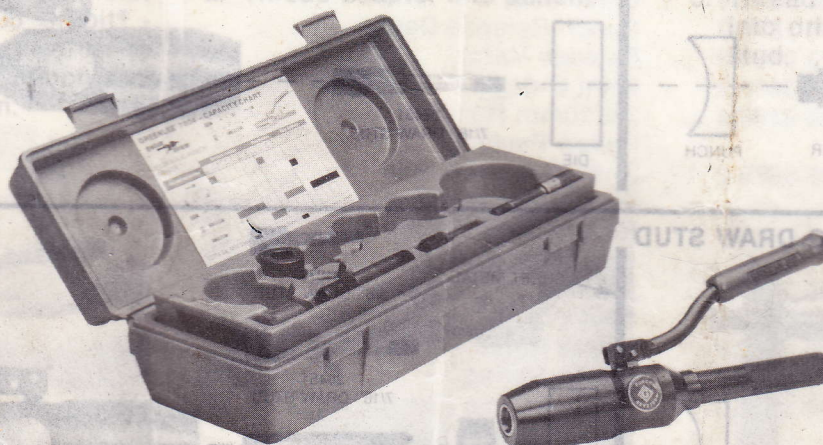

SAFETY FIRST

1. Be sure to operate your driver only with GREENLEE manufactured punches, dies, and draw studs.
2. CAUTION: Do not exceed capacity of unit and draw studs as shown in chart on page 2.
3. Be sure to use only GREENLEE supplied draw studs. Keep the draw stud installed securely to the driver.
4. Do not use 31874 adapter except as outlined in the capacity chart shown on page 2.
5. Always observe the outlined procedures as described in this manual for installation of draw studs, punches, and dies.
6. The driver is capable of punching its rated holes with a maximum of 80 lbs. input force. If excessive force is required, stop and inspect set up for proper assembly.
7. Be sure to check punch sharpness and draw stud threads for wear before using. If dull or damaged replace immediately.
8. Always stand erect on firm, level surface providing solid footing when operating tool.
9. Handle extensions (cheaters) must **never** be used with this tool.
10. This tool operates at 10,000 psi hydraulic pressure and develops approx. 16,000 lbs. force. Treat and use it with care and respect.

The Timesavers

GREENLEE TOOL COMPANY

a division of

Ex-Cell-O

4455 Boeing Drive, Rockford, IL 61109 U.S.A.

PARTS LIST7804 HYDRAULIC PUNCH DRIVER

KEY NO.	PART NO.	DESCRIPTION	QTY.
1	503 2457.8	Cylinder	1
2	503 2456.0	Piston	1
3	503 2468.3	Return Spring	1
4	503 2465.9	Pump Block	1
5	503 2463.2	Plunger	1
6	503 2461.6	Intake Seat and Valve Screen	1
7	503 2458.6	Pump Lever	1
8	503 2464.0	Lever Pin	1
9	503 2467.5	Valve Screw	2
10	503 2471.3	Pump Handle and Cap	1
11	503 2470.5	Reservoir	1
12	503 2469.1	Reservoir Cap	1
13	502 3258.4	Lever Grip	1
14	503 1878.0	Punch Release Decal	1
15	503 2480.2	Release Valve	1
16	905 3466.2	7mm O-ring	1
17	905 3465.4	3 x 10mm Roll Pin	2
18		Piston Packing	1
19	905 0678.2	3/16" Dia. Steel Ball	3
20		Piston Rod Packing	1
21		Plunger and Piston	1
		Extension Packing	2
22	905 3467.0	25mm O-ring Retainer	1
23	503 2462.4	Seat Washer	1
24	905 3463.8	E-type Retaining Ring	4
25	503 2466.7	Check Spring	2
	503 2536.1	Caution Decal (Not Shown)	1

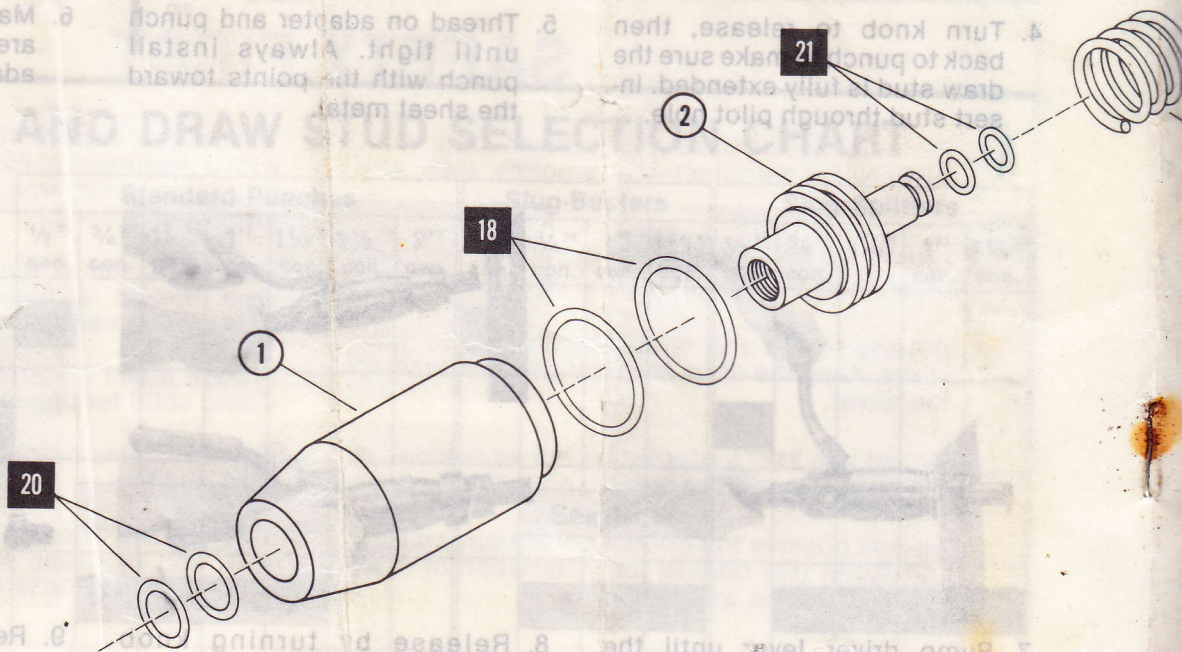

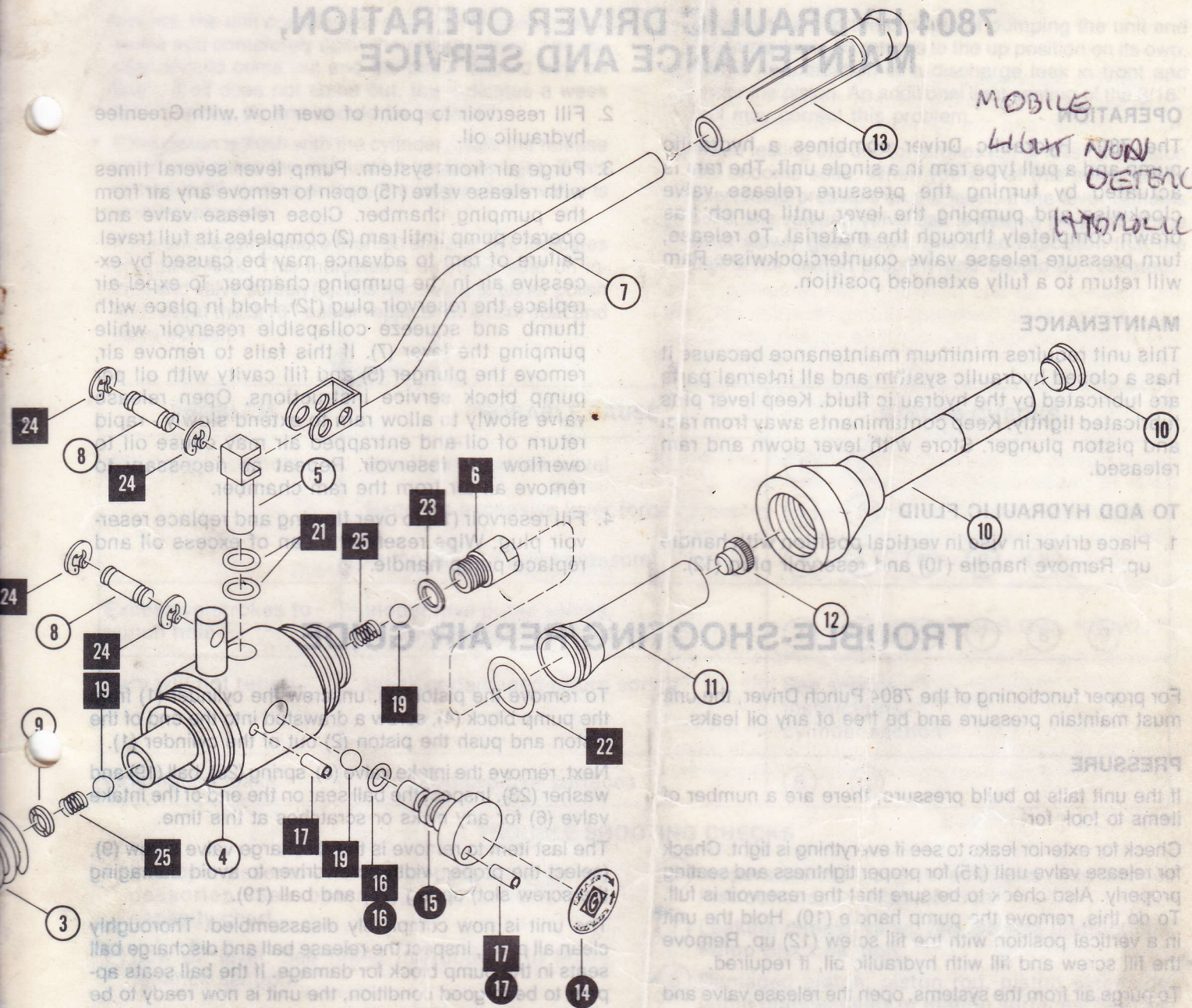

REPAIR KITS

503 2472.1

Release Valve Unit Repair Kit includes items keyed in black circles; 14, 15, 16, and (1)17.

503 2473.0

Hydraulic Repair Kit includes items keyed in black squares; 6, 16 thru 25

DRAW STUDS AND ACCESSORIES

PART NO.

DESCRIPTION

QTY.

503 1873.0

3/8" Draw Stud

1

502 9451.2

7/16" Draw Stud

1

503 1872.1

3/4" Draw Stud

1

503 1874.8

Adapter (adapts punches for 3/4" studs to 7/16" studs)

1

500 3248.8

Spacer (1924AA)

1