

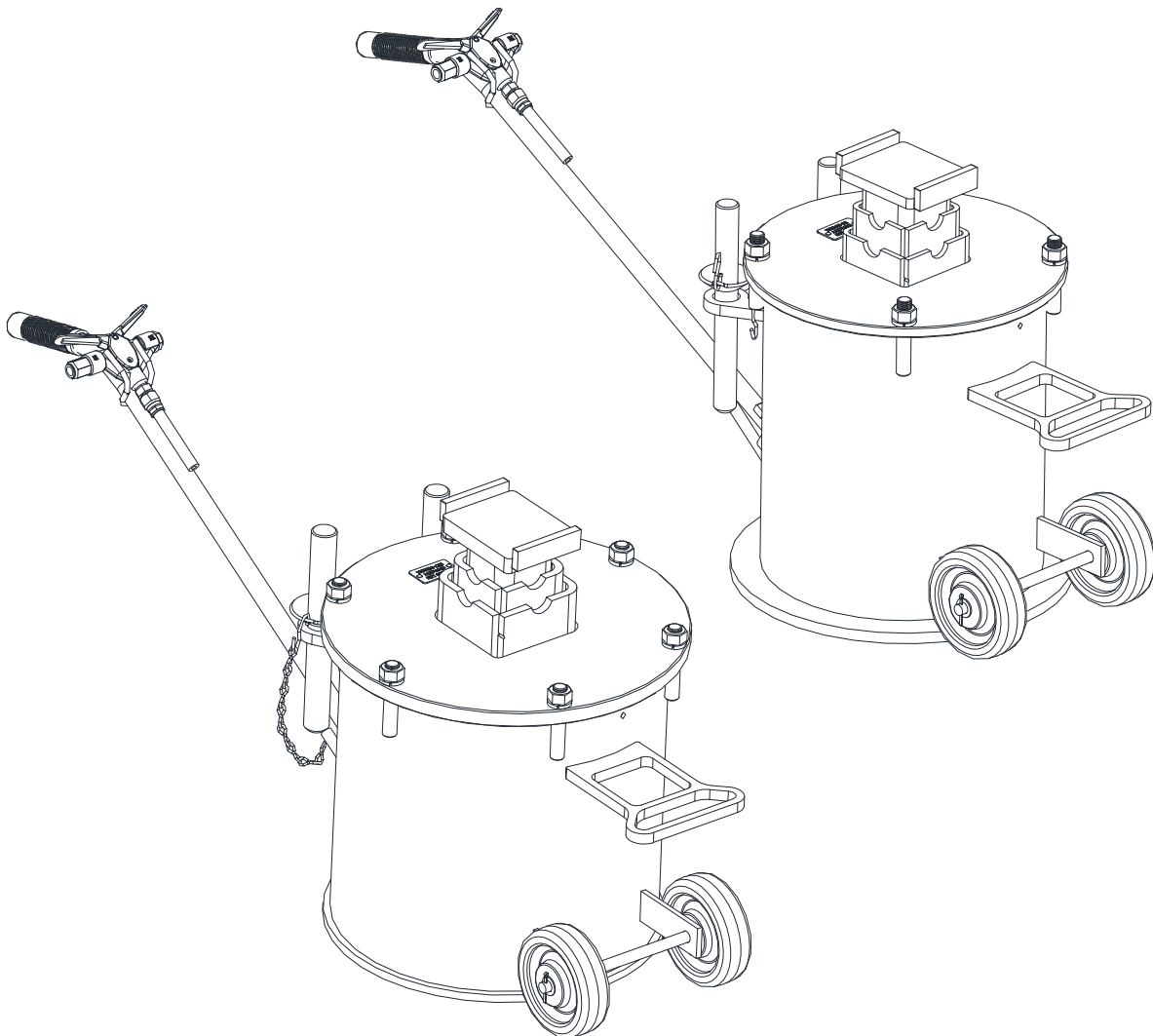

OWNER'S MANUAL

TAJS-2000 & TAJS-3000

Truck Air Jack Stand



EVERY PERSON WHO OPERATES THIS EQUIPMENT NEEDS TO KNOW AND UNDERSTAND ALL OF THE INFORMATION IN THIS MANUAL—FAILURE TO DO SO COULD RESULT IN SERIOUS INJURY OR DEATH.

1. SAFETY INSTRUCTIONS

WARNING

Failure to follow all of these safety instructions can lead to severe injury or death from a sudden loss of the load. Contact the manufacturer using the contact information printed on the back cover of this manual if you have any questions.

- Before using this air jack stand, be sure you have read and understood all of the instructions and warnings on the on product labeling and in this owner's manual. See the section entitled "Owner and/or Operator Responsibilities" on page 3 of this manual for more information.
- Inspect the air jack stand before each use. The air jack stand must be removed from service if damage is detected or if the air jack stand is subjected to an abnormal shock or load. See page 7 of this manual for proper instructions for "Structural Inspection."
- Inspect the work area before each use. Make sure the air jack stand and vehicle are located on a hard, level surface capable of supporting the load. The air jack stand must remain in direct contact with the floor and the lift post saddle must be in direct contact with an appropriate lift point on the vehicle.
- Identify appropriate vehicle lift points before using the air jack stand. Lift only on areas of the vehicle specified by the vehicle manufacturer. The lift point must be strong enough to sustain the lifting force without damage to the vehicle.
- Make sure the lift point is securely cradled in the center (i.e., between the "saddle ears") of the lift post saddle— never lift a load with it resting on top of an saddle ear of the lift post saddle. Always use the factory-supplied lift post saddle to raise a load and never use blocks or cribbing devices in conjunction with this air jack stand (only adapters and/or attachments supplied by the manufacturer for this particular air jack stand can be used). Never place a hand or any other body part between lift post saddle and vehicle.
- Make sure the load does not exceed the rated capacity of the air jack stand. The maximum capacity of the TAJIS-2000 is 20,000 lbs/9,072 kg each. The maximum capacity of the TAJIS-3000 is 30,000 lbs/13,608 kg each.
-
- Do not exceed the maximum lift height. Never use more than one optional extension adapter with this air jack stand.
- After lifting the vehicle, never allow any part of your body to pass under it (and never begin work) until the ram of the jack is properly pinned and the air is exhausted. If the air is not exhausted and the jack is not properly pinned, the jack may rise or drop suddenly when a heavy object is removed from or placed on the vehicle, which could cause dangerous tilting or toppling of the vehicle.
- Always use the jack as intended. Never modify or alter the air jack stand. If this jack does not have sufficient capacity to lift a load, use a different jack with adequate capacity. Never attempt to reposition or rotate the jack or move, dolly, or drive the vehicle while it is raised. Never use this jack to lower or support a vehicle if the vehicle was raised using another lifting device or devices. Do not attempt to raise a partially-filled tanker or transport containing an unrestrained load as a sudden load shift could cause a dangerous tilting or toppling of the vehicle. Never throw the air jack stand or allow it to fall from an elevated position, such as from a truck bed.

READ THIS MANUAL CAREFULLY AND RETAIN FOR YOUR RECORDS

2. FOREWORD

Thank you for your purchase. With Gray products, you take part in a long history of product engineering for the transportation service industry. Company founder J.H. Gray applied for his first automotive jack patent in 1921, and since 1952 Gray has been producing the highest quality hydraulic and pneumatic equipment available for the professional service technician. Our purpose is to provide you with quality equipment that makes your job easier and with exemplary service after the sale. Please call Gray's customer service at 1-800-821-7320 or 816-233-6121 with any comments or questions.

3. SIGNAL WORDS

Signal words call attention to a safety message or messages, or a property damage message or messages, and designate a degree or level of hazard seriousness. Signal words used in this manual include:

- **DANGER:** Indicates a hazardous situation, which, if not avoided, will result in severe injury or death. This signal word is to be limited to the most extreme situations.
- **WARNING:** Indicates a hazardous situation, which, if not avoided, could result in severe injury or death.
- **CAUTION:** Indicates a hazardous situation, which, if not avoided, could result in minor or moderate injury. It may be used to alert against unsafe practices.
- **NOTICE:** Indicates a property damage message.

TABLE OF CONTENTS

1.	SAFETY INSTRUCTIONS.....	2
2.	FOREWORD	3
3.	SIGNAL WORDS.....	3
4.	RECEIVING INSPECTION.....	4
5.	OWNER AND/OR OPERATOR RESPONSIBILITIES.....	4
6.	SPECIFICATIONS.....	4
7.	COMPONENT IDENTIFICATION.....	5
8.	COMPRESSED AIR SUPPLY	6
9.	OPERATING INSTRUCTIONS	6
	9.1. Preparation Before Operation.....	6
	9.2. Identify a Lift Point on the Vehicle and Position the Air Jack Stand	7
	9.3. Raise the Vehicle	7
	9.4. Support the Vehicle.....	7
10.	MAINTENANCE INSTRUCTIONS	8
11.	INSPECTION INSTRUCTIONS	8
12.	TROUBLESHOOTING.....	9
13.	MAINTENANCE CHART	10

4. RECEIVING INSPECTION

Before attempting to operate this equipment, thoroughly read and understand this manual. Completely remove all tape and packaging. Inspect the equipment immediately upon delivery. If shipping damage is evident, inform the delivering carrier immediately and contact the manufacturer using the contact information on the back cover of this manual.

5. OWNER AND/OR OPERATOR RESPONSIBILITIES

The owner of this equipment must read these instructions and maintain them for future reference and for instructing any other users of the equipment. The owner is responsible for keeping all warning labels and instruction manuals legible and intact. Replacement labels and literature are available from the manufacturer. The owner must never authorize or allow anyone to use this equipment until the operator has read and understood the information in this manual and on the accompanying labeling on the equipment itself.

If this equipment is being used in an occupational setting (or workplace), the employer should ensure that all personnel working with and around the equipment know of the risks associated with its use. Personnel involved in the use and operation of this equipment shall be careful, competent, trained, and qualified in the safe operation of the equipment and its proper use when servicing motor vehicles and their components. Safety information provided with this equipment should be emphasized by the employer and understood by each employee. The employer must make this manual available to all personnel using this equipment and all personnel must read and understand the contents of this manual. If the operator is not fluent in English, the manufacturer's instructions and warnings shall be read to and discussed with the operator in the operator's native language by the employer, making sure that the operator comprehends its contents and observes the proper procedures for use of this equipment.

6. SPECIFICATIONS

	TAJS-2000		TAJS-3000	
	US Units	Metric	US Units	Metric
Capacity (at 150 psi)	15,000 lb each	6,804 kg each	20,000 lb each	9,072 kg each
Capacity (at 200 psi)	20,000 lb each	9,072 kg each	30,000 lb each	13,608 kg each
Maximum Lift Height	37.38 in	94.9 cm	38.25 in	97.2 cm
Maximum Lift Height with Optional Extension Adapter	52.38 in	133.0 cm	53.38 in	135.6 cm
Minimum Starting Height	17.88 in	45.4 cm	18.75 in	47.6 cm
Pin Increment Positions	2.50 in	6.4 cm	2.50 in	6.4 cm
Stroke	10 in	25.4 cm	10 in	25.4 cm
Width	15 in	38.1 cm	16.25 in	41.2 cm
Length	22 in	55.9 cm	23.75 in	60.3 cm
Weight	139 lb	63 kg	194 lb	88 kg

7. COMPONENT IDENTIFICATION

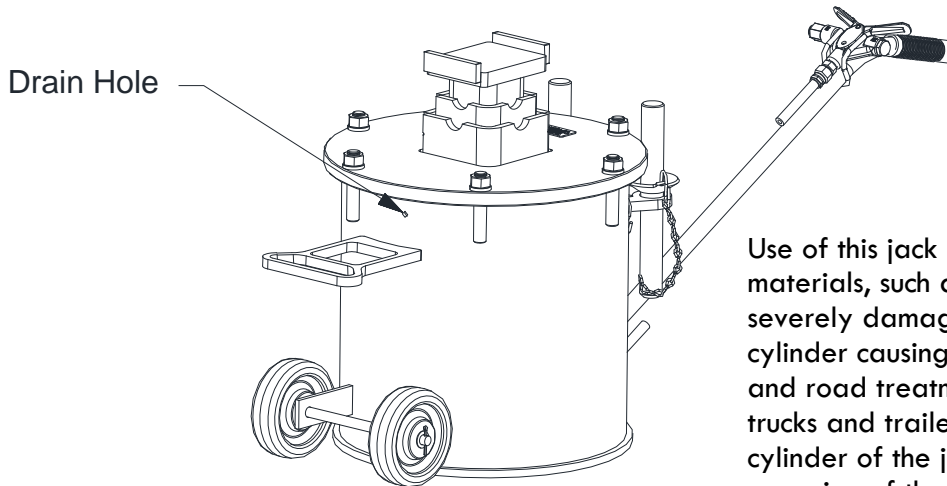
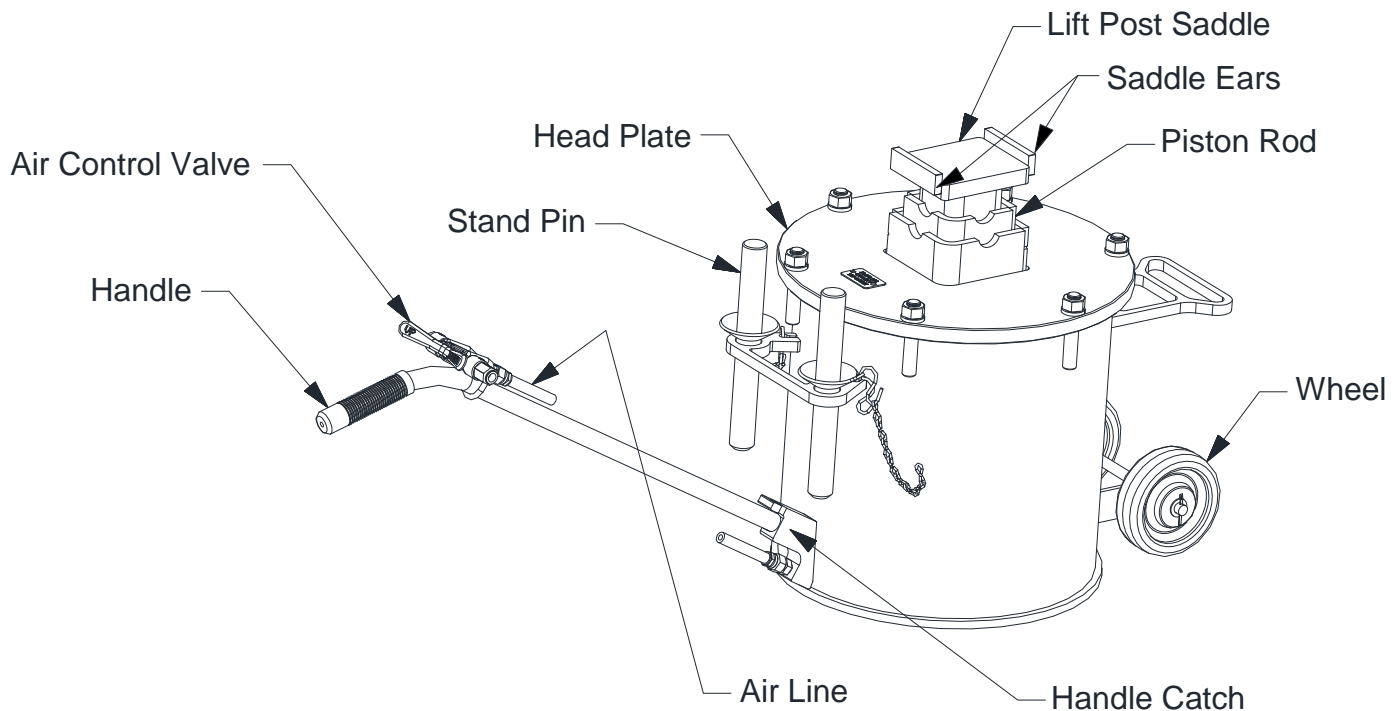

Use of this jack around corrosive materials, such as chlorides, will severely damage the inside of the cylinder causing air leakage. Water and road treatment residues from trucks and trailers may drain into the cylinder of the jack. This can cause corrosion of the jack's cylinder resulting in air leaks. Such use invalidates the warranty. If water or other fluids get into the cylinder, tilt the jack until they drain out of the drain hole (shown above-left).

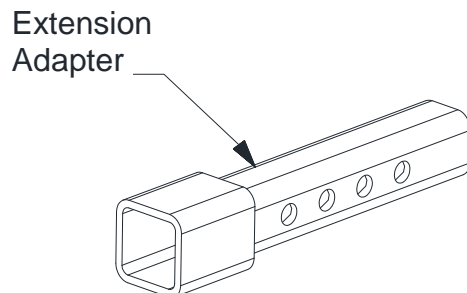

The Extension Adapter is available from the manufacturer as an accessory. Never use more than one Extension Adapter with each jack.

8. COMPRESSED AIR SUPPLY

The air jack stand requires a supply of compressed air to operate.

To Operate a Single Air Jack Stand

If the jack is being used as a single jack, the following steps need to be completed prior to use:

1. Connect a quick coupler to the air control valve.
2. Attach an air hose with 200 psi maximum to the quick coupler. The unit is now ready for use.
3. Actuate the air control valve lever and check that the lift post raises and lowers as expected.

To Operate a Pair of Air Jack Stands

Because these jacks are often used in pairs, operating the air control valves on both jacks simultaneously from one air line offers advantages. To utilize a single air line, assemble the air control valve from each jack according to the Figure below or contact the manufacturer to purchase a "Valve Tee Connection" kit (#8855-01009):

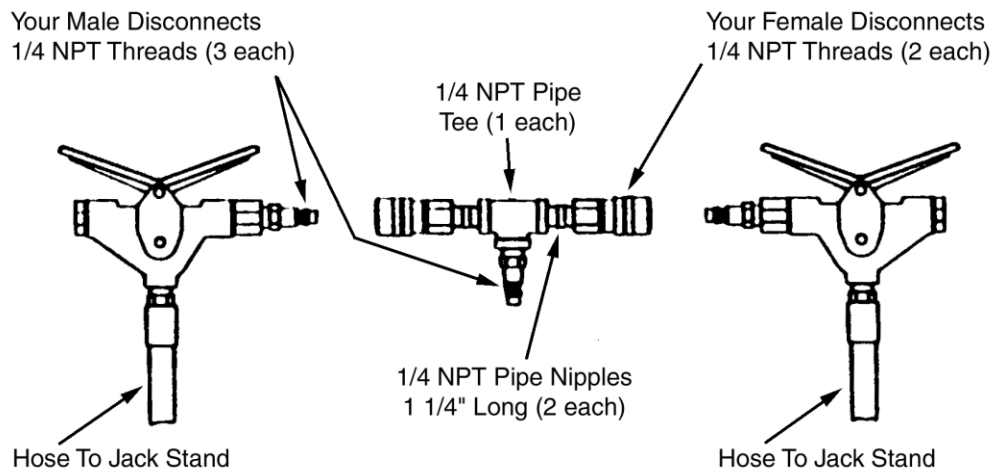

Use Pipe Thread Sealer On All Threads

9. OPERATING INSTRUCTIONS

⚠ WARNING

This section discusses the appropriate and safe methods for using the TAJIS-2000 or TAJIS-3000 air jack stands to raise, lower and/or support a vehicle. Safe operation includes adequate preparation *before* the vehicle is lifted. Failure to follow all of steps outlined in this section could result in serious injury or death.

9.1. Preparation Before Operation

1. Make sure the vehicle load does not exceed the rated capacity of the air jack stand (see SPECIFICATIONS on page 4).
2. Inspect the air jack stand for signs of wear or damage (see "INSPECTION INSTRUCTIONS" below). The jack should be immediately removed from service if you detect any abnormal conditions or signs of damage that suggest the jack will not work properly or safely— When in doubt, don't use the jack!

3. Transport the air jack stand to the work area by wheeling it. You can push or pull the jack.
4. Examine the work area. Use the jack only on hard, level surfaces capable of safely supporting the load. The jack must ALWAYS remain in direct contact with the floor. NEVER attempt to lift from a polished or greasy floor. Clear the surrounding area of personnel, tools, equipment, or any other objects that would interfere with the use of the jack.
5. Chock the vehicle's wheels. When raising a vehicle from one end, always chock the wheels that will remain on the ground. Make sure at least two wheels of the vehicle remain in contact with the floor at all times—NEVER use the jack to raise all four wheels of the vehicle from the floor. Verify that the vehicle's engine is not running before raising it.

9.2. Identify a Lift Point on the Vehicle and Position the Air Jack Stand

6. Identify a lift point on the vehicle that is capable of supporting the load. Lift only on areas of the vehicle specified by the vehicle manufacturer. The lift point must be strong enough to sustain the lifting force without damage to the vehicle.
7. If using only one stand to raise one end of the vehicle, make sure that the stand is balanced side-to-side. With one stand, it is extremely important to ensure the load is level and stable during and after lifting. Loads that are not balanced can result in tipping of the stand which can result in loss of the load, leading to personal injury, death, and/or property damage.
8. Position the unit(s) under the vehicle by using the handle and place according to the vehicle manufacturer's recommended lifting points.

9.3. Raise the Vehicle

9. Raise the lift post manually on each air jack stand to engage the manufacturer's recommended lift point. If using two jacks as a pair, keep both lift posts at equal heights. For each air jack stand being used, insert the stand pin in the nearest hole in the lift post so that the stand pin fully engages both sides of the piston rod. This position may not fully engage the lift point on the vehicle until the unit is pressurized to lift the load.
10. If the lift post is not fully engaged with the lift point, slowly apply air pressure until the lift post saddle engages the lift points on the vehicle. Before raising the vehicle, ensure that the lift post saddle is positioned such that the lift point is cradled and captured on both sides by the saddle ears on each side of the lift post. Never lift a load with it resting on top of an ear of the lift post saddle.
11. Apply air pressure to continue raising the vehicle. If using a pair of jacks, use the air control valves to keep the vehicle level while lifting. Once the proper height has been achieved, insert the other stand pin through the hole in the piston rod (for each air jack stand being used), such that the pins fully engage both sides of the head plate when lowered.

9.4. Support the Vehicle

12. Make sure the vehicle is stable. If using two units, make sure the vehicle is level. For each air jack stand being used, check that the stand pin is fully engaged with the notches on both sides of the head plate. Slowly release the air pressure to lower the vehicle so that it is supported by the stand pins (and not the air pressure from the jack). Fully discharge the air pressure from the jack stands.
13. Before beginning work or placing any part of your body under the vehicle, check one last time to ensure the vehicle is stable and level (between a pair of air jack stands or on a single air jack stand).
14. When work is completed, reverse the process described in this section to lower the vehicle.

10. MAINTENANCE INSTRUCTIONS

WARNING

All inspection and maintenance procedures must be performed *after* the jack has been removed from service. Failure to do this may result in personal injury and/or property damage.

The following procedures should be performed periodically to properly maintain the air jack stand:

- Check that all controls operate freely. Wheels should rotate freely.
- All warning and capacity labels should be readable and complete. Wash external surfaces of jack, labels, and decals with a mild soap solution. Do not allow water to run down the ram or the post and into the cylinder area. If water or any other liquid enters the cylinder, tilt the jack so the liquid can drain out the drain hole (shown in the COMPONENT IDENTIFICATION section on page 5).
- Lubricate all rotating and sliding portions of the jack monthly.

11. INSPECTION INSTRUCTIONS

WARNING

The jack must be inspected according to the requirements of this section. Failure to properly inspect the jack could lead to severe injury or death. The owner must inspect or appoint a knowledgeable person to inspect the jack for signs of corrosion, damage and/or excessive wear.

Visual inspection should be made before each use of the air jack stand, checking for abnormal conditions. Regular inspections should be made weekly for daily use or monthly for intermittent use. Any jack that appears to be damaged in any way, is found to be badly worn, or operates abnormally shall be removed from service until necessary repairs are made.

1. Inspect piston rod, lift post, and lift extension adapter regularly and replace if they are cracked, chipped, or show signs of excessive wear. Holes for the stand pins must not be elongated or deformed.
2. Inspect stand pins for deformities or excessive wear. Stand pins must be able to inset fully into the posts and piston rod in all positions.
3. The piston rod should extend and retract smoothly through its full range.
4. Inspect hoses for leaks or kinks. Inspect couplings for damage or air leakage. Replace damaged or defective hoses or couplings.

The jack must be removed from service and inspected immediately if it is subjected to an abnormal load or a shock load. If any irregularities or problems are detected during an inspection, the jack must be removed from service immediately and repaired. Contact the manufacturer using the contact information printed on the back cover of this manual. Remember, if you have *any* doubt about the safe condition of this air jack stand, **DON'T USE IT!**

12. TROUBLESHOOTING

WARNING

This section is a list of potential problems and solutions. If the solution listed fails to correct the problem, call customer service at the numbers and address printed on the back cover of this manual. Please have the model number and serial number of your jack available. The serial number is permanently stamped on the top of the head plate.

Problem	Cause/Solution
Fails to lift load	Inadequate air pressure. Increase air pressure but do not exceed 200 psi. Air leaks. Locate and correct leaks. Overloaded. Use larger capacity jack.
Fails to hold load	Stand pin not engaged.

13. MAINTENANCE CHART

[illegible]



GRAY MANUFACTURING COMPANY, INC.

3501 S. Leonard Road
St. Joseph, Missouri 64503

Customer Service Hotline: 800-821-7320

Fax: 816-233-7251

E-mail: gray@grayusa.com

Website: grayusa.com

Printed in U.S.A.

©2017 Gray Manufacturing Company, Inc.