

HI-RISE TRANSMISSION JACK HEAD ASSEMBLY

PARTS LIST

HTJ-800C SERIAL # 26-01 AND UP

HTJ-1000 SERIAL # 48-00 AND UP

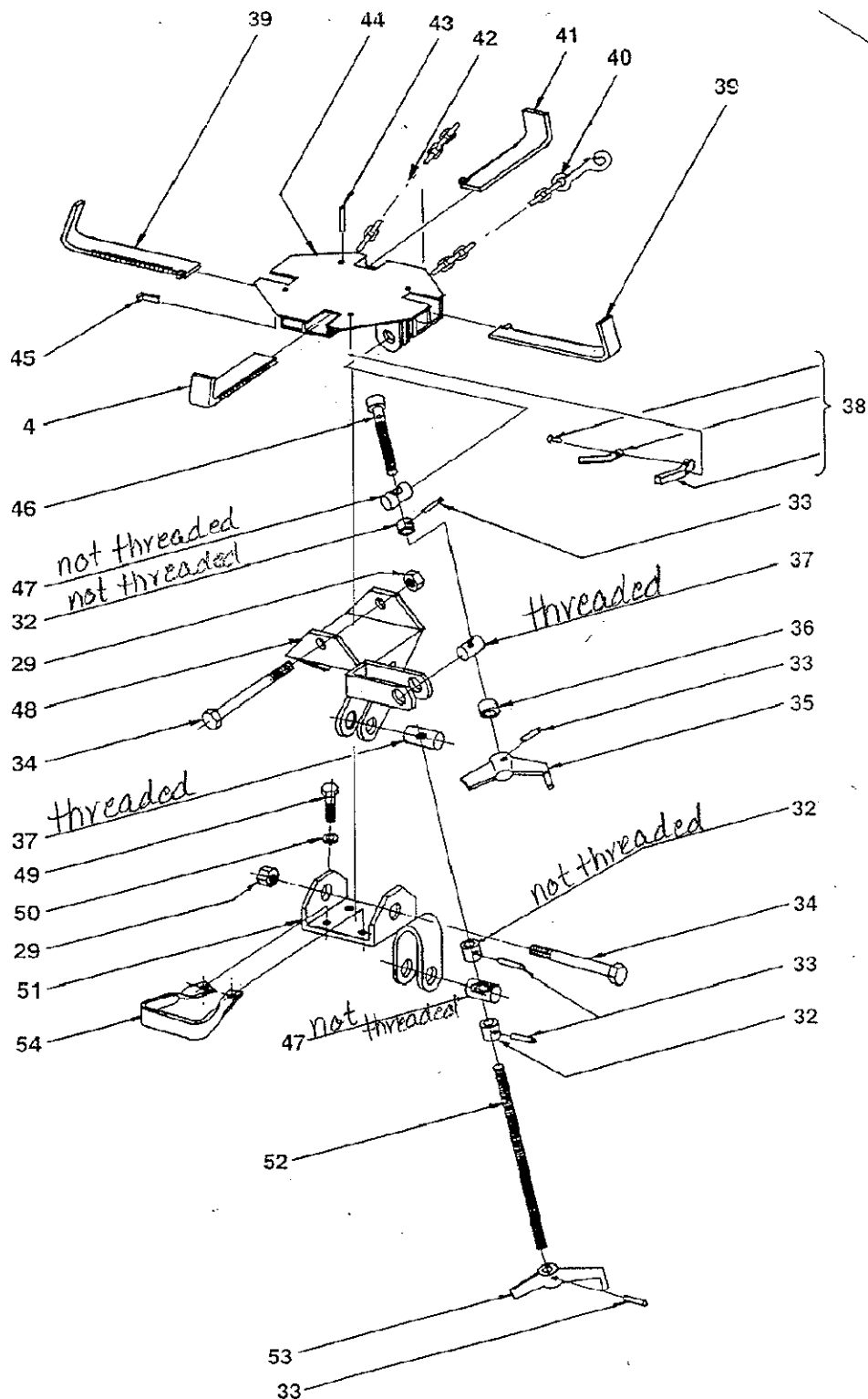

HI-RISE TRANSMISSION JACK HEAD ASSEMBLY

PARTS LIST

HTJ-800C SERIAL # 26-010000 & UP

HTJ-1000 SERIAL # 48-001000 & UP

Complete Head Assembly Part # 848-01003

ITEM	QTY	PART NUMBER	DESCRIPTION
4	1	826-04096	Removable Transmission Bracket
29	4	203-01403	Nut, 1/2-13, Self Locking
32	3	826-04085	Spacer, Drilled <i>not threaded</i>
33	5	235-21013	Roll Pin, 3/16 x 7/8
34	2	200-31421	Capscrew, Special
35	1	232-20075	Crank, Side Tilt
36	1	826-04090	Spacer (Not Drilled)
37	2	826-04078	Nut, Tilt <i>threaded</i>
38	4	825-01011	Ratchet Pawl Assembly
39	2	825-04098	Transmission Bracket, Long
40	1	826-01016	Chain & Snap assembly
41	1	825-04099	Transmission Bracket, Short
42	1	234-39014	Chain 1/0, 42 Links
43	4	235-21007	Roll Pin, 1/4 x 7/8
44	1	826-02017	Adapter Weldment
45	3	825-04100	Angle Stop
46	1	826-02019	Side Tilt Shaft
47	2	826-04079	Trunnion, Tilt <i>not threaded</i>
48	1	826-02016	Pivot Bracket
49	4	200-31206	Capscrew, 3/8 x 1
50	4	204-11201	Lock Washer, 3/8
51	1	826-02018	Hydraulic Unit Bracket
52	1	826-04093	Long Tilt Shaft
53	1	232-20015	Crank (Lower)
54	1	826-04113	Tow Handle
		848-01003	Complete head assembly
PRICES GOOD THRU DECEMBER 29, 2000			
ALL PRICES SUBJECT TO TAX AND FREIGHT			
			DNO1000