

# QUICK COUPLER CONNECTION

Install your quick coupler connection in the brass adapter. To prevent damage, hold adapter with wrench when tightening quick coupler. When using a quick coupler, the lift will not raise or lower until you actuate the valve lever.

After raising the lift, you may disconnect the air hose and lift will not lower until you again actuate the lever.

## VALVE DIAGRAM

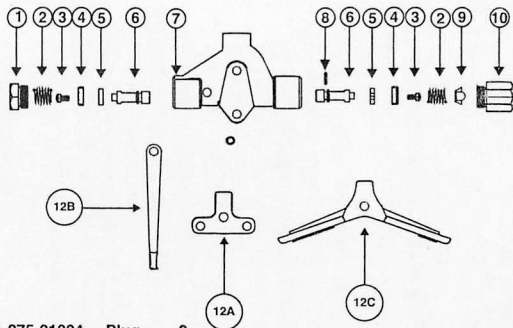

1	1-275-21004	Plug	2
2	1-233-12001	Spring	2
3	0-202-10601	Screw	2
4	1-312-91003	Cup	2
5	1-390-10006	Seal	2
6	1-312-91002	Spool	1
7	3-312-91009	Body	1
8	0-390-00005	O'Ring	1
9	1-312-91004	Screen	1
10	1-274-12001	Adapter	1
11	0-235-21009	Roll Pin	1
12	Note:2	Handle	1

### Notes:

- Complete valve Assembly With Handle:  
2-312-01005  
2-312-01006  
2-312-01007

### 2. Handle Part Numbers:

12A	1-232-20053
12B	1-232-20034
12C	2-232-20063