



IMPORTANT: TO AVOID ANY DANGER OR PERSONAL HARM THE CUSTOMER MUST SPECIFY WHICH FLUID HAS BEEN USED WITH THIS PUMP BEFORE SERVICE CAN BE OBTAINED.

TO PROTECT YOUR WARRANTY, FOLLOW THE INSTRUCTIONS AND ONLY USE FLUIDS RECOMMENDED BY ENERPAC.

See Note 1

See Note 2

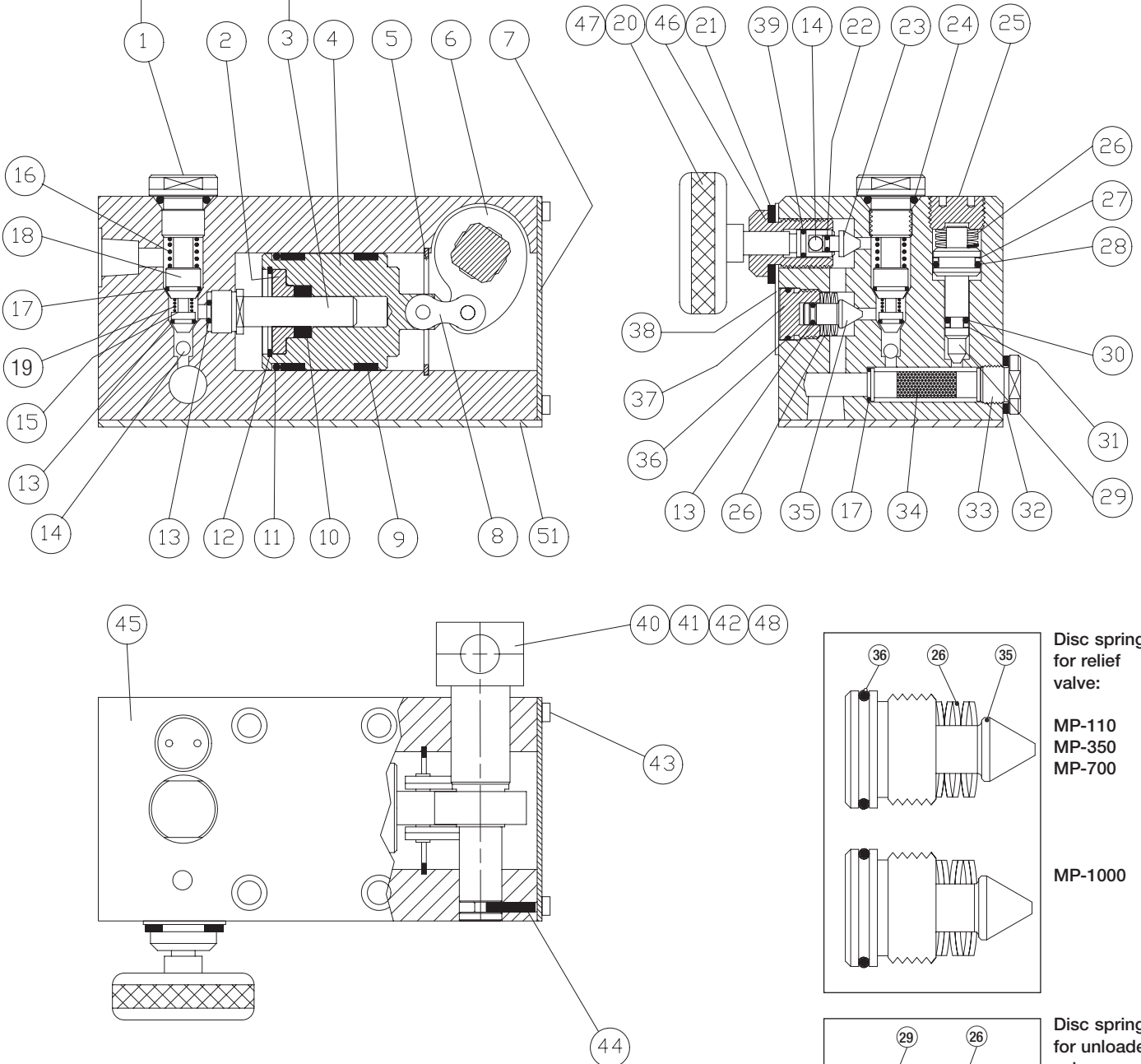

NOTE 1:
Torque item nr. 1 with
95-100 Nm [70-73 Ft.lbs]

NOTE 2:
Torque item nr. 3 with
40-45 Nm [30-33 Ft.lbs]

Disc springs
for relief
valve:

MP-110
MP-350
MP-700

MP-1000

Disc springs
for unloader
valve

Item Nr.	Partnumber	Description	Quantity MP-110	Quantity MP-350	Quantity MP-700	Quantity MP-1000
❖ 1	SY273006	Pressure Plug	1x	1x	1x	1x
2	SY817020	Seal Gland MP-350	–	1x	–	–
2	DQ1692020	Seal Gland MP-700	–	–	1x	–
2	DQ1682020	Seal Gland MP-1000	–	–	–	1x
3	SY808040	HP Plunger MP-110	1x	–	–	–
3	SY810040	HP Plunger MP-350	–	1x	–	–
3	DQ1677040	HP Plunger MP-700	–	–	1x	–
3	DQ1680040	HP Plunger MP-1000	–	–	–	1x
4	DQ1684040	LP Plunger MP-110	1x	–	–	–
4	DQ1685040	LP Plunger MP-350	–	1x	–	–
4	DQ1678040	LP Plunger MP-700	–	–	1x	–
4	DQ1681040	LP Plunger MP-1000	–	–	–	1x
5*	SY283044	Int. Circlip M50	1x	1x	1x	1x
6	SY834157	Tumbler	1x	1x	1x	1x
7	DQ1703126	Name Plate	1x	1x	1x	1x
8	SY833061	Chain Plate	2x	2x	2x	2x
8	SY835062	Chain Connect Link	1x	1x	1x	1x
9*	DQ1689155	Slydring	2x	2x	2x	2x
10*	SY284041	High Pressure Seal	1x	1x	–	–
10*	DQ1687041	High Pressure Seal	–	–	1x	–
10*	DQ1688041	High Pressure Seal	–	–	–	1x
11*	DQ1704503	O-Ring	1x	1x	1x	1x
12*	SY282044	Int. Circlip M36	–	1x	1x	1x
❖ 13*	SY271903	O-Ring	3x	3x	3x	3x
* 14*	SY278016	1/4"Ball	2x	2x	2x	2x
❖ 15	SY271274	Mid Delivery Cone	1x	1x	1x	1x
❖ 16*	SY830110	Spring	1x	1x	1x	1x
❖ 17*	SY829903	O-Ring	2x	2x	2x	2x
❖ 18	SY272274	Top Delivery Cone	1x	1x	1x	1x
❖ 19*	SY831110	Mid Delivery Spring	1x	1x	1x	1x
20	see nr. 47	Release knob ass'y	–	–	–	–
* 21*	SY276041	Sealing washer 1/2"	1x	1x	1x	1x

Item Nr.	Partnumber	Description	Quantity MP-110	Quantity MP-350	Quantity MP-700	Quantity MP-1000
* 22*	SY274903	O-Ring	1x	1x	1x	1x
* 23	SY826274	Release Valve Cone	1x	1x	1x	1x
24*	SY822006	O-Ring	1x	1x	1x	1x
♦ 25	SY823006	Unloader Valve Plug	1x	1x	1x	1x
♦+ 26	SY109010	Disc spring	11x	11x	11x	12x
♦ 27*	SY855564	Back Up Washer	1x	1x	1x	1x
♦ 28*	SY852903	O-Ring	1x	1x	1x	1x
♦ 29	SY825010	Unloader Spindle	1x	1x	1x	1x
♦ 30*	SY853903	O-Ring	1x	1x	1x	1x
♦ 31*	SY856569	Back Up Washer	1x	1x	1x	1x
32*	SY278041	Sealing washer 3/8"	1x	1x	1x	1x
33	SY828006	Filter Plug	1x	1x	1x	1x
34	SY829018	Filter Assembly	1x	1x	1x	1x
+ 35	SY827274	Relief Valve Cone	1x	1x	1x	1x
+ 36*	SY277903	O-Ring	1x	1x	1x	1x
+ 37	SY824006	Relief Valve Plug	1x	1x	1x	1x
38	SY838101	Cover Plate	1x	1x	1x	1x
* 39*	SY832903	O-Ring	1x	1x	1x	1x
★ 40	DQ1686011	Washer	1x	1x	1x	1x
★ 41	DQ1699120	Nut	1x	1x	1x	1x
42	DQ1676104	Tumbler Shaft	1x	1x	1x	1x
43	SY413028	Screw	4x	4x	4x	4x
44	DQ1690061	Dowel Pin	1x	1x	1x	1x
45	DQ1700900	Pump Body ass'y (45+49)	1x	1x	1x	1x
* 46	SY821044	Release Valve Gland	1x	1x	1x	1x
* 47	DQ1701900	Release Valve Spindle	1x	1x	1x	1x
★ 48	DQ1675070	Handle Tube	1x	1x	1x	1x
49	see nr. 45	Relief Valve Seat	–	–	–	–
50	SY850006	Plug	3x	3x	3x	3x
51*	SY290001	Gasket	1x	1x	1x	1x
Repair Kit.		Contains parts marked with *	MP-110350K3	MP-110350K3	MP-700K2	MP-1000K2

Key to repair parts kits:

- ❖ Included in DD1798900 check assembly repair kit.
- * Included in DD1795900 release valve repair kit.
- ★ Included in DD1796900 handle assembly repair kit.

- ♦ Included in DD1797900 unloader assembly repair kit.
- + Included in DD1799900 relief valve repair kit.



IMPORTANT: To avoid any danger or personal harm the customer must specify which fluid has been used with this pump before service can be obtained.

TO PROTECT YOUR WARRANTY, FOLLOW THE INSTRUCTIONS AND ONLY USE FLUIDS RECOMMENDED BY ENERPAC.

MULTI FLUID PUMP SERVICE INSTRUCTIONS

1. FAULT DIAGNOSES

Before stripping the pump try to establish where the fault lies within the unit. There are a few basic checks which can help to determine the faulty area as listed below:

- **The pump loses pressure and the pump handle rises.**
This is caused by fluid from the system passing the pump outlet check cone (item 18) and pressurising the high pressure plunger chamber, this in turn forces the plunger backwards thus raising the handle. Check for damage to the top check valve seat, cone and O-ring seal (item 18).
- **The pump loses pressure but the handle does not rise.**
There are two areas which can cause this problem apart from an external leak on a pump sealing plug, they are:
 1. The release valve is faulty, check the seat and cone for damage, if the seat is damaged a replacement seat kit is available.
 2. If the seat and cone appear to be in good condition check the condition of the unloader assembly especially the plunger bore and seals.

- **Pump performance becomes erratic once the unloader setting has been reached (35 bar / 508 psi).**
This is normally caused by a fault on the middle seat / cone (item 15) assembly. Check the seat, cone and O-ring seal allowing fluid from the high pressure pump plunger to flow back to the reservoir via the unloader piston once the unloader has opened.
- **The pump fails to make full pressure.**
Normally this is caused by a fault within the relief valve assembly, try adjusting the relief valve. It may have become loose or been tampered with, if this fails strip and inspect the seat and cone for damage.

2. PUMP STRIPPING INSTRUCTIONS

Before stripping the pump ensure the pump plunger is fully forward. This will ensure the plunger cavities are empty before plunger removal.

Pump Plunger Assembly

1. Remove the 4 screws securing the pump identification plate to the rear of the pump (item 7) and remove the plate being careful not to loosen the tumbler shaft retaining pin (item 44). When the plate is removed turn the pump assembly vertically with the pump outlet port upwards this should allow the tumbler shaft retaining pin to drop out, some assistance may be required so either tap the body or move the tumbler shaft.
2. Before removing the tumbler shaft (item 42) rotate the shaft to move the pump plunger to its mid-position, now remove the tumbler shaft.

3. The tumbler (item 6) will now drop clear and allow access to the low pressure plunger retainer clip (item 5), this can now be removed with internal circlip pliers. With the circlip removed ease the plunger assembly out of the pump body.
4. Remove the tumbler link assembly (item 8) and check for wear on the pins and holes. The high pressure seal (item 10) is held in position by an internal circlip (item 12) and seal gland (item 2) once both are out the seal can be removed.
5. With the low pressure plunger removed access is now available to the high pressure plunger (item 3) a special service tool is required to remove this item contact Enerpac Technical Department for details. Using the service tool unscrew the plunger (counterclockwise).

Unloader Assembly

1. Unscrew the unloader adjusting plug (item 25), invert pump to allow the unloader spring washers to drop out.
2. With a pair of pliers gently pull the unloader plunger out (item 29) using a turning motion to help overcome seal friction.
3. Remove the O-rings and back-up washers taking care not to damage the seal grooves with sharp tools i.e. screw driver blades.

Check Valve Assembly

1. Unscrew the check valve plug (item 1), once removed this gives access to both check valve cones and cone springs and the suction ball, invert pump to allow all items to drop out.

Release Valve Assembly

1. Unscrew the release valve gland nut located behind the release valve hand wheel and remove the complete release valve assembly.
Note: The release valve knob, spindle and gland are non serviceable, if any of the components are damaged the whole assembly must be replaced.
2. Remove the cone (item 23) and ball (item 14) the O-ring on the cone is not intended as a seal it's function is to secure the cone in the spindle.

Relief Valve Assembly

1. The relief valve is located under the cover plate (item 38) this plate will have been removed whilst removing the release valve assembly. Unscrew the adjusting plug (item 37), when removed the relief valve cone (item 35) and spring washers (items 26) should be attached.
2. Pull the relief valve cone out of the adjusting plug the O-ring on the cone is not intended as a seal it's function is to secure the cone in the plug.
3. Remove the O-ring's (item 36) from the adjusting plug and (item 13) from the cone.

Filter Assembly

1. Unscrew the filter plug (item 33) this will allow access to the filter (item 34), invert the pump to allow the filter to drop out, O-ring (item 17) should also be removed.

Additional Notes

- The pump body has 3 threaded plugs (1/8" NPT) inserted during manufacture these should not be removed during servicing unless a leak is detected. If this is the case remove and apply a suitable thread tape and refit.

3. ASSEMBLY PROCEDURE

Before re-assembly clean and inspect all components for visual wear or damage, paying particular attention to the main low pressure plunger bore of the pump body and all valve seats.

Unloader Valve Assembly

1. Assemble O-rings and back-up seals (items 27, 28, 30, 31) to the unloader piston (item 29) back-up washers fit on outside of both O-rings.
2. Lubricate piston assembly and insert into pump body.
3. Fit spring washers (items 26), see parts sheet for correct spring assembly.
4. Insert threaded plug (item 25), screw in until plug reaches spring assembly.

Relief Valve Assembly

1. Fit spring washers (items 26) onto relief valve cone (item 35), see parts sheet for correct spring assembly and fit O-ring (item 13) onto cone.

2. Fit O-ring (item 36) onto relief valve adjusting screw (item 37) and insert cone assembly into relief valve adjusting screw.
3. Screw complete assembly into pump body until plug begins to tighten onto springs, once this occurs turn adjuster one complete revolution (final setting will be made during relief valve setting procedure).

Release Valve Assembly

1. Fit bonded washer (item 21) onto the release valve gland nut.
2. Fit O-ring (item 22) to release valve cone (item 23).
3. Insert ball (item 14) and cone assembly into release valve spindle (do not apply any lubricant to this area).
4. Fit release valve nameplate (item 38) onto release valve gland nut and screw assembly into pump body, ensure release valve spindle remains free during tightening by rotating the release valve knob. Position nameplate to allow access to relief valve adjusting screw.

Filter Assembly

1. Insert O-ring (item 17) into pump body filter hole ensuring O-ring sits correctly at the bottom of the hole.
2. Insert clean filter (item 34) into pump body.
3. Fit bonded washer (item 32) to filter plug (item 33), screw plug into pump body and tighten.

Check Valve Assembly

Note: Middle valve seat cone and spring (items 17, 18) will not be installed at this stage.

1. Drop suction ball (item 14) into pump body check valve hole.
2. Fit new O-ring (item 17) to top valve seat cone (item 18) and drop assembly into pump body.
3. Fit check valve spring (item 19) onto top valve seat cone stem.
4. Fit O-ring (item 24) onto check valve plug (item 1), screw plug into pump body and tighten.

Plunger Assembly

1. Assemble tumbler linkage (items 8, 6) to low pressure piston (item 4) lubricating with a lithium based grease.
2. Fit both plastic bearings (items 9) to low pressure plunger and install O-ring (item 11) to front bearing groove.
3. Install high pressure seal (item 10) into low pressure plunger ensuring seal is the correct way round (widest seal lip faces inwards).
4. Fit high pressure seal gland (item 2) into low pressure plunger and install circlip (item 12) ensuring clip engages correctly into groove.
5. Fit O-ring (item 13) into the counter bore at the threaded end of the high pressure plunger (item 3).
6. Carefully screw high pressure plunger into the pump body using the appropriate special tool and tighten.
7. Lubricate the low pressure plunger assembly with a suitable lubricant (the lubricant must be compatible with the seals and fluid to be used with the pump after assembly), carefully push the plunger assembly into the pump body, it may be necessary to gently hammer the plunger into the bore using a suitable drift (tumbler rocker must be positioned the correct way round). Insert plunger far enough to allow both the rocker to engage into the pump body tumbler shaft cavity and the low pressure plunger circlip to be inserted.
8. Insert the low pressure circlip (item 5) ensure correct engagement in groove.
9. Lubricate the tumbler shaft (item 42) with a Lithium based grease and insert shaft into body aligning the rocker as the shaft is inserted, with the shaft inserted drop the shaft retaining pin (item 44) into the pump body and fit rear cover plate (item 7).

Note: The 110 bar pump unit (MP-110) has a different high pressure seal arrangement, the seal fits onto the high pressure plunger and not into the low pressure plunger as with all other units.

Unloader Valve Setup Procedure

Fit the suction tube into the suction hole of the pump body and install the pump onto it's reservoir which should be clean a filled with a suitable fluid. Fit a 0-100 bar gauge (0-1450 psi), hose and cylinder to the pump outlet port.

1. With the release valve open, pump the operating lever 6 complete strokes to prime the pump and expel all internal air.
2. Close the release valve and operate the pump handle, pressure may start to rise on the gauge, if no pressure is created tighten the unloader valve adjusting screw (item 25) by a 1/4 of a revolution then re-operate the pump handle. Continue this procedure until

the pressure gauge reaches 35 bar \pm 5 bar (508 psi \pm 72 psi) and continuous pumping will not allow gauge to rise above the set pressure.

Note: If the adjuster plug reaches the end of it's travel before 35 bar is achieved the pump has a fault, check unit for correct assembly.

Setting Main Relief Valve

Before the relief valve can be set the middle check valve cone must be installed as below:

1. Remove the check valve plug, top check valve cone and spring.
2. Fit O-ring (item 13) to middle check valve cone (item 15) and drop cone into pump, carefully fit the middle check valve spring (item 16) onto the cone stem.

3. Replace the top check valve cone, spring and check valve plug.

Note: Replace the 0-100 bar gauge with a suitable pressure gauge depending on the pump maximum pressure setting.

Setting The Relief Valve

1. With the release valve open, pump the operating lever 6 complete strokes to prime the pump and expel all internal air.
2. Close the release valve and operate the pump handle pressure will rise on the gauge to increase the pressure setting tighten the relief valve adjusting screw (item 37), the adjustment is very sensitive so only turn a few degrees at a time. If the pressure raises too high release the pressure and back-off the adjusting screw, then try again.
3. When the correct pressure is achieved release the pressure, loosen the release valve gland nut, rotate the relief valve cover plate into position and re-tighten the release valve gland nut.

Enerpac Worldwide Locations

✦ e-mail: info@enerpac.com

✦ internet: www.enerpac.com

Australia and New Zealand

Actuant Australia Ltd.
Block V Unit 3
Regents Park Estate
391 Park Road
Regents Park NSW 2143
(P.O. Box 261) Australia
T +61 (0)2 9743 8988
F +61 (0)2 9743 8648
sales-au@enerpac.com

Brazil

Power Packer do Brasil Ltda.
Rua Luiz Lawrie Reid, 548
09930-760 - Diadema (SP) - Brazil
T +55 11 5525 2311
Toll Free: 0800 891 5770
vendasbrasil@enerpac.com

China

Actuant (China) Industries Co. Ltd.
No.6 Nanjing East Road,
Taicang Economic Dep Zone
Jiangsu, China
T +86 0512 5328 7500
F +86 0512 5335 9690
Toll Free: +86 400 885 0369
sales-cn@enerpac.com

France, Switzerland, North Africa and French speaking African countries

ENERPAC
Une division d'ACTUANT France S.A.
ZA de Courtaboeuf
32, avenue de la Baltique
91140 VILLEBON /YVETTE
France
T +33 1 60 13 68 68
F +33 1 69 20 37 50
sales-fr@enerpac.com

Germany and Austria

ENERPAC GmbH
P.O. Box 300113
D-40401 Düsseldorf
Willstätterstrasse 13
D-40549 Düsseldorf, Germany
T +49 211 471 490
F +49 211 471 49 28
sales-de@enerpac.com

India

ENERPAC Hydraulics Pvt. Ltd.
No. 1A, Peenya Industrial Area
IInd Phase, Bangalore, 560 058, India
T +91 80 40 792 777
F +91 80 40 792 792
sales-in@enerpac.com

Italy

ENERPAC S.p.A.
Via Canova 4
20094 Corsico (Milano)
T +39 02 4861 111
F +39 02 4860 1288
sales-it@enerpac.com

Japan

Applied Power Japan LTD KK
Besshocho 85-7
Kita-ku, Saitama-shi 331-0821, Japan
T +81 48 662 4911
F +81 48 662 4955
sales-jp@enerpac.com

Middle East, Egypt and Libya

ENERPAC Middle East FZE
Office 423, LOB 15
P.O. Box 18004, Jebel Ali, Dubai
United Arab Emirates
T +971 (0)4 8872686
F +971 (0)4 8872687
sales-ua@enerpac.com

Russia

Rep. office Enerpac
Russian Federation
Admiral Makarova Street 8
125212 Moscow, Russia
T +7 495 98090 91
F +7 495 98090 92
sales-ru@enerpac.com

Southeast Asia, Hong Kong and Taiwan

Actuant Asia Pte Ltd.
83 Joo Koon Circle
Singapore 629109
T +65 68 63 0611
F +65 64 84 5669
Toll Free: +1800 363 7722
sales-sg@enerpac.com

South Korea

Actuant Korea Ltd.
3Ba 717, Shihwa Industrial Complex
Jungwang-Dong, Shihung-Shi,
Kyunggi-Do
Republic of Korea 429-450
T +82 31 434 4506
F +82 31 434 4507
sales-kr@enerpac.com

Spain and Portugal

ENERPAC SPAIN, S.L.
Avda. Los Frailes, 40 - Nave C & D
Pol. Ind. Los Frailes
28814 Daganzo de Arriba
(Madrid) Spain
T +34 91 884 86 06
F +34 91 884 86 11
sales-es@enerpac.com

Sweden, Denmark, Norway, Finland and Iceland

Enerpac Scandinavia AB
Fabriksgatan 7
412 50 Gothenburg
Sweden
T +46 (0) 31 799 0281
F +46 (0) 31 799 0010
scandinavianinquiries@enerpac.com

The Netherlands, Belgium, Luxembourg, Central and Eastern Europe, Baltic States, Greece, Turkey and CIS countries

ENERPAC B.V.
Galvanistraat 115
6716 AE Ede
P.O. Box 8097
6710 AB Ede
The Netherlands
T +31 318 535 911
F +31 318 535 848
sales-nl@enerpac.com

Enerpac Integrated Solutions B.V.

Opaalstraat 44
7554 TS Hengelo
P.O. Box 421
7550 AK Hengelo
The Netherlands
T +31 74 242 20 45
F +31 74 243 03 38
integratedsolutions@enerpac.com

South Africa and other English speaking African countries

Enerpac Africa Pty Ltd.
No. 5 Bauhinia Avenue
Cambridge Office Park
Block E
Highveld Techno Park
Centurion 0157
South Africa
T: +27 12 940 0656

United Kingdom and Ireland

ENERPAC UK Ltd.
5 Coopies Field
Morpeth, Northumberland
NE61 6JR, England
T +44 (0)121 50 50 787
F +44 (0)121 50 50 799
sales-uk@enerpac.com

USA, Latin America and Caribbean

ENERPAC
P.O. Box 3241
Milwaukee WI 53201 USA
T +1 262 293 1600
F +1 262 293 7036
User inquiries:
T +1 800 433 2766
Distributor inquiries/orders:
T +1 800 558 0530
F +1 800 628 0490
Technical inquiries:
techservices@enerpac.com
sales-us@enerpac.com

All Enerpac products are guaranteed against defects in workmanship and materials for as long as you own them.

For the location of your nearest authorized Enerpac Service Center, visit us at www.enerpac.com

061014

ENERPAC

RPS63110-1 MPmultifluid
Mac, Printed in Holland