

PTJ5002 0.5 Ton Transmission Jack

Model PTJ5002 transmission jack is a mobile lifting device having a lift platform assembly suited to retaining an automotive transmission, and other driveline components such as transfer cases and trans-axes, and is designed to support and stabilize the component during its installation or removal from a vehicle.

SPECIFICATIONS

Power Lifting Range:	850-1860mm
Ram Travel:	Total Travel: 1010mm Second Stage: 480mm First Stage: 530mm
Adjustable Support	Horizontal: ± 27.5 mm
Adjusting Scope:	Vertical Action: -7.5° $\sim +17.5^{\circ}$
Base Size:	890 mm x 810 mm
Shipping Weight:	191 Lbs.

WARNING

THE USE OF THIS JACK IS LIMITED TO THE REMOVAL, INSTALLATION, AND TRANSPORTATION IN THE LOWERED POSITION, OF TRANSMISSIONS AND DIFFERENTIALS. IT MAY BE USED WITH APPROPRIATE ADAPTERS MANUFACTURED SPECIFICALLY FOR THE JACK TO HANDLE OTHER COMPONENTS, SUCH AS REAR AXLE UNITS AND TRANSFER CASES, WITHIN THE WEIGHT LIMITATIONS SPECIFIED. NO ALTERATION TO THE JACK OR ADAPTERS SHALL BE MADE.

BE SURE THE VEHICLE IS APPROPRIATELY SUPPORTED BEFORE STARTING REPAIRS.

DO NOT OVERLOAD. OVERLOADING CAN CAUSE DAMAGE TO OR FAILURE OF THE JACK.

ONLY ATTACHMENTS AND/OR ADAPTERS SUPPLIED BY THE MANUFACTURER SHALL BE USED.

THIS JACK IS DESIGNED FOR USE ONLY ON HARD LEVEL SURFACES CAPABLE OF SUSTAINING THE LOAD. USE ON OTHER THAN HARD LEVEL SURFACES CAN RESULT IN JACK INSTABILITY AND POSSIBLE LOSS OF LOAD.

READ, STUDY AND UNDERSTAND THE OPERATING MANUAL PACKED WITH THIS JACK BEFORE OPERATING.

FAILURE TO HEED THESE WARNINGS MAY RESULT IN LOSS OF LOAD, DAMAGE TO JACK, AND/OR FAILURE RESULTING IN PROPERTY DAMAGE, PERSONAL OR FATAL INJURY.

Assembly Instructions:

1. Before using jack for the first time, some assembly is required. Place hydraulic unit in upright position and bolt legs to base using (4) 1/2" x 1" HHCS and (4) 1/2" internal tooth lock washers.
2. Assemble casters to legs using (16) 5/16" x 3/4" hex bolts and (16) 5/16" nyloc locknuts.
3. Attach fingers to saddle using (2) 7/16" x 1-1/4" bolts, (2) 7/16" washers and (2) 7/16" hex nuts.

Inspection:

Visual inspection should be made before each use of the transmission jack, checking for leaking hydraulic fluid and damaged, loose or missing parts. Each jack must be inspected by a manufacturer's repair facility immediately, if accidentally subjected to an abnormal load or shock. Any jack which appears to be damaged in any way, is found to be badly worn, or operates abnormally **MUST BE REMOVED FROM SERVICE** until necessary repairs are made by a manufacturer's authorized repair facility. It is recommended that an annual inspection of the jack be made by a manufacturer's authorized repair facility and that any defective parts, decals or warning labels be replaced with manufacturer's specified parts. A list of authorized repair facilities is available from the manufacturer.

Important! Before Use . . .

Open reservoir vent screw 2 full turns to vent. Check to see if oil level is up to the filler hole. Fill if necessary with clean hydraulic jack oil. **NOTE:** jack will not operate properly unless vented and filled with oil. Sometimes during shipment and handling air gets into the hydraulic system, causing poor lifting performance.

Bleeding the pump: With the release lever down, pump pedal several times to force excess air from the piston area. It should then be possible to raise the ram with normal foot pedal action.

Bleeding the ram: With the ram in the low position remove the hex socket set screw from the top of ram, pump the foot pedal until fluid comes out. Replace the hex socket set screw. The jack will then be ready for use.

Operating Instructions:

1. **Lifting:** Pump pedal to raise saddle to contact load. Position jack so weight of load will be equally distributed on saddle, and adjust pitch and tilt controls as necessary. Position corner support brackets and secure load with load restraint chain. **Warning:** Always use the load restraint chain, corner support brackets, and attachment to stabilize and firmly secure the load to the saddle. The chain should be used as follows: Place the chain over the load, pull tight and place into slot on opposite side of saddle. Tighten wing nut.
2. **Lowering:** To lower jack - step down on release lever slowly.
3. **Saddle Controls**
Tilt Control: The side tilt knob tilts saddle -7.5° ~+17.5°
Horizontal: The Horizontal knob moves saddle ±27.5mm

Maintenance Instructions:

1. Regularly lubricate all moving parts, paying close attention to the tilt screws and related linkages.
2. Regularly check the oil level in ram. With the saddle in the lowest position, the oil level should be up to the filler screw hole. Use SAE 30 hydraulic jack oil, do not use hydraulic brake fluid.
3. If jack fails to operate - check oil level and/or bleed air from unit.

Owner/User Responsibility:

The owner and/or user must have an understanding of the manufacturer's operating instructions and warnings before using the transmission jack. Personnel involved in the use and operation of equipment shall be careful, competent, trained, and qualified in the safe operation of the equipment and its proper use when servicing motor vehicles and their components. Warning information should be emphasized and understood. If the operator is not fluent in English, the manufacturer's instructions and warnings shall be read to and discussed with the operator in the operator's native language by the purchaser/owner, making sure that the operator comprehends its contents.

Owner and/or user must study and maintain for future reference the manufacturer's instructions and pertinent warning information. Owner and/or user is responsible for keeping all warning labels and instruction manuals legible and intact. Replacement labels and literature are available from the manufacturer.

PARTS DIAGRAM

PLEASE READ THE FOLLOWING CAREFULLY

The manufacturer and/or distributor has provided the parts diagram in this manual as a reference tool only. Neither the manufacturer nor the distributor makes any representation or warranty of any kind to the buyer that he or she is qualified to make any repairs to the product or that he or she is qualified to replace any parts of the product. In fact, the manufacturer and/or distributor expressly states that all repairs and part replacements should be undertaken by certified and licensed technicians and not by the buyer. The buyer assumes all risk and liability arising out of his or her repairs to the original product or replacement parts thereto, or arising out of his or her installation of replacement parts thereto.

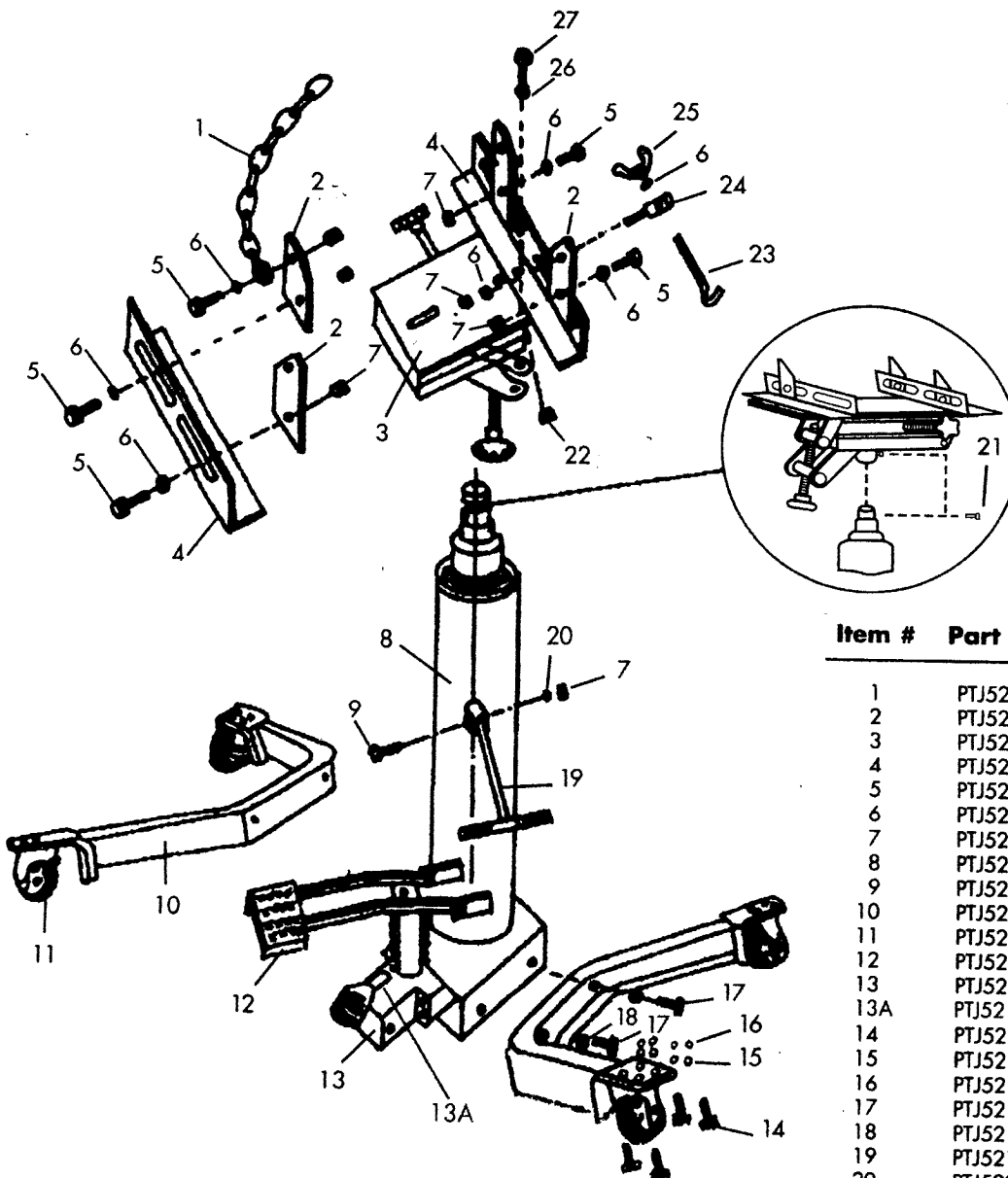

Item #	Part No.	Description	Qty.
1	PTJ5201	Chain	1
2	PTJ5202	Adjusting Bar	4
3	PTJ5203	Saddle Base	1
4	PTJ5204	Angle Bar	2
5	PTJ5205	Bolt / m8x25	5
6	PTJ5206	Washer 8	7
7	PTJ5207	Nut / m8	7
8	PTJ5208	Jack	1
9	PTJ5209	Screw / m8x45	1
10	PTJ5210	Frame	2
11	PTJ5211	3" Swivel Caster	4
12	PTJ5212	Pedal	1
13	PTJ5213	Base	1
13A	PTJ5213A	Release Valve Assembly	1
14	PTJ5214	Screw / m8x20	16
15	PTJ5215	Washer 8	16
16	PTJ5216	Locking Nut / m8	16
17	PTJ5217	Bolt / m12x25	4
18	PTJ5218	Spring Washer 12	4
19	PTJ5219	Handle	1
20	PTJ5220	Spring Washer	1
21	PTJ5221	Bolt / m10x20	1
22	PTJ5222	Nut / m12	2
23	PTJ5223	Chain Lock	1
24	PTJ5224	Shaft	1
25	PTJ5225	Wing Nut	1
26	PTJ5226	Washer 12	2
27	PTJ5227	Bolt / m12x30	2