



## **! WARNING**

**DO NOT EXCEED MAXIMUM WEIGHT LIMIT OF 1,250 LBS. PER DOLLY.**

**BEFORE USING, CHECK THAT CASTERS ARE SECURED TIGHTLY TO FRAME AND NOT DAMAGED.**

**DOLLIES MUST BE USED IN PAIRS.**

**DOLLIES ARE TO BE USED TO SUPPORT VEHICLES WITH TIRES INSTALLED. DO NOT USE TO SUPPORT VEHICLES WITHOUT TIRES. TIRES MUST REST SECURELY IN DOLLY.**

**USE DOLLIES TO MOVE VEHICLES ONLY. DO NOT WORK ON OR UNDER VEHICLE WHILE SUPPORTED WITH DOLLY.**

**READ, STUDY CAREFULLY, AND UNDERSTAND THE OPERATING MANUAL PACKED WITH THIS DOLLY BEFORE OPERATING. FAILURE TO HEED THESE WARNINGS MAY RESULT IN LOSS OF LOAD, DAMAGE TO THE DOLLY AND/OR FAILURE RESULTING IN PROPERTY DAMAGE, PERSONAL OR FATAL INJURY.**

### **SPECIFICATIONS**

Capacity. . . . . 1,250 LBS per dolly  
Base Size . . . . . 17-1/2" x 14-1/2"  
Height: . . . . . 7-1/4"  
Shipping Wt. . . . . 49 Lbs.(1 pair)

## **CTE-WDS** **WHEEL DOLLY** **SET (2)**

# CTE-WDS

## WHEEL DOLLY SET (2)

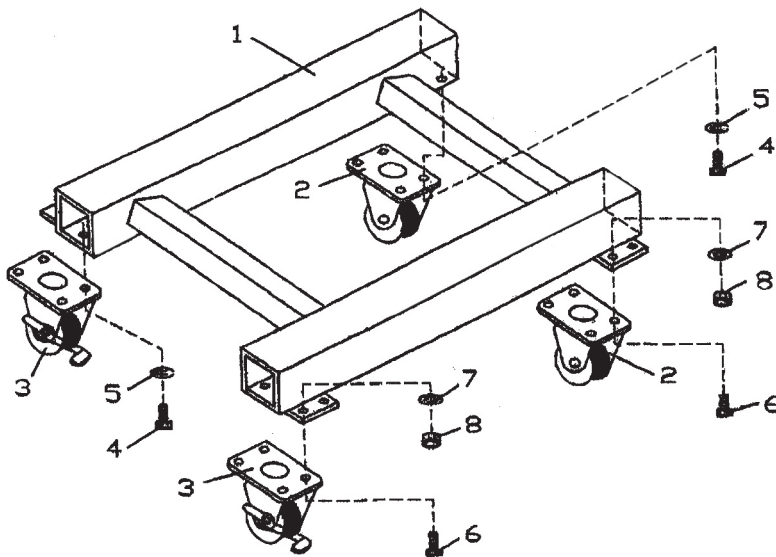

Ref. #	Part #	Description	Qty.
1		Main Frame	1
2	CTE-WDSNLC	Caster/each	2
3	CTE-WDSLCL	Locking Caster/each	2
4		*Bolt M8 x 16	8
5		*Lock Washer	8
6		*Bolt M8 x 20	8
7		*Washer	8
8		*Lock Nut	8

Astericked parts only available in bolt kit, part number RSWDSBK.

Only reference number's identified by part number are available as replacement parts.

### **WARNING!** READ ALL INSTRUCTIONS AND WARNING INFORMATION BEFORE OPERATION!

#### **Operating Instructions**

1. Lift the vehicle.
2. Carefully place dolly under center of tire.
3. Lower the vehicle.
4. Repeat for other dolly.

**NOTE:** Dollies must ALWAYS be used in pairs.

5. Dollies are for moving vehicle ONLY. Do NOT walk on or under vehicle while supported with dollies.

#### **Owner/User Responsibility**

The owner and/or user must have an understanding of the manufacturer's operating instructions and warnings before using this wheel dolly. Personnel involved in the use and operation of equipment shall be careful, competent, trained, and qualified in the safe operation of the equipment and its proper use when servicing motor vehicles and their components. Warning information should be emphasized and understood. If the operator is not fluent in English, the manufacturer's instructions and warnings shall be read to and discussed with the operator in the operator's native language by the purchaser/owner, making sure that the operator comprehends its contents. Owner and/or user must study and maintain for future reference the manufacturer's

instructions. Owner and/or user is responsible for keeping all warning labels and instruction manuals legible and intact. Replacement labels and literature are available from the manufacturer.

#### **Inspection**

Visual inspection should be made before each use of the wheel dolly, checking for damaged, loose or missing parts. Each dolly must be inspected if subjected to an abnormal load or shock. Any dolly which appears to be damaged in any way, is found to be badly worn, or operates abnormally **MUST BE REMOVED FROM SERVICE**. It is recommended that an annual inspection of the dolly be made and that any defective parts, decals or warning labels be replaced with manufacturer's specified parts.

#### **Assembly**

1. Attach casters and locking casters (item numbers 2, 3) to base with bolts, washers and nuts (item numbers 4, 5, 6, 7, 8).