

ASSEMBLY INSTRUCTIONS

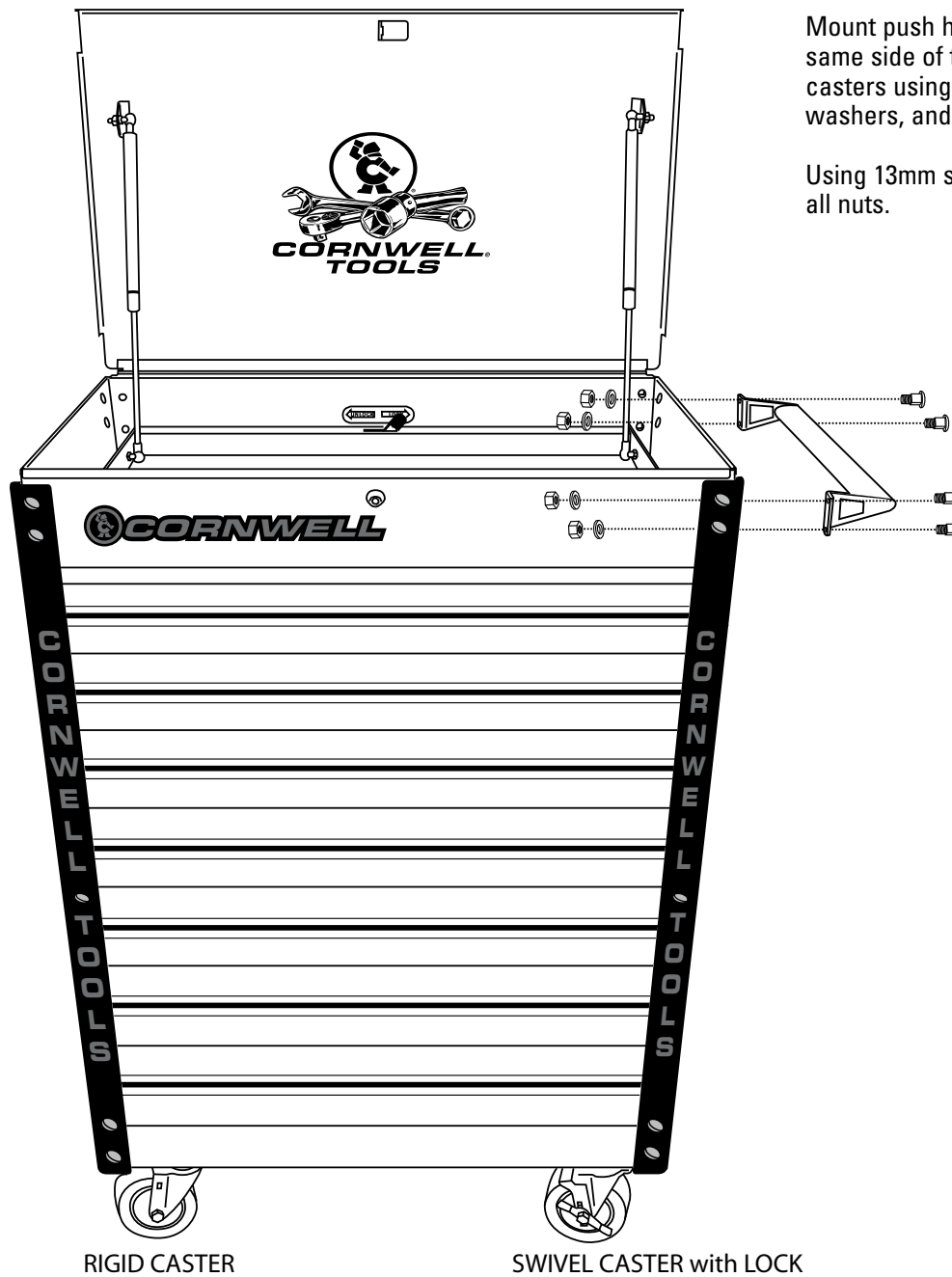

Mount push handle (Part #12) to the same side of the cart as the locking casters using the four stove bolts, washers, and nuts provided.

Using 13mm socket completely tighten all nuts.

HARDWARE SPECIFICATIONS

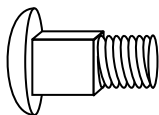

4 pcs.

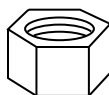

4 pcs.



4 pcs.

TROUBLESHOOTING

Troubleshooting Points for the CTBMM700 Series:

Problem: Drawers appear not to fit, do not slide in accurately and bump the cart sides.

Solution: The roller bearing slides must be fully engaged into the mounting slots on all drawers. They potentially could fall out of position during shipment. Check the side of the cart to determine which slide is out of position.

Remove the drawer that is out of position. The drawer is removed by the two clips on the actual roller bearing slide.

Simply push the roller bearing slide back down into position.

Insert the drawer back onto the roller bearing slides.

Problem: Back Lock/Unlock Switch does not engage the drawer.

Solution: The inside Lock/Unlock slide potentially could fall out of its groove during shipment. Unscrew the four screws that are holding the Lock/Unlock slide in place.

Once the screws are removed, simply place the latch back onto the slide and tighten the four screws back down.

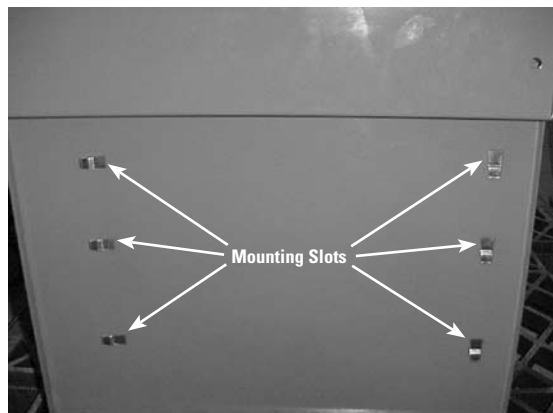

! WARNING

SERVICE CART WEIGHT CAPACITY

Total Net Load.....	700 LBS
Top Compartment	150 LBS
Top Six Drawers.....	70 LBS each
Bottom Drawer.....	150 LBS

PLEASE NOTE: Loading cart beyond rated capacity may cause structural damage to the cart as well as personal and /or property damage.

PARTS LIST

Item #	Part #	# Req'd	Description
1	RSLKN	1	Lock with Keys
2	RSMM700LGBK	4	Black Leg (each)
	RSMM700LGBL		Blue Leg
	RSMM700LGBR		Burgundy Leg
	RSMM700LGNV		Yellow Leg
	RSMM700LGRD		Red Leg
	RSMM700LGRG		Orange Leg
3	RSMM700BPLF	1	Left Front Bumper
	RSMM700BPLR	1	Left Rear Bumper
	RSMM700BPRF	1	Right Front Bumper
	RSMM700BPRR	1	Right Rear Bumper
4	CTB700MMLD2BK	1	Drawer 2-1/2"
	CTB700MMLD2BL		
	CTB700MMLD2BR		
	CTB700MMLD2NY		
	CTB700MMLD2RD		
	CTB700MMLD2RG		
5	CTB100MMLD2BK	3	Drawer 3-1/4"
	CTB100MMLD2BL		
	CTB100MMLD2BR		
	CTB100MMLD2NY		
	CTB100MMLD2RD		
	CTB100MMLD2RG		
6	CTB700MMLD4BK	2	Drawer 3-3/4"
	CTB700MMLD4BL		
	CTB700MMLD4BR		
	CTB700MMLD4NY		
	CTB700MMLD4RD		
	CTB700MMLD4RG		
7	CTB700MMLD6BK	1	Drawer 6"
	CTB700MMLD6BL		
	CTB700MMLD6BR		
	CTB700MMLD6NY		
	CTB700MMLD6RD		
	CTB700MMLD6RG		
8	RSMM100DH	7	Drawer Handle (with end caps)
	RSMM100DHP	14	Drawer Handle End Caps (each)
9	CTBMM100FC	1 set	Fixed Caster (pair)
10	RSSWLC	2	Swivel Caster w/lock (each)
11	RSGP	2	Gas Piston (each)
12	CTBMMHDK	1	Push Handle and Bracket Kit
13	CTBMM100RBS	6	Slides (pair)
14	CTBMM7HDS	1	HD Slides (pair)
15	RSLMC700BK	1	Black Locking Mechanism (Excluding Lock & Keys)
	RSLMC700BL		Blue Locking Mechanism (Excluding Lock & Keys)
	RSLMC700BR		Burgundy Locking Mechanism (Excluding Lock & Keys)
	RSLMC700NY		Yellow Locking Mechanism (Excluding Lock & Keys)
	RSLMC700RD		Red Locking Mechanism (Excluding Lock & Keys)
	RSLMC700RG		Orange Locking Mechanism (Excluding Lock & Keys)

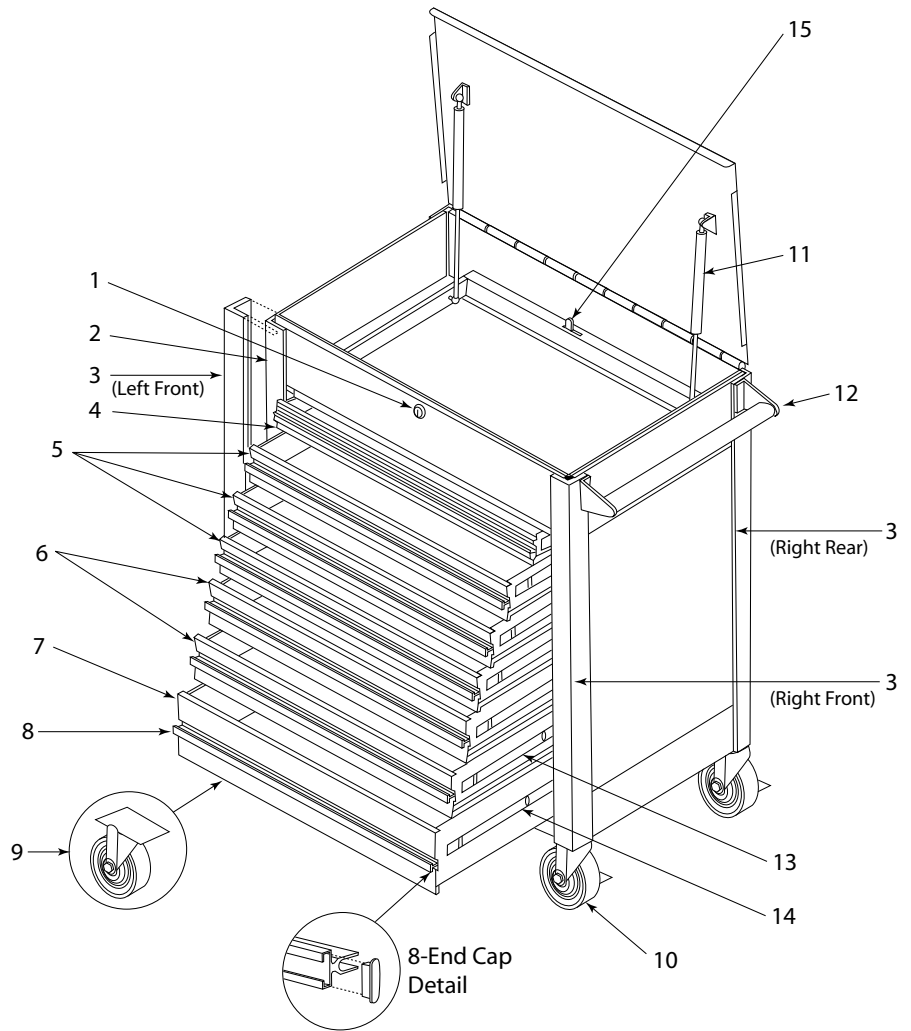
TOOLS NEEDED FOR ASSEMBLY:

- 13mm Socket or wrench

Also available:

RSSCPK
RSDT8PK

RSBKP
RSCTBBLU
RSCTBBR
RSYP
RSRDP
RSCORNORP
RSMM7008LK
RSMM100CLP

Service Cart Polishing Kit.
Ball Bearing Slide Detents
(Package of 8)
Black Touch Up Paint (1oz.)
Blue Touch Up Paint (1oz.)
Burgundy Touch Up Paint (1oz.)
Yellow Touch Up Paint (1oz.)
Red Touch Up Paint (1oz.)
Orange Touch Up Paint (1oz.)
Liner Kit
Logo Plate

RSMM700BK1
RSMM700BK2
RSMM700BK3

Bolt Kit for Legs and Bumpers (36 M8 x 17 bolts, nuts, and washers)
Bolt Kit for Push Handle (4 M8 x 19 bolts, nuts, and washers)
Bolt Kit for Casters (16 M8 x 16 bolts, nuts, and washers)