

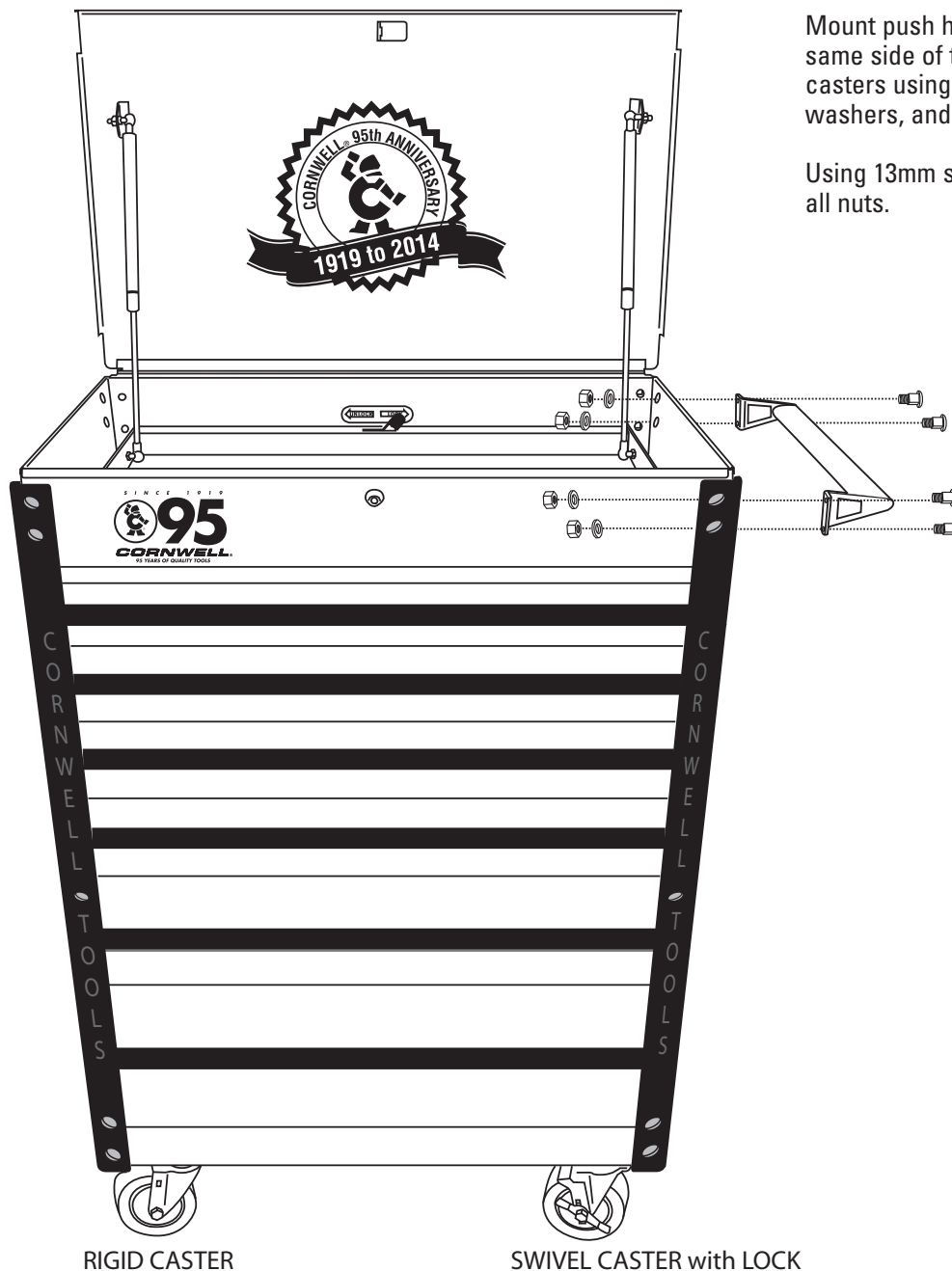

ASSEMBLY INSTRUCTIONS



Mount push handle (Part #12) to the same side of the cart as the locking casters using the four stove bolts, washers, and nuts provided.

Using 13mm socket completely tighten all nuts.



HARDWARE SPECIFICATIONS

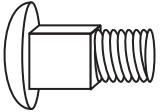

4 pcs.

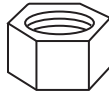

4 pcs.



4 pcs.

TROUBLESHOOTING

Troubleshooting Points for the CTBMM600 Series:

Problem: Drawers appear not to fit, do not slide in accurately and bump the cart sides.

Solution: The roller bearing slides must be fully engaged into the mounting slots on all drawers. They potentially could fall out of position during shipment. Check the side of the cart to determine which slide is out of position.

Remove the drawer that is out of position. The drawer is removed by the two clips on the actual roller bearing slide.

Simply push the roller bearing slide back down into position.

Insert the drawer back onto the roller bearing slides.

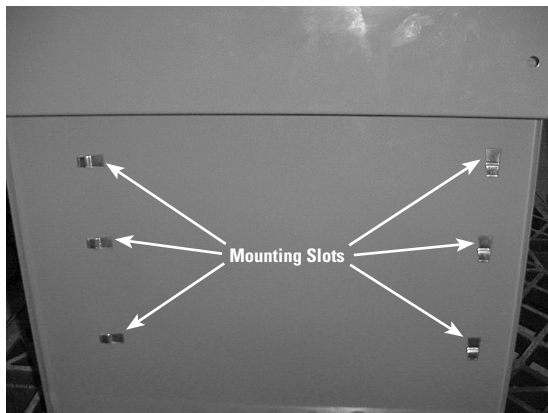

Problem: Back Lock/Unlock Switch does not engage the drawer.

Solution: The inside Lock/Unlock slide potentially could fall out of its groove during shipment. Unscrew the four screws that are holding the Lock/Unlock slide in place.

Once the screws are removed, simply place the latch back onto the slide and tighten the four screws back down.

⚠ WARNING

Cart Load Limit 700 LBS

Top 4 Drawer Load Limit 75 LBS

Bottom 2 Drawer Load Limit 150 LBS



- Read and follow all instructions in User's Manual
- Do not load carts beyond rated capacity
- Lock lid and drawers before moving
- Apply brake on locking casters anytime cart is in place
- Units can tip or fall causing damage or personal injury
- Do not open more than one loaded drawer at a time
- Do not stand on or step in drawers
- Keep children away from unit
- Wear gloves when lifting edges
- This product may contain one or more chemicals known to the State of California to cause cancer and birth defects or other reproductive harm. *Wash hands thoroughly after handling.*
- Failure to heed these warnings may result in personal injury and/or property damage

Patent # 7,144,020 B2; D529,254 S

PARTS LIST

Item #	Part #	# Req'd	Description
1	RSLKN	1	Lock with Keys
3A	RSMM700BPLF	1	Left Front Bumper
3B	RSMM700BPLR	1	Left Rear Bumper
3C	RSMM700BPRF	1	Front Right Bumper
3D	RSMM700BPRR	1	Right Rear Bumper
4	CTB600MMLDPG2	1	Drawer 2"
5	CTB600MMLDPG3	3	Drawer 3"
6	CTB600MMLDPG6	1	Drawer 6"
7	CTB600MMLDPG9	1	Drawer 9"
8	RSMM100DHBK	6	Drawer Handle (with end caps)
8A	RSMM100DHP	12	Drawer Handle End Cap (each)
9	CTBMM100FC	1 set	Fixed Caster (pair)
10	RSSWLCS	2	Swivel Caster w/lock (each)
11	RSGP	2	Gas Piston (each)
12	CTBMMHDK	1	Push Handle and Bracket Kit
13	CTBMM100RBS	8	Slides (pair)
14	RSLMC600PG		Locking Mechanism (Excluding Lock & Keys)
	RSMM700BK1		Bolt Kit for Legs and Bumpers (36 M8 x 17 bolts, nuts, and washers)
	RSMM700BK2		Bolt Kit for Push Handle (4 M8 x 19 bolts, nuts, and washers)
	RSMM700BK3		Bolt Kit for Casters (16 M8 x 16 bolts, nuts, and washers)

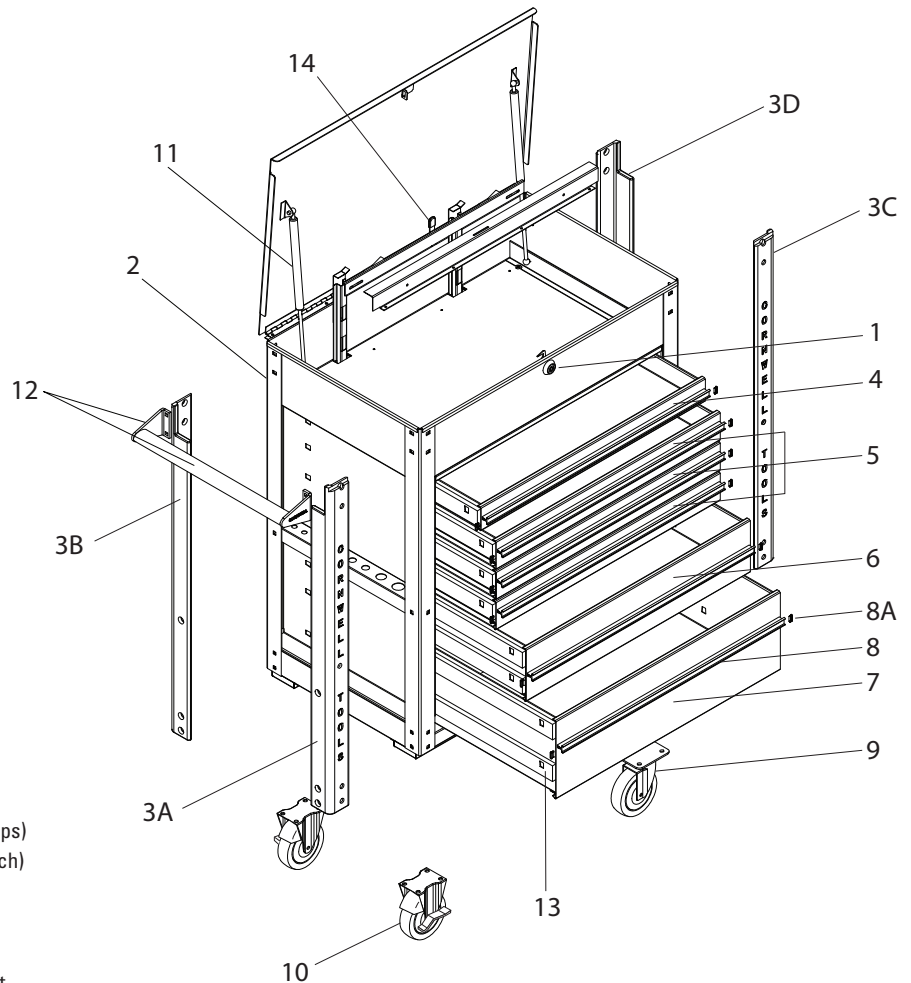

TOOLS NEEDED FOR ASSEMBLY:

- 13mm Socket or wrench

Also available:

RSSCPK
RSRBSDET8PK

RSMM7008LK
RSCTBMM600PGLK

Service Cart Polishing Kit.
Ball Bearing Slide Detents
(Package of 8)
Liner Kit
Graphic Decals Kit for CTBMM600PG