

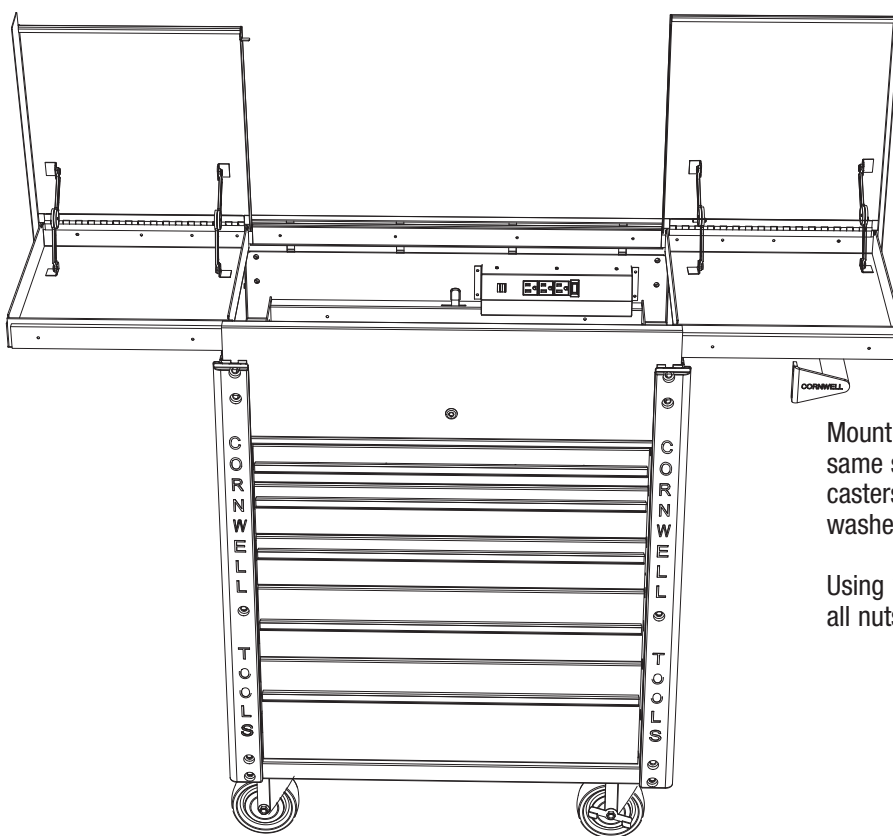

**CTB5DSTBLACKOUT/
CTB5DSTWHITE**
**5 Drawer Pro Series Slide Top
Service Cart w/ Power Strip**

ASSEMBLY INSTRUCTIONS



Mount push handle (Part #5) to the same side of the cart as the locking casters using the four stove bolts, washers, and nuts provided.

Using 13mm socket completely tighten all nuts.

! WARNING



- Read and follow all instructions in User's Manual.
- Do not load carts beyond rated capacity:

Maximum Total Net Load	700 Lbs.
Top Tray (Slide Top)	100 Lbs.
Drawers – Top 3.....	75 Lbs. Each
Drawers – Bottom 2.....	150 Lbs. Each

PLEASE NOTE: Loading cart beyond rated capacity may cause structural damage to the cart as well as personal and/or property damage. Please educate your customers to the "dangers of overloading".

- Lock lid and drawers before moving. • Apply brake on locking casters anytime cart is in place. • Do not pull cart. Push from handle on end to move. • Units can tip or fall causing damage or personal injury. • Cart is designed to roll easily on flat surfaces and should not be used on uneven or inclined surfaces. • Do not

open more than one loaded drawer at a time. • Do not stand on or step in drawers. • Keep children away from unit. • Wear gloves when lifting edges. • Before connecting to a power supply, always check to make sure the power supply corresponds to the voltage required on the product. • Fully insert plug to reduce the risk of electric shock. • Always unplug when not in use. • Disconnect power before installing or servicing. • Do not try to plug in unit or product when hands are wet or damp, or if standing on a wet or damp surface or in water. • Never attempt to pick up unit or plugged in product that should fall in standing water. • This unit is not waterproof and is intended for general use indoors. • Do not use in potentially dangerous locations, such as flammable or explosive atmospheres. • Keep cord away from heat, oil, sharp edges or moving parts. • Failure to heed these warnings may result in personal injury and/or property damage.



WARNING: This product can expose you to chemicals including lead, which is known to the State of California to cause cancer and birth defects or other reproductive harm. For more information go to www.P65Warnings.ca.gov.



CTB5DSTBLACKOUT/ CTB5DSTWHITE 5 Drawer Pro Series Slide Top Service Cart w/ Power Strip

HARDWARE SPECIFICATIONS



1 x 4 pcs.
Flat washer



2 x 4 pcs.
Nylon nut

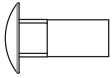

3 x 4 pcs.
M8 bolt (6mm-19mm)

TROUBLESHOOTING

Problem: Drawers appear not to fit, do not slide in accurately and bump the cart sides.

Solution: The roller bearing slides must be fully engaged into the mounting slots on all drawers. They potentially could fall out of position during shipment. Check the side of the cart to determine which slide is out of position.

Remove the drawer that is out of position. The drawer is removed by the two clips on the actual roller bearing slide.

Simply push the roller bearing slide back down into position.

Insert the drawer back onto the roller bearing slides.

Problem: Back Lock/Unlock Switch does not engage the drawer.

Solution: The inside Lock/Unlock slide potentially could fall out of its groove during shipment. Unscrew the four screws that are holding the Lock/Unlock slide in place.

Once the screws are removed, simply place the latch back onto the slide and tighten the four screws back down.

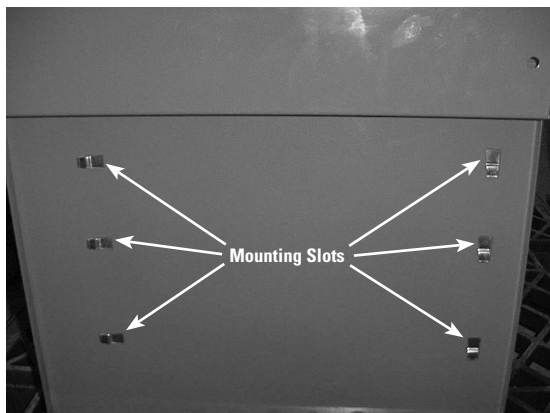

PARTS LIST

CTB5DSTBLACKOUT/

CTB5DSTWHITE

5 Drawer Pro Series Slide Top Service Cart w/ Power Strip

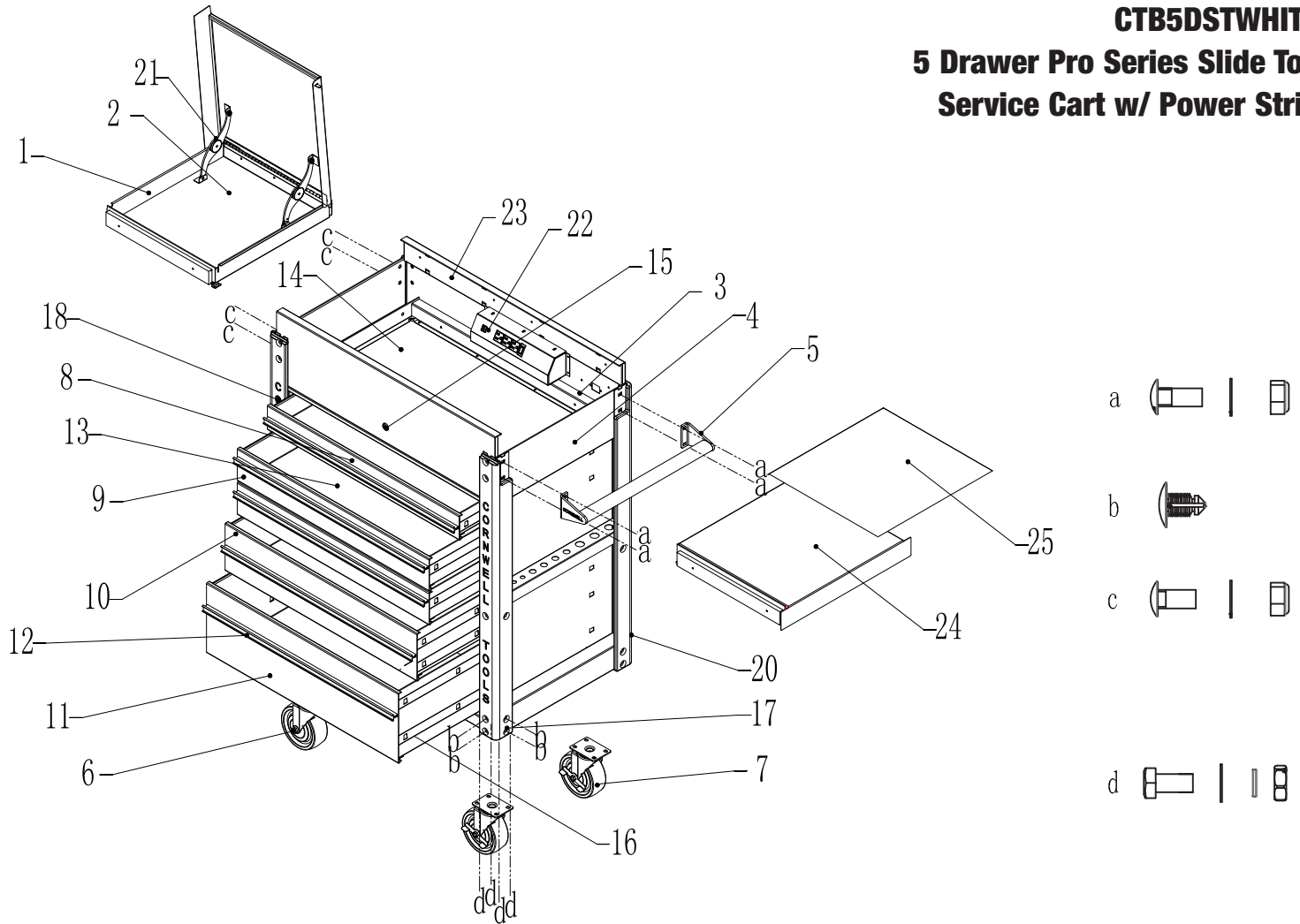

Item #	Part #	Description	QTY.	Item #	Part #	Description	QTY.
1	CTB5DLSTFBNN	Left sliding top file box (Black-Nero Nemesis)	1	a	RSMM700BK2BK	Hardware kit for push handle (Including 4 each of Bolts 6mm-19mm, Flat washers, Nylon nuts) - Black	1 set
	CTB5DLSTFBWH	Left sliding top file box (White)	1	b	RSMM500BF	Bumper fastener	32
2	RSFBEL	File box eva liner (each)	2	c	RSMM700BK4BK	Hardware kit for the opposite side of push handle - Black (Including 4 each of bolts 3-17mm, Flat washers, Nylon nuts)	1 set
3	RSLMC500NN	Locking mechanism (Black-Nero Nemesis) (excl lock w/ keys)	1	d	RSMM700BK3BK	Hardware kit for caster (Including 16 each of Hex bolt M8x16, 16 flat washers, 16 Spring washer) - Black	1 set
	RSLMC500BWHN	Locking mechanism (White) (excl lock w/ keys)	1				
4		Cart frame	1				
5	CTBMMHDKBK	Push handle and bracket kit (Black)	1				
6	CTBMM100FCBK	5" fixed caster (Black)	2				
7	RSSWLCGBK	5" swivel caster with lock (Black)	2				
8	CTBMM5003DNN	3" drawer (Black-Nero Nemesis)	1				
	CTBMM5003DWH	3" drawer (White)	1				
9	CTBMM5004DNN	4" drawer (Black-Nero Nemesis)	2				
	CTBMM5004DWH	4" drawer (White)	2				
10	CTBMM5006DNN	6" drawer (Black-Nero Nemesis)	1				
	CTBMM5006DWH	6" drawer (White)	1				
11	CTBMM5009DNN	9" drawer (Black-Nero Nemesis)	1				
	CTBMM5009DWH	9" drawer (White)	1				
12	RSMM100DHBK	Drawer handle (Black)	5				
13-14	RSSTFB8ELK	8 Pack of EVA liners	1 set				
15	RS5DSTLKSBK	Lock with keys (Black)	1				
16	RSRBS	Roller bearing slides (pair)	7 pair				
17	RSMM700BPRF	Right front bumper	1				
18	RSMM700BPLF	Left front bumper	1				
19	RSMM700BPLR	Left rear bumper	1				
20	RSMM700BPRR	Right rear bumper	1				
21	RSFBBRACE	File Box Brace	4				
22	RS50022	Power strip w/ cord	1				
23	RSTFBSLIDE	Top file box slides (pair)	1 pair				
24	CTB5DRSTFBNN	Right sliding top file box (Black-Nero Nemesis)	1				
	CTB5DRSTFBWH	Right sliding top file box (White)	1				
25	RSSTPVCL	Sliding top PVC liner (each)	2				

ALSO AVAILABLE:

RSMM100DHP - End cap for drawer handle
RS50022PC - Power cord only for power strip
RSRBSDET8PK - Ball bearing slide detents (Package of 8)
RSBLACKOUTPLK - Product Label Kit for CTB5DSTBLACKOUT
RSWHITEPLK - Product Label Kit for CTB5DSTWHITE