



ASSEMBLY INSTRUCTIONS

CSE-1000FTA
Fuel Tank Adapter for
Transmission Jack

ASSEMBLY INSTRUCTIONS:

1. Attach the fuel tank adapter saddle #3 to the transmission jack hydraulic unit ram using #9 bolt.
2. Attach fuel tank adapter #1 to saddle #3 using 2 each #6 bolts, #7 washers, and #8 wing nuts. The bolts should be inserted on opposite ends of the saddle. Make sure the fuel tank adapter is fastened securely to the saddle.
3. Adjust the four padded supports #2 to side of the fuel tank. Once the supports are in the correct position, secure them in place by using the wing bolts #4 provided.
4. Once the fuel tank has been removed from the vehicle, strap the fuel tank to the adapter #1 (before transporting it to its destination) using the tie down straps #5 provided.

INSPECTION:

Visual inspection should be made before each use of the transmission jack with adapter, checking for leaking hydraulic fluid and damaged, loose or missing parts. Each jack must be inspected by a manufacturer's repair facility immediately, if accidentally subjected to an abnormal load or shock. Any jack which appears to be damaged in any way, found to be badly worn, or operates abnormally **MUST BE REMOVED FROM SERVICE** until necessary repairs are made by a manufacturer's authorized repair facility. It is recommended that an annual inspection of the jack be made by a manufacturer's authorized repair facility and that any defective parts be replaced with manufacturer's specified parts.

A list of authorized repair facilities is available from the manufacturer.

! WARNING

1. THIS IS A LIFTING DEVICE ONLY. DO NOT MOVE OR DOLLY THE VEHICLE WHILE ON THE JACK. IMMEDIATELY AFTER LIFTING SUPPORT, THE VEHICLE WITH APPROPRIATE MEANS.
2. THE USE OF A TRANSMISSION JACK WITH THIS FUEL TANK ADAPTER IS LIMITED TO THE REMOVAL, INSTALLATION, AND TRANSPORTATION IN THE LOWER POSITION, OF FUEL TANKS.
3. DO NOT OVERLOAD. OVERLOADING CAN CAUSE DAMAGE TO OR FAILURE OF THE JACK AND/OR ADAPTER.
4. LIFT ONLY ON AREAS OF THE VEHICLE AS SPECIFIED BY THE VEHICLE MANUFACTURER.
5. THIS JACK IS DESIGNED FOR USE ONLY ON HARD LEVEL SURFACES CAPABLE OF SUSTAINING THE LOAD. USE ON OTHER THAN HARD LEVEL SURFACES CAN RESULT IN JACK INSTABILITY AND POSSIBLE LOSS OF LOAD.
6. NO ALTERATIONS TO THE JACK AND/OR ADAPTER SHALL BE MADE.
7. READ, STUDY AND UNDERSTAND THE INSTRUCTION MANUAL BEFORE OPERATING JACK AND/OR ADAPTER.
8. FAILURE TO HEED THESE WARNINGS MAY RESULT IN LOSS OF LOAD, DAMAGE TO THE JACK AND/OR ADAPTER, AND FAILURE RESULTING IN PROPERTY DAMAGE, PERSONAL OR FATAL INJURY.

OWNER/USER RESPONSIBILITY:

The owner and/or user must have a thorough understanding of the manufacturer's operating instructions and warnings before using this adapter with a transmission jack. Personnel involved in the use and operation of equipment shall be careful, competent, trained, and qualified in the safe operation of the equipment and its proper use when servicing motor vehicles and their components. Warning information should be emphasized and understood. If the operator is not fluent in English, the manufacturer's instructions and warnings shall be read to and discussed with the operator in the operator's native language by the purchaser/owner, making sure that the operator comprehends its contents.

Owner and/or user must study and maintain for future reference the manufacturer's instructions. Owner and/or user is responsible for keeping all warning labels and instruction manuals legible and intact. Replacement literature is available from the manufacturer.

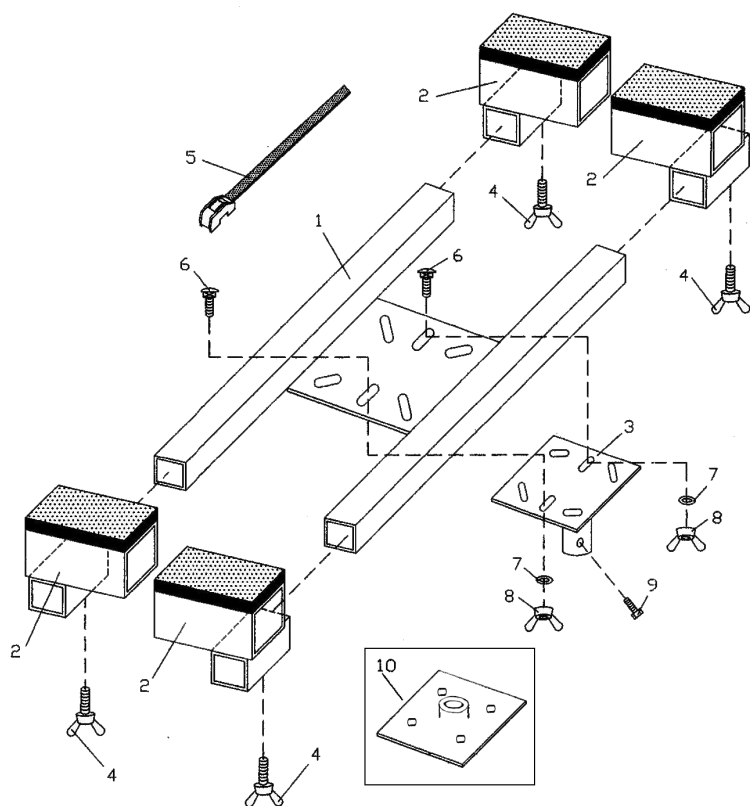

REF. NO.	PART NO.	DESCRIPTION	QTY.
1		Fuel Tank Adapter	1
2	RS770402	Padded Support	4
3	RS770403	Adapter Saddle For Dual Stage Transmission Jack	1
4	*	Wing Bolt (M10x25)	4
5	RS7704STRAP	Strap	2
6	*	Bolt (M12x35)	2
7	*	Washer (M12)	2
8	*	Wing Nut (M12)	2
9	*	Bolt (M8x20)	1
10	RS770410	Adapter Saddle for Single Stage Transmission Jack (not included)	
* Only available in bolt kit, RS7704BK			
Ref No. 1 is not available individually			

WARRANTY COVERAGE

Cornwell Quality Tools Company ("Cornwell") warrants against defects in material and workmanship on this product for a period of TWO (2) YEARS from the date of original retail purchase. Subject to the conditions and limitations set forth below, Cornwell will, at its option, either repair or replace any part of the product(s) that proves defective by reason of improper workmanship or materials.

This warranty does not cover any damage to this product that results from accident, abuse, misuse, natural or personal disaster, or any unauthorized disassembly, repair, or modification. Repairs, disassembly and modification are only authorized to be made by Cornwell or a warranty service center approved by Cornwell.

WARRANTY SERVICE

To obtain warranty service, contact your Cornwell dealer.

EXCLUSIONS AND LIMITATIONS

THIS WARRANTY AND THE REMEDIES SET FORTH ABOVE ARE EXCLUSIVE AND IN LIEU OF ALL OTHER WARRANTIES, REMEDIES AND CONDITIONS, WHETHER ORAL OR WRITTEN, EXPRESS OR IMPLIED. CORNWELL SPECIFICALLY DISCLAIMS ANY AND ALL IMPLIED WARRANTIES, INCLUDING, TO THE EXTENT PERMITTED BY APPLICABLE LAW, ANY WARRANTIES OF MERCHANTABILITY AND FITNESS FOR A PARTICULAR PURPOSE. IF CORNWELL CANNOT LAWFULLY DISCLAIM IMPLIED WARRANTIES UNDER THIS LIMITED WARRANTY, ALL SUCH IMPLIED WARRANTIES ARE LIMITED IN DURATION TO THE DURATION OF THIS WARRANTY.

IN NO EVENT SHALL CORNWELL BE LIABLE TO THE PURCHASER OR TO THE USER OF A CORNWELL PRODUCT FOR ANY SPECIAL, INCIDENTAL OR CONSEQUENTIAL DAMAGES BASED UPON BREACH OF WARRANTY, BREACH OF CONTRACT, NEGLIGENCE, TORT, OR ANY OTHER LEGAL THEORY. SUCH DAMAGES INCLUDE, WITHOUT LIMITATION, EXPENSES, LOST REVENUES, LOST SAVINGS, LOST PROFITS, OR ANY OTHER INCIDENTAL OR CONSEQUENTIAL DAMAGES ARISING FROM THE PURCHASE, USE OR INABILITY TO USE THE CORNWELL PRODUCT.

Some states do not allow the exclusion or limitation of incidental or consequential damages or exclusions or limitation on the duration of implied warranties or conditions, so the above limitations or exclusions may not apply to you. This warranty gives you specific legal rights, and you may also have other rights that vary by state.