

## 3/4 Ton Wheel Dolly

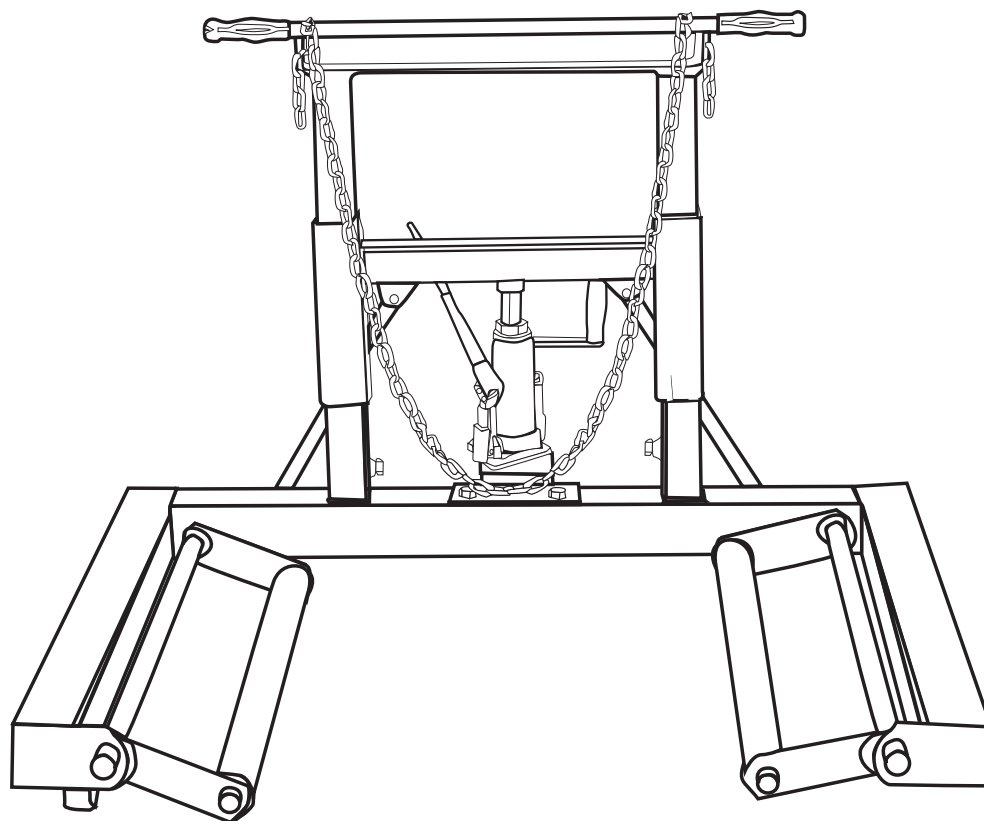

### SPECIFICATIONS

|                            |           |
|----------------------------|-----------|
| Capacity .....             | 1500 Lbs. |
| Length .....               | 31"       |
| Width .....                | 43"       |
| Height .....               | 35"       |
| Lift Arm Length .....      | 26"       |
| Max. Lift Arm Spread ..... | 25"       |
| Min. Lift Arm Spread ..... | 21"       |
| Lift .....                 | 8-1/4"    |
| Ram .....                  | 4-3/4"    |
| Shipping Wt. ....          | 156 Lbs.  |



*Model 1800-PVA Wheel Dolly is a lifting device characterized by a pair of laterally spaced lifting members which are used to raise, remove, transport and replace automotive wheel and tire assemblies.*

## Assembly Instructions:

1. Attach the swivel caster assembly (#16) to the base frame (#1) using (4) 5/16" x 3/4" hex bolts (#17) and (4) 5/16" hex locknuts (#15). **NOTE:** When attaching swivel caster assembly, insert bolts so that when stand is upright, the hex locknuts will be on top. Refer to exploded view diagram - Figure 1.
2. Insert upright assembly (#2) onto the frame (#1) using (4) 1/2" x 4" hex bolts (#12), (4) 1/2" nuts (#13), and (4) 1/2" flat washers (#14).
3. Assemble the lifting straps (#6) to the frame (#1) and upright assembly (#2) by attaching the lifting straps to the fingers (#7) of the frame and upright assembly (#2) by using 4 5/16" x 1" Clevis Pins (#8) and (4) 5/16" x 1" Cotter Pins (#9). **NOTE:** make sure lifting straps are located on each side of the frame fingers and upright assembly fingers. Refer to diagram.
4. Place bottle jack (#3) onto the upright assembly (#2). Refer to diagram. **NOTE:** Screw out bottle jack extension screw so that the upright assembly will rest on bottle jack.
5. Attach safety chain (#10) by putting links into slots on upright assembly (#2).

## Operating Instructions

**Removing Wheel(s):** Raise the vehicle so that the Wheel(s) to be removed are clear of the ground. Keep the Axle(s) horizontal for ease of sliding the Wheel(s) on and off. Place Jack Stands under the vehicle. Make sure vehicle is properly blocked. Lower the Dolly's Lifting Arms fully by turning Valve counter clockwise on the Hydraulic Jack and position the Wheel Dolly under the Wheel(s) to be removed. Loop chain around the Wheel(s) and draw the chain snugly (not tightly) before fastening it to the connecting points. Raise the Dolly Lifting Arms by turning Valve counter clockwise on the Hydraulic Jack, and use upward and downward motion with Jack Handle until the Arms are supporting the weight of the Wheel(s); then carefully slide the Wheel(s) off the Axle by pulling the Dolly away from the vehicle. Caution should be taken to avoid damaging the Bearing and Seals.

**Replacing Wheel(s):** Load the Wheel(s) on the Wheel Dolly, loop the chain around the Wheel(s) to secure it, and maneuver the Wheel Dolly into alignment with the Axle. Carefully slide the Wheel(s) onto the Axle by pushing the Wheel Dolly toward the vehicle. **NOTE:** When the Wheel(s) have to be rotated to align them with the Mounting Studs, rotate one of the Lifting Arm Rollers (which in turn, rotates the Wheel) rather than rotating the Wheel(s) directly.

## ! WARNING

ALWAYS KEEP HANDS OFF VERTICAL GUIDE POST WHEN LOWERING ELEVATOR.

DO NOT OVERLOAD. OVERLOADING CAN CAUSE DAMAGE TO OR FAILURE OF THE WHEEL DOLLY.

THE USE OF THIS WHEEL DOLLY IS LIMITED TO THE REMOVAL, TRANSPORTATION AND INSTALLATION OF WHEEL ASSEMBLIES.

DO NOT LIFT OR SUPPORT VEHICLES WITH WHEEL DOLLY. THE USE OF CAR/TRUCK STANDS IS REQUIRED WHEN USING THIS WHEEL DOLLY.

VEHICLE MUST BE PROPERLY BLOCKED TO PREVENT MOVEMENT WHEN TIRES ARE REMOVED OR INSTALLED.

MAKE SURE THAT THE LOAD IS CENTERED AS CLOSE TO THE VERTICAL PORTION OF THE LIFTING MEMBER AS POSSIBLE, AND SECURED WITH THE LOAD RESTRAINT CHAIN.

NO ALTERATIONS TO THE WHEEL DOLLY SHALL BE MADE.

VISUAL INSPECTION SHOULD BE MADE BEFORE EACH USE OF THE DOLLY, CHECKING FOR LEAKING HYDRAULIC FLUID AND DAMAGED, LOOSE OR MISSING PARTS.

THIS WHEEL DOLLY IS DESIGNED FOR USE ONLY ON HARD LEVEL SURFACES CAPABLE OF SUSTAINING THE LOAD. USE ON OTHER THAN HARD LEVEL SURFACES CAN RESULT IN WHEEL DOLLY INSTABILITY AND POSSIBLE LOSS OF LOAD.

STUDY AND UNDERSTAND THE OPERATING INSTRUCTIONS PACKED WITH THIS WHEEL DOLLY BEFORE OPERATING.

FAILURE TO HEED THESE WARNINGS MAY RESULT IN LOSS OF LOAD, DAMAGE TO THE WHEEL DOLLY AND/OR FAILURE OF THE WHEEL DOLLY RESULTING IN PROPERTY DAMAGE, PERSONAL OR FATAL INJURY.

## PARTS BREAKDOWN & OPERATING MANUAL

# Model # 1800-PVA

## 3/4 Ton Wheel Dolly

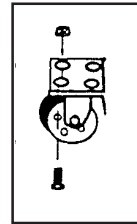
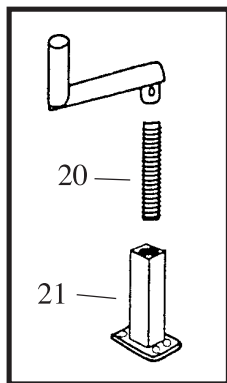
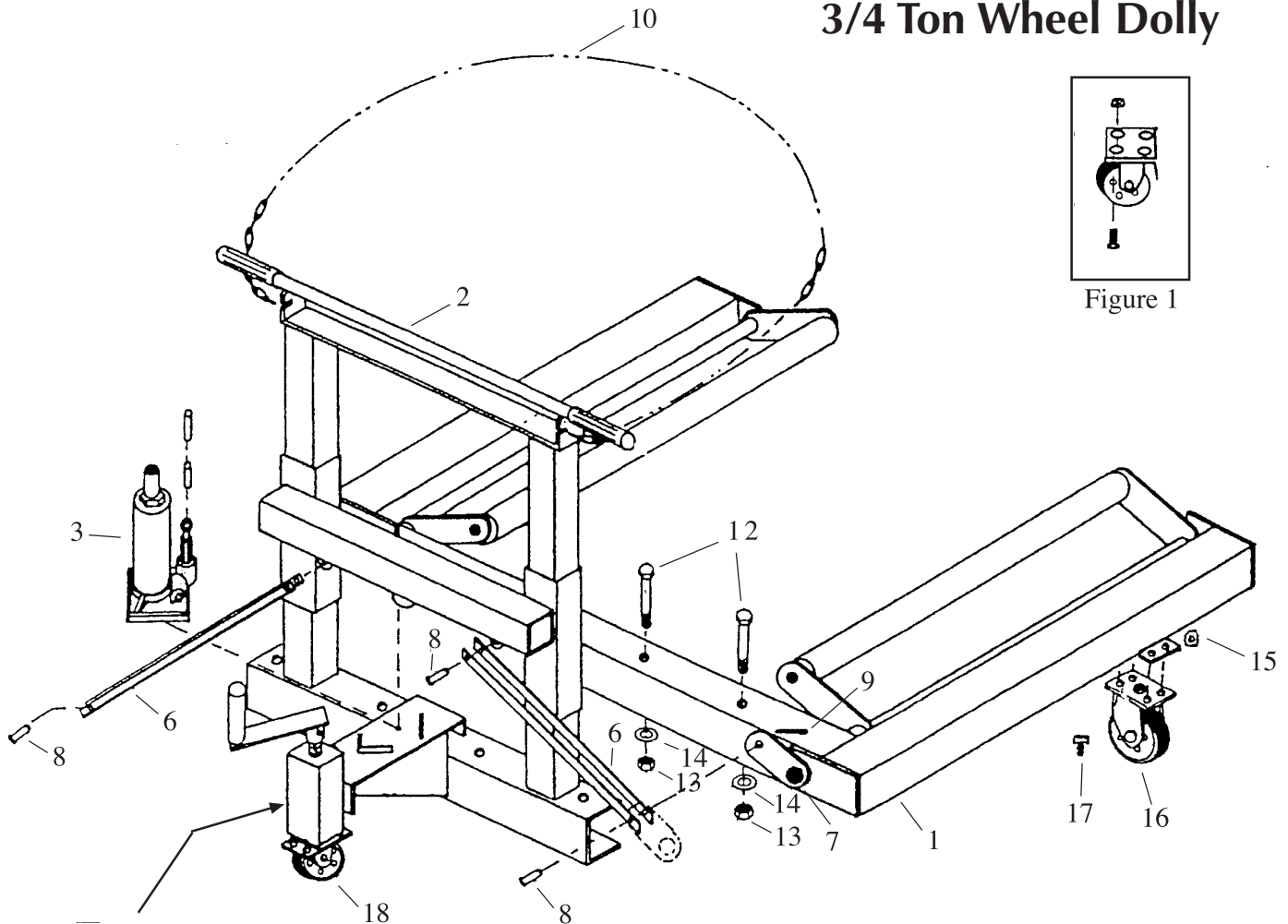

Figure 1



| Ref. No. | Part No. | Description                         | Qty. |
|----------|----------|-------------------------------------|------|
| *1       |          | Base Weldment (Incl. # 7)           | 1    |
| *2       |          | Upright Assembly                    | 1    |
| 3        | RS1501BJ | Bottle Jack                         | 1    |
| 6        | RS150106 | Lifting Strap                       | 4    |
| *7       |          | Finger                              | 2    |
| 16       | RSSC350A | 3-1/2" Swivel Caster Assy.          | 2    |
| 18       | RSSC301A | 3" Swivel Caster (Pre-Assem.)       | 1    |
| 19       | RS150119 | Crank Assembly (Inc. Ref #20 & #21) | 1    |
| 20       |          | Acme Rod                            | 1    |
| 21       |          | Slide Weldment                      | 1    |
|          | RS1501BK | <b>Bolt Kit Includes</b>            | 1    |
| 8        |          | 5/16" x 1" Clevis Pin               | 4    |
| 9        |          | 5/16" x 1" Cotter Pin               | 4    |
| 12       |          | 1/2" x 4" Bolt                      | 4    |
| 13       |          | 1/2" Nut                            | 4    |
| 14       |          | 1/2" Flat Washer                    | 4    |
| 15       |          | 5/16" Hex Locknut                   | 8    |
| 17       |          | 5/16" x 3/4" Hex Bolt               | 8    |
| 10       |          | Safety Chain                        | 1    |

\* Not Available

## PARTS BREAKDOWN & OPERATING MANUAL

## Inspection:

Visual inspection should be made before each use of the hydraulic wheel dolly, checking for leaking hydraulic fluid and damaged, loose or missing parts. Any wheel dolly which appears to be damaged in any way, found to be badly worn, or operated abnormally **MUST BE REMOVED FROM SERVICE**. If the wheel dolly is accidentally subjected to an abnormal load or shock, it must be inspected by a manufacturer's authorized repair facility immediately. It is recommended that an annual inspection of the wheel dolly be made by a manufacturer's authorized repair facility and that any defective parts, decals, or warning labels be replaced with manufacturer's specified parts. A list of authorized repair facilities is available from the manufacturer.

## Owner/User Responsibility:

The owner and/or user must have a thorough understanding of the manufacturer's operating instructions and warnings before using this wheel dolly. Personnel involved in the use and operation of equipment shall be careful, competent, trained, and qualified in the safe operation of the equipment and its proper use when servicing motor vehicles and their components. Warning information should be emphasized and understood. If the operator is not fluent in English, the manufacturer's instructions and warnings shall be read to and discussed with the operator in the operator's native language by the purchaser/owner, making sure that the operator comprehends its contents.

Owner and/or user must study and maintain for future reference the manufacturer's instructions. Owner and/or user is responsible for keeping all warning labels and instruction manuals legible and intact. Replacement labels and literature are available from the manufacturer.

## LIMITED WARRANTY

ProValue<sup>TM</sup> shop equipment and tools, excluding accessories, are warranted against defects in materials or workmanship for a period of 1 year from original purchase. We will repair or replace at our option any defective part or unit which proves to be defective in material or workmanship within this warranty plan. This warranty does not cover damage to equipment or tools arising from alteration, abuse, misuse or damage and does not cover any repairs or replacement made by anyone other than ProValue<sup>TM</sup> or its authorized service centers.

The foregoing obligation is **CARQUEST** Products, Inc., ProValue's sole liability under this or any implied warranty and under no circumstances shall we be liable for any incidental or consequential damages.

NOTE: Some states do not allow the exclusion or limitation of incidental or consequential damages, so the above limitation or exclusion may not apply to you.

Return equipment or parts to an authorized service center via prepaid transportation. Be certain to include your name and address, evidence of the purchase date, and description of the suspected defect.

This warranty gives you specific legal rights and you may also have other rights which vary from state to state.