

ProValueTM

Old 1022-CJ
New 1022-PV

20 TON HYDRAULIC PRESS

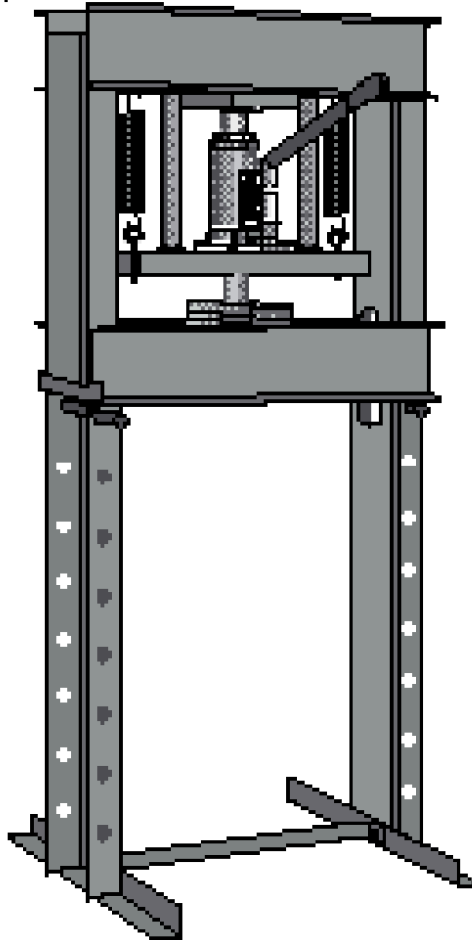

PARTS BREAKDOWN & OPERATING MANUAL

⚠ WARNING



ALWAYS USE AN ACCURATE PRESSURE GAUGE TO MEASURE PRESSING FORCE.

DO NOT EXCEED THE RATED CAPACITY OF THIS PRESS.

NEVER TAMPER WITH HYDRAULIC SYSTEM PRESSURE SETTINGS.

COMPONENTS OF THIS PRESS ARE SPECIALLY DESIGNED TO WITHSTAND RATED CAPACITY LOADS. DO NOT SUBSTITUTE BOLTS OR PINS, OR ANY OF THE COMPONENTS. USE ONLY GENUINE FACTORY REPLACEMENT PARTS.

ALWAYS CENTER LOAD ON RAM PLUNGER. OFFSET LOADS CAN DAMAGE RAM AND MAY CAUSE LOAD TO EJECT.

VISUAL INSPECTION SHOULD BE MADE BEFORE EACH USE OF THE PRESS, CHECKING FOR SIGNS OF CRACKED WELDS, BENT BED PINS, LOOSE OR MISSING BOLTS, OR ANY OTHER STRUCTURAL DAMAGE.



REMOVE ALL LOADS FROM PRESS BED BEFORE ATTEMPTING TO ADJUST BED HEIGHT. BEWARE OF POSSIBLE FALLING BED.

PRESS ONLY ON LOADS SUPPORTED BY PRESS BED. DO NOT SUPPORT LOADS ON FLOOR OR PRESS FRAME.

WHEN USING ANY ACCESSORIES SUCH AS ARBOR PLATES, BE CERTAIN THEY ARE CENTERED ON PRESS BED, AND ARE IN FULL CONTACT WITH BED.

PARTS BEING PRESSED MAY SPLINTER, SHATTER, OR BE EJECTED FROM THE PRESS. DUE TO VARIED APPLICATIONS, IT IS YOUR RESPONSIBILITY TO ALWAYS USE ADEQUATE GUARDS, WEAR EYE PROTECTION AND HEAVY PROTECTIVE CLOTHING WHEN OPERATING THE PRESS.

KEEP HANDS AND FINGERS OUT OF THE PRESS AND AWAY FROM PARTS THAT MAY SHIFT AND PINCH. DO NOT STAND IN FRONT OF WORK AREA WHERE LOAD IS APPLIED.

BEFORE APPLYING LOAD, BE CERTAIN ALL PRESS BED SUPPORTING PINS ARE FULLY ENGAGED.

ALWAYS USE A BEARING SHIELD WHEN PRESSING BEARINGS. UTILIZE CAUTION SETTING WORK UP TO BE PRESSED TO INSURE THAT THE ITEM THAT IS TO BE PRESSED OR ANY PART THEREOF CANNOT BE DISLODGED OR BROKEN DURING PRESS WORK. THIS MAY RESULT IN THE PART FLYING OUT OF THE WORK AREA AT A DANGEROUS RATE OF SPEED.

NO ALTERATIONS TO THE PRESS SHALL BE MADE.

READ, STUDY AND UNDERSTAND ALL INSTRUCTION MANUALS PACKED WITH THIS PRESS BEFORE OPERATING.

FAILURE TO HEED THESE WARNINGS MAY RESULT IN LOSS OF LOAD, DAMAGE TO THE PRESS AND/OR FAILURE RESULTING IN PROPERTY DAMAGE, PERSONAL OR FATAL INJURY.

FEATURES

- All Welded Steel Construction
- Heavy Duty Return Springs for Fast Ram Retraction
- Reinforced Head Plate
- Hydraulic Power Unit Included
- Bed Plates and Bearing Punch Included as Standard Equipment

ASSEMBLY INSTRUCTIONS

1. Unpack carton and lay the frame (#1) on a flat surface. Make sure press bed (#6) is on frame before proceeding. See diagram.
2. Attach Z bar leg (#13) to each side leg (#12) using (4) 1/2" x 1-1/4" hex bolt (#14) and (4) 1/2" nuts (#15).
3. After making sure press bed (#6) is positioned on the bottom of the frame (#1), stand press upright, being careful not to let press bed (#6) drop down.

NOTE: Keep hands away from bed while raising unit.

4. Raise press bed (#6) to desired height and insert press pins (#7) into parallel holes.
5. Set hydraulic unit (#11) on press carriage (#16) and insert handle.
6. Check all bolts for tightness and hydraulic unit for any leaks. **NOTE:** Always use bearing shield when pressing bearings. If press rocks and is not level, loosen feet slightly to compensate.

INSPECTION

Visual inspection should be made before each use of the hydraulic press, checking for damaged, loose or missing parts. Each press must be inspected by a manufacturer's repair facility immediately, if accidentally subjected to an abnormal load or shock. Any press which appears to be damaged in any way, is found to be badly worn, or operates abnormally **MUST BE REMOVED FROM SERVICE** until necessary repairs are made by a manufacturer's authorized repair facility. It is recommended that an annual inspection of the press be made by a manufacturer's authorized repair facility and that any defective parts, decals or warning labels be replaced with manufacturer's specified parts. A list of authorized repair facilities is available from the manufacturer.

SPECIFICATIONS

Capacity	20 Tons
Height	67"
Base Width	30"
Stroke	7"
Shipping Wt.	265 Lbs.

OPERATING INSTRUCTIONS

1. Bed Frame - the press bed (#6) is adjustable up and down to fully take advantage of available ram travel and numerous work pieces.
2. Fully retract ram and remove all items from press bed frame.
3. Support press bed (#6), and remove (2) press bed pins (#7).
4. Raise or lower press bed to desired height, and re-install press bed pins (#7). Be certain pins are fully engaged in parallel flanges of the upright columns.

OWNER/USER RESPONSIBILITY

The owner and/or user must have an understanding of the manufacturer's operating instructions and warnings before using this hydraulic press. Personnel involved in the use and operation of equipment shall be careful, competent, trained, and qualified in the safe operation of the equipment and its proper use. Warning information should be emphasized and understood. If the operator is not fluent in English, the manufacturer's instructions and warnings shall be read to and discussed with the operator in the operator's native language by the purchaser/owner, making sure that the operator comprehends its contents.

Owner and/or user must study and maintain for future reference the manufacturer's instructions. Owner and/or user is responsible for keeping all warning labels and instruction manuals legible and intact. Replacement labels and literature are available from the manufacturer.

MAINTENANCE

Maintain proper hydraulic fluid level in bottle jack.

1022-PV 20 Ton Hydraulic Press

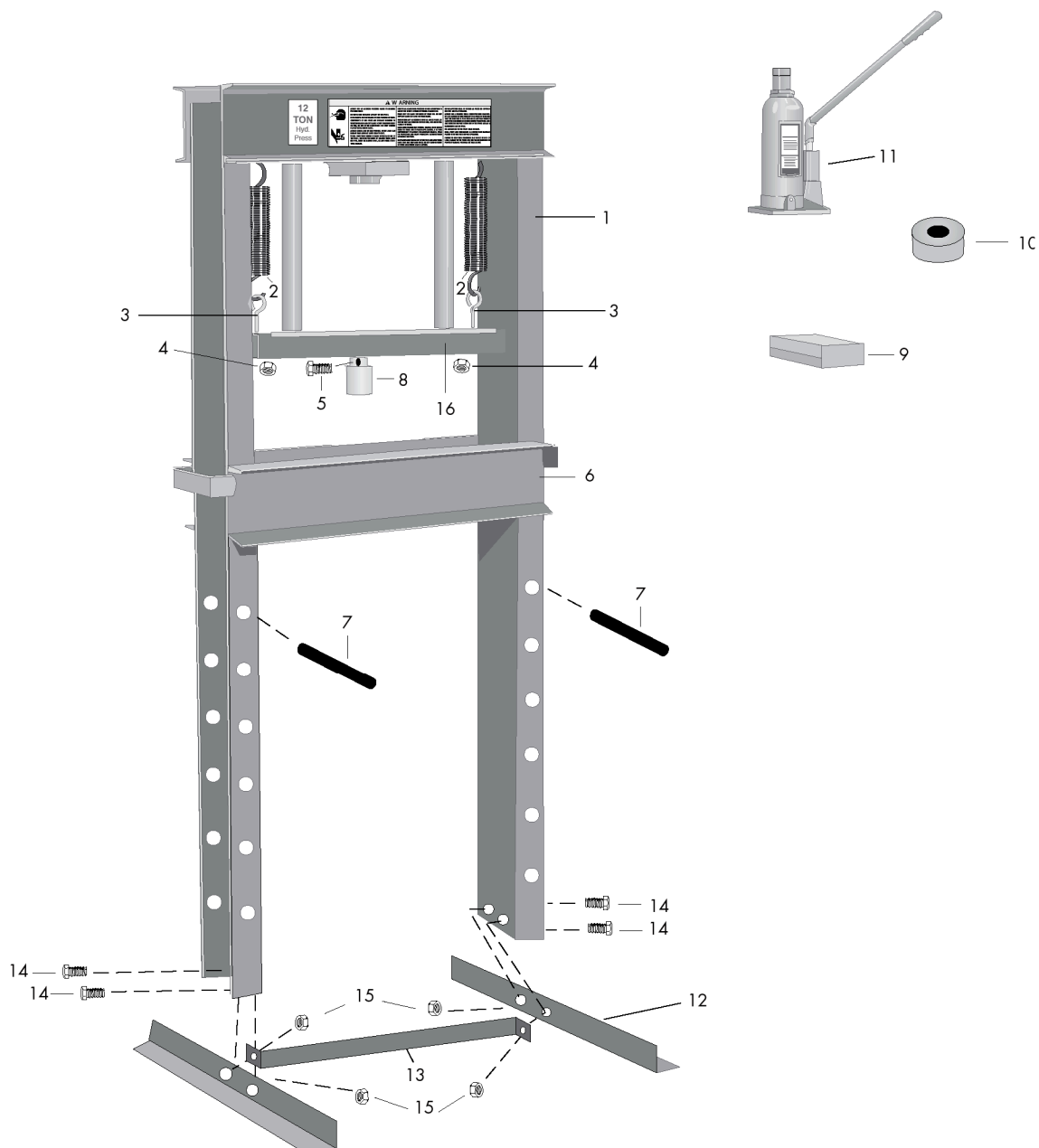

REF. NO.	PART NO.	DESCRIPTION	QTY.
1	550045A	Press Frame	1
2	345009	Spring	2
*3		3/8" x 4" Eye Bolt	2
*4		3/8" Nut	2
*5		5/16" x 1" Hex Bolt	1
6	540046A	Press Bed	1
7	550034	Press Pin	2
8	310012	Pushing Adapter	1
9	550041	Press Plate	2

REF. NO.	PART NO.	DESCRIPTION	QTY.
10	RS BSI	Bearing Shield	1
11	4920A	20 Ton Capacity Bottle Jack	1
12	540048	Side Leg	2
13	540049	Z Bar Leg	1
*14		1/2" x 1-1/4" Bolt	4
*15		1/2" Nut	4
16	540047A	Press Carriage	1
17	5220BK	Inc. Item #3, 4, 5, 14, 15	1

*Available ONLY in Kit Part #5220BK

ProValueTM

1022PV 20 TON HYDRAULIC PRESS

Warranty Notice

Hydraulic Warranty Policy . . . 90 Day

Should hydraulic repair become necessary within the 90 day warranty period, please ship the entire 20 Ton Bottle Jack prepaid to your nearest authorized repair facility. Please include a description of the problem, along with a dated receipt or other proof of purchase.

Manufactured Parts . . . 1 Year

Are covered under a 1 year warranty when used as recommended. Manufactured parts are available as shown in parts breakdown. Please see your local dealer for return and replacement of manufactured parts.