

Blue-Point®

**2 TON CAPACITY
SERVICE JACK**

Model SJ002 service jack is a self-contained device designed for lifting, but not sustaining, a partial vehicular load. It consists of a frame with wheels and swivel casters supporting a mechanism that actuates a pivoting lift arm equipped with a saddle. It is designed for use by professional auto mechanics.

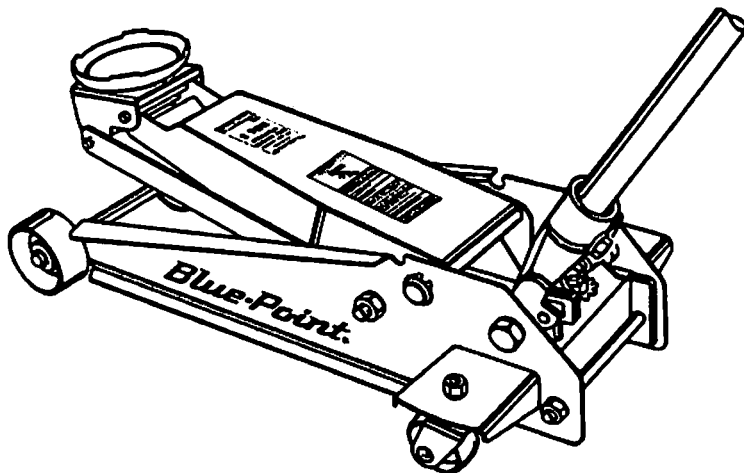

▲ WARNING



THIS IS A LIFTING DEVICE ONLY. DO NOT MOVE OR DOLLY THE VEHICLE WHILE ON THE JACK. IMMEDIATELY AFTER LIFTING SUPPORT THE VEHICLE WITH APPROPRIATE MEANS.

DO NOT OVERLOAD. OVERLOADING CAN CAUSE DAMAGE TO OR FAILURE OF THE JACK.

LIFT ONLY ON AREAS OF THE VEHICLE AS SPECIFIED BY THE VEHICLE MANUFACTURER.

CENTER LOAD ON SADDLE PRIOR TO LIFTING. OFF-CENTER LOADS MAY CAUSE DAMAGE TO JACK, LOSS OF LOAD, PROPERTY DAMAGE, PERSONAL OR FATAL INJURY.

THIS JACK IS DESIGNED FOR USE ONLY ON HARD LEVEL SURFACES CAPABLE OF SUSTAINING THE LOAD. USE ON OTHER THAN HARD LEVEL SURFACES CAN RESULT IN JACK INSTABILITY AND POSSIBLE LOSS OF LOAD.

NO ALTERATIONS TO THE JACK SHALL BE MADE.

READ, STUDY AND UNDERSTAND THE OPERATING MANUAL PACKED WITH THIS JACK BEFORE OPERATING.

FAILURE TO HEED THESE WARNINGS MAY RESULT IN LOSS OF LOAD, DAMAGE TO JACK, AND/OR FAILURE RESULTING IN PROPERTY DAMAGE, PERSONAL OR FATAL INJURY.

▲ WARNING

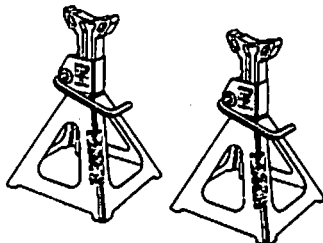

**FOR YOUR SAFETY
AND TO PREVENT INJURY:**

Use Service Jack for
Lifting Purposes **ONLY**.
Always Support Vehicle with
Support Stands

SJ002 SPECIFICATIONS

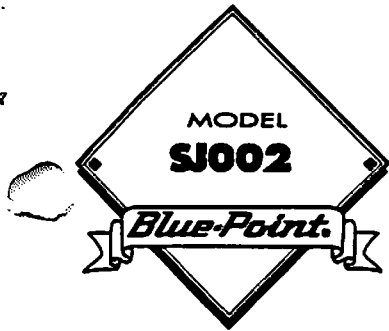

Low Height 3-7/8"
High Height 20"
Saddle Diameter 5-1/8"
Handle Length 42"

Base Length 27-3/4"
Chassis Width 14-1/2"
Weight 89 Lbs.

OWNER/USER RESPONSIBILITY

The owner and/or user must have an understanding of the manufacturer's operating instructions and warnings before using this jack. Personnel involved in the use and operation of equipment shall be careful, competent, trained, and qualified in the safe operation of the equipment and its proper use when servicing motor vehicles and their components. Warning information should be emphasized and understood. If the operator is not fluent in English, the manufacturer's instructions and warnings shall be read to and discussed with the operator in the operator's native language by the purchaser/owner, making sure that the operator comprehends its contents.

Owner and/or user must study and maintain for future reference the manufacturer's instructions. Owner and/or user is responsible for keeping all warning labels and instruction manuals legible and intact. Replacement labels and literature are available from the manufacturer.

INSPECTION

Visual inspection should be made before each use of the jack, checking for leaking hydraulic fluid and damaged, loose or missing parts. Each jack must be inspected by a manufacturer's repair facility immediately, if accidentally subjected to an abnormal load or shock. Any jack which appears to be damaged in any way, is found to be badly worn, or operates abnormally **MUST BE REMOVED FROM SERVICE** until necessary repairs are made by a manufacturer's authorized repair facility. It is recommended that an annual inspection of the jack be made by a manufacturer's authorized repair facility and that any defective parts, decals or warning labels be replaced with manufacturer's specified parts.

A list of authorized repair facilities is available from the manufacturer.

WARNING!

READ ALL
INSTRUCTIONS
AND
WARNING
INFORMATION
BEFORE
OPERATION!

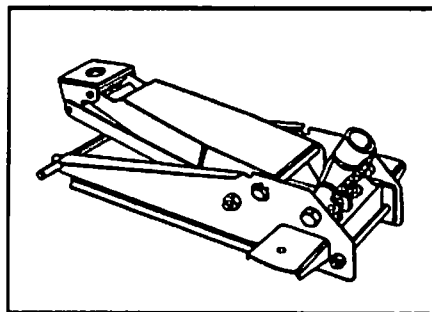

Contents: Box 1 of 2

When you receive your SJ002 Service Jack, examine the contents of each box and make sure all the items shown are present.

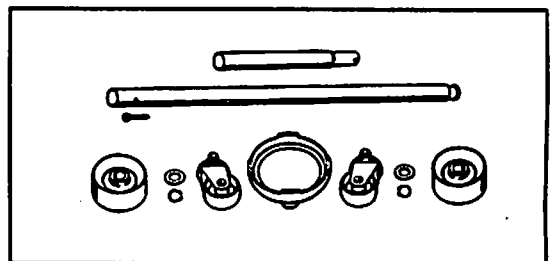

Contents: Box 2 of 2

ASSEMBLY INSTRUCTIONS



Refer to Figure 1 when assembling unit.

1. Rear Wheel Assembly: Mount rear wheel caster assembly to rear wheel bracket. Place lock washer over stem and tighten with nut.
2. Front Wheel Assembly: Slide front wheel onto front axle. Slide washer against wheel and assemble snap ring to groove in axle.
3. Position lower handle into handle socket; place handle locking bolt into rear of handle socket and tighten. Put upper handle onto lower handle and place hex head screw through handles and tighten nut.
4. Place saddle into lifting arm until base of saddle contacts lifting arm.

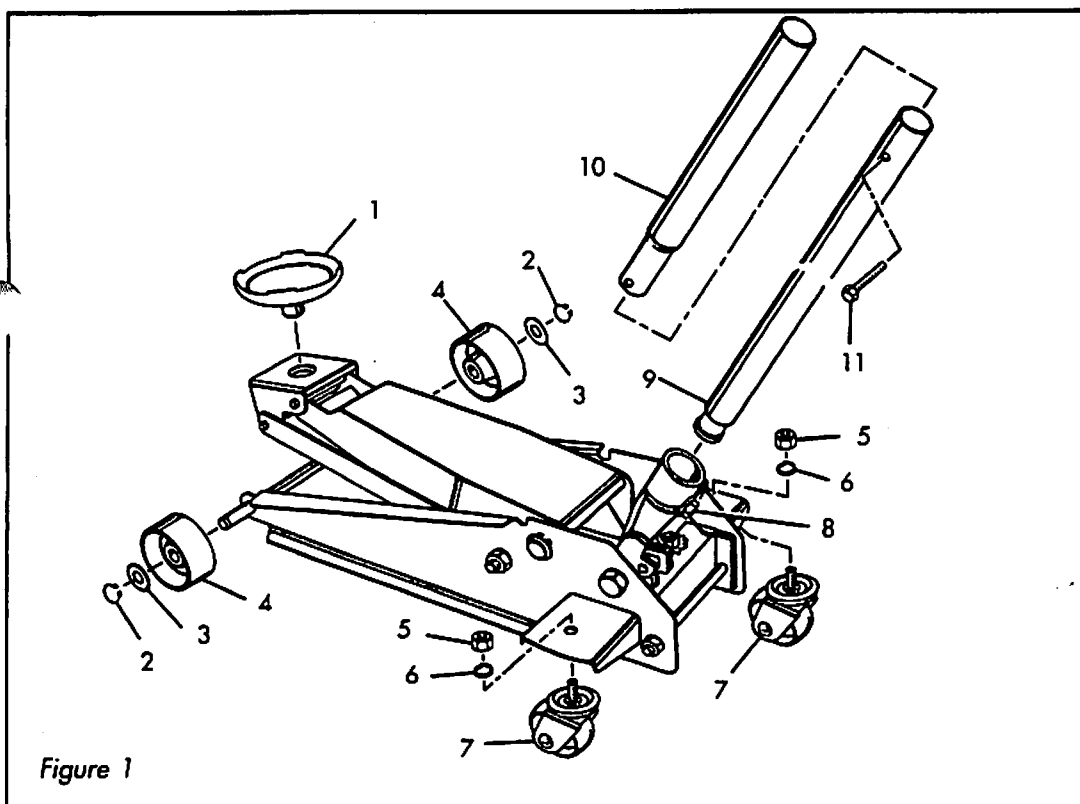

Figure 1

PARTS LIST

Item #	Description	Snap-On Part #	Item #	Description	Snap-On Part #
1	Saddle	SJ002-1	8	Handle Locking Bolt	SJ002-8
2	Snap Ring	SJ002-2	9	Lower Handle	SJ002-9
3	Washer	SJ002-3	10	Upper Handle	SJ002-10
4	Wheel	SJ002-4	11	Hex Screw	SJ002-11
5	Nut	SJ002-5	12	Hyd. Cylinder	SJ002-12
6	Lock Washer	SJ002-6	13	Cylinder Seal Kit	SJ002-13
7	Caster	SJ002-7			

WARNING!

READ ALL
INSTRUCTIONS
AND
WARNING
INFORMATION
BEFORE
OPERATION!

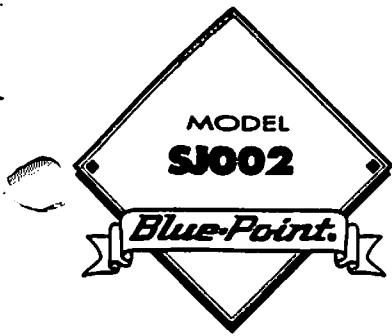

BEFORE USE

Air may become trapped in the hydraulic system during transit. To purge air:

1. Open release valve by turning handle counterclockwise.
2. Pump handle rapidly 4 full strokes. This will expel air that may have entered oil passages during transit.
3. Close release valve by rotating handle clockwise and pump handle.
4. If lift arm raises, jack is ready for use. If not, repeat this procedure.

OPERATING INSTRUCTIONS

IMPORTANT: Before attempting to raise a vehicle, check vehicle service manual for recommended lifting surfaces.

1. **To raise load:** Close release valve tightly (by turning handle clockwise) **DO NOT OVERTIGHTEN.** Position jack under load so that saddle will contact load firmly and load is centered so it cannot slip. Operate jack handle until saddle approaches the load. Once again check to see that saddle is correctly positioned. Raise load to desired height. Place jack stands of appropriate capacity under the vehicle. **DO NOT CRAWL UNDER VEHICLE WHILE LIFTING VEHICLE OR PLACING OR REMOVING JACK STANDS!** Place jack stands at vehicle manufacturer's recommended lift areas that provide stable support for the raised vehicle. Slowly turn the jack handle counterclockwise to lower the vehicle onto the jack stands. Lower the vehicle slowly so as not to shock load the jack stands. Once repairs are completed, raise vehicle enough to remove jack stands. Lower vehicle very slowly.
2. **To lower load:** Open Release Valve **VERY SLOWLY** (by turning handle counterclockwise.) When release valve is opened, saddle and load will be lowered.

CAUTION: Keep hands or feet away from the hinge mechanism of the jack.

MAINTENANCE

All moving joints require lubrication often. Remove handle and grease the lower end of handle where it rotates in the handle socket. Grease release valve gears. Using a grease gun, grease the lift arm pivot shaft grease fitting until grease appears at the end of the shaft. Oil all lift arm linkages, front wheels and rear casters.

IMPORTANT: When adding or replacing oil, always use a good grade hydraulic jack oil. **DO NOT** use brake fluid, alcohol, glycerine, detergent motor oil, or dirty oil as improper fluid can cause serious internal damage to jack.

To add oil: With saddle fully lowered and jack on level ground, remove Filler Plug (see Fig. 1). Oil should be filled to level of oil filler plug hole. If low, add oil as needed.

Maintenance and Inspection: The owner and/or user must maintain and inspect the jack in accordance with the manufacturer's instructions.

WARNING!

READ ALL
INSTRUCTIONS
AND
WARNING
INFORMATION
BEFORE
OPERATION!