

REPAIR PARTS LIST FOR MODEL PJ-21

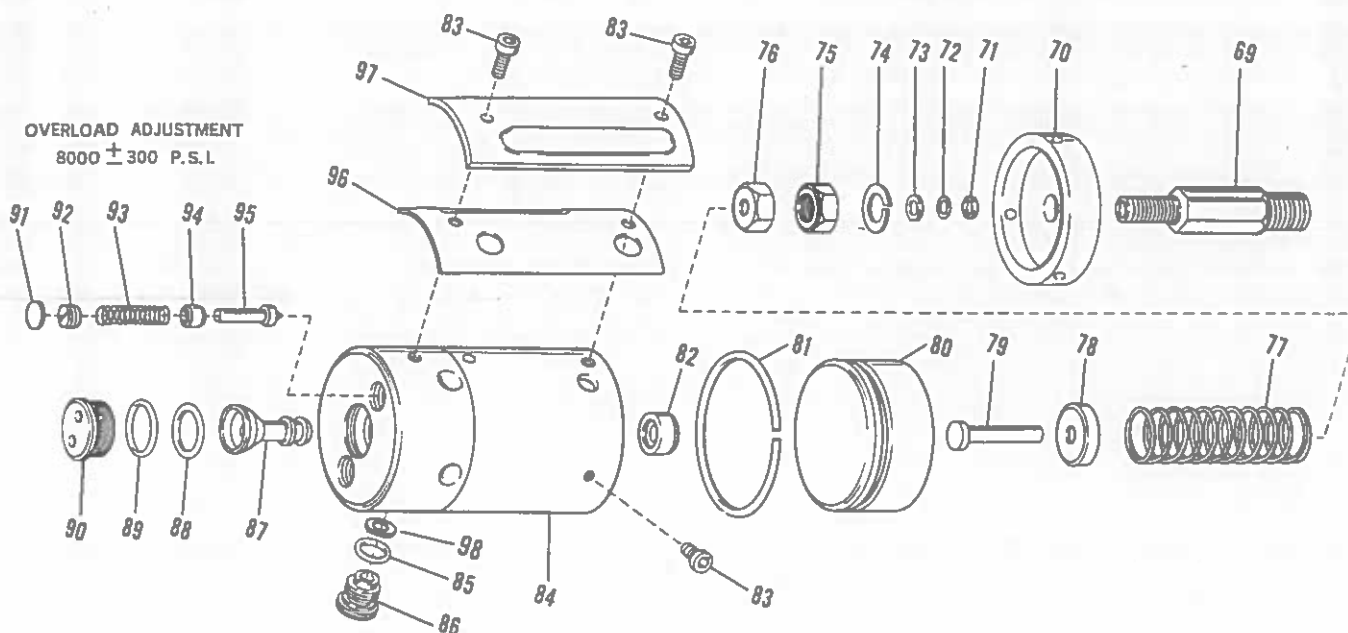

BEER KIT #7795 (AIR MOTOR, ONLY)

Item No.	Part No.	No. Req.	Description	Item No.	Part No.	No. Req.	Description
69	J387.190	1	Plunger Body	84	G497.900	1	Air Body and Sleeve
70	J380.101	1	Plate	*85	B839.503	1	"O" Ring
*71	J481.041	1	"O" Ring	86	J801.006	1	Plug
72	B712.562	1	Washer (Leather)	87	A8002.052	1	Stem
73	J999.039	1	Bearing	*88	B1224.503	1	"O" Ring
74	S8.222	1	Washer	*89	BL30126	1	"O" Ring
75	S38.181	1	Nut	90	B743.006-1	1	Plug
76	J893.055	1	Gland Nut	91	E725.006	1	Plug
77	B704.110	1	Spring	92	E726.028	1	Adjusting Screw
78	B703.108	1	Cap	93	E734.183	1	Spring
79	B702.040	1	Plunger	94	E724.039	1	Sleeve
80	B729.578	1	Piston	95	E735.416	1	Valve Stem
81	B713.491	1	Piston Ring	96	C323.037	1	Gasket
*82	F15.808	1	Seal	97	C82.098	1	Cover
83	B733.087	4	Screw	*98	B860.066	1	Washer "Poly"

NOTE: Orders for parts cannot be filled unless both model and serial number with prefix imprinted on nameplate are given.

WARRANTY

Blackhawk warrants its products against defects in workmanship and materials for 90 days from date of delivery to user. Chain is not warranted. Warranty does not cover ordinary wear and tear, abuse, misuse, overloading, altered products or use of improper fluid.

WARRANTY RETURN PROCEDURE

When question of warranty claim arises, the user should send his unit to the nearest Blackhawk Authorized Service Depot for inspection, transportation to be prepaid and evidence of purchase date furnished. If the claim comes under the terms of our warranty, the Authorized Service Depot will REPAIR OR REPLACE PARTS AFFECTED and return prepaid.

BLACKHAWK®

BLACKHAWK MFG. CO., MILWAUKEE, WIS. 53227 DIVISION OF APPLIED POWER INDUSTRIES, INC.