



Auxillary Stand

Operating Instructions & Parts Manual

Model Number	Capacity
BH5710	1500 Lbs
BH5715	1500 Lbs

SFA Companies ©2004
10939 N. Pomona Ave. Kansas City, MO 64153
816-891-6390
sales@blackhawk-automotive.com

- Before using this product, read this manual and follow all its Safety Rules and Operating Instructions

Made in PRC

TABLE OF CONTENTS

Warranty	P2
Save These Instructions	P3
Product Description	P3
Specifications	P3
Safety Instructions	P4
Assembly	P4
Operation	P5
Maintenance	P5
Replacement Parts	P5



ONE YEAR LIMITED WARRANTY

For a period of one (1) year from date of purchase, SFA Companies will repair or replace, at its option, without charge, any of its products which fails due to a defect in material or workmanship, or which fails to conform to any implied warranty not excluded hereby.

Performance of any obligation under this warranty may be obtained by returning the warranted product, freight prepaid, to SFA Companies Warranty Service Department, 10939 N. Pomona Ave., Kansas City, MO 64153. Except where such limitations and exclusions are specifically prohibited by applicable law:

- (1) THE CONSUMER'S SOLE AND EXCLUSIVE REMEDY SHALL BE THE REPAIR OR REPLACEMENT OF DEFECTIVE PRODUCTS AS DESCRIBED ABOVE.
- (2) SFA COMPANIES SHALL NOT BE LIABLE FOR ANY CONSEQUENTIAL OR INCIDENTAL DAMAGE OR LOSS WHATSOEVER.
- (3) THE DURATION OF ANY AND ALL EXPRESSED AND IMPLIED WARRANTIES, INCLUDING WITHOUT LIMITATION, ANY WARRANTIES OF MERCHANTABILITY AND FITNESS FOR A PARTICULAR PURPOSE, IS LIMITED TO A PERIOD OF ONE (1) YEAR FROM DATE OF PURCHASE.

Some states do not allow limitations on how long an implied warranty lasts, so the above limitation may not apply to you. Some states do not allow the exclusion or limitation of incidental or consequential damages, so the above limitation or exclusion may not apply to you. This warranty gives you specific legal rights, and you may also have other rights which vary from state to state.

SAVE THESE INSTRUCTIONS

For your safety, *read, understand, and follow* the information provided with and on this stand. The owner and operator of this equipment shall have an understanding of this stand and safe operating procedures before attempting to use. The owner and operator shall be aware that use and repair of this product may require special skills and knowledge. Instructions and safety information shall be conveyed in the operator's native language before use of this stand is authorized. If any doubt exists as to the safe and proper use of this stand, remove from service immediately. **Inspect before each use.** Do not use if there are broken, bent, cracked or damaged parts (including labels). Any stand that appears damaged in any way, or operates abnormally shall be removed from service immediately. If the stand has been or is suspected to have been subjected to a shock load (a load dropped suddenly, unexpectedly upon it), immediately discontinue use until stand has been inspected by a Blackhawk Automotive authorized service center. It is recommended that an annual inspection be done by qualified personnel. Labels and Operator's Manuals are available from manufacturer.

PRODUCT DESCRIPTION

Blackhawk Auxiliary Stands are intended to be used as a means of partial support for, and the positioning of, vehicle components during their installation/removal, but **not** for use in stabilizing or supporting vehicles. These are for use under a 2 or 4 post overhead vehicle lift or in a garage pit. Heavy gauge steel construction and compliance with the latest **ASME / ANSI - PALD** standards ensure safety, strength and stability.

DO NOT USE TO MOVE, SUPPORT OR DOLLY VEHICLES
DO NOT USE FOR ANY OTHER PURPOSE THAN THOSE OUTLINED ABOVE

SPECIFICATIONS

Model	Capacity	Base Diameter	Min. Height	Max. Sustained Height
BH5710	1500 Lbs	12"	53 5/8"	79 1/8"
BH5715	1500 Lbs	12"	53 3/8"	79"

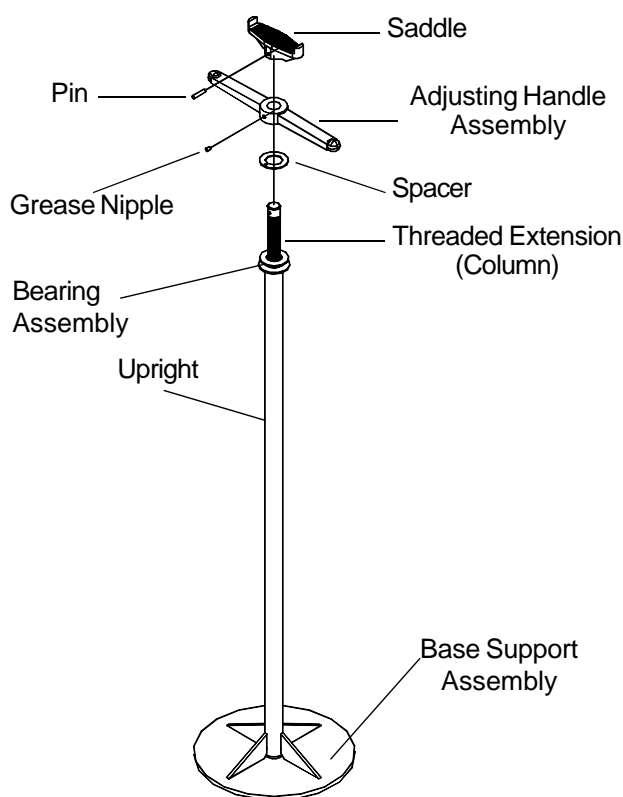

Figure 1 - Model BH5710 Components

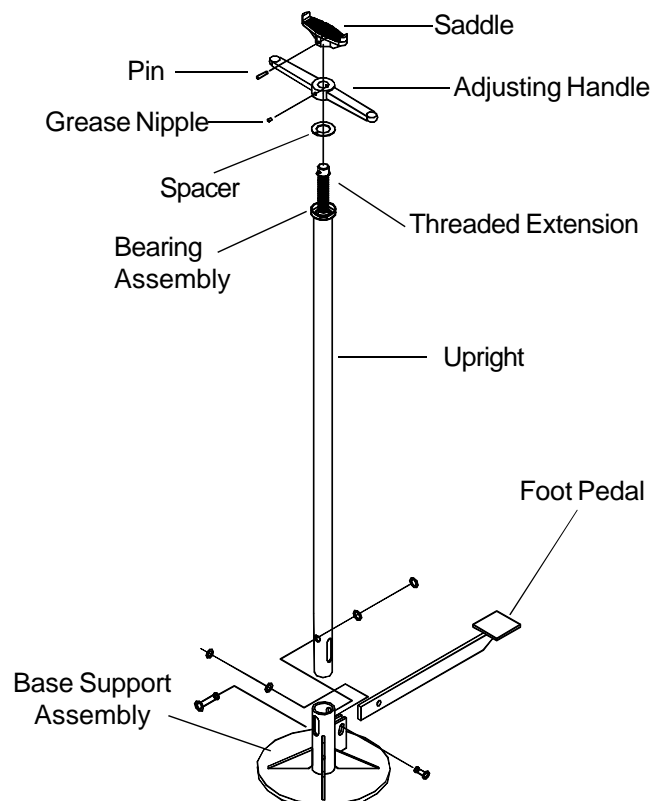

Figure 2 - Model BH5715 Components

SAFETY INSTRUCTIONS

BEFORE USE

1. Verify that the product and the application are compatible, if in doubt call Blackhawk Automotive Technical Service at (816) 891-6390.
2. Read the operator's manual completely and familiarize yourself thoroughly with the product, its components, and the potential hazards associated with its improper use **before** using this product.
3. Inspect before each use. Do not use if there are bent, broken or cracked components. Replace worn or damaged parts and assemblies with Blackhawk Authorized Replacement Parts only.

WARNING

- Study, understand, and follow all instructions before operating this device.
- Do not exceed rated capacity. Use only on hard, level surfaces.
- Adequately support the vehicle before starting repairs.
- Do not use to support or stabilize vehicle. Center load on saddle.
- Failure to heed these markings may result in personal injury and/or property damage.

! SAFETY MESSAGE !

This stand is intended to provide partial support of vehicle components during removal and installation. Be sure all tools and personnel are clear before lowering load. No alterations shall be made to this device. Only attachments and/or adapters supplied by the manufacturer shall be used.

ASSEMBLY

For Model **BH5710** (See Figure 1, Page 3)

1. Insert smaller end of threaded column through the bottom of upright, allowing small end of threaded column to project out of the top of upright.
2. Place bearing over threaded portion with upright/threaded column assembly in the horizontal position.
3. Spin adjusting handle clockwise onto threaded portion.
4. Insert roll pin through saddle & threaded column to fasten saddle.

For Model **BH5715** (See Figure 2, Page 3)

1. Insert smaller end of threaded column through the bottom of upright, allowing small end of threaded column to project out of the top of upright.
2. Place bearing over threaded portion with upright/threaded column assembly in the horizontal position.
3. Spin adjusting handle clockwise onto threaded portion.
4. Insert the roll pin through saddle & threaded column to fasten saddle.
5. Insert upright assembly onto base with slot in upright facing foot pedal mount.
6. Secure upright using the larger pin, washer and c-clip.
7. Insert pedal into slot and secure with remaining pin, washer, and c-clip.

OPERATION

Note: This product should NEVER be used to lift or lower a vehicle.

To Raise

1. Turn adjusting handle clockwise until saddle contacts load. Be sure to center load on saddle.
2. On Model BH5715, slight upward adjustment can be made to the saddle height by pressing downward on the foot pedal. This may or may not be necessary depending on the application. It is provided as a means of making temporary adjustments on load height without using your hands. This leaves your hands free to engage, handle and control the workpiece.

NOTE: DO not lower overhead lift in order to accommodate the stand. Contact with the desired vehicle component shall only be done by means of the vertical adjustments provided on the stand.

To Lower

Turn adjusting handle counterclockwise.

MAINTENANCE

Periodically inspect each stand. Ensure all parts move freely. Apply grease to fitting as needed. If rust appears, sand affected area and cover with suitable utility paint.

REPLACEMENT PARTS

Please refer to the Parts drawing on page 6 & 7 when ordering parts. Not all components of the stand are replacement items, but are illustrated as a convenient reference of location and position in the assembly sequence. When ordering parts, give Model number, serial number and description. Call or write for current pricing:

SFA Companies. 10939 N. Pomona Ave. Kansas City, MO 64153, U.S.A. Tel:(816)891-6390
Fax:(816)891-6599 E-Mail: sales@blackhawk-automotive.com

Model BH5710

Item #	Part #	Description	Qty
1	T45-6-0000-006	Saddle	1
2	T45-5-A000-0002	Adjusting Handle	1
3	GB3-0-1840-000	Bearing	1
-	BH5710-L0	Label	1
-	BH5710-M0	Manual	1

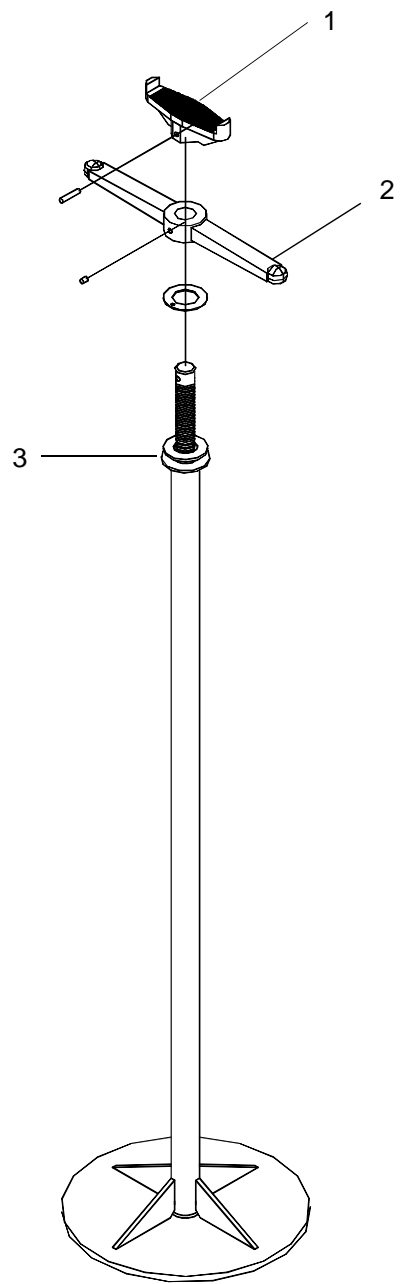

Figure 3 - Replacement Parts Illustration for model BH5710

Model BH5715

Item #	Part #	Description	Qty
1	T45-6-0000-006	Saddle	1
2	T45-5-A000-0002	Adjusting Handle	1
3	GB3-0-1840-000	Bearing	1
4	T45-6-0200-000	Foot Pedal	1
-	T45-6-0000-000	Hardware Kits	1
-	BH5715-L0	Label	1
-	BH5710-L0	Manual	1

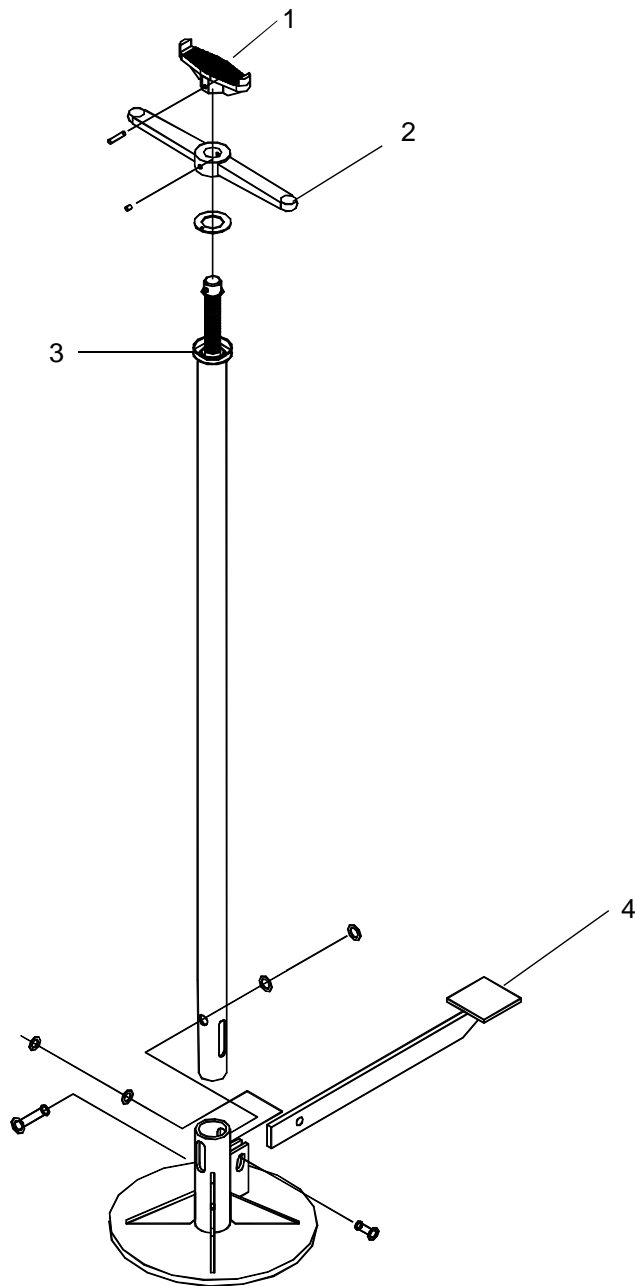

Figure 4 - Replacement Parts for models BH5715

[illegible]