

# BLACKHAWK

## LIFTING EQUIPMENT

### Repair Parts Information

Hydraulic Hand Jacks

MODELS TC-7-B & C, BA-85-F & G,  
AA-85-F & G, CB-9-E & F,  
D-87-G & H, EA-11-E & F

CAPACITY: 1½–20 TONS

NOTE  
CARRYING HANDLE IS INCLUDED AND  
WELDED TO RESERVOIR ON 12 & 20  
TON MODELS.

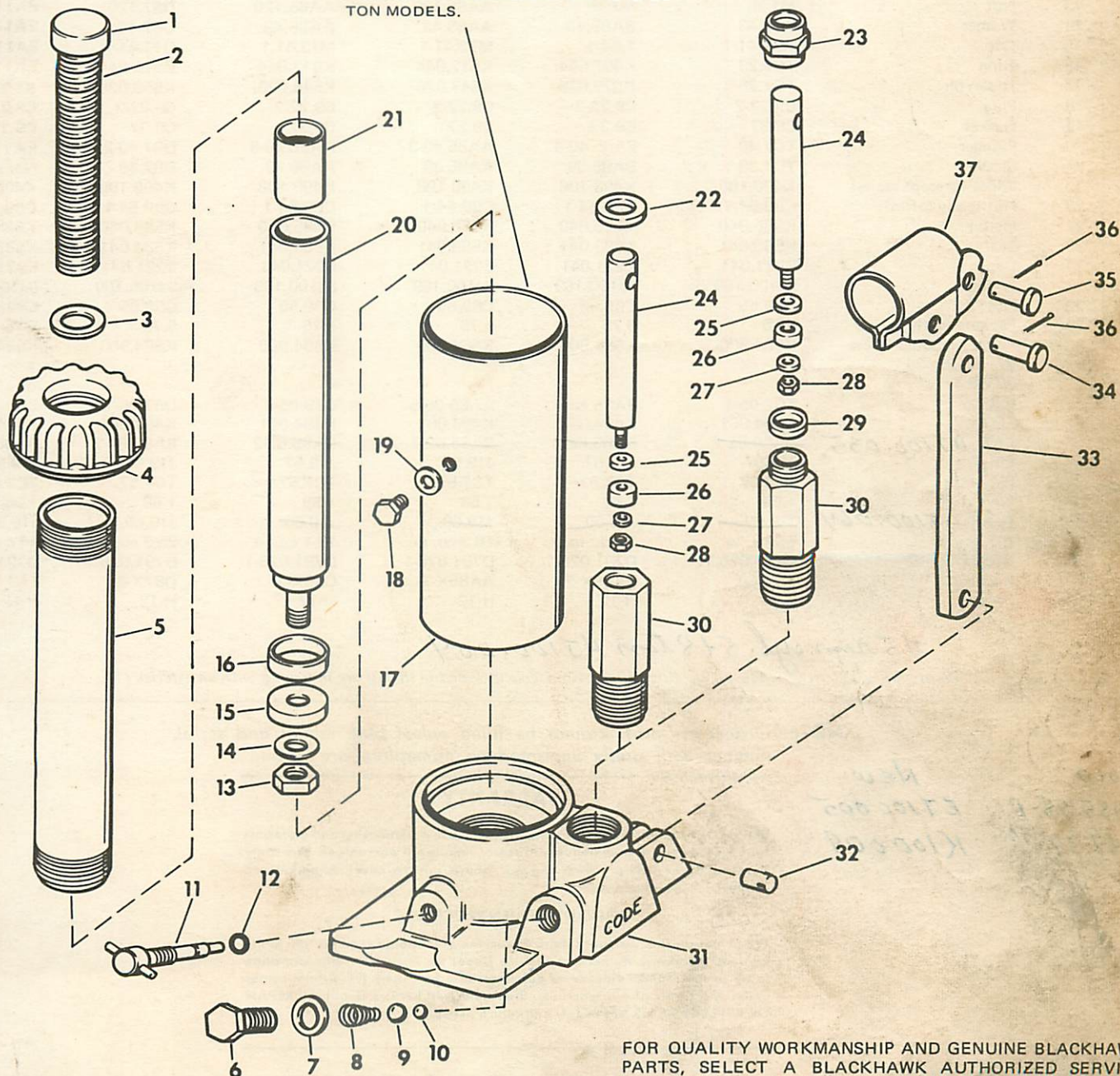

FOR QUALITY WORKMANSHIP AND GENUINE BLACKHAWK PARTS, SELECT A BLACKHAWK AUTHORIZED SERVICE DEPOT FOR YOUR REPAIR NEEDS. THE CLASSIFIED SECTION IN YOUR PHONE BOOK LISTS YOUR NEAREST AUTHORIZED SERVICE DEPOT.

USE ONLY LX-21 JACK OIL AND GENUINE FACTORY PARTS. USE OF OTHER HYDRAULIC FLUIDS OR NON-GENUINE PARTS VOIDS WARRANTY.

NEVER USE BRAKE FLUID.



# REPAIR PARTS LIST

ITEM NO.	DESCRIPTION	TC-7, B & C 1½ TON	BA-85, F & G 3 TON	AA-85, F & G 5 TON	CB-9, E & F 8 TON	D-87, G & H 12 TON	EA-11, E & F 20 TON
1	Saddle	Use Item 2	BA85.45-1	AA85.45-1	AA85.45-1	D87.45-3	EA11.45-2
2	Screw	TC7.28	BA85.28-1	<del>AA85.28-1</del>	AA85.28-1	D87.28-2	None
* 3	"O" Ring	W293.504	K514.041	D196.041	D196.041	K288.041	K568.041
4	Cap	AJ100.319	K527.020	K528.020	K529.020	K519.020	K520.020
5	Cylinder	TC7.30	BA85.30-3	<del>CB9.30-2</del>	<del>CB9.30-2</del>	D87.30-2	EA11.30-1
6	Plug	CB9.185-2	CB9.185-2	CB9.185-2	CB9.185-2	CB9.185-2	CB9.185-2
* 7	Gasket	B159.167	B159.167	B159.167	B159.167	B159.167	B159.167
* 8	Spring	BA85.183	BA85.183	BA85.183	BA85.183	BA85.183	BA85.183
* 9	5/16" Ball	S1.16	S1.16	S1.16	S1.16	S1.16	S1.16
*10	7/32" Ball	1.16	1.16	1.16	1.16	1.16	1.16
11	Valve	AJ10.059	AJ10.059	AJ10.059	AJ10.059	AJ10.059	AJ10.059
*12	"O" Ring	AJ100.312	AJ100.312	AJ100.312	AJ100.312	AJ100.312	AJ100.312
13	Nut	MJ.35	MJ.35	AA85.120	AA85.120	D87.120	EA11.120
14	Washer	TC7.43	BA85.43	AA85.43	AA85.43	D87.43	EA11.43-1
*15	Cup	TC7.41-1	1.41-1	M73.41-1	M73.41-1	D11.41-1	EA11.41-1
16	Ring	TC7.29	K497.044	K512.044	K512.044	K525.044	EA11.29-1
17	Reservoir	TC7.25	K379.025	K547.025	K548.025	K553.025	K559.025
18	Plug	C9.22-2	C9.22-2	C9.22-2	C9.22-2	C9.22-2	C9.22-2
*19	Gasket	C9.37	C9.37	C9.37	C9.37	C9.37	C9.37
20	Plunger	TC7.40	BA85.40-4	AA85.40-3	AA85.40-3	D87.40-2	EA11.40-2
21	Sleeve	TC7.39	BA85.39	AA85.39	AA85.39	D87.39	None
*22	Wiper (present series)	K498.108	K498.108	K498.108	K498.108	K498.108	K498.108
23	Nut (early series)	CB9.54-1	CB9.54-1	CB9.54-1	CB9.54-1	CB9.54-1	CB9.54-1
24	Piston	K585.040	K585.040	K585.040	K585.040	K585.040	K585.040
*25	Seal	K583.041	K583.041	K583.041	K583.041	K583.041	K583.041
*26	Cup	E221.041	E221.041	E221.041	E221.041	E221.041	E221.041
*27	Washer	SJ100.169	SJ100.169	SJ100.169	SJ100.169	SJ100.169	SJ100.169
*28	Nut	CB9.55	CB9.55	CB9.55	CB9.55	CB9.55	CB9.55
*29	Packing (early series)	5.75	5.75	5.75	5.75	5.75	5.75
30	Pump (includes items 22, 24, 25, 26, 27, 28,)	K584.900	K584.900	K584.900	K584.900	K584.900	K584.900
31	Base	TC7.05-1	BA85.05-4	AA85.05-5	CB9.05-4	D87.05-1	EA11.05-2
32	Pin	K494.061	K494.061	K494.061	K494.061	K494.061	K494.061
33	Link <i>AJ100.035</i>	<del>BA85.62-2</del>	<del>BA85.62-2</del>	<del>BA85.62-2</del>	<del>BA85.62-2</del>	BA85.62-2	BA85.62-2
34	Pin	J19.57	J19.57	J19.57	J19.57	J19.57	J19.57
35	Pin	TC7.57	TC7.57	TC7.57	TC7.57	TC7.57	TC7.57
*36	Pin	1.58	1.58	1.58	1.58	1.58	1.58
37	Beam <i>AJ100.064</i>	<del>J19.60</del>	<del>J19.60</del>	<del>J19.60</del>	<del>J19.60</del>	J19.60	J19.60
† 38	LX-21 Oil	5½ cu. in.	11 cu. in.	16.3 cu. in.	18.1 cu. in.	25.3 cu. in.	44 cu. in.
† 39	Decal (repair)	D791.026-1	D791.026-1	D791.026-1	D791.026-1	D791.026-1	D791.026-1
† 40	Repair Kit	TC7X-1	BA85X-2	AA85X-2	CB9X-1	D87X-2	EA11X-2
† 41	Handle	H-12	H-12	H-12	H-12	H-12	H-12

† Not Shown.

For economical maintenance order the repair kit specified (item 40). Items included in the kit are indicated with an asterisk (\*).

**NOTE:** Orders for parts cannot be filled unless both model and serial number with prefix imprinted on nameplate are given.

## WARRANTY

Blackhawk warrants its products against defects in workmanship and materials for 90 days from date of delivery to user. Chain is not warranted. Warranty does not cover ordinary wear and tear, abuse, misuse, overloading, altered products or use of improper fluid.

### WARRANTY RETURN PROCEDURE

When question of warranty claim arises, the user should send his unit to the nearest Blackhawk Authorized Service Depot for inspection, transportation to be prepaid and evidence of purchase date furnished. If the claim comes under the terms of our warranty, the Authorized Service Depot will REPAIR OR REPLACE PARTS AFFECTED and return prepaid.

# BLACKHAWK®

BLACKHAWK MFG. CO., MILWAUKEE, WIS. 53227 DIVISION OF APPLIED POWER INDUSTRIES, INC.