

BLACKHAWK®

repair parts

MODELS SJ-52 & SJ-62
AIR OPERATED ONE-END LIFTS

CAPACITY — 3000 LBS.

Issued June, 1965

Intake Valve Assembly (19)
is OBSOLETE - No Parts
Are Available

NEW VERSION AIR VALVE

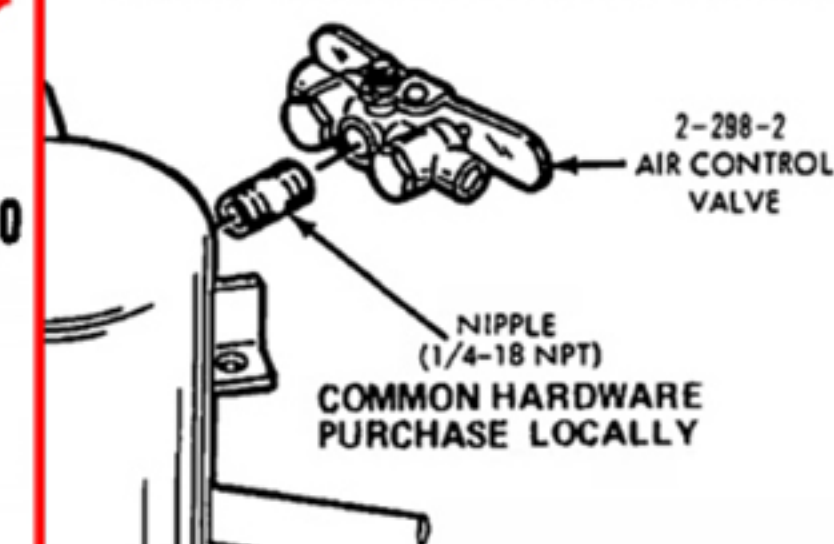

EXHAUST VALVE ASS'Y.

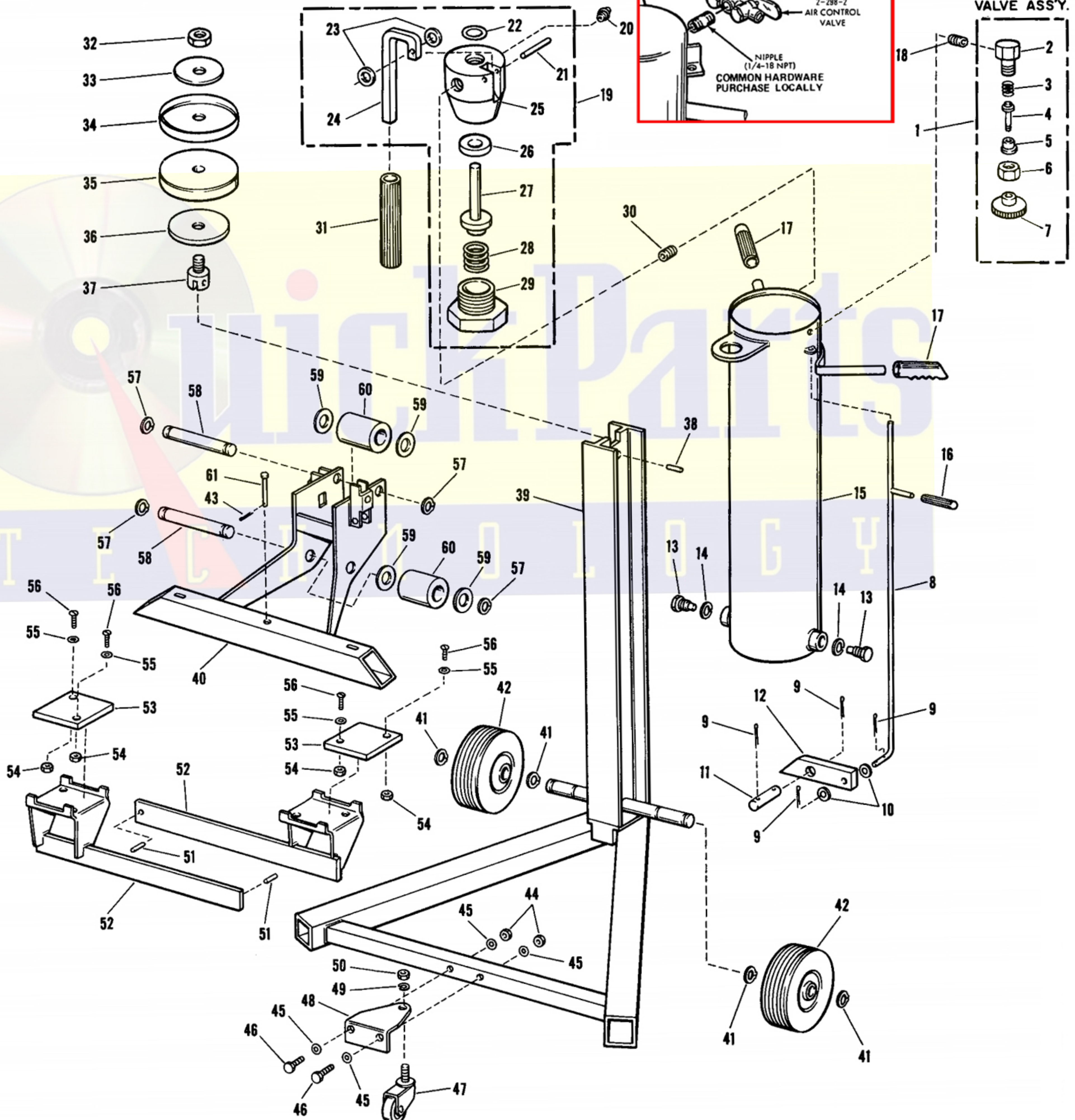

PARTS LIST FOR MODELS SJ-52 and SJ-62

AIR OPERATED ONE-END LIFTS

Item	SJ-52 Part No.	SJ-62 Part No.	No. Req.	Description	Item	SJ-52 Part No.	SJ-62 Part No.	No. Req.	Description
1	E514.900	E514.900	1	Exhaust Valve Assembly	36	E544.108	E544.108	1	Piston Washer
2	E515.580	E515.580	1	Valve Body	37	E545.305	E545.305	1	Stud (Special)
3	E516.183	E516.183	1	Spring	38	E546.061	E546.061	1	Roll Pin
4	E519.010	E519.010	1	Valve Spindle	39	E521.900	E583.900	1	Frame Weldment
5	E517.290	E517.290	1	Valve Seat	40	E552.900	E552.900	1	Elevator Weldment
6	E518.020-1	E518.020-1	1	Valve Cap	41	B557.523	B557.523	4	Retaining Ring
7	E520.550	E520.550	1	Knob	42	E540.106	E587.106	2	Wheel
8	E559.550	E574.900	1	Release Rod	*43	1.58	1.58	1	Cotter Pin
*9	K18.58	K18.58	4	Cotter Pin	44	SJ100.230	SJ100.230	2	Hex Nut
10	BA85.43	BA85.43	2	Plain Washer	45	D215.108	D215.108	4	Washer
11	E565.061	E565.061	1	Safety Latch Pin	46	B874.028	B874.028	2	Capscrew
12	E542.817	E542.817	1	Safety Latch	47	E543.154	E543.154	1	Caster
13	E539.305	E539.305	2	Stud, Special	48	E536.111	E536.111	1	Bracket
14	S4.180	S4.180	2	Lockwasher	49	S4.139	S4.139	1	Lockwasher
15	E567.900	E581.900	1	Tank Weldment	50	D891.055	D891.055	1	Hex Nut
16		E657.268	1	Grip (Release Rod)	51	SJ100.076	SJ100.076	2	Roll Pin
17		E709.550	2	Grip (Handle)	52	E549.900	E549.900	2	Saddle Bar Weldment
18	E566.431	E566.431	1	Pipe Nipple	53		E584.045	2	Saddle Pad
19	E527.900	E527.900	1	Intake Valve Ass'y.	54		E698.055	4	Hex Nut
20	D609.165	D609.165	1	Air Chuck Inflator	55		A644.052	4	Washer
21	E531.061	E531.061	1	Roll Pin	56		E198.028	4	Screw
*22	B709.503	B709.503	1	O-Ring	57	A434.523	A434.523	4	Retaining Ring
23	E535.108	E535.108	2	Washer	58	E538.104	E538.104	2	Shaft
24	E530.157	E530.157	1	Lever	59	E537.108	E537.108	4	Thrust Washer
25	E528.580	E528.580	1	Valve Body	60	E562.900	E562.900	2	Roller
26	E534.290	E534.290	1	Valve Seat	61	SJ100.049	SJ100.049	1	Stop Pin
27	E532.010	E532.010	1	Valve Spindle	†62	B155.026	B155.026	1	Nameplate
28	E533.183	E533.183	1	Spring	†63	W78.03	W78.03	2	Drive Screw
29	E529.277	E529.277	1	Spring Housing	†64	E585.026	E586.026	1	Decal (Ident.)
30	FZ-1607	FZ-1607	1	Pipe Nipple	†65	E704.026	E704.026	1	Decal (Caution)
31		E656.268	1	Grip (Intake Valve Handle)		SJ52K	SJ52K		*Jack/Saver Kit
32	D253.055	D253.055	1	Hex Jam Nut	*Items included in Jack/Saver Kit. †Parts Not Shown				
33	E541.108	E541.108	1	Cup Washer					
*34	E547.041	E547.041	1	Cup					
35	E548.040	E548.040	1	Piston					

NOTE: Orders for parts cannot be filled unless both model and serial number with prefix imprinted on nameplate are given.

FRANCHISED SERVICE DEPOTS



For quality workmanship and genuine Blackhawk parts select a Franchised Blackhawk Service Depot for your repair work. Only repairs performed by a Franchised Service Depot displaying this official sign are backed with full factory guarantee. The Classified Section in your Phone Book lists your nearest Franchised Service Depot.

GUARANTEE

Blackhawk guarantees its Products against defects in workmanship and materials for 90 days from date of delivery to the user. Only exception is chain, which follows the trade custom of its manufacturers and cannot be guaranteed. When question of warranty arises, the user should send his unit to the nearest Blackhawk Franchised Service Depot for inspection, transportation to be prepaid and evidence of purchased date furnished. If the difficulty comes under the terms of our guarantee, the Franchised Service Depot will repair or replace parts affected and return prepaid. Our guarantee does not cover ordinary wear and tear, abuse, misuse, overloading, altered products or use of improper fluid.

PARTS, SERVICE INFORMATION AND THE ADMINISTRATION OF FRANCHISED SERVICE DEPOTS FOR BLACKHAWK PRODUCTS IS PROVIDED BY —

BLACKHAWK SERVICE

MILWAUKEE, WISCONSIN 53246

DIVISION OF APPLIED POWER INDUSTRIES, INC.

Please direct all Service Correspondence to **BLACKHAWK SERVICE**