

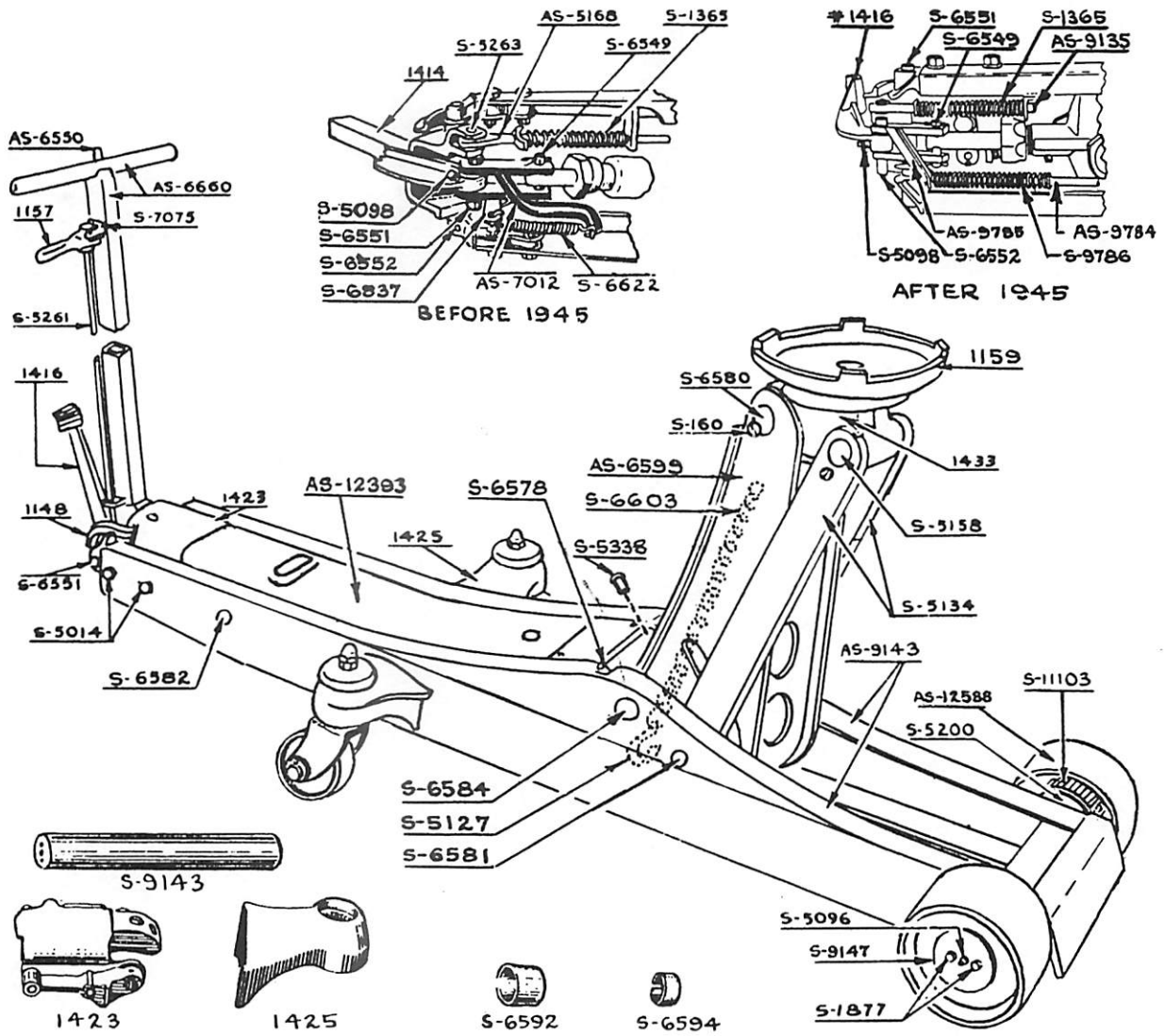

PARTS SHEET
MODEL D-6900
CAPACITY 10 TON
 December 1, 1961

FRAME AND LIFTING ARM ASSEMBLIES



HANDLE ASSEMBLY

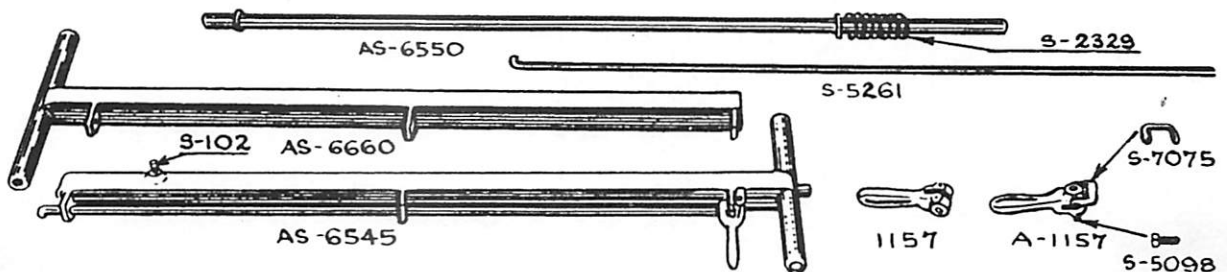

10-TON SERVICE JACK

CUP LEATHERS, PACKINGS, GASKETS, AND FOLLOWERS

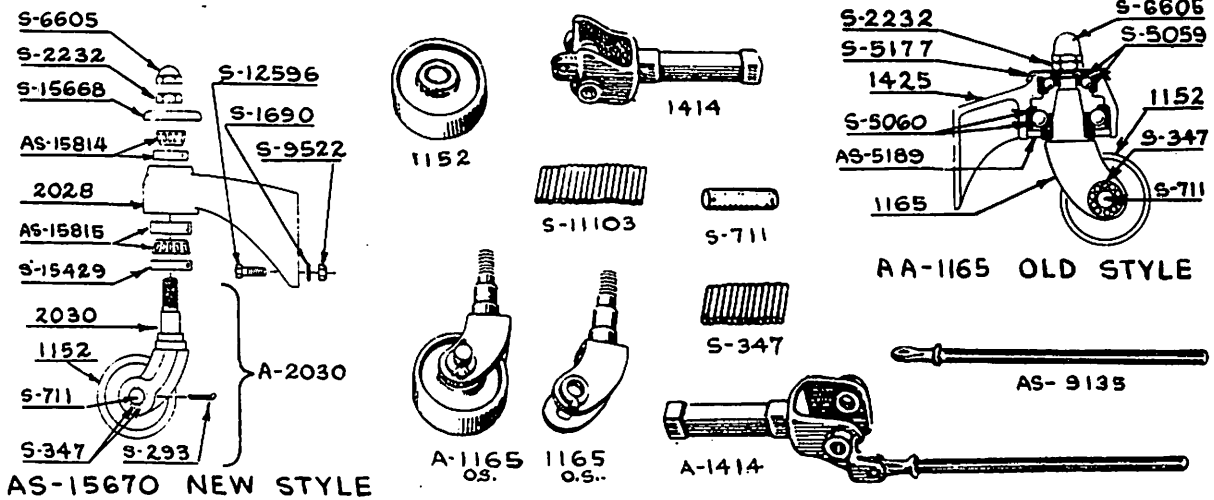

PUMP LINK ASSEMBLIES, OLD AND NEW STYLE AND SPRINGS

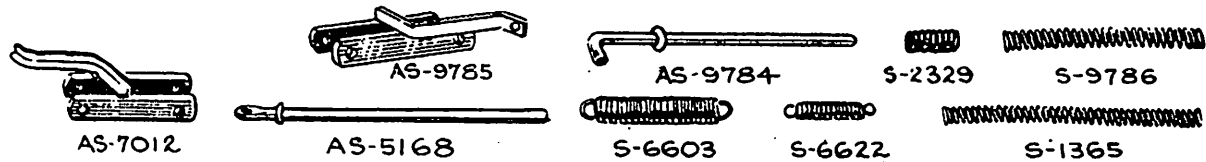

PINS, SCREWS, RIVETS AND WASHERS

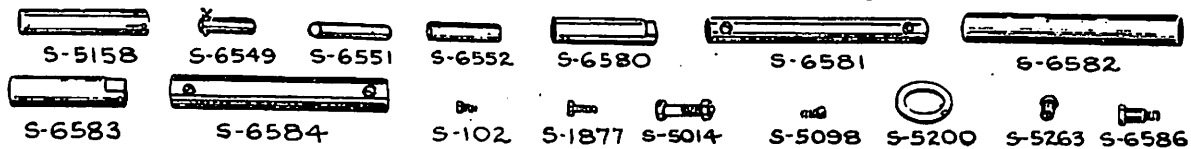

MISCELLANEOUS CASTINGS AND MISCELLANEOUS STEEL PARTS

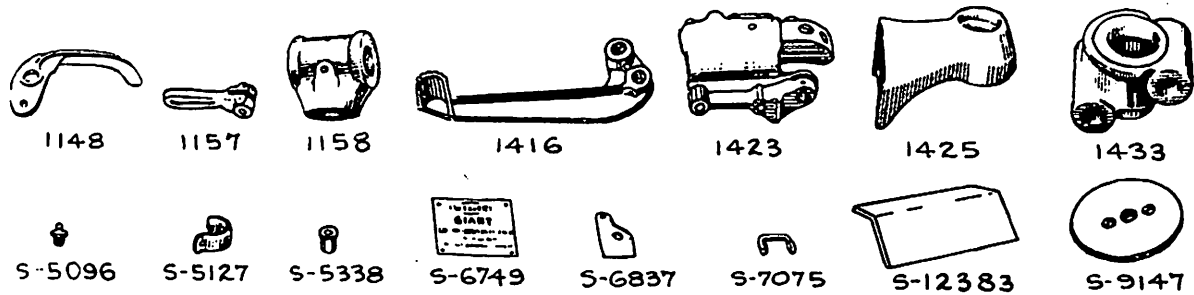

CASTINGS

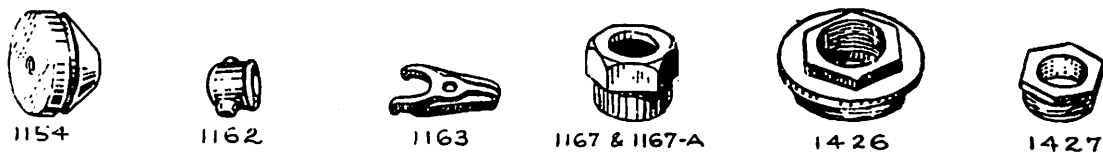

MISCELLANEOUS STEEL PARTS

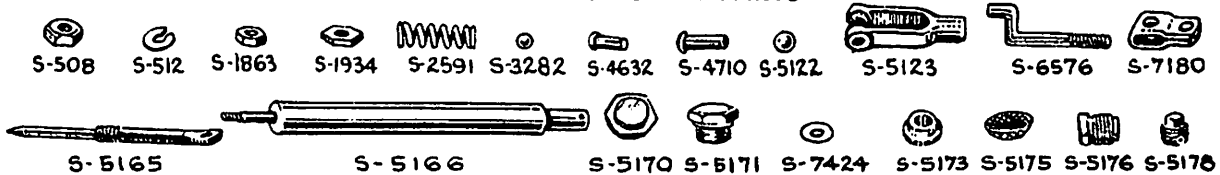

10-TON SERVICE JACK

CUP LEATHERS, PACKINGS, GASKETS, AND FOLLOWERS

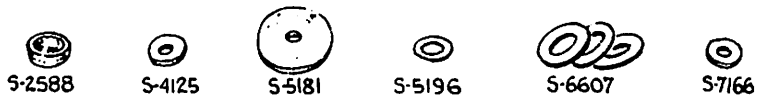

5-547 CYLINDER KIT

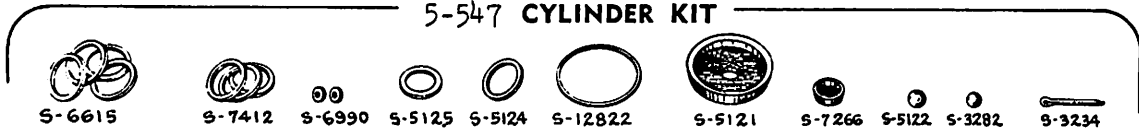

ASSEMBLIES AND STEEL PARTS

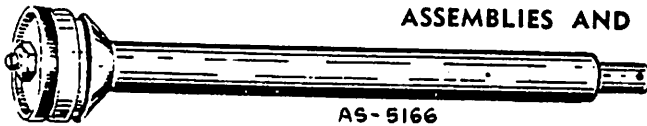

AS-5166

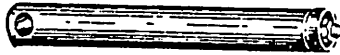

AS-7165

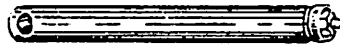

AS-7421

Showing S-2497 Welch Plug and S-13558 Alnico Magnet, replacing S-5170 Clean-out plug. Since July 1, 1952

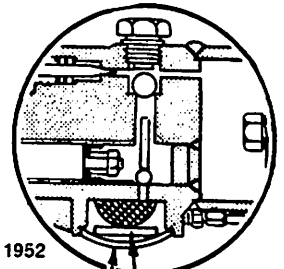

S-2479 S-13558

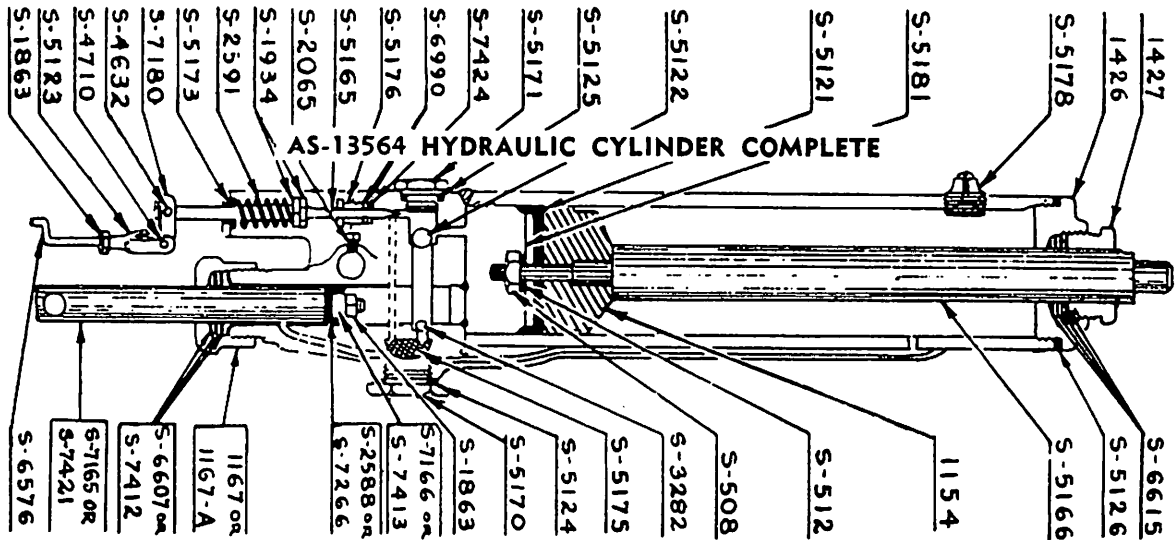

AS-13564 HYDRAULIC CYLINDER COMPLETE

* SPECIAL NOTE — The above Hydraulic Cylinder has been manufactured with two different size Pump Plungers, viz: $\frac{3}{8}$ " Diameter and 1" Diameter. When ordering Pump Plunger, Pump Cup Leather or Pump Packing, check size of present Plunger and order parts corresponding to this size.

PART NO.	DESCRIPTION
S- 102	Set Screw 3/8-16 x 3/4
S- 160	Mach. Screw 1/4-20 x 3/8 Rd. Head
S- 293	Cotter
S- 347	Roller Bearing for Caster Axle, Set of 13
S- 508	Hex. Nut 1/2-13
S- 512	Lock Washer 1/2 x 11/64 x 1/8
S- 711	Axle (For Caster Wheel)
1148	Release Lever
1152	Caster Wheel
1154	Ram Head
1157	Release Handle
A- 1157	Release Handle Complete
1158	Crosshead
1159	Saddle
1165	Caster Yoke (Old Style)
A- 1165	Caster Yoke and Wheel Assemblies (Old Style)
AA- 1165	Caster Assembly Complete (Old Style)

10-TON SERVICE JACK

PART NO.	DESCRIPTION
S- 5338	Gits Oil Cup
S- 5355	Intake Ball Weight
AS- 6545	Handle Assembly Complete
S- 6549	Pump Plunger Pin $\frac{5}{8}$ " x $2\frac{3}{8}$ "
AS- 6550	Lock Rod Assembly
S- 6551	Handle Pin $\frac{3}{4}$ " x $6\frac{1}{2}$ "
S- 6552	Foot Lever Pin $\frac{3}{4}$ " x $3\text{-}3/16$ "
S- 6576	Release Pull Rod
S- 6578	Sector Pin Retainer
S- 6580	Short Lifting Arm Pin $1\text{-}1/8$ " x $4\text{-}9/16$ "
S- 6581	Long Parallel Bar Pin $1\text{-}1/8$ " x $9\text{-}3/8$ "
S- 6582	Cylinder Pin $1\text{-}1/4$ " x $9\text{-}1/2$ "
S- 6583	Crosshead Pin $1\text{-}5/16$ " x 5" (for 1158)
S- 6584	Sector Pin $1\text{-}1/2$ " x $9\text{-}1/2$ "
S- 6586	Release Lever Pin $7/8$ " x $1\text{-}13/16$ "
S- 6592	Lifting Arm Bearing
S- 6594	Spacer for Lifting Arm Bearing
AS- 6599	Lifting Arm Assembly
S- 6603	Sector Spring
S- 6605	Acorn Nut $3/4\text{-}16$
S- 6607	Piston Packing for 1" Piston (Set of 3)
S- 6615	Ram Packing 4 Rings (Set of 4)
A- 6615	Complete Set Cup Leathers and Packing
S- 6622	Pump Piston on Foot Lever Spring (Old Style)
AS- 6660	Handle Tube and Cross Bar Assembly
S- 6749	Name Plate
S- 6837	Bracket for S-6622 Spring
S- 6990	Release Valve Packing (2 Per Set)
AS- 7012	Pump Link Assembly (Old Style)
S- 7075	Release Lock
S- 7076	Release Lock Pin $1/4$ " x $7/16$ "
AS- 7165	Pump Plunger Assembly 1" diameter
S- 7166	Followers for Plunger Cup Leather (used with AS-7165)
S- 7180	Release Valve Extension
S- 7266	Pump Cup Leather $7/8$ "
S- 7412	Piston Packing (Set of 3)
S- 7413	Follower for Plunger Cup Leather (used with AS-7421)
S- 7421	Pump Piston $7/8$ " diameter
AS- 7421	Pump Piston Assembly $7/8$ " diameter
S- 7424	Release Packing Ring
AS- 9135	Handle Return Spring Guide Assembly
S- 9143	Front Axle
AS- 9143	Frame Assembly
S- 9147	Front Wheel Retainer
S- 9149	Inside Wheel Washer
S- 9522	Hex Nut
AS- 9784	Piston Return Rod Assembly
AS- 9785	Pump Link Assembly, New Style
S- 9786	Piston Return Spring
S-11103	Front Wheel Bearing
AS-12393	Cover Plate Assembly
AS-12588	Front Wheel Assembly ($7\frac{1}{2}$ ")
S-12596	Cap Screw $1/2$ " x 1"
S-12822	Cylinder Gasket
S-13558	Alnico Magnet
AS-13564	Cylinder Assembly Complete
S-15429	Bearing Retainer Closure
S-15668	Caster Bearing Cap
AS-15670	Caster Assembly Complete (Less Caster Bracket, Cap Screws, Washers and Nuts)
AS-15814	Upper Bearing
AS-15815	Lower Bearing

10-TON SERVICE JACK

PART NO.	DESCRIPTION
1167A	Pump Packing Nut $\frac{7}{8}$ "
1167	Piston Packing Nut 1"
S- 1365	Handle Return Spring
1414	Handle Yoke
A- 1414	Handle Yoke Assembly
1416	Foot Lever
1423	End Frame Tie
1425	Caster Bracket (Welded to Jack Frame)
1426	Cylinder Cap
1427	Piston Packing Nut
1433	Saddle Bracket
S- 1690	Lock Washer
S- 1863	Hex. Nut 5/16 - 24
S- 1877	Cap Screw Hex. Hd. 1/4 - 20 x 3/4
S- 1921	Hex. Nut 1/4 - 20
S- 1934	Hex. Jam Nut 3/8 - 16 (2 used)
2028	Caster Bracket (Bolted to Jack Frame)
2030	Caster Yoke
A-2030	Caster Yoke and Wheel Assembly (Includes S-293, S-347, S-711, 1152, and 2030)
S- 2232	Hex. Jam Nut 3/4 - 16
S- 2329	Lock Return Spring
S- 2497	Welch Plug
S- 2588	Cup Leather for 1" Piston
S- 2501	Release Spring
S- 2918	3 8 Ball Intake Valve
S- 3234	Cotter 3/16" x 2"
S- 3282	7 16 Ball
S- 4125	Follower for Plunger Cup Leather (used only with S-5166)
S- 4401	Set Screw 3/8 - 16 x 5/8
S- 4632	Pull Rod Pin $\frac{3}{8}$ " x 29/32"
S- 4710	Release Yoke Pin $\frac{3}{8}$ " x 1-1/8"
S- 5014	Cap Screw — Hex. Hd. 1/2 - 13 x 2-3/4
S- 5059	Upper Caster Bearing
S- 5060	Lower Caster Bearing
S- 5096	Grease Fitting
S- 5098	Set Screw 1/4 - 20 x 5/8
S- 5121	Cup Leather
S- 5122	Upper Ball Valve 5 8
S- 5123	Adjustable Yoke
S- 5124	Clean Out Plug Gasket
S- 5125	Ball Chamber Plug Gasket
S- 5127	Lifting Arm Spring Hook
S- 5134	Parallel Arm
S- 5158	Parallel Arm Pin 1-1/8" x 5-17/32"
S- 5165	Release Valve
S- 5166	Ram
AS- 5166	Ram Assembly
AS- 5168	Guide Rod for Handle Spring S-1365
S- 5170	Clean Out Plug
S- 5171	Ball Chamber Plug
S- 5173	Release Valve Guide
S- 5175	Screen
S- 5176	Release Packing Nut
S- 5177	Caster Bearing Cap
S- 5178	Filler Plug
S- 5181	Ram Cup Washer
AS- 5189	Felt Washer Assembly
S- 5196	Intake Connector Gasket
S- 5200	Inside Hub Washer
S- 5261	Release Rod
S- 5263	Rivet Thru AS-9135

SERVICE AND MAINTENANCE INSTRUCTIONS

TO SERVICE

1. Keep all working parts thoroughly lubricated. Oil should be placed regularly in the oil hole at the base of the lifting arm, and also in the oil hole in the cross head (see diagrams). Oil should also be put in the handle pivot and foot pedal.
2. Packing nuts at the piston and pump plunger should be kept moderately tight. These packings are NOT under high pressure, and should only be tight enough to prevent leakage.
3. Ball valves may be removed for inspection and cleaning by removing the Valve Plug and turning the jack on its side, when they will roll out.

IMPORTANT: Whenever it is necessary to loosen or remove the Valve Plug, the gasket should be replaced with a new one. Oil leakage at this point is usually caused by trying to use an old gasket over again.

4. If pumping fails to raise the load, the lower ball valve is leaking, and it should be inspected for dirt or other obstruction.
5. If the load raises on the down stroke of the handle and immediately settles back, forcing up the handle, it shows the upper ball valve is leaking.
6. The screen may be cleaned by removing the plug on the under side of the cylinder head, directly opposite the valve plug. With plenty of oil in the cylinder a clogged screen is indicated when the foot lever or handle works freely up and down without raising the saddle, and offering no resistance to pumping.
7. Make sure that the gasket under clean-out plug is VERY tight. Air leakage at this point will cause jack to work only on half stroke of handle.
8. Pumping only on a half stroke of the handle may also be caused by a loose piston packing nut. Be sure this nut is kept tight.

TO RELIEVE WHEN AIR-BOUND

1. Should the oil supply run too low, or in case of air leakage at the Clean Out Plug, the jack may become air-bound and work on only a half stroke of the handle. Fill the jack with oil, raise the saddle, and then lower the saddle while holding the foot pedal depressed. This will flush out any air in the system, and excess oil may run out of the vent. Be sure jack is properly filled with oil before putting it back in service.

TO REFILL

Remove the filler plug and with the saddle DOWN pour in recommended Hydraulic Jack Oil until level comes up to the "FULL" mark on the oil bayonet attached to the Filler Plug. Do not fill above this level; too much oil will cause excess to spurt out the vent hole as jack is raised. Insufficient oil causes jack to lift only part way. Always be sure to put in oil only when the saddle is down. Be careful not to let any dirt get into the reservoir while the Filler Plug is out.

TO REPLACE CUP LEATHERS

1. After removing the cylinder unit as described above, place it in a vise. Note that the vise jaws should grip the forging, not the steel cylinder. Set the unit in the vise with the forging downward, and the steel cylinder and piston up.
2. Unscrew the cylinder cap and lift the piston out of the cylinder.
3. Remove the nut and washer which holds the leather at the end of the piston; put in the new leather, and replace nut and washer.
4. In fitting the new leather into the cylinder, use great care as the leather passes the filler plug hole, not to cut or otherwise damage the leather. Then replace the cylinder cap.
5. To replace the small cup leather on the pump, turn the cylinder unit pump end upward in the vise.
6. Unscrew the packing nut and pull out the pump plunger. Remove the nut that holds cup leather to end of plunger; insert new leather, and replace nut.
7. Be careful not to force the cup leather through the packing nut, as this will damage the leather. Instead, slip the packing nut over the plunger from the other end. Replace plunger and tighten packing nut moderately — just enough to prevent leakage.

Auto Specialties Manufacturing Company, St. Joseph, Michigan, U.S.A.