

AUTO SPECIALTIES MFG., CO.

ST. JOSEPH, MICHIGAN 49085

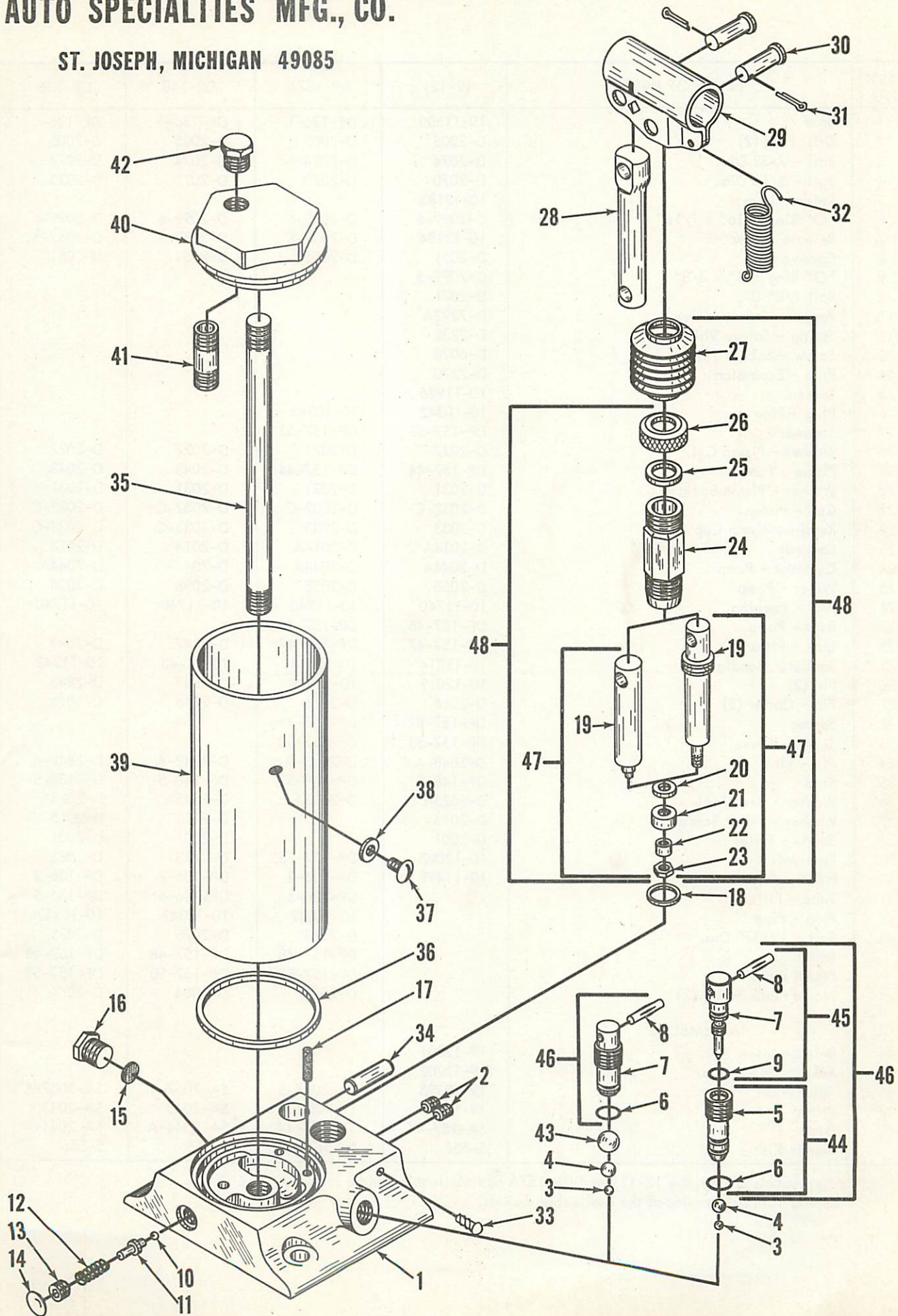

ITEM NO.	NAME OF PART	12-121	DP-157A	DP-148	DP-136
1	Base	10-11500	DP-136-1	DP-136-1	DP-136-1
2	Drill Plug (2)	D-2005	D-2005	D-2005	D-2005
3	Ball - 7/32 Dia.	D-2074	D-2074	D-2074	D-2074
4	Ball - 5/16 Dia.	D-2070	D-2070	D-2070	D-2070
5	Release Insert	10-12183			
6	"O" Ring 5/16" x 7/16"	D-2099-6	D-2099-6	D-2099-6	D-2099-6
7	Release Screw	10-12184	D-2057-S	D-2057-S	D-2057-S
8	Groove Pin	D-2051	D-2051	D-2051	D-2051
9	"O" Ring 1/4" x 3/8"	D-2099-5			
10	Ball 1/8" Dia.	D-2071			
11	Poppet - Safety Valve	D-7292A			
12	Spring - Safety Valve	D-7232			
13	Screw - Socket Set	D-6078			
14	Plug - Expansion	D-7270			
15	Screen	10-11986			
16	Plug - Pipe	10-10342	10-10342		
17	Strainer	DP-157-52	DP-157-52		
18	Washer - Piston Cyl.	D-2027	D-2027	D-2027	D-2027
19	Piston - Pump	DP-157-44	DP-157-44	D-2043	D-2043
20	Washer - Piston Backup	D-2031	D-2031	D-2031	D-2031
21	Cup - Piston	D-2032-C	D-2032-C	D-2032-C	D-2032-C
22	Retainer Piston Cup	D-2033	D-2033	D-2033-C	D-2033-C
23	Locknut	D-2014A	D-2014A	D-2014	D-2014
24	Cylinder - Pump	D-2044A	D-2044A	D-2044A	D-2044A
25	Wiper - Pump	D-2058	D-2058	D-2058	D-2058
26	Nut - Packing	10-11740	10-11740	10-11740	10-11740
27	Boot - Pump	DP-157-46	DP-157-46		
28	Link - Piston	DP-157-47	DP-157-47	D-2547	D-2547
29 *	Socket - Handle	10-12014	10-12014	10-11743	10-11743
30	Pin (2)	10-12019	10-12019	D-2845	D-2845
31	Pin - Cotter (2)	D-2016	D-2016	D-2016	D-2016
32	Spring	DP-157-49	DP-157-49		
33	Screw - Drive	DP-157-53	DP-157-53		
34	Pin - Link	D-2848-A	D-2848-A	D-2848-A	D-2848-A
35	Stud	DP-148-5	DP-148-5	DP-148-5	DP-136-5
36	Washer - Res. Seal	D-2625A	D-2625A	D-2625A	D-2625A
37	Washer - Filler Screw	D-2015		D-2015	D-2015
38	Screw - Filler	D-2001		D-2001	D-2001
39	Reservoir	10-12083	DP-157-23	D-2723	D-2623
40	Head - Reservoir	10-11499	DP-136-2	DP-136-2	DP-136-2
41	Tube - Filler		DP-136-6	DP-136-6	DP-136-6
42	Plug - Pipe		10-10342	10-10342	10-10342
43	Ball - 13/32" Dia.		D-2075	D-2075	D-2075
	Label		DP-157-48	DP-157-48	DP-157-48
	Name Plate		DP-157-50	DP-157-50	DP-157-50
	Name Plate Screw (2)		D-2084	D-2084	D-2084
	ASSEMBLIES				
44	Release Insert Sub.	19-12201			
45	Release Screw Sub.	19-12202			
46	Release	19-12395	SA-2057-S	SA-2057-S	SA-2057-S
47	Piston	19-10001	19-10001	SA-2043	SA-2043
48	Pump	SA-157-44	SA-157-44	SA-2044-A	SA-2044-A
	Repair Kit	5-556	5-556	5-556	5-556

*Earlier models of both the 12-121 and DP-157A had Malleable handle sockets. Stamping 10-12014 replaced the Malleable sockets.