



PARTS SHEET
MODEL 10-257
CAPACITY 5 TON
OCTOBER, 1965

SS-115

GENERAL INFORMATION

This Jack is equipped with a 3-way Air Valve for convenience in jacking. Air may be introduced through a hose permanently attached to the 1/4 inch pipe thread on the one side of the valve or through a hose equipped with a tire chuck through the fitting on top of the valve.

A special feature incorporated in the Jack is the Mechanical Safety Lock designed to support the load in the event of loss of air.

There are three lifting points, Lift Arms, Saddles or Top Bridge. Use the most convenient lifting point on bumper or frame members. All wheels on vehicle must be free to roll.

The Mechanical Safety Lock must be released prior to depressing the valve handle. To disengage safety lock, open valve allowing air into the cylinder to raise lift so that safety lock may be released.

At the lower rear of the Jack, located at the air inlet, a drain is provided to eliminate any water that may have accumulated. This should be periodically checked.

LUBRICATION

Use a high grade machine oil or grease to lubricate the following points:

1. The front and rear rollers greased at fittings.
2. The front caster wheel and swivel.
3. The ball bearing rear wheels.

Rated capacity of 5 ton is obtained with 105 pounds of air pressure.

TO ORDER PARTS

Order parts from your Franchised Service Depot, giving part number and complete name.

WARRANTY

These Jacks are fully guaranteed against defective material and workmanship when submitted or shipped prepaid to the nearest franchised service depot or the factory, ninety days from the date of delivery to the user. This warranty does not cover jacks that have been altered or attachments added to them which are not recommended by the manufacturer. The use of hydraulic brake or shock absorber fluid, alcohol, Kerosene or other deleterious fluids voids this warranty as does improper use of jacks through overloading or any other abusive practice or accident.

AUTO SPECIALTIES MANUFACTURING COMPANY

St. Joseph, Michigan

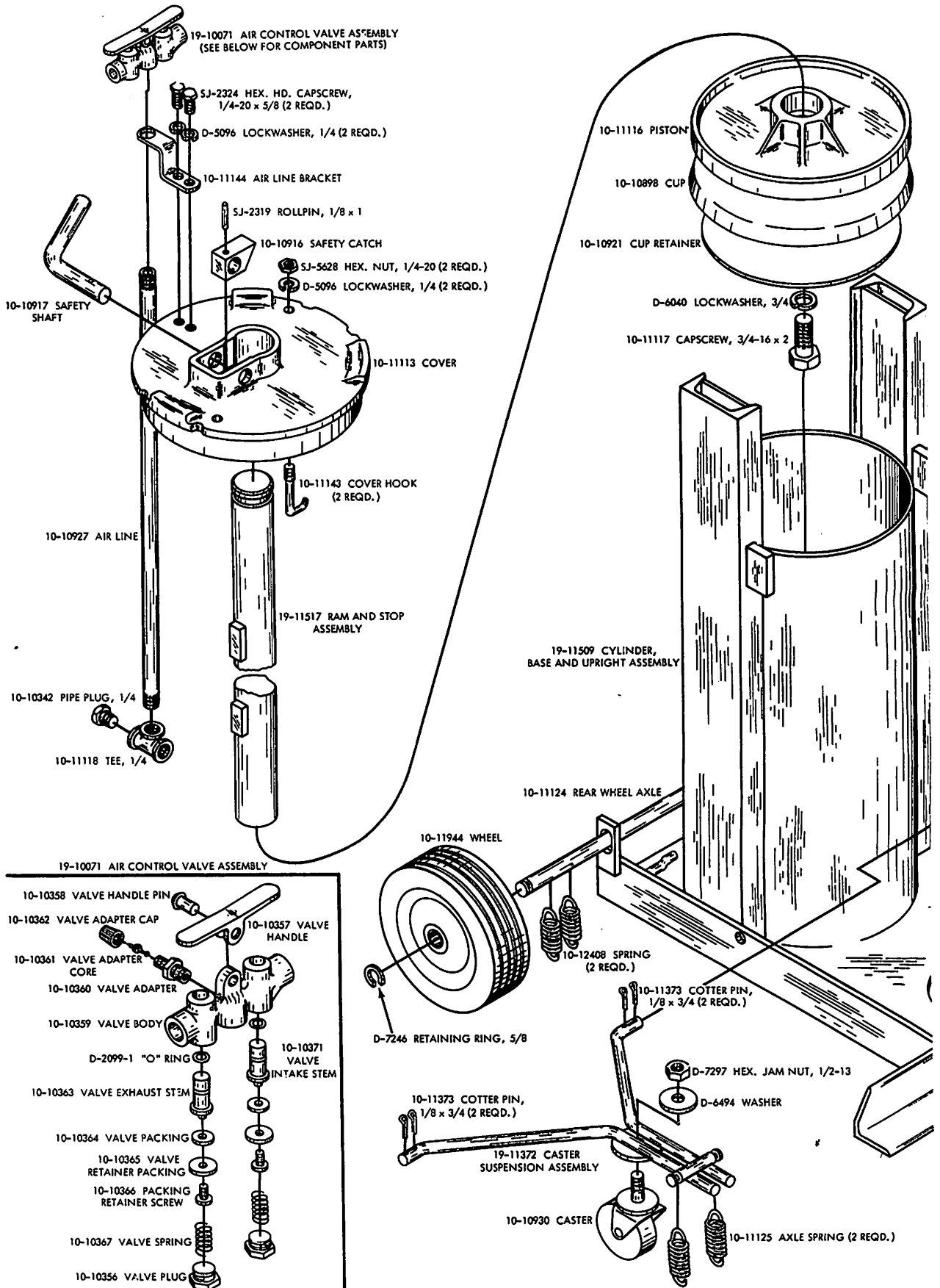

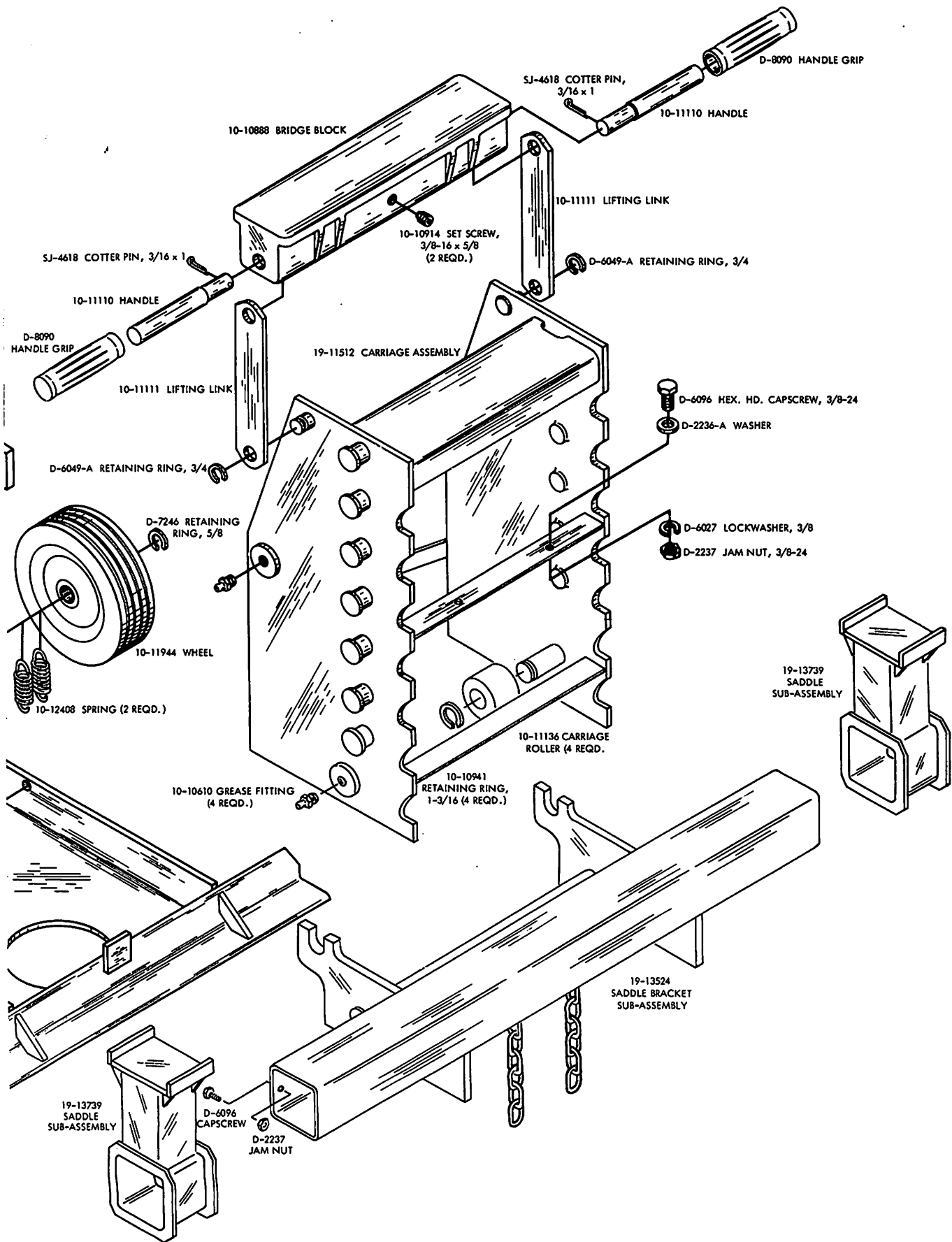

They stock our original parts, kits, and units. When ordering, indicate required items by