

PARTS BREAKDOWN

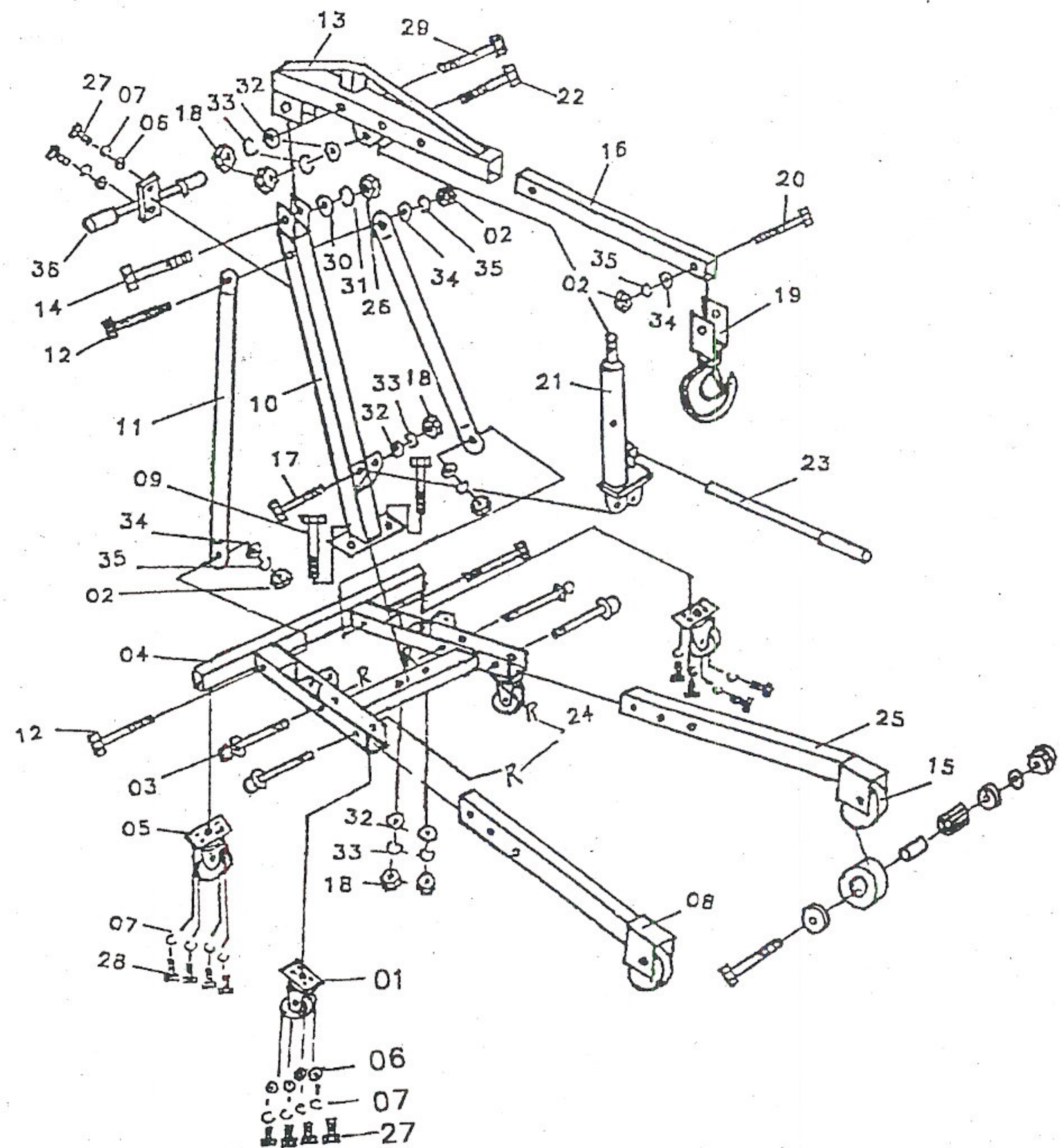

Index No.	Description	Qty.	Index No.	Description	Qty.
01	Caster - Ø60	2	20	Bolt - M14 × 85	1
02	Nut - M14	4	21	Hydraulic Ram	1
03	Roller Shaft Ø18 × 100	4	22	Bolt - M16 × 85(8.8)	1
04	Base	1	23	Jack Handle	1
05	Caster - Ø90	2	24	Hitch Pin	4
06	Washer - Ø8	10	25	Left Leg	1
07	Spring Washer - Ø8	18	26	Nut - M18	1
08	Right leg	1	27	Bolt - M8 × 15	10
09	Bolt - M16 × 95	2	28	Bolt - M8 × 20	8
10	Support Post	1	29	Bolt - M16 × 85	1
11	Support	2	30	Washer - Ø18	1
12	Bolt - M14 × 105	3	31	Spring Washer - Ø18	1
13	Boom	1	32	Washer - Ø16	5
14	Bolt - M18 × 105	1	33	Spring Washer - Ø16	5
15	Caster	2	34	Washer - Ø14	4
16	Boom Extension	1	35	Spring Washer - Ø14	4
17	Bolt - M16 × 95(8.8)	1	36	Handle Grip	1
18	Nut - M16	5			
19	Hook and U Base	1			

For information regarding the maintenance and use of this unit call

1-800-820-7236

of
ng

ator

on

caused

cilities

arranty

CHINA



2 Ton Mobile Folding Engine Crane

MODEL NO.
TAC2

OPERATING INSTRUCTIONS

PARTS LIST

WARRANTY

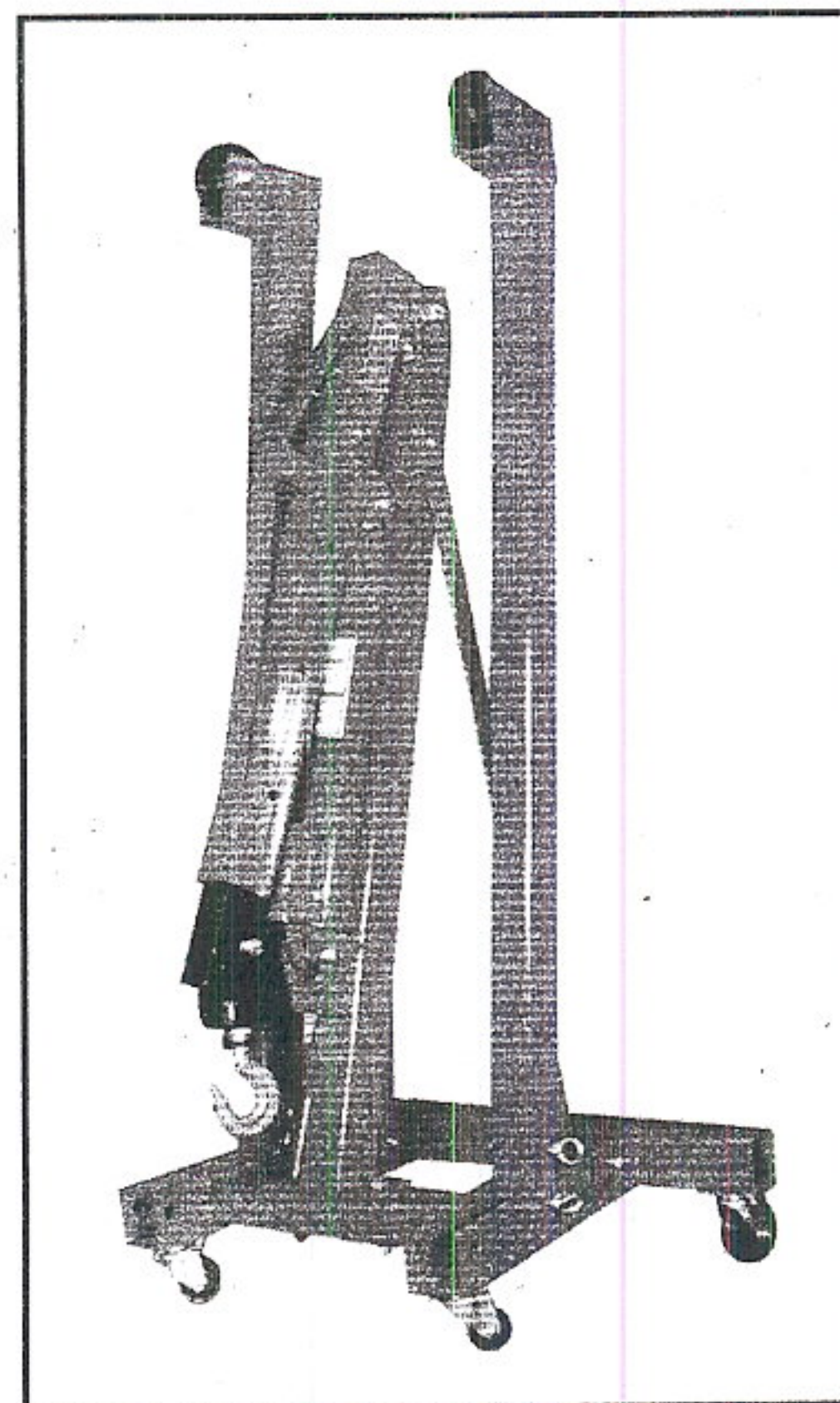
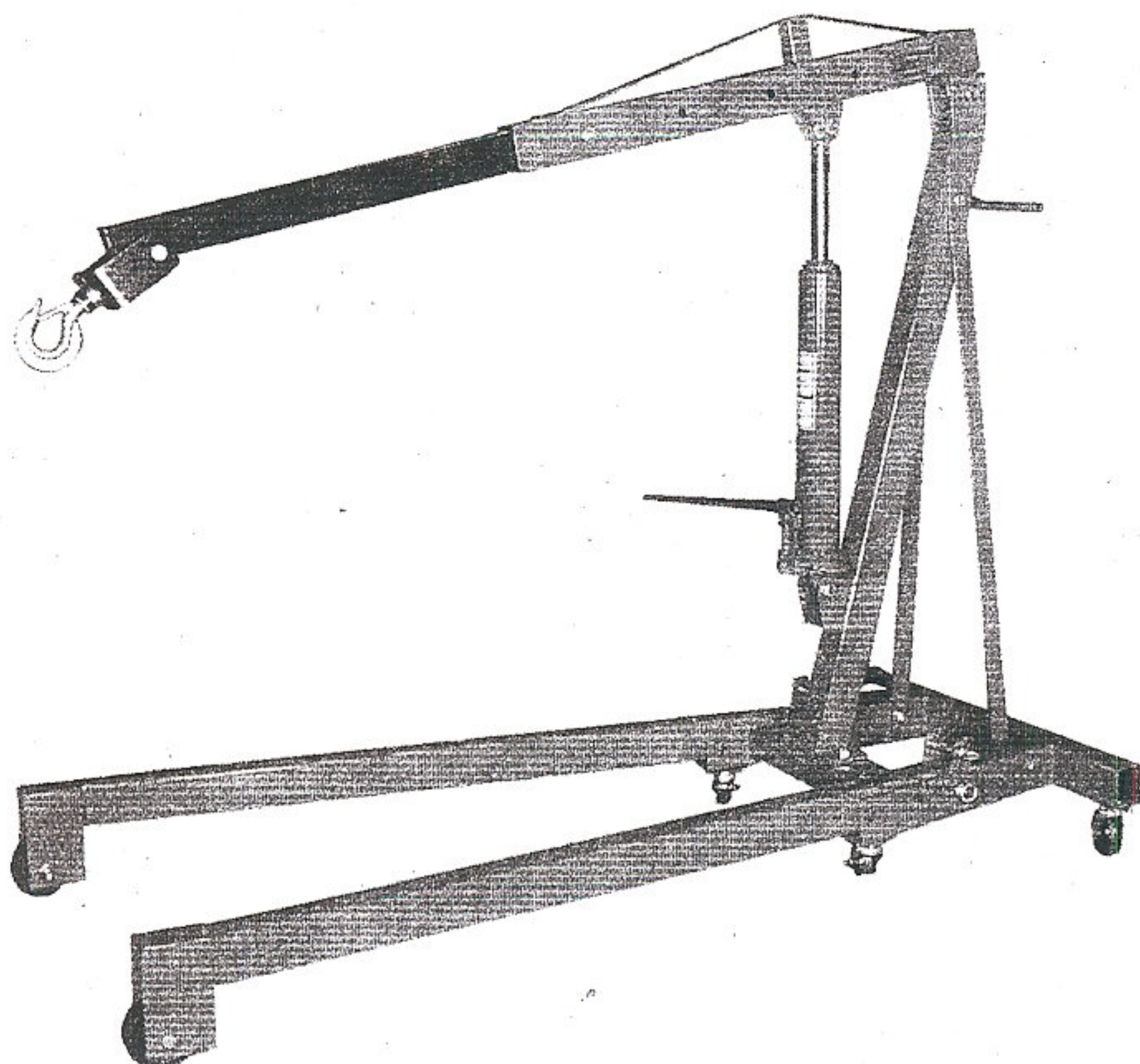

WARNING



For Your Safety & To Prevent Injury

1. Do **NOT** overload this equipment beyond its rated capacity.
2. Oil all moving joints periodically with a medium weight machine oil or motor oil.
3. Do **NOT** use brake or shock absorber fluids.
4. Make sure that the boom is in the lowered position when adding oil.

OWNER'S RESPONSIBILITY

The owner and/or operator shall have an understanding of these operating instructions and warnings before operating the crane. Warning information shall be emphasized and understood. If the operator is not fluent in English, the instructions shall be read to and discussed with the operator in operator's native language by the purchaser/owner, making sure that the operator comprehends its content.

MEETS OR EXCEEDS ANSI STANDARD FOR PERFORMANCE AND SAFETY

For information regarding the maintenance and use of this unit call: 1-800-820-7236

ASTRO 1 YEAR LIMITED WARRANTY

The manufacturer warrants this equipment to the original user against defective material or workmanship for a period of 1 year from the date of purchase on repair parts and labor. The manufacturer's responsibility under this warranty is limited to the repair or replacement defective part or parts. The manufacturer reserves the right to determine whether the part or parts failed because of defective material, of workmanship or other causes. Failure caused by accident, alteration, misuse or improper packaging of returned units is not covered by this warranty. All warranty repairs must be done by an Astro Tool Service Representative or Astro Factory. Any repair to the equipment other than by these authorized facilities voids this warranty. The rights under this warranty are limited to the original user and may not be transferred to subsequent owners. This warranty is in lieu of all other warranties, express or implied including warranties of merchantability and fitness for a particular purpose.

WARNING: Do not, under any circumstances, attempt to repair or make any adjustments to your tool or equipment, as this will VOID your warranty.

Note: Some states do not allow the exclusion or limitations of incidental or consequential damages, so the above limitations may not apply to you. **This warranty gives you specific legal rights. You may also have other rights which vary from state to state or outside the U.S.A.**



Astro Pneumatic Tool Company
1-800-820-7236

MADE IN CHINA