



ASTROLINE

HTJ43001

1,000 LB PROFESSIONAL HIGH LIFT TRANSMISSION JACK

OPERATING INSTRUCTIONS

PARTS LIST

WARRANTY

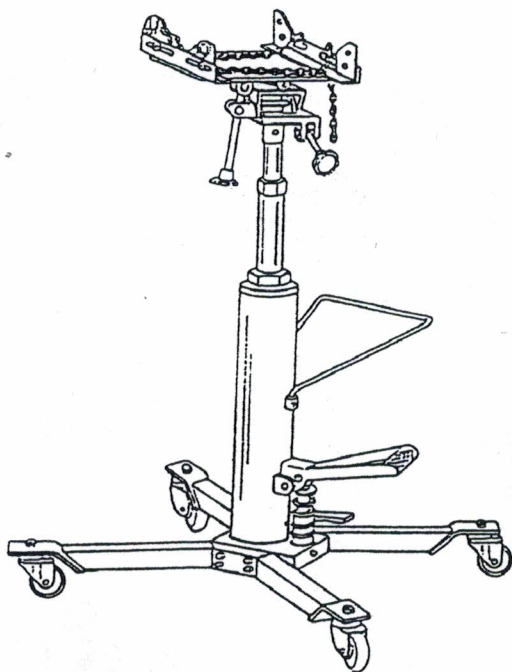

WARNING:



For Your Safety & To Prevent Injury

Read, Study and understand all warning labels and operating instructions furnished with this equipment prior to use. If any portion of this material is unclear contact your representative for clarification. Never allow unskilled or improperly trained personnel to operate this equipment. Use of the transmission jack is limited to the removal and installation of transmissions, transaxles and vehicle components for which appropriate adaptors are supplied. Do not lift or support vehicles with transmission jack.

Be sure vehicle is appropriately supported before starting repairs. This jack is not a load sustaining device. Do not overload. Overloading can cause damage, failure of the jack, and/or personal or fatal injury. Use only on hard level surfaces capable of sustaining the load. Use on other than hard level surfaces will result in jack instability and loss of load. Always use the load restraint chain, corner support bracket, and attachments to stabilize and firmly secure the load to the saddle. Insure that load restraint chain is tight and properly positioned to effectively harness the load. Never use this jack without a load restraint chain strong enough to support the transmission. Prior to transporting the load, insure that the jack is adjusted so the saddle is in the lowest horizontal position possible, and the load is centrally located on the saddle.

Do not modify this equipment or remove load restraint chain. It is your responsibility to keep all warning labels and instruction literature legible and intact. Replacement labels and literature are available from the factory. Failure to heed these warnings may result in equipment and/or property damage and/or personal or fatal injury

OPERATING INSTRUCTIONS:

1. Lifting - Close release valve first, pump pedal to raise saddle to contact load. Position jack so weight of load will be equally distributed on saddle, and adjust pitch and tilt controls as necessary. Position corner support brackets and secure load with Load Restrain Chain.

WARNING: Always use the Load restraint Chain, Corner Support Brackets, and attachments to stabilize and firmly secure the load to the saddle. The chain should be used as follows: Place the chain over the load, pull taut and engage into slot on opposite side of saddle. Tighten wing nut.

2. Lowering - To lower jack, open release knob slowly.

MAINTENANCE:

1. Lubricate regularly all moving parts of the jack. Pay special attention to the lift screw and related linkages.

2. Regularly check oil level. With the saddle fully lowered, remove oil filler screw, and check oil level. For units with filler screw in the reservoir tube, oil should just cover the inner cylinder tube. For units with filler screw at the rear of the unit block, level should be at the bottom of the filler screw holes. Fill if necessary. Use only hydraulic jack oil in the pump unit. **Do not use hydraulic brake fluid.**

3. If jack fails to operate - check oil level and/or bleed unit before seeking service.

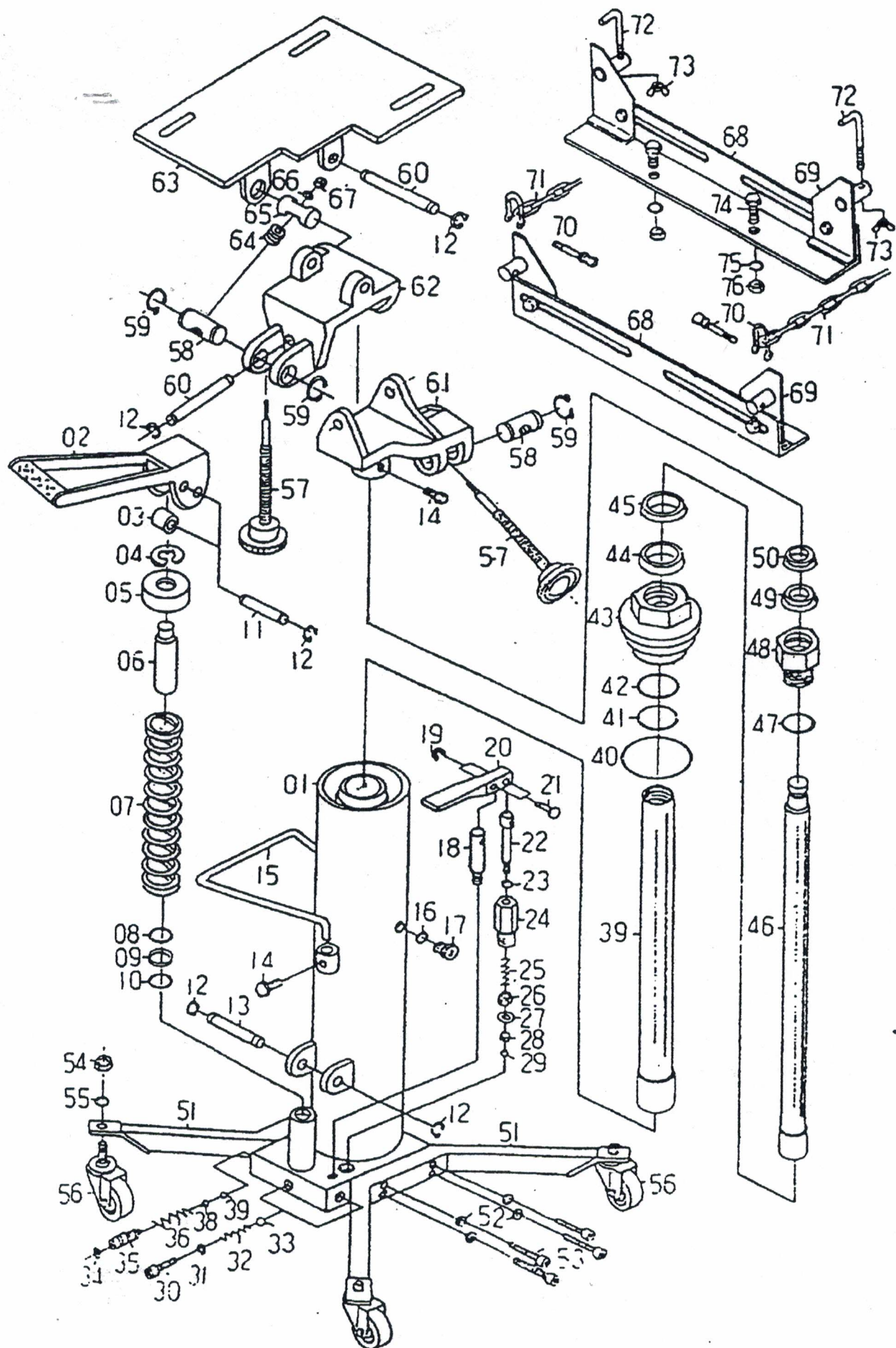

1,000 LB PROFESSIONAL HIGH LIFT TRANSMISSION JACK ASSEMBLY INSTRUCTIONS

- STEP 1: Install LEGS ASSEMBLY to POWER UNIT by using 3/8" UNC BOLTS and WASHERS
Do Not Use Any Kind of Air Ratchet or Air Gun to tighten Any bolt On This Unit!
- STEP 2: With 3/8" x 3/4" BOLTS/WASHER, install ALL FOUR SADDLE ANGLES to top part of SADDLE ASSEMBLY.
- STEP 3: Install WING NUT/CHAIN ASSEMBLY to SADDLE ANGLES to top part of SADDLE ASSEMBLY.
Always Use the Load restraint Chain!

PART	DESCRIPTION	QTY	PART	DESCRIPTION	QTY	PART	DESCRIPTION	QTY	PART	DESCRIPTION	QTY
01	Base Assembly	1	20	Pedal	1	39	Main Piston	1	58	Adjust Bearing	2
02	Pedal	1	21	Pin	2	40	"O" Ring	1	59	Snap Ring	4
03	Bushing	1	22	Release Stem	1	41	Back-UP Ring	1	60	Pin	2
04	Retainer Ring	1	23	"O" Ring	1	42	"O" Ring	1	61	Saddle Base 1	1
05	Spring Cover	1	24	Release Valve	1	43	Top Cap	1	62	Saddle Base 2	1
06	Piston	1	25	Spring	1	44	"U" Cup Seal	1	63	Flat Plate	1
07	Spring	1	26	Nut	1	45	Wiper Seal	1	64	"T" Bearing	2
08	"O" Ring	1	27	Brass Washer	1	46	Main Piston	1	65	Bearing System	2
09	Back-UP Ring	1	28	Ball Guider	1	47	"O" Ring	1	66	Washer	2
10	"O" Ring	1	29	Steel Ball	1	48	Top Cap	1	67	Hex Nut	2
11	Pin	1	30	Screw	2	49	"U" Cup Seal	1	68	Saddle Angle 1	2
12	Snap Ring	8	31	Brass Washer	2	50	Wiper Seal	1	69	Saddle Angle 2	4
13	Pin	1	32	Spring	2	51	Legs	2	70	Chain	2
14	Screw	2	33	Steel Ball	2	52	Spring Washer	8	71	Chain Connector	2
15	Grip	1	34	"O" Ring	1	53	Screw	8	72	Hook Bolt	2
16	"O" Ring	1	35	Screw	1	54	Nut	4	73	Wing Nut	2
17	Screw	1	36	Spring	1	55	Washer	4	74	Screw	4
18	Stable Stem	1	37	Ball Guider	1	56	Wheels	4	75	Washer	4
19	Snap Ring	2	38	Steel Ball	1	57	Wing Screw	2	76	Nut	4